

# Milling System

## ISO-GSK

ISO-GSK HIGH SPEED SK COLLET CHUCK

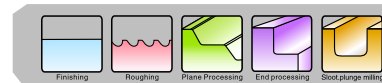

- Wrench : P02
- Collet : P05-P06
- Nut : P02
- Pull Stud : P03-P04
- Locking Device : P09

- ◆ High-speed engraving and milling machine specific tool holders.
- ◆ Sk Collet (4°), higher repeat clamping accuracy.
- ◆ Full Circle nuts, low noise, little wind resistance.



Model explanation

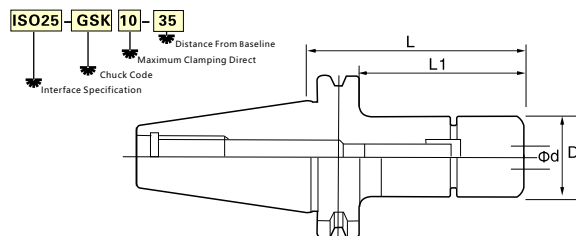

G2.5 MAX.40,000min<sup>-1</sup>

Order No.	Cat. No	Φd Chucking Dia	D	L1	L	Nut	Collet	Collet Puller	spanner	Locking Device	PRICE (RMB)
301100	ISO20-GSK6-45	2-6	20	32	45	LMGSK06	SK06	CX06	BSGSK06	SDZISO20	1200
301102	-GSK10-45	2-10	27	32	45	LMGSK10	SK10	CX10	BSGSK10	SDZISO20	1200
301104	ISO25-GSK6-45	2-6	20	32	45	LMGSK06	SK06	CX06	BSGSK06	SDZISO25	1200
301106	-GSK10-45	2-10	27	32	45	LMGSK10	SK10	CX10	BSGSK10	SDZISO25	1200
301108	-GSK16-45	2-16	40	32	45	LMGSK16	SK16	CX16	BSGSK16	SDZISO25	1200
301110	ISO30-GSK06-60	2-6	20	46	60	LMGSK06	SK06	CX06	BSGSK06	SDZISO30	1200
301112	-GSK10-60	2-10	27	46	60	LMGSK10	SK10	CX10	BSGSK10	SDZISO30	800
301114	-GSK16-60	2-16	40	46	60	LMGSK16	SK16	CX16	BSGSK16	SDZISO30	900

## NBT-GSK

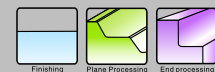

- Wrench : P02
- Collet : P05-P06
- Nut : P02
- Pull Stud : P03-P04
- Locking Device : P09

- ◆ High-speed carving and milling machine for tool holder
- ◆ Non-eccentric full balanced round nut.
- ◆ low noise, little wind resistance.



Model explanation

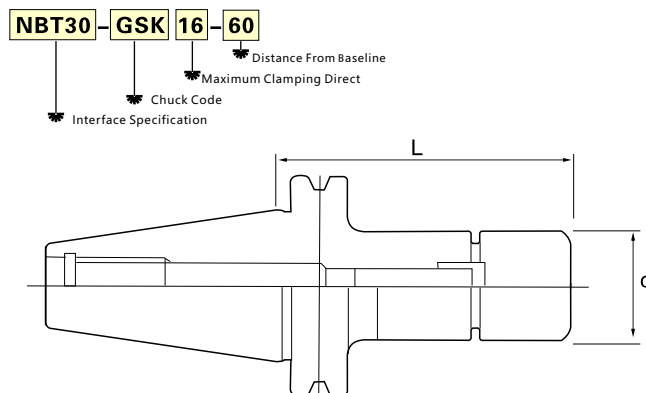

G2.5 MAX.30,000min<sup>-1</sup>

Order No.	Cat. No	Chucking Dia	C	L	Nut	Collet	Collet Puller	spanner	Locking Device	PRICE (RMB)
301200	NBT30-GSK10-60	3.0~10.0	27.1	60	GSK10	SK10	CX10	GSK10	NBT30	800
301202	-GSK16-60	3.0~16.0	40	60	GSK16	SK16	CX16	GSK16	NBT30	900

## BT-GSK

BT-GSK HIGH SPEED SK COLLET CHUCK

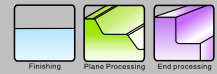

- ◆ SK Collet(4°) , Higher Repeat Clamping Accuracy.
- ◆ Full Circle Nuts, Low noise, Little Wind Resistance.



Wrench : P02  
Collet : P05-P06  
Nut : P02  
Pull Stud : P03-P04  
Locking Device : P09

**G2.5 MAX.30,000min<sup>-1</sup>**

### Model explanation

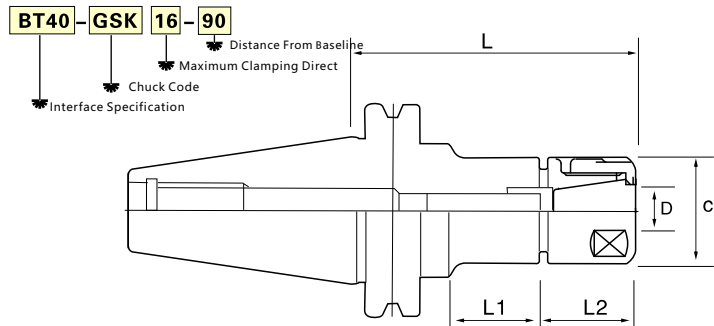

Order No.	Cat. No	D	L	C	MAX.min <sup>-1</sup>	nut	collet	Collet Puller	spanner	Weight ( KG )	PRICE (RMB)
301300	<b>BT30-GSK6-60</b>	2~6.0	60	19.5	30,000	GSK6	SK6	CX6	GSK6	0.7	<b>950</b>
301302	-GSK6-90		90							0.7	<b>1000</b>
301304	-GSK10-60	3~10.0	60	27.1	30,000	GSK10	SK10	CX10	GSK10	0.9	<b>950</b>
301306	-GSK10-90		90							1.0	<b>1000</b>
301308	-GSK10-120		120							1.2	<b>1125</b>
301310	-GSK16-60	3~16.0	60	40	25,000	GSK16	SK16	CX16	GSK16	1.1	<b>1000</b>
301312	-GSK16-90		90							1.2	<b>1125</b>
301314	-GSK16-120		120							1.4	<b>1250</b>
301316	<b>BT40-GSK6-60</b>	2~6.0	60	19.5	30,000	GSK6	SK6	CX6	GSK6	1.0	<b>950</b>
301318	-GSK6-90		90							1.1	<b>1000</b>
301320	-GSK6-120		120							1.3	<b>1125</b>
301322	-GSK10-60	3~10.0	60	27.1	25,000	GSK10	SK10	CX10	GSK10	1.1	<b>950</b>
301324	-GSK10-90		90							1.2	<b>1000</b>
301326	-GSK10-120		120							1.4	<b>1125</b>
301328	-GSK16-60	3~16.0	60	40	25,000	GSK16	SK16	CX16	GSK16	1.3	<b>1000</b>
301330	-GSK16-90		90							1.5	<b>1125</b>
301332	-GSK16-120		120							1.7	<b>1250</b>
301334	-GSK25-90	6~25	90	55	20,000	GSK25	SK25	CX25	GSK25	1.8	<b>1250</b>
301336	-GSK25-120		120							2.0	<b>1375</b>
301338	<b>BT50-GSK6-105</b>	2~6.0	105	19.5	20,000	GSK6	SK6	CX6	GSK6	3.8	<b>1750</b>
301340	-GSK10-105	3~10.0	105	27.1	20,000	GSK10	SK10	CX10	GSK10	4.2	<b>1750</b>
301342	-GSK10-135		135							4.4	<b>2000</b>
301344	-GSK16-105	3~16.0	105	40	15,000	GSK16	SK16	CX16	GSK16	4.7	<b>1875</b>
301346	-GSK16-135		135							4.9	<b>2125</b>
301348	-GSK25-105	6~25	105	55	15,000	GSK25	SK25	CX25	GSK25	5.2	<b>2000</b>
301350	-GSK25-135		135							5.5	<b>2250</b>

## BT-SK

BT-SK SK COLLET CHUUCK

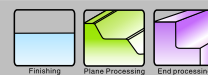

Model explanation

◆ SK Collet(4°), Higher Repeat Clamping Accuracy.

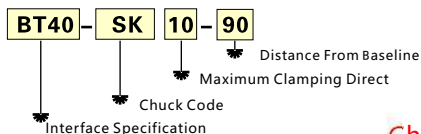

- Wrench : P02
- Collet : P05-P06
- Nut : P02
- Pull Stud : P03-P04
- Locking Device : P09

### Characteristic :

- GSK series is suitable for high speed and high precision cutting.
- Cutting stability, reduce vibration.
- The tool is inserted into the inner hole of the Collet, which must exceed the effective clamping length of the Collet hole, Avoid improper locking, damage.
- Precision balance correction available:  
G2.515000RPM~25000RPM.

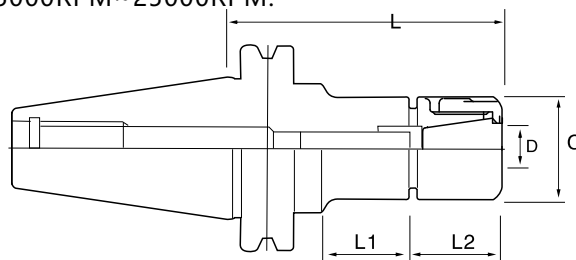

G2.5 MAX.15,000min<sup>-1</sup>

Order No.	Cat. No	D	L	C	nut	collet	Collet Puller	spanner	Weight ( KG )	PRICE (RMB)
301400	BT30-TSK06-60	1.8~6.00	60	20	LMTSK06	SK06	CX06	BSTSK06	0.7	500
301402	TSK06-100	1.8~6.00	100	20					0.9	500
301404	TSK10-60	1.8~10.00	60	30	LMTSK10	SK10	CX10	BSTSK10	0.9	500
301406	TSK10-100	1.8~10.00	100	30					1.0	500
301408	TSK16-60	2.75~16.00	60	40	LMTSK16	SK16	CX16	BSTSK16	1.0	500
301410	TSK16-100	2.75~16.00	100	40					1.1	500
301412	BT40-TSK06-60	1.8~6.00	60	20	LMTSK06	SK06	CX06	BSTSK06	1.1	600
301414	TSK06-100	1.8~6.00	100	20					1.2	600
301416	TSK10-60	1.8~10.00	60	30	LMTSK10	SK10	CX10	BSTSK10	1.1	600
301418	TSK10-100	1.8~10.00	100	30					1.2	600
301420	TSK16-60	2.75~16.00	60	40	LMTSK16	SK16	CX16	BSTSK16	1.3	600
301422	TSK16-100	2.75~16.00	100	40					1.5	600
301424	TSK25-80	8.00~25.00	80	55	LMTSK25	SK25	CX25	BSTSK25	1.6	700
301426	TSK25-120	8.00~25.00	120	55					1.9	700
301428	BT50-TSK10-100	1.8~10.00	100	30	LMTSK10	SK10	CX10	BSTSK10	4.2	900
301430	TSK10-150	1.8~10.00	150	30					4.4	1000
301432	TSK16-100	2.75~16.00	100	40	LMTSK16	SK16	CX16	BSTSK16	4.5	900
301434	TSK16-150	2.75~16.00	150	40					4.7	1000
301436	TSK25-120	8.00~25.00	120	55	LMTSK25	SK25	CX25	BSTSK25	4.8	1000
301438	TSK25-200	8.00~25.00	200	55					5.3	1200

## C-GSK

C-GSK STRAIGHT SHANK SK COLLET CHUCK HOLDER



Wrench : P02  
Collet : P05-P06  
Nut : P02

### Model explanation

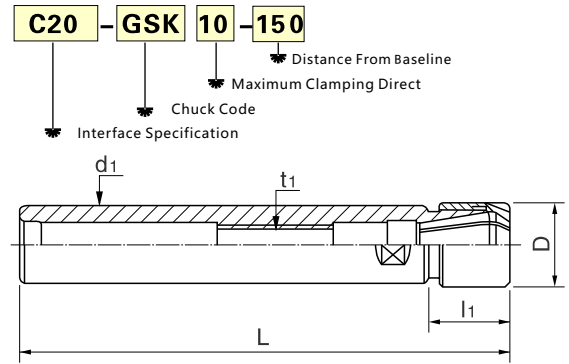

Order No.	Cat. No	Chucking Dia	L	L1	D	nut	Collet	Collet Puller	spanner	PRICE (RMB)
301500	<b>C20-GSK6-100</b>	2~6.0	100	36	19.5	GSK6	SK6	CX6	GSK6	500
301502	<b>-GSK6-150</b>		150	56						550
301504	<b>-GSK10-100</b>	3~10	100	40	27.1	GSK10	SK10	CX10	GSK10	500
301506	<b>-GSK10-150</b>		150	60						550
301508	<b>C25-GSK10-100</b>	3~10	100	30	19.5	GSK10	SK10	CX10	GSK10	550
301510	<b>-GSK10-150</b>		150	60						600
301512	<b>-GSK16-100</b>	3~16	100	50	27.1	GSK16	SK16	CX16	GSK16	550
301514	<b>-GSK16-150</b>		150	75						600
301516	<b>C32-GSK10-120</b>	3~10	120	47	27.1	GSK10	SK10	CX10	GSK10	600
301518	<b>-GSK10-150</b>		150	75						650
301520	<b>-GSK16-120</b>	3~16	120	58	40	GSK16	SK16	CX16	GSK16	700
301522	<b>-GSK16-150</b>		150	88						750
301524	<b>-GSK16-180</b>		180	118						850
301526	<b>-GSK25-150</b>		6.0~25.4	150						88

## C-SK

C-SK STRAIGHT SHANK SK COLLET CHUCK HOLDER



Wrench : P02  
Collet : P05-P06  
Nut : P02

### Model explanation

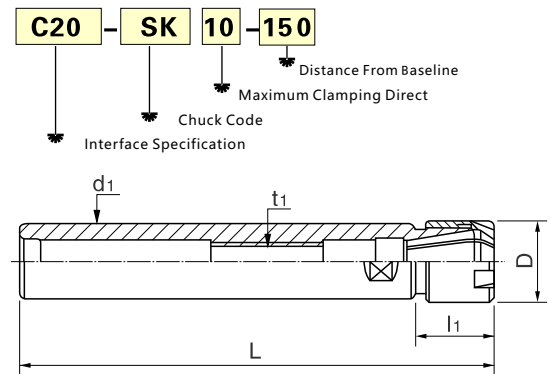

Order No.	Cat. No	Chucking Dia	L	L1	D	nut	Collet	Collet Puller	spanner	PRICE (RMB)
301600	<b>C20-SK6-100</b>	2~6.0	100	36	18	SK6	SK6	CX6	TSK6	500
301602	<b>-SK6-150</b>		120	56						550
301604	<b>-SK10-100</b>	3~10	100	40	25	SK10	SK10	CX10	TSK10	500
301606	<b>-SK10-150</b>		120	60						550
301608	<b>C25-SK10-100</b>	3~10	100	30	18	SK10	SK10	CX10	TSK10	550
301610	<b>-SK10-150</b>		130	60						600
301612	<b>-SK16-100</b>	3~16	120	50	25	SK16	SK16	CX16	TSK16	550
301614	<b>-SK16-150</b>		150	75						600
301616	<b>C32-SK10-120</b>	3~10	120	47	25	SK10	SK10	CX10	TSK10	600
301618	<b>-SK10-150</b>		150	75						650
301620	<b>-SK16-120</b>	3~16	120	58	40	SK16	SK16	CX16	TSK16	700
301622	<b>-SK16-150</b>		150	88						750
301624	<b>-SK16-180</b>		180	118						850
301626	<b>-SK25-150</b>		6.0~25.4	150						88

## BT-HM

BT-HM HYDRAULIC EXPANSION CHUCK



### Model explanation

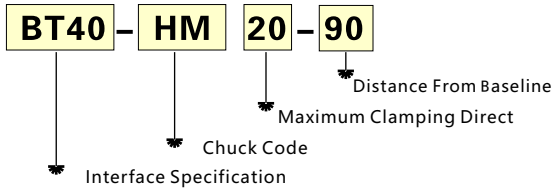

- ◆ Beating accuracy **3 $\mu$ m**.
- ◆ Torque **450NM**
- ◆ For precision machining



- Wrench : P02
- Collet : P05-P06
- Nut : P02
- Pull Stud : P03-P04
- Locking Device : P09

**G2.5 MAX.30,000min<sup>-1</sup>**

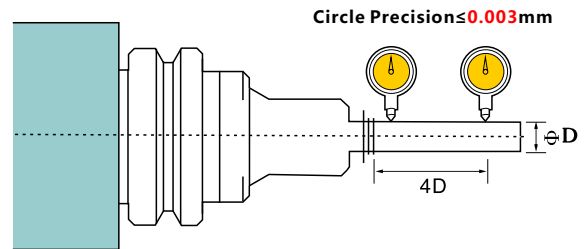

Take deep groove processing, please matching shrink its handle bar.

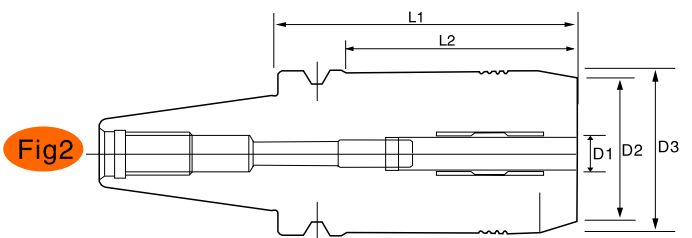
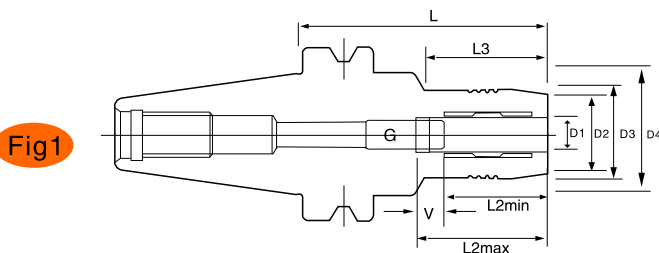

Order No.	Cat. No	D1	D2	D3	D4	L	L2max	L2min	V	L3	Collet	G	spanner	Type	PRICE (RMB)						
301700	<b>BT30-HM6-70</b>	6	25	28	45	70	37.5	27.5	10	28	---	M5X0.8	T4	FIG1	3450						
301702	<b>-HM8-70</b>	8	27	30		70					---	M6X1.0			3450						
301704	<b>-HM10-75</b>	10	29	32		75					---	M8x1.0			3450						
301706	<b>-HM12-75</b>	12	31	34		75					OHM12	M8x1.0			3450						
301708	<b>-HM16-90</b>	16	35	38		90					---	M10x1.0			3450						
301710	<b>-HM20-90</b>	20	40	43		90					OHM20				3450						
301712	<b>BT40-HM6-90</b>	6	25	28	50	90	37.5	27.5	10	44.5	---	M5X0.8	T4	FIG1	3625						
301714	<b>-HM8-90</b>	8	27	30		90					---	M6X1.0			3625						
301716	<b>-HM10-90</b>	10	29	32		90	---	M8x1.0			3625										
301718	<b>-HM12-90</b>	12	31	34		90	OHM12	M10x1.0			3625										
301720	<b>-HM16-90</b>	16	35	38		90	---				3625										
301722	<b>-HM20-90</b>	20	40	43		90	OHM20	3625													
301724	<b>-HM25-100</b>	25	53	57		100	---	M16x1.0			T5	FIG2			3625						
301726	<b>-HM32-105</b>	32	60	63		105	OHM32								3860						
301728	<b>BT50-HM12-90</b>	12	31	34		50	90	47.5			37.5	10			32	OHM12	M8x1.0	T4	FIG1	4450	
301730	<b>-HM20-90</b>	20	40	43			90									OHM20	M10x1.0			4450	
301732	<b>-HM32-115</b>	32	60	63	---		115		65.0	55			77	OHM32		M16x1.0	T5			FIG2	4560



## SR SR SHRINK FIT CHUCK

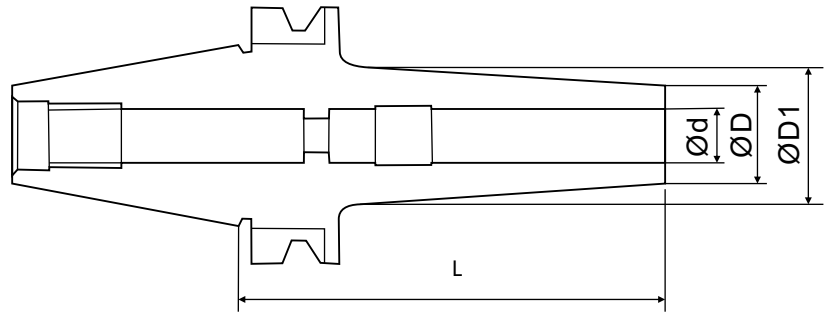
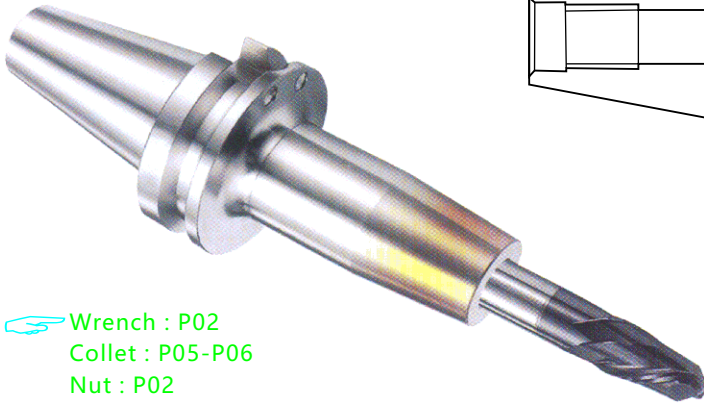

- Wrench : P02
- Collet : P05-P06
- Nut : P02
- Pull Stud : P03-P04
- Locking Device : P09

◆ Produced by the heating machine induction coil of high frequency electromagnetic wave to handle induction current to generate heat, rapid heating expansion will handle tool into after cooling contraction can obtain strong clamping force.

◆ Suitable for high speed steel and carbide cutting tools, clamping stability, high precision (0.005mm)

◆ Body material selection of special anti heat steel, strong rigidity long service life.

Order No.	Cat. No	Ød	ØD	ØD1	L
301800	BT30-SR06-80	6	16	21	80
301802	BT30-SR06-130	6	16	21	130
301804	BT30-SR08-80	8	18	23	50
301806	BT30-SR08-130	8	18	23	130
301808	BT30-SR10-80	10	22	27	80
301810	BT30-SR10-130	10	22	27	130
301812	BT30-SR12-80	12	24	29	80
301814	BT30-SR12-130	12	24	29	130
301816	BT30-SR16-80	16	28	33	80
301818	BT30-SR16-130	16	28	33	130
301820	BT40-SR06-90	6	16	21	90
301822	BT40-SR06-130	6	16	21	130
301824	BT40-SR08-90	8	18	23	90
301826	BT40-SR08-130	8	18	23	130
301828	BT40-SR10-90	10	22	27	90
301830	BT40-SR10-130	10	22	27	130
301832	BT40-SR12-90	12	24	29	90
301834	BT40-SR12-130	12	24	29	130
301836	BT40-SR16-90	16	28	33	90
301838	BT40-SR16-130	16	28	33	130
301840	BT40-SR20-90	20	34	41	90
301842	BT40-SR20-130	20	34	41	130
301844	BT40-SR25-90	25	44	51	90
301846	BT40-SR25-130	25	44	51	130
301848	BT40-SR32-90	32	44	51	90
301850	BT40-SR32-130	32	44	51	130
301852	BT50-SR06-105	6	16	21	105
301854	BT50-SR06-150	6	16	21	150
301856	BT50-SR08-105	8	18	23	105
301858	BT50-SR08-150	8	18	23	150
301860	BT50-SR10-105	10	22	27	105
301862	BT50-SR10-150	10	22	27	150
301864	BT50-SR12-105	12	24	29	105
301866	BT50-SR12-150	12	24	29	150
301868	BT50-SR16-105	16	28	33	105
301870	BT50-SR16-150	16	28	33	150
301872	BT50-SR20-105	20	34	41	105
301874	BT50-SR20-150	20	34	41	150
301876	BT50-SR25-105	25	44	51	105
301878	BT50-SR25-150	25	44	51	150
301880	BT50-SR32-105	32	44	51	105
301882	BT50-SR32-150	32	44	51	150



# Milling System

## BT-ADS 后拉式刀柄 BT-ADS COLLET CHUCK

◆ Side of the lock, to avoid dumping pull nails,  
convenient and practical

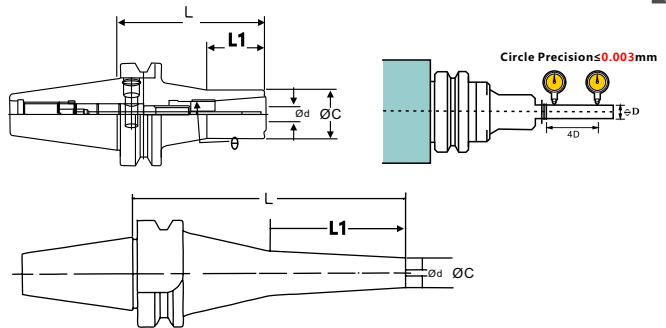
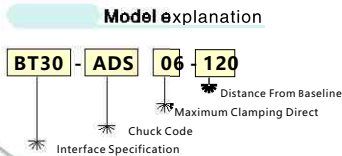
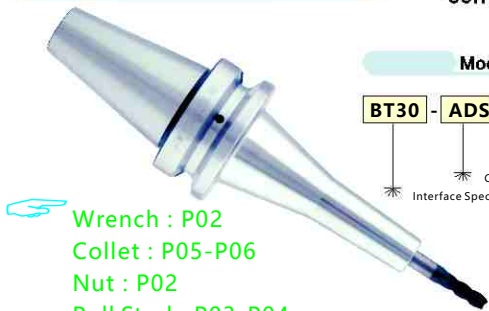
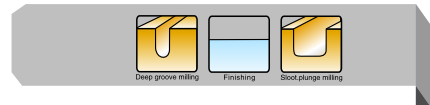

Wrench : P02  
Collet : P05-P06  
Nut : P02  
Pull Stud : P03-P04  
Locking Device : P09

G2.5 MAX.30,000min<sup>-1</sup>  
beating accuracy 0.003MM

Order No.	Cat. No	d	L	C	L1	Collet	spanner	θ	Weight ( KG )	PRICE (RMB)
301900	BT30-ADS06-60	2.0-6.0	60	13	-	ADS06	T4	6°	0.45	900
301902	-ADS06-90		90		-				0.55	950
301904	-ADS06-120		120		-				0.7	1000
301906	-ADS10-90	3.0-10.0	90	22	36	ADS10	T4	6°	0.6	1000
301908	-ADS10-105		105		35				0.7	1200
301910	-ADS12-80	3.0-12.0	80	30	35	ADS12	T4	6°	0.8	1000
301912	-ADS20-80	3.0-20.0	80	-	35	ADS20	T6	6°	0.8	1100
301914	-ADS20-100		100		50				1.2	1300
301916	BT40-ADS06-90		90		-				1.2	1200
301918	-ADS06-120	2.0-6.0	120	13	-	ADS06	T4	6°	1.5	1400
301920	-ADS06-150	2.0-8.0	150	13	-	ADS08	T4	6°	1.9	1600
301922	-ADS08-90		90		-				1.2	1200
301924	-ADS08-120	120	13	-	ADS08	T4	6°	1.5	1400	
301926	-ADS10-85	3.0-10.0	85	22	35	ADS10	T4	6°	1.3	1200
301928	-ADS10-120		120		40				1.6	1400
301930	-ADS12-70	3.0-12.0	70	30	35	ADS12	T4	6°	1.2	1200
301932	-ADS12-90		90		40				1.6	1300
301934	-ADS12-120		120		50				1.9	1400
301936	-ADS16-95	3.0-16.0	95	-	35	ADS16	T5	6°	1.7	1250
301938	-ADS16-125		125		40				2.0	1500
301940	-ADS20-80	3.0-20.0	80	-	35	ADS20	T6	6°	1.9	1300
301942	-ADS20-100		100		40				2.2	1600
301944	BT50-ADS08-95	2.0-8.0	95	13	-	ADS08	T4	6°	4.1	2200
301946	-ADS08-110		110		-				4.5	2700
301948	-ADS10-105		105		35				4.1	2200
301950	-ADS10-135	3.0-10.0	135	22	40	ADS10	T4	6°	4.4	2700
301952	-ADS10-165	3.0-10.0	165	22	50	ADS10	T4	6°	4.8	2900
301954	-ADS12-105		105		35				4.2	2200
301956	-ADS12-135	3.0-12.0	135	30	40	ADS12	T4	6°	4.5	2700
301958	-ADS12-165	3.0-12.0	165	30	50	ADS12	T4	6°	4.9	2900
301960	-ADS16-100		100		35				4.3	2200
301962	-ADS16-125	3.0-16.0	125	-	40	ADS16	T5	6°	4.6	2700
301964	-ADS20-80	3.0-20.0	80	-	35	ADS20	T6	6°	4.5	2200
301966	-ADS20-100		100		40				4.9	2700

## EXTENSION ROD AFTER PULL

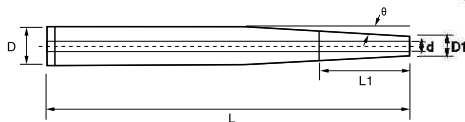

Wrench : P02  
Collet : P05-P06  
Nut : P02

Order No.	Cat. No	d	L	L1	D	D1	θ	Collet	spanner	PRICE (RMB)
302100	C08-CS04-100	2-4	100	36	8	8.0	6°	CS04	T4	2100
302102	C10-CE04-100	2-4	100	36	10	10.0				2200
302104	150	2-4	150	36	10	10.0	6°	CE04	T4	2500
302106	150S	2-4	150	36	10	8.2				2500
302108	C12-CE04-150S	2-4	150	36	12	9.7	6°	ADS06	T4	3000
302110	C12-ADS06-100	2-6	100	36	12	12.0				2600
302112	150	2-6	150	36	12	12.0	6°	ADS06	T4	2800
302114	150L	2-6	150	36	12	12.0				2800
302116	C16-ADS06-150S	2-6	150	50	16	12.4	6°	ADS06	T4	4000
302118	150L	2-6	150	50	16	12.4				4000
302120	200S	2-6	200	50	16	12.4	6°	ADS10	T4	4600
302122	200L	2-6	200	50	16	12.4				4600
302124	C20-ADS10-150	3-10	150	50	20	20.0	6°	ADS10	T4	5600
302126	200	3-10	200	50	20	20.0				6600

## HSK-ADS HSK-ADS COLLET CHUCK



Wrench : P02  
Collet : P05-P06  
Nut : P02  
Pull Stud : P03-P04  
Locking Device : P09

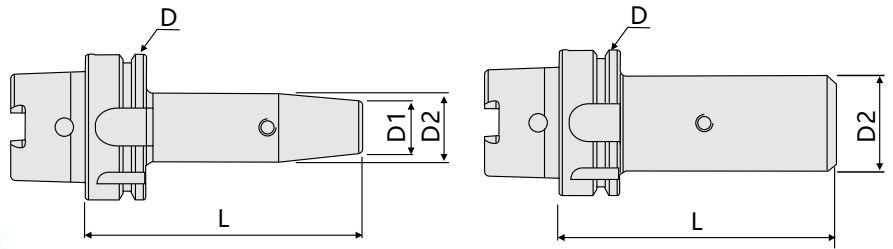

### Characteristic :

- Pull a Tool with pull type Collet clamp, applicable to the processing of high speed and high precision.
- The tool is inserted into the inner hole of the Collet, which must exceed the effective clamping length of the inner hole of the Collet to avoid improper locking and damage.
- With the HSK two constraints, can increase the stability of lateral processing.

Order No.	Model	L	ΦD	ΦD1	ΦD2	FIG.圖	Price
302200	HSK50A-ADS06-105	105	50	23	30	1	2050
302202	HSK50A-ADS06-120	120	50	23	30	1	2080
302204	HSK50A-ADS12-120	120	50	-	34	2	2110
302206	HSK50A-ADS12-120	130	50	-	34	2	2150
302208	HSK50A-ADS20-130	130	50	-	42	2	2180
302210	HSK50A-ADS20-150	150	50	-	42	2	2210
302212	HSK63A-ADS06-110	110	63	23	30	1	2050
302214	HSK63A-ADS06-120	120	63	23	30	1	2080
302216	HSK63A-ADS12-120	120	63	-	42	2	2110
302218	HSK63A-ADS12-150	150	63	-	42	2	2150
302220	HSK63A-ADS20-130	130	63	-	42	2	2180
302222	HSK63A-ADS20-140	140	63	-	42	2	2210

## SK-ADS SK-ADS COLLET CHUCK



Wrench : P02  
Collet : P05-P06  
Nut : P02  
Pull Stud : P03-P04  
Locking Device : P09

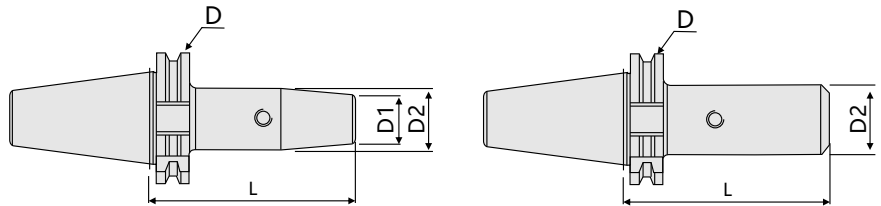

### Characteristic :

- Pull a Tool with pull type Collet clamp, applicable to the processing of high speed and high precision.
- The tool is inserted into the inner hole of the Collet, which must exceed the effective clamping length of the inner hole of the Collet to avoid improper locking and damage.

Order No.	Model	L	ΦD	ΦD1	ΦD2	FIG.	Price
302300	SK30-ADS06-70	70	50	23	30	1	1860
302302	SK30-ADS06-100	100	50	23	30	1	2050
302304	SK30-ADS12-80	80	50	-	34	2	1760
302306	SK30-ADS12-100	100	50	-	34	2	1910
302308	SK30-ADS20-80	80	50	-	42	2	1780
302310	SK30-ADS20-100	100	50	-	42	2	1930
302312	SK40-ADS06-70	70	63.55	23	30	1	2060
302314	SK40-ADS06-100	100	63.55	23	30	1	2260
302316	SK40-ADS12-80	80	63.55	-	34	2	1950
302318	SK40-ADS12-100	100	63.55	-	34	2	2110
302320	SK40-ADS20-80	80	63.55	-	42	2	1980
302322	SK40-ADS20-100	100	63.55	-	42	2	2150
302324	SK50-ADS06-70	70	97.5	23	30	1	3810
302326	SK50-ADS06-100	100	97.5	23	30	1	4210
302328	SK50-ADS12-70	70	97.5	-	34	2	3660
302330	SK50-ADS12-100	100	97.5	-	34	2	4030
302332	SK50-ADS20-80	80	97.5	-	42	2	3710
302334	SK50-ADS20-100	100	97.5	-	42	2	4100



# Milling System

## BT-C

BT-C MULTI-LOCK MILL CHUCK



Wrench : P02  
Collet : P05-P06  
Nut : P02  
Pull Stud : P03-P04  
Locking Device : P09

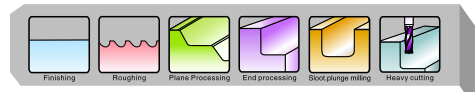

- Characteristic :**
- Slotting: the inner hole of the cutter is slotted (divided into 6 slots) to prevent sliding and increase the clamping force.
  - Needle roller bearings: the two line device, sliding surface to ensure the cone rolling friction and shedding to minimize.
  - Water proof and dust proof, clamping end contact. This design structure will not overtighten damage chuck.
  - The sealed structure, to eliminate dirt and debris damage chuck.
  - Dynamic balance can reach G6.38000RPM.
  - Balance and speed can be based on customer requirements, but the need for a separate offer.

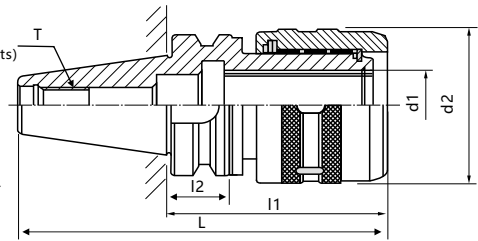

Order No.	Model	L	l1	l2	d1	d2	T	Price
302400	BT30-C20-80	128.4	80	20	20	55	M12x1.75	1200
302402	BT40-C20-80	145.4	80	25	32	68.5	M16x2.0	1200
302404	BT40-C20-100	165.4	100	25	32	68.5		1200
302406	BT40-C20-135	200.4	135	25	32	68.5		1500
302408	BT40-C20-80	145.4	80	25	32	68.5		1200
302410	BT40-C25-100	165.4	100	25	32	68.5		1200
302412	BT40-C32-90	155.4	90	25	32	68.5		1200
302414	BT40-C32-105	170.4	105	25	32	68.5	1200	
302416	BT40-C32-135	200.4	135	25	32	68.5	1500	
302418	BT50-C32-110	211.8	110	35	32	68.5	M24x3.0	1875
302420	BT50-C32-135	236.8	135	35	32	68.5		2175
302422	BT50-C32-165	266.8	165	35	32	68.5		2625
302424	BT50-C32-200	301.8	200	35	32	68.5		3750
302426	BT50-C42-110	211.8	110	35	42	92		2250

## DAT-C

DAT-C MULTI-LOCK MILL CHUCK



Wrench : P02  
Collet : P05-P06  
Nut : P02  
Pull Stud : P03-P04  
Locking Device : P09

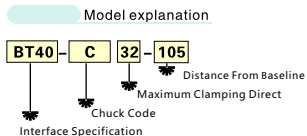

- Characteristic :**
- High precision work flow, even if the use of lengthened drill, concentricity is still in 0.015mm.
  - Suitable for flat tail type Morse taper shank drill.

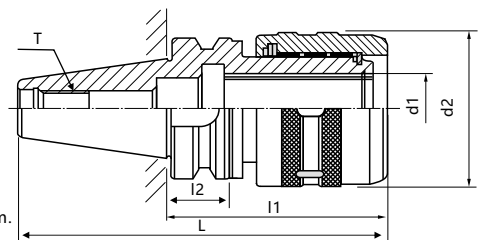
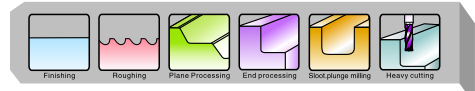

Order No.	Model	L	l1	l2	d1	d2	T	Price
302500	DAT30-C20-80	127.8	80	19.1	20	55	M12x1.75	3188
302502	DAT40-C20-80	148.4	80	19.1	32	68.5	M16x2.0	3269
302504	DAT40-C20-100	168.4	100	19.1	32	68.5		3269
302506	DAT40-C20-135	203.4	135	19.1	32	68.5		3269
302508	DAT40-C25-80	148.4	80	19.1	32	68.5		3269
302510	DAT40-C25-100	168.4	100	19.1	32	68.5		3269
302512	DAT40-C32-90	158.4	90	19.1	32	68.5		3269
302514	DAT40-C32-105	173.4	105	19.1	32	68.5	3556	
302516	DAT40-C32-135	203.4	135	19.1	32	68.5	4806	
302518	DAT50-C32-110	211.75	110	19.1	32	68.5	M24x3.0	3556
302520	DAT50-C32-135	236.75	135	19.1	32	68.5		4806
302522	DAT50-C32-165	266.75	165	19.1	32	68.5		5238
302524	DAT50-C32-200	301.75	200	19.1	32	68.5		5238
302526	DAT50-C42-110	211.75	110	19.1	42	92		5238

## BT-MLT

BT-MLT MULTI-LOCK MILL CHUCK

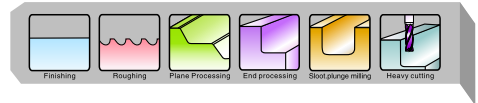

- Wrench : P02
- Collet : P05-P06
- Nut : P02
- Pull Stud : P03-P04
- Locking Device : P09

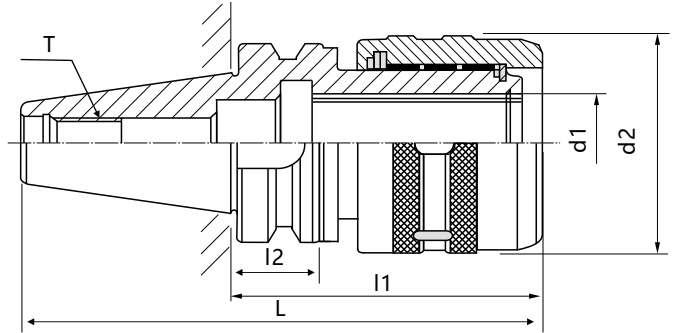

### Characteristic :

- Water proof and dust proof, clamping end contact.
- This design structure will not overtighten damage chuck.
- The sealed structure, to eliminate dirt and debris damage chuck.
- Dynamic balance can reach G6.38000RPM.
- Balance and speed can be based on customer requirements, but the need for a separate offer.

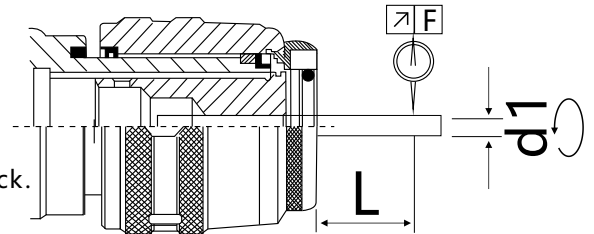

d1 END MILL DIAMETER	6	8	10	12	16	20	25	32	42
L END MILL LENGTH	25	30	30	40	40	50	50	60	60
F CONCENTRICITY	0.02								

L	MLT20	60
	MLT32	80
	MLT40	100
F CONCENTRICITY	0.001-0.005	

Order No.	Model	L	l1	d1	d2	WG	Price
302600	BT30-MLT20-75	123.4	75	20	55	1.8kg	2244
302602	BT30-MLT20-90	138.4	90			2.0kg	2294
302604	BT40-MLT20-80	145.4	80	20	55	2.3kg	2769
302606	BT40-MLT20-100	165.4	100			2.5kg	2844
302608	BT40-MLT20-135	200.4	135			2.7kg	3056
302610	BT40-MLT32-90	155.4	90	32	73	2.7kg	3050
302612	BT40-MLT32-105	170.4	105			3.0kg	3131
302614	BT40-MLT32-135	200.4	135			3.0kg	3338
302616	BT50-MLT20-105	206.4	105	20	55	4.5kg	4038
302618	BT50-MLT20-150	251.8	150			4.9kg	4556
302620	BT50-MLT32-110	211.8	110	32	73	5.2kg	4331
302622	BT50-MLT32-135	236.8	135			5.9kg	4594
302624	BT50-MLT32-165	266.8	165			6.6kg	4956
302626	BT50-MLT42-110	211.8	110	42	95	6.0kg	4756
302628	BT50-MLT42-130	231.8	130			6.5kg	5000
302630	BT50-MLT42-165	266.8	165			7.4kg	5425

## DAT-MLT

DAT-MLT MULTI-LOCK MILL CHUCK

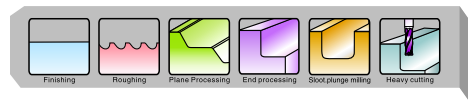

- Wrench : P02
- Collet : P05-P06
- Nut : P02
- Pull Stud : P03-P04
- Locking Device : P09

### Characteristic :

- Water proof and dust proof This design structure will not overtighten damage the chuck.
- The sealed structure, to eliminate dirt and debris damage chuck.
- Dynamic balance can reach G6.38000RPM.
- Balance and speed can be based on customer requirements, but the need for a separate offer.

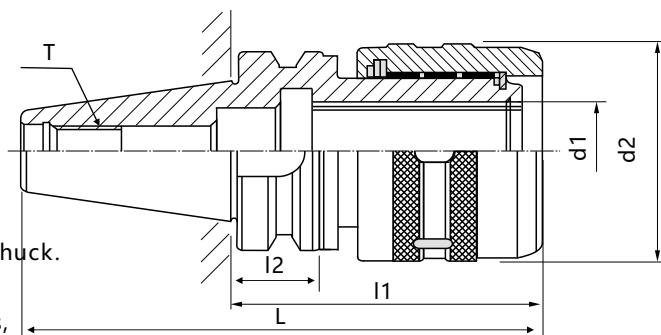

d1 END MILL DIAMETER	6	8	10	12	16	20	25	32	42
L END MILL LENGTH	25	30	30	40	40	50	50	60	60
F CONCENTRICITY	0.02								

L	MLT20	60
	MLT32	80
	MLT40	100
F CONCENTRICITY	0.001~0.005	

Order No.	Model	L	l1	d1	d2	WG	Price
302700	DAT30-MLT20-85	132.8	85	20	55	1.9kg	2150
302702	DAT30-MLT20-100	147.8	100			2.1kg	2188
302704	DAT40-MLT20-85	153.4	85			2.4kg	2413
302706	DAT40-MLT20-100	168.4	100			2.5kg	2519
302708	DAT40-MLT20-135	203.4	135	32	73	2.8kg	2663
302710	DAT40-MLT32-105	173.4	105			2.7kg	2806
302712	DAT40-MLT32-135	203.4	135			3.0kg	2919
302714	DAT50-MLT20-105	206.75	105			4.5kg	3069
302716	DAT50-MLT20-150	251.75	150	20	55	4.9kg	3369
302718	DAT50-MLT32-105	206.75	105			5.1kg	3294
302720	DAT50-MLT32-135	236.75	135			5.9kg	3331
302722	DAT50-MLT40-110	211.75	110			42	95

## HSK-MLT

HSK-MLT MULTI-LOCK MILL CHUCK

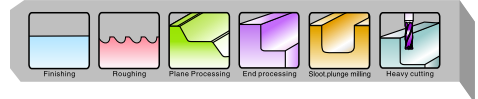

- Wrench : P02
- Collet : P05-P06
- Nut : P02
- Pull Stud : P03-P04
- Locking Device : P09

**Characteristic :**

- Water proof and dust proof This design structure will not overtighten damage the chuck.
- The sealed structure, to eliminate dirt and debris damage chuck.
- The tool is inserted into the inner hole of the Collet,
- which must exceed the effective clamping length of the inner hole of the Collet to avoid improper locking and damage.
- Be sure to use the correct Wrench to install, can not be arbitrarily changed to avoid improper locking, causing damage.
- Dynamic balance can reach G6.38000RPM.
- Balance and speed can be based on customer requirements, but the need for a separate offer.

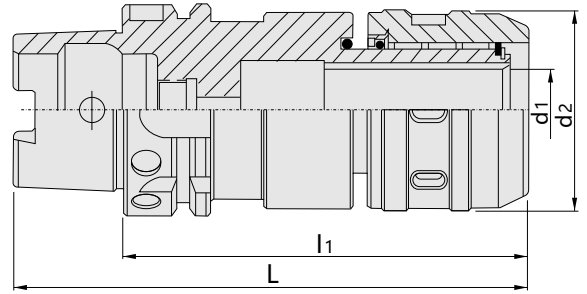

d1 END MILL DIAMETER	6	8	10	12	16	20	25	32	42
L END MILL LENGTH	25	30	30	40	40	50	50	60	60
F CONCENTRICITY	0.02								

L	MLT20	60
	MLT32	80
	MLT40	100
F CONCENTRICITY	0.001~0.005	

Order No.	Model	L	l1	d1	d2	WG	Price
302800	HSK50A-MLT20-120	140	120	20	55	1.62kg	2388
302802	HSK63A-MLT20-90	122	90			1.52kg	2556
302804	HSK63A-MLT20-120	152	120			1.68kg	2663
302806	HSK63A-MLT32-105	137	105	32	73	1.60kg	2838
302808	HSK63A-MLT32-120	152	120			1.76kg	2931
302810	HSK63A-MLT32-150	182	150			1.92kg	3025
302812	HSK63A-MLT42-135	167	135			1.82kg	4919

## NT-MLC

NT-MLC MULTI-LOCK MILL CHUCK



- Wrench : P02
- Collet : P05-P06
- Nut : P02
- Pull Stud : P03-P04
- Locking Device : P09

**Characteristic :**

- Fixed: use high strength brass holder guide roller bearing, the sliding more perfect.
- Oil: use a special hydraulic oil, no solidification.

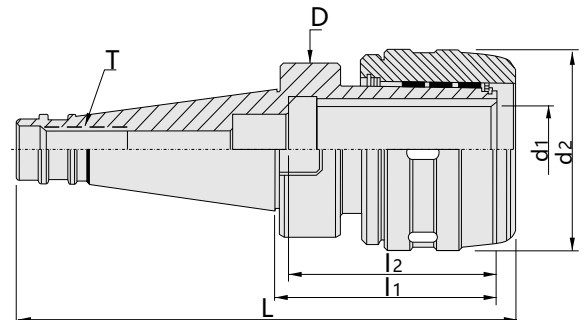

When ordering, please confirm the rod screw specifications for metric or imperial.

Unit:mm

Order No.	Model	L	l2	D	d1	d2	T	WG	Price
302900	NT30-MLC20-62.5	130.9	65	49	20	55	M12(M12*1.75P),A04(1/2"-12)	1.9kg	1781
302902	NT40-MLC20-62.5	155.9	70	63			M16(M16*2.0P),A06(5/8"-11)	2.3kg	2031
302904	R8-MLC20-62.5	163.5	85	55			7/16"-20	1.9kg	1806
302906	MTB4-MLC32-90	192.5	90	73	32	73	M16(M16*2.0P),A06(5/8"-11)	2.1kg	2381
302908	MTB5-MLC32-85	214.5	90	73			M24(M24*3.0P),A07(1"-8)	3.8kg	2506
302910	NT40-MLC32-79.6	173	90	63			M16(M16*2.0P),A06(5/8"-11)	2.6kg	2300
302912	NT50-MLC32-87.2	214	90	97.5			M24(M24*3.0P),A07(1"-8)	4.9kg	3413
302914	MTB4-MLC42-95	197.5	110	95	42	95	M16(M16*2.0P),A06(5/8"-11)	2.8kg	3481
302916	MTB5-MLC42-95	224.5	110	95			M24(M24*3.0P),A07(1"-8)	4.0kg	3888
302918	NT50-MLC42-86.2	213	110	97.5				5.8kg	3925

## NT-MCST

NT-MCST MILLING COLLETS CHUCK HOLDER



- Wrench : P02
- Collet : P05-P06
- Nut : P02
- Pull Stud : P03-P04
- Locking Device : P09

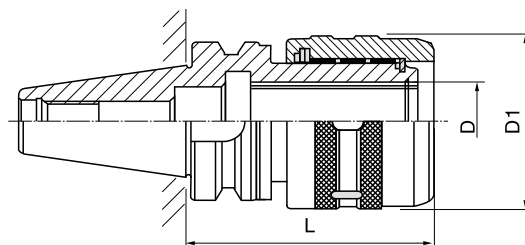

Order No.	Model	D	D1	L	Collet	Rod thread	N.W.	Price
303100	NT30-MCST20-80	20	52	80	ST20	M12(M12*1.75P) A04(1/2"-12)	1.5kg	2988
303102	NT30-MCST25-85	25	58	85	ST25		1.5kg	2988
303104	NT40-MCST20-80	20	52	80	ST20	M16(M16*2.0P) A06(5/8"-11)	2.0kg	3031
303106	NT40-MCST25-85	25	58	85	ST25		2.0kg	3031
303108	NT40-MCST32-95	32	75	95	ST32	M24(M24*3.0P) A07(1"-8)	2.6kg	3219
303110	NT50-MCST32-100	32	75	100	ST32		4.5kg	3869
303112	NT50-MCST42-110	42	87	110	ST42	5.5kg	4694	

## BT-MCST

BT-MCST MILLING COLLETS CHUCK HOLDER



- Wrench : P02
- Collet : P05-P06
- Nut : P02
- Pull Stud : P03-P04
- Locking Device : P09

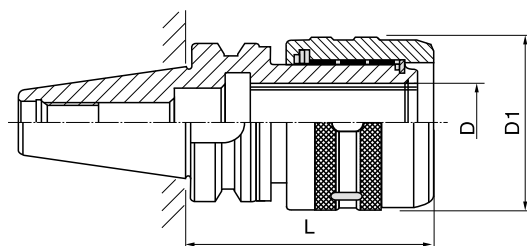

Order No.	Model	D	D1	L	Collet	N.W.	Price
303200	BT30-MCST20-85	20	52	85	ST20	1.5kg	3056
303202	BT40-MCST20-80	20	52	80	ST20	2.0kg	3069
303204	BT40-MCST20-120	20	52	120	ST20	2.8kg	3288
303206	BT40-MCST25-90	25	58	90	ST25	2.2kg	3069
303208	BT40-MCST25-135	25	58	135	ST32	2.9kg	3288
303210	BT40-MCST32-105	32	75	105	ST32	3.0kg	3294
303212	BT40-MCST32-150	32	75	150	ST32	3.5kg	3706
303214	BT50-MCST32-110	32	75	110	ST32	5.2kg	4150
303216	BT50-MCST32-150	32	75	150	ST32	7.0kg	4600
303218	BT50-MCST42-115	42	87	115	ST42	7.0kg	5000
303220	BT50-MCST42-150	42	87	150	ST42	8.5kg	5238



## DAT-MCST

DAT-MCST MILLING COLLETS CHUCK HOLDER



Wrench : P02  
 Collet : P05-P06  
 Nut : P02  
 Pull Stud : P03-P04  
 Locking Device : P09

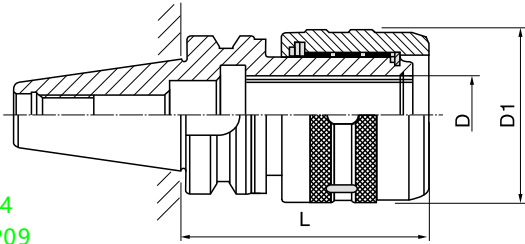

Order No.	Model	D	D1	L	Collet	N.W.	Price
303300	DAT30-MCST20-95	20	52	90	ST20	1.5kg	3188
303302	DAT40-MCST20-80	20	52	80	ST20	2.0kg	3269
303304	DAT40-MCST25-90	25	58	90	ST25	2.0kg	3269
303306	DAT40-MCST32-100	32	75	100	ST32	2.7kg	3556
303308	DAT50-MCST32-105	32	75	105	ST32	4.5kg	4806
303310	DAT50-MCST42-110	42	87	110	ST42	5.7kg	5238

## MCST COLLETS CHUCK KIT

### Set Metric Collet

ST20	6PCS	4, 6, 8, 10, 12, 16
ST25	7PCS	4, 6, 8, 10, 12, 16, 20
ST32	7PCS	6, 8, 10, 12, 16, 20, 25
ST42	8PCS	6, 8, 10, 12, 16, 20, 25, 32

Wrench : P02  
 Collet : P05-P06  
 Nut : P02  
 Pull Stud : P03-P04  
 Locking Device : P09



Order No.	Model	Collet	Rod thread	N.W.	Price
303400	NT30-MCST20-80-6PCS	ST20 6PCS	M12(M12*1.75P)	4.0kg	4188
303402	NT30-MCST25-85-7PCS	ST25 7PCS	A04(1/2"-12)	4.0kg	4388
303404	NT40-MCST20-80-6PCS	ST20 6PCS	M16(M16*2.0P)	4.5kg	4269
303406	NT40-MCST25-85-7PCS	ST25 7PCS		4.5kg	4469
303408	NT40-MCST32-95-7PCS	ST32 7PCS	A06(5/8"-11)	7.0kg	5069
303410	NT50-MCST32-100-7PCS	ST32 7PCS	M24(M24*3.0P)	9.0kg	5719
303412	NT50-MCST42-110-8PCS	ST42 8PCS		12.0kg	8075
303414	BT30-MCST20-85-6PCS	ST20 6PCS	A07(1"-8)	4.0kg	4256
303416	BT40-MCST20-80-6PCS	ST20 6PCS		4.5kg	4269
303418	BT40-MCST20-120-6PCS	ST20 6PCS		5.0kg	4481
303420	BT40-MCST25-90-7PCS	ST25 7PCS		4.7kg	4475
303422	BT40-MCST25-135-7PCS	ST25 7PCS		5.2kg	4688
303424	BT40-MCST32-105-7PCS	ST32 7PCS		7.0kg	5131
303426	BT50-MCST32-110-7PCS	ST32 7PCS		9.5kg	5869
303428	BT50-MCST42-115-8PCS	ST42 8PCS		13.0kg	8369
303430	DAT30-MCST20-95-6PCS	ST20 6PCS		4.0kg	4388
303432	DAT40-MCST20-80-6PCS	ST20 6PCS		4.5kg	4469
303434	DAT40-MCST25-90-7PCS	ST25 7PCS		4.8kg	4681
303436	DAT40-MCST32-100-7PCS	ST32 7PCS		7.2kg	5344
303438	DAT50-MCST32-105-7PCS	ST32 7PCS		9.1kg	6056
303440	DAT50-MCST42-110-8PCS	ST42 8PCS		12.0kg	8544

## BT-GER

BT-GER HIGH SPEED CHUCK

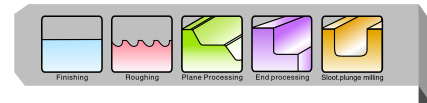

- Wrench : P02
- Collet : P05-P06
- Nut : P02
- Pull Stud : P03-P04
- Locking Device : P09

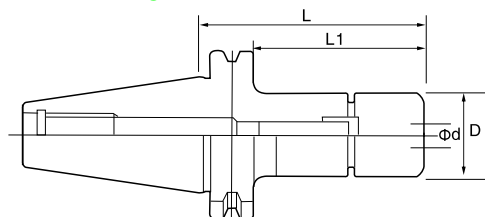

- ◆ High-speed carving and milling machine for tool holder
- ◆ Non-eccentric full balanced round nut.
- ◆ low noise, little wind resistance.

Order No.	Model	Φd	D	L	Price
303500	BT30-GER16-70	0.5-10.0	27.5	70	600
303502	BT30-GER20-70	1.0-13.0	30	70	600
303504	BT30-GER25-70	1.0-16.0	40	70	600
303506	BT30-GER16-100	0.5-10.0	27.5	100	600
303508	BT30-GER20-100	1.0-13.0	30	100	600
303510	BT30-GER25-100	1.0-16.0	40	100	600
303512	BT40-GER16-70	0.5-10.0	27.5	70	700
303514	BT40-GER20-70	1.0-13.0	30	70	700
303516	BT40-GER25-70	1.0-16.0	40	70	700
303518	BT40-GER16-100	0.5-10.0	27.5	100	700
303520	BT40-GER20-100	1.0-13.0	30	100	700
303522	BT40-GER25-100	1.0-16.0	40	100	700

## ISO-GER

ISO-GER ENGRAVING MACHINE HIGH SPEED CHUCK

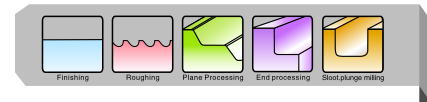

- Wrench : P02
- Collet : P05-P06
- Nut : P02
- Pull Stud : P03-P04
- Locking Device : P09

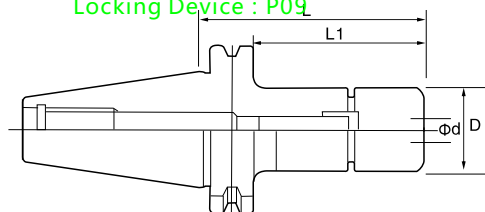

### Characteristic :

- High-speed carving and milling machine for tool holder
- Non-eccentric full balanced round nut.
- low noise, little wind resistance.

Order No.	Model	Φd	D	L	Price
303600	ISO25-GER16	2~10	27.5	42	1000
303602	ISO25-GER20	2~13	30	42	1000
303604	ISO30-GER16	2~10	27.5	55	700
303606	ISO30-GER20	2~13	30	55	700

## GER Wrench



Order No.	Model	Wrench Spanner aperture	Price
303700	BSGER16	27.5	400
303702	BSGER20	30	400
303704	BSGER25	40	400

Order No.	Model	φd	D	L	Price
303800	ER11	2,2.25,2.5,2.75,3,3.5,4,4.5,5,5.5,6	11.5	18.5	100
303802	ER16	2,2.25,2.5,2.75,3,3.5,4,4.5,5,5.5,6,6.5,7,7.5,8,8.5,9,9.5,10	17	27	100
303804	ER20	2,2.25,2.5,2.75,3,3.5,4,4.5,5,5.5,6,6.5,7,7.5,8,8.5,9,9.5,10,10.5,11,11.5,12,12.5,13,13.5,14,14.5,15,15.5,16	21	31	100

## BT-ER-A Type

BT-ER COLLET CHUCK A TYPE



- Wrench : P02
- Collet : P05-P06
- Nut : P02
- Pull Stud : P03-P04
- Locking Device : P09

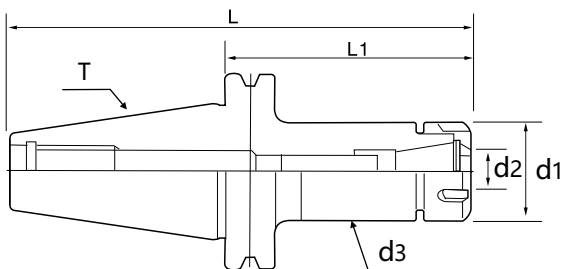

### Characteristic :

- Thread grinding.
  - ER16, ER20 fastening nut for outer six nut.
  - Extra strength nut.
  - Dynamic balance can reach G6.310000RPM.
- Balance and speed can be based on customer requirements,

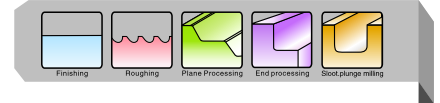

but the need for a separate offer.

Order No.	Model	L	d1	d2	d3	T	夹持范围 Clamping range	WG	Price
303900	BT30-ER16A-50	98.4	28	16	28	M10x1.5P	0.5-10.0	0.45kg	400
303902	BT30-ER16A-70	118.4	28	16	28			0.55kg	400
303904	BT30-ER16A-60	108.4	28	16	28			0.66kg	400
303906	BT30-ER16A-100	148.4	28	16	28			0.80kg	400
303908	BT30-ER16A-120	168.4	28	16	28			0.95kg	500
303910	BT30-ER20A-50	98.4	34	20	34	M12x1.75P	1.0-13.0	0.48kg	400
303912	BT30-ER20A-70	118.4	34	20	34			0.75kg	400
303914	BT30-ER20A-135	183.4	34	20	34	M16x2.0P	1.0-16.0	1.15kg	400
303916	BT30-ER25-70	118.4	42	25	42			0.70kg	400
303918	BT30-ER25-135	183.4	42	25	42			1.45kg	500
303920	BT30-ER32-70	118.4	50	32	45			0.85kg	400
303922	BT30-ER32-100	148.4	50	32	45	M16x2.0P	2.0-20.0	1.00kg	400
303924	BT30-ER40-80	128.4	63	40	53			3.0-26.0	1.10kg
303926	BT40-ER16A-70	135.4	28	16	28	M10x1.5P	0.5-10.0	1.20kg	400
303928	BT40-ER16A-100	165.4						1.30kg	400
303930	BT40-ER16A-125	190.4						1.36kg	450
303932	BT40-ER16A-150	215.4						1.54kg	500
303934	BT40-ER16A-180	245.4	34	20	34	M12x1.75P	1.0-13.0	2.00kg	550
303936	BT40-ER20A-70	135.4						1.40kg	400
303938	BT40-ER20A-100	165.4						1.50kg	400
303940	BT40-ER20A-135	200.4						1.70kg	450
303942	BT40-ER20A-150	215.4	42	25	42	M16x2.0P	1.0-16.0	1.80kg	500
303944	BT40-ER25-70	135.4						1.30kg	400
303946	BT40-ER25-100	165.4						1.50kg	400
303948	BT40-ER25-125	190.4						1.90kg	450
303950	BT40-ER25-150	215.4	50	32	45	M16x2.0P	2.0-20.0	2.25kg	500
303952	BT40-ER32-70	135.4						1.30kg	400
303954	BT40-ER32-100	165.4						1.70kg	400
303956	BT40-ER32-150	215.4	63	40	53	M20x2.0P	3.0-26.0	2.05kg	500
303958	BT40-ER40-80	145.4						1.50kg	500
303960	BT40-ER40-100	165.4						2.06kg	500
303962	BT40-ER40-120	185.4						2.5kg	550
303964	BT40-ER40-150	215.4	78	50	60	M24x2.0P	5.0-34.0	3.10kg	600
303966	BT40-ER50-85	150.4						1.70kg	700
303968	BT40-ER50-100	165.4						2.10kg	700
303970	BT50-ER16A-70	171.8	28	16	28	M10x1.5P	0.5-10.0	4.05kg	700
303972	BT50-ER16A-90	191.8						4.20kg	700
303974	BT50-ER16A-105	206.8						4.30kg	700
303976	BT50-ER16A-135	236.8						4.40kg	800
303978	BT50-ER16A-150	251.8						4.50kg	850
303980	BT50-ER16A-165	266.8	34	20	34	M12x1.75P	1.0-13.0	4.50kg	900
303982	BT50-ER20A-70	171.8						4.20kg	700
303984	BT50-ER20A-90	191.8						4.25kg	700
303986	BT50-ER20A-105	206.8						4.30kg	700
303988	BT50-ER20A-135	236.8						4.55kg	800
303990	BT50-ER20A-150	251.8	42	25	42	M16x2.0P	2.0-20.0	4.70kg	850
303992	BT50-ER20A-165	266.8						4.80kg	900
303994	BT50-ER20A-200	301.8						4.90kg	1000
303996	BT50-ER25-70	171.8						4.20kg	700
303998	BT50-ER25-105	206.8	50	40	50	M20x2.0P	3.0-26.0	4.40kg	700
304000	BT50-ER25-135	236.8						4.70kg	800
304002	BT50-ER25-165	266.8	63	40	63	M24x2.0P	5.0-34.0	5.00kg	850
304004	BT50-ER32-80	181.8						4.70kg	700
304006	BT50-ER32-100	201.8						4.80kg	700
304008	BT50-ER32-120	221.8						4.90kg	800
304010	BT50-ER32-150	251.8	78	50	78	M24x2.0P	5.0-34.0	5.30kg	800
304012	BT50-ER32-200	301.8						5.50kg	1000
304014	BT50-ER40-80	181.8						4.30kg	800
304016	BT50-ER40-100	201.8	78	50	78	M24x2.0P	5.0-34.0	4.40kg	800
304018	BT50-ER40-120	221.8						5.20kg	900
304020	BT50-ER40-135	236.8						5.50kg	1000
304022	BT50-ER50-90	191.8						4.60kg	1000
304024	BT50-ER50-120	221.8	78	50	78	M24x2.0P	5.0-34.0	5.50kg	1100
304026	BT50-ER50-165	266.8						6.10kg	1200

## BT-ER-M Type

BT-ER COLLET CHUCK M TYPE

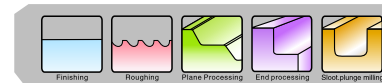

### Characteristic :

- M type knife rod adopts small diameter Nut to avoid interference.
  - The tool is inserted into the inner hole of the Collet, which must exceed the effective clamping length of the Collet hole, Avoid improper locking, damage.
  - Be sure to use the correct Wrench to install, can not be arbitrarily changed, to avoid improper Lock, cause damage.
  - Dynamic balance can reach G6.310000RPM.
- Balance and speed can be based on customer requirements, but the need for a separate offer.

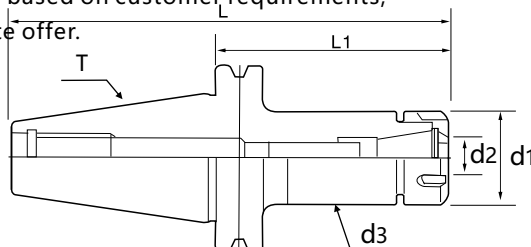

- Wrench : P02
- Collet : P05-P06
- Nut : P02
- Pull Stud : P03-P04
- Locking Device : P09

Order No.	Model	L	L1	d1	d2	d3	T	Clamping range	WG	Price						
304100	BT30-ER11M-70	118.4	6.6	16	11	15	M6x1.0P	0.5~7.0	0.50kg	500						
304102	BT30-ER11M-100	148.4							0.60kg	535						
304104	BT30-ER11M-120	168.4							0.70kg	580						
304106	BT30-ER16M-70	118.4	10.6	22	16	21	M10x1.5P	0.5~10.0	0.55kg	500						
304108	BT30-ER16M-100	148.4							0.65kg	535						
304110	BT30-ER16M-120	168.4							0.75kg	600						
304112	BT30-ER20M-70	118.4	11.5	28	20	27	M12x1.75P	1.0~13.0	0.65kg	505						
304114	BT30-ER20M-100	148.4							0.70kg	540						
304116	BT30-ER20M-120	168.4							0.80kg	615						
304118	BT30-ER20M-150	198.4							1.00kg	700						
304120	BT40-ER11M-70	135.4	6.6	16	11	15	M6x1.0P	0.5~7.0	1.10kg	545						
304122	BT40-ER11M-100	165.4							1.20kg	585						
304124	BT40-ER11M-125	190.4							1.40kg	880						
304126	BT40-ER11M-150	215.4							1.50kg	960						
304128	BT40-ER16M-70	135.4							1.20kg	550						
304130	BT40-ER16M-100	165.4	10.6	22	16	21	M10x1.5P	0.5~10.0	1.30kg	585						
304132	BT40-ER16M-125	190.4							1.50kg	900						
304134	BT40-ER16M-150	215.4							1.60kg	995						
304136	BT40-ER20M-70	135.4							1.20kg	550						
304138	BT40-ER20M-100	165.4	11.5	28	20	27	M12x1.75P	1.0~13.0	1.55kg	590						
304140	BT40-ER20M-125	190.4							1.70kg	930						
304142	BT40-ER20M-150	215.4							1.80kg	1,030						
304144	BT50-ER11M-70	171.8							6.6	16	11	15	M6x1.0P	0.5~7.0	3.80kg	1,585
304146	BT50-ER11M-90	191.8													3.90kg	1,635
304148	BT50-ER11M-105	206.8	4.00kg	1,705												
304150	BT50-ER11M-135	236.8	4.10kg	1,560												
304152	BT50-ER11M-165	266.8	4.20kg	1,615												
304154	BT50-ER16M-70	171.8	10.6	22	16	21	M10x1.5P	0.5~10.0							3.90kg	1,580
304156	BT50-ER16M-90	191.8							4.00kg	1,645						
304158	BT50-ER16M-105	206.8							4.10kg	1,735						
304160	BT50-ER16M-135	236.8							4.20kg	1,590						
304162	BT50-ER16M-165	266.8							4.30kg	1,635						
304164	BT50-ER20M-90	191.8							11.5	28	20	27	M12x1.75P	1.0~13.0	4.10kg	1,655
304166	BT50-ER20M-105	206.8													4.20kg	1,750
304168	BT50-ER20M-135	236.8													4.40kg	1,605
304170	BT50-ER20M-165	266.8	4.60kg	1,655												

## BT-ER Handle Set

BT-ER COLLET CHUCK GROUP

- Wrench : P02
- Collet : P05-P06
- Nut : P02
- Pull Stud : P03-P04
- Locking Device : P09



Order No.	Model	Set Range	Collet	N.W.	Price
304200	BT30-ER16-60-10PCS	1-10	ER16 10PCS	1.90kg	
304202	BT30-ER16-100-10PCS	1-10	ER16 10PCS	2.00kg	
304204	BT30-ER20-60-12PCS	2-13	ER20 12PCS	2.50kg	
304206	BT30-ER20-100-12PCS	2-13	ER20 12PCS	2.60kg	
304208	BT30-ER25-60-15PCS	2-16	ER25 15PCS	2.50kg	
304210	BT30-ER25-60-7PCS	4-16	ER25 7PCS	2.80kg	
304212	BT30-ER32-60-18PCS	3-20	ER32 18PCS	4.40kg	
304214	BT30-ER32-60-11PCS	4-20	ER32 11PCS	3.80kg	
304216	BT30-ER32-60-6PCS	6-20	ER32 6PCS	3.40kg	
304218	BT40-ER16-70-10PCS	1-10	ER16 10PCS	2.30kg	
304220	BT40-ER16-100-10PCS	1-10	ER16 10PCS	2.70kg	
304222	BT40-ER20-70-12PCS	2-13	ER20 12PCS	2.80kg	
304224	BT40-ER20-100-12PCS	2-13	ER20 12PCS	3.00kg	
304226	BT40-ER25-70-15PCS	2-16	ER25 15PCS	3.20kg	
304228	BT40-ER25-70-7PCS	4-16	ER25 7PCS	3.00kg	
304230	BT40-ER32-70-18PCS	3-20	ER32 18PCS	5.20kg	
304232	BT40-ER32-70-11PCS	4-20	ER32 11PCS	4.20kg	
304234	BT40-ER32-70-6PCS	6-20	ER32 6PCS	3.80kg	
304236	BT40-ER40-80-23PCS	4-26	ER40 23PCS	8.90kg	
304238	BT40-ER40-80-15PCS	4-26	ER40 15PCS	7.60kg	
304240	BT40-ER40-80-7PCS	6-25	ER40 7PCS	4.50kg	
304242	BT40-ER50-90-12PCS	12-34	ER50 12PCS	9.00kg	
304244	BT50-ER32-100-18PCS	3-20	ER32 18PCS	7.50kg	
304246	BT50-ER40-100-23PCS	4-26	ER40 23PCS	11.3kg	
304248	BT50-ER40-100-15PCS	4-26	ER40 15PCS	10.0kg	
304250	BT50-ER50-100-12PCS	12-34	ER50 12PCS	12.0kg	



# Milling System

## DAT-ER

DAT-ER COLLET CHUCK



- Wrench : P02
- Collet : P05-P06
- Nut : P02
- Pull Stud : P03-P04
- Locking Device : P09

**Characteristic :**

- Thread by precision grinding, can clamp the straight handle and tools.
- ER16, ER20 fastening Nut for outer six angle Nut.
- ER25, ER32, ER40, ER50 with a standard nut,
- Extra strength nut.
- Dynamic balance can reach G6.310000RPM.
- Balance and speed can be based on customer requirements, but the need for a separate offer.

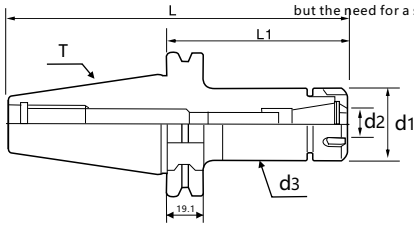

- Wrench : P02
- Collet : P05-P06
- Nut : P02
- Pull Stud : P03-P04
- Locking Device : P09

**Characteristic :**

- M type knife rod adopts small diameter Nut to avoid interference.
- The tool is inserted into the inner hole of the Collet, which must exceed the effective clamping length of the inner hole of the Collet to avoid improper locking and damage.
- Be sure to use the correct Wrench to install, can not be arbitrarily changed to avoid improper locking, causing damage.
- Dynamic balance can reach G6.310000RPM.

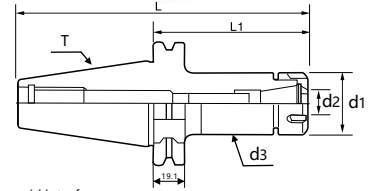

Balance and speed can be based on customer requirements, but the need for a separate offer.

Order No.	Model	L	d1	d2	T	Clamping range	WG	Price
304300	DAT30-ER11A-80	127.8	19	11	M6x1.0P	0.5~7.0	0.60kg	605
304302	DAT30-ER16A-63	110.8	28	16	M10x1.5P	0.5~10.0	0.70kg	600
304304	DAT30-ER16A-120	167.8					0.85kg	680
304306	DAT30-ER20A-63	110.8	34	20	M12x1.75P	1.0~13	0.80kg	615
304308	DAT30-ER20A-120	167.8					1.05kg	690
304310	DAT30-ER25-63	110.8	42	25	M16x2.0P	1.0~16	0.85kg	640
304312	DAT30-ER25-120	167.8	50	32		2.0~20	0.90kg	695
304400	DAT40-ER11A-80	127.8	19	11	M16x1.0P	0.5~7.0	1.05kg	750
304402	DAT40-ER11A-125	193.4					1.15kg	810
304404	DAT40-ER16A-70	138.4					1.30kg	690
304406	DAT40-ER16A-100	168.4					1.40kg	795
304408	DAT40-ER16A-125	193.4	28	16	M10x1.5P	0.5~10.0	1.60kg	845
304410	DAT40-ER16A-150	218.4					1.65kg	910
304412	DAT40-ER16A-180	248.4					1.85kg	935
304414	DAT40-ER20A-70	138.4					1.40kg	850
304416	DAT40-ER20A-100	168.4	34	20	M12x1.75P	1.0~13	1.50kg	810
304418	DAT40-ER20A-135	203.4					1.95kg	880
304420	DAT40-ER20A-160	228.4					2.20kg	970
304422	DAT40-ER25-70	138.4					1.60kg	825
304424	DAT40-ER25-100	168.4					1.85kg	870
304426	DAT40-ER25-150	218.4	42	25	M16x2.0P	1.0~16.0	2.25kg	980
304428	DAT40-ER25-180	248.4					2.45kg	1065
304430	DAT40-ER25-200	268.4					2.55kg	1115
304432	DAT40-ER32-70	138.4					1.60kg	855
304434	DAT40-ER32-100	168.4					2.00kg	915
304436	DAT40-ER32-135	203.4	50	32	M16x2.0P	2.0~20.0	2.15kg	980
304438	DAT40-ER32-150	218.4					2.65kg	1025
304440	DAT40-ER40-70	138.4					1.50kg	950
304442	DAT40-ER40-100	168.4	53	40	M20x2.0P	3.0~26.0	2.00kg	1005
304444	DAT40-ER40-135	218.4					2.30kg	1075
304446	DAT40-ER50-100	168.4	78	50	M24x2.0P	5.0~34.0	1.70kg	1200
304500	DAT50-ER16A-100	201.75					3.20kg	1475
304502	DAT50-ER16A-135	236.75	28	16	M10x1.5P	0.5~10.0	4.30kg	1605
304504	DAT50-ER16A-160	261.75					4.50kg	1725
304506	DAT50-ER16A-180	281.75					4.80kg	1830
304508	DAT50-ER20A-100	201.75					3.40kg	1445
304510	DAT50-ER20A-135	236.75	34	20	M12x1.75P	1.0~13.0	3.60kg	1605
304512	DAT50-ER20A-160	261.75					3.80kg	1725
304514	DAT50-ER25-70	171.75					3.40kg	1355
304516	DAT50-ER25-100	201.75					4.15kg	1480
304518	DAT50-ER25-150	251.75	42	25	M16x2.0P	1.0~16.0	4.50kg	1750
304520	DAT50-ER25-200	301.75					4.70kg	1965
304522	DAT50-ER32-80	181.75					3.60kg	1430
304524	DAT50-ER32-120	221.75					4.60kg	1650
304526	DAT50-ER32-160	261.75	50	32	M20x2.0P	2.0~20.0	4.75kg	1820
304528	DAT50-ER32-200	301.75					4.90kg	2005
304530	DAT50-ER40-80	181.75					3.65kg	1525
304532	DAT50-ER40-120	221.75	63	40	M20x2.0P	3.0~26.0	4.80kg	1745
304534	DAT50-ER40-160	261.75					5.20kg	1925
304536	DAT50-ER40-200	301.75					5.40kg	2105
304538	DAT50-ER50-80	181.75					4.85kg	1690
304540	DAT50-ER50-120	221.75					5.45kg	1895
304542	DAT50-ER50-160	261.75	78	50	M24x2.0P	5.0~34.0	5.55kg	2065
304544	DAT50-ER50-200	301.75					5.70kg	2250

Order No.	Model	L	d1	d2	d3	T	Clamping range	WG	Price
304600	DAT30-ER11M-70	117.8						0.50kg	875
304602	DAT30-ER11M-100	147.8	16	11	15	M6x1.0P	0.5~7.0	0.60kg	945
304604	DAT30-ER11M-120	167.8						0.70kg	995
304606	DAT30-ER16M-70	117.8						0.55kg	900
304608	DAT30-ER16M-100	147.8	22	16	21	M10x1.5P	0.5~10.0	0.65kg	975
304610	DAT30-ER16M-120	167.8						0.75kg	1025
304612	DAT30-ER20M-100	147.8						0.70kg	985
304614	DAT30-ER20M-120	167.8	28	20	27	M12x1.75P	1.0~13.0	0.80kg	1040
304616	DAT30-ER20M-150	197.8						1.00kg	1175
304618	DAT40-ER11M-70	138.4						1.10kg	1100
304620	DAT40-ER11M-100	168.4	16	11	15	M6x1.0P	0.5~7.0	1.20kg	1190
304622	DAT40-ER11M-125	193.4						1.40kg	1300
304624	DAT40-ER11M-150	218.4						1.50kg	1420
304626	DAT40-ER16M-70	138.4						1.20kg	1160
304628	DAT40-ER16M-100	168.4	22	16	21	M10x1.5P	0.5~10.0	1.30kg	1250
304630	DAT40-ER16M-125	193.4						1.50kg	1355
304632	DAT40-ER16M-150	218.4						1.60kg	1415
304634	DAT40-ER20M-70	138.4						1.20kg	1135
304636	DAT40-ER20M-100	168.4	28	20	27	M12x1.75P	1.0~13.0	1.55kg	1245
304638	DAT40-ER20M-125	193.4						1.70kg	1340
304640	DAT40-ER20M-150	218.4						1.80kg	1470
304700	DAT50-ER11M-70	171.75						3.8kg	2010
304702	DAT50-ER11M-90	191.75						3.9kg	2140
304704	DAT50-ER11M-105	206.75	16	11	15	M6x1.0P	0.5~7.0	4.0kg	2020
304706	DAT50-ER11M-135	236.75						4.1kg	2210
304708	DAT50-ER11M-165	266.75						4.2kg	2410
304710	DAT50-ER16M-70	171.75						3.9kg	2020
304712	DAT50-ER16M-90	191.75						4.0kg	2155
304714	DAT50-ER16M-105	206.75	22	16	21	M10x1.5P	0.5~10.0	4.1kg	2025
304716	DAT50-ER16M-135	236.75						4.2kg	2220
304718	DAT50-ER16M-165	266.75						4.3kg	2445
304720	DAT50-ER20M-90	191.75						4.1kg	2145
304722	DAT50-ER20M-105	206.75	28	20	27	M12x1.75P	1.0~13.0	4.2kg	2040
304724	DAT50-ER20M-135	236.75						4.4kg	2235
304726	DAT50-ER20M-165	266.75						4.6kg	2435

### DAT/ER Milling chuck group



Order No.	Model	Set Range	Collet	N.W	Price
304800	DAT30-ER16-60-10PCS	1-10	ER16 10PCS	1.80kg	
304802	DAT30-ER20-60-12PCS	2-13	ER20 12PCS	2.40kg	
304804	DAT30-ER25-60-15PCS	2-16	ER25 15PCS	2.70kg	
304806	DAT30-ER32-60-18PCS	3-20	ER32 18PCS	4.20kg	
304808	DAT40-ER16-70-10PCS	1-10	ER16 10PCS	2.20kg	
304810	DAT40-ER20-70-12PCS	2-13	ER20 12PCS	2.70kg	
304812	DAT40-ER25-70-15PCS	2-16	ER25 15PCS	3.10kg	
304814	DAT40-ER32-70-18PCS	3-20	ER32 18PCS	5.20kg	
304816	DAT40-ER40-80-23PCS	4-26	ER40 23PCS	8.90kg	
304818	DAT40-ER40-80-15PCS	4-26	ER40 15PCS	7.00kg	
304820	DAT50-ER32-100-18PCS	3-20	ER32 18PCS	7.00kg	
304822	DAT50-ER40-100-15PCS	4-26	ER40 15PCS	9.50kg	
304824	DAT50-ER50-100-23PCS	4-26	ER50 23PCS	11.3kg	

## HSK-ER

HSK-ER COLLET CHUCK



**Characteristic :**

- The rotation of the cutter rod is detected by the balancing machine.
- The rotary balance of the cutter can reach G2.525000RPM.
- Can hold any kind of diameter cutter and tool.
- Balance and speed can be based on customer requirements, without the need for a separate offer.

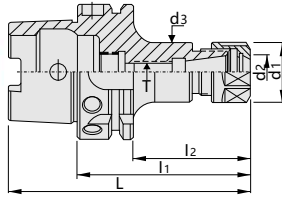

- Wrench : P02
- Collet : P05-P06
- Nut : P02
- Pull Stud : P03-P04
- Locking Device : P09

Order No.	Model	L	L2	d1	d2	d3	T	WG	Price
304900	HSK40A-ER20A-80	100	60	34	20	32	M10x1.5P	0.35kg	1010
304902	HSK40A-ER25-80	100	60	42	25		M10x1.5P	0.40kg	1035
304904	HSK50A-ER16A-80	105	54	28	16	32	M10x1.5P	0.50kg	1145
304906	HSK50A-ER16A-100	125	74				M10x1.5P	0.55kg	1225
304908	HSK50A-ER16A-120	145	94	34	20	42	M12x1.75P	0.70kg	1295
304910	HSK50A-ER20A-80	105	54				M12x1.75P	0.60kg	1165
304912	HSK50A-ER20A-100	125	74	50	32	42	M16x2.0P	0.70kg	1335
304914	HSK50A-ER20A-120	145	94				M16x2.0P	0.90kg	1370
304916	HSK50A-ER25-80	105	54	42	25	50	M16x2.0P	0.70kg	1205
304918	HSK50A-ER25-100	125	74				M16x2.0P	0.80kg	1270
304920	HSK50A-ER25-135	160	109	50	32	53	M16x2.0P	1.35kg	1330
304922	HSK50A-ER32-100	125	74				M16x2.0P	1.50kg	1445
304924	HSK50A-ER32-135	160	109	28	16	53	M10x1.5P	1.70kg	1550
304926	HSK50A-ER32-160	185	134				M10x1.5P	1.50kg	1395
304928	HSK63A-ER16A-80	112	54	42	25	53	M10x1.5P	1.55kg	1490
304930	HSK63A-ER16A-100	132	74				M10x1.5P	1.70kg	1580
304932	HSK63A-ER16A-120	152	94	34	20	53	M12x1.75P	1.90kg	1790
304934	HSK63A-ER16A-160	192	134				M12x1.75P	1.60kg	1405
304936	HSK63A-ER20A-80	112	54	63	40	53	M20x2.0P	1.70kg	1505
304938	HSK63A-ER20A-100	132	74				M20x2.0P	1.80kg	1605
304940	HSK63A-ER20A-120	152	94	78	50	53	M24x2.0P	2.00kg	1810
304942	HSK63A-ER20A-160	192	134				M24x2.0P	1.70kg	1440
304944	HSK63A-ER25-80	112	54	42	25	53	M16x2.0P	1.80kg	1525
304946	HSK63A-ER25-100	132	74				M16x2.0P	2.00kg	1610
304948	HSK63A-ER25-120	152	94	50	32	53	M16x2.0P	2.30kg	1780
304950	HSK63A-ER25-150	182	124				M16x2.0P	2.50kg	1495
305000	HSK63A-ER32-80	112	54	63	40	53	--	2.55kg	1595
305002	HSK63A-ER32-100	132	74				M16x2.0P	2.70kg	1805
305004	HSK63A-ER32-145	177	119	78	50	53	M16x2.0P	3.10kg	1890
305006	HSK63A-ER32-160	192	134				M16x2.0P	2.65kg	1620
305008	HSK63A-ER40-80	112	54	63	40	53	--	2.70kg	1710
305010	HSK63A-ER40-100	132	74				M20x2.0P	2.77kg	1810
305012	HSK63A-ER40-120	152	94	78	50	53	M20x2.0P	2.95kg	1940
305014	HSK63A-ER40-150	182	124				M20x2.0P	3.10kg	2055
305016	HSK63A-ER40-170	202	144	85	20	53	M24x2.0P	3.50kg	2050
305018	HSK63A-ER50-120	152	94				M24x2.0P	2.90kg	2670
305020	HSK100A-ER16A-80	130	51	28	16	85	M10x1.5P	2.95kg	2885
305022	HSK100A-ER16A-100	150	71				M10x1.5P	3.45kg	3555
305024	HSK100A-ER16A-160	210	131	34	20	85	M12x1.75P	2.90kg	2660
305026	HSK100A-ER20A-80	130	51				M12x1.75P	3.00kg	2890
305028	HSK100A-ER20A-100	150	71	42	25	85	M16x2.0P	3.30kg	3770
305030	HSK100A-ER20A-80	210	131				M16x2.0P	3.00kg	2915
305032	HSK100A-ER25-100	150	71	50	32	85	M16x2.0P	3.20kg	3255
305034	HSK100A-ER25-130	180	101				M16x2.0P	3.15kg	2975
305036	HSK100A-ER32-100	150	71	63	40	85	M16x2.0P	3.35kg	3420
305038	HSK100A-ER32-130	185	106				M16x2.0P	3.50kg	3525
305040	HSK100A-ER32-160	200	121	78	50	85	M20x2.0P	3.30kg	2870
305042	HSK100A-ER40-80	130	51				M20x2.0P	3.38kg	3295
305044	HSK100A-ER40-120	170	91	78	50	85	M24x2.0P	4.20kg	3935
305046	HSK100A-ER40-175	225	146				M24x2.0P	4.50kg	3185
305048	HSK100A-ER50-100	150	71	170	91	85	M24x2.0P	5.00kg	3410
305050	HSK100A-ER50-120	170	91				M24x2.0P		

## NT-ER

NT-ER COLLET CHUCK



**Characteristic :**

- Steel: SCM-21
- At the end of the body, there is a plastic ring that protects the spindle from damage.
- Can be purchased separately, each lock has a clamping Nut, but not attached to Wrench.

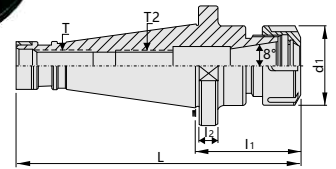

- Wrench : P02
- Collet : P05-P06
- Nut : P02
- Pull Stud : P03-P04
- Locking Device : P09

When ordering, please confirm the rod screw specifications for metric or imperial.

Unit:mm

Order No.	Model	L	l2	d1	t2	T	WG	Price
305100	NT30-ER16A-45	111.4	8	28	M10x1.5P	M12(M12*1.75P)	0.50kg	635
305102	NT30-ER20A-45	113.4		34	M12x1.75P		0.60kg	645
305104	NT30-ER25-55	123.4	8	42	M16x2.0P	A04(1/2"-12)	0.65kg	695
305106	NT30-ER32-60	128.4		50			0.80kg	750
305108	NT30-ER40-75	143.4	10	63	M16x2.0P	M16(M16*2.0P)	0.90kg	870
305110	NT40-ER16A-45	138.4		28			M10x1.5P	0.95kg
305112	NT40-ER20A-45	138.4	10	34	M12x1.75P	A06(5/8"-11)	1.20kg	805
305114	NT40-ER25-55	148.4		42	M16x2.0P		1.25kg	850
305116	NT40-ER32-60	153.4	12	50	M24x2.0P	M24(M24*3.0P)	1.30kg	870
305118	NT40-ER40-70	163.4		63			M20x2.0P	1.35kg
305120	NT40-ER50-80	173.4	12	78	M24x2.0P	A07(1"-8)	2.00kg	1,255
305122	NT50-ER32-75	201.8		50			M16x2.0P	3.20kg
305124	NT50-ER40-80	206.8	12	63	M24x2.0P	A07(1"-8)	3.40kg	1,815
305126	NT50-ER50-80	206.8		78			M24x2.0P	3.70kg

## NT/ER Milling chuck group



Order No.	Model	Set Range	Collet	Draw Bar	N.W.	Price
305200	NT30-ER16-76-10PCS	1-10	ER16 10PCS	M12(M12*1.75P)	1.70kg	
305202	NT30-ER16-76-12PCS	2-13	ER16 12PCS		A04(1/2"-12)	1.80kg
305204	NT30-ER25-55-15PCS	2-16	ER25 15PCS	M12(M12*1.75P)	2.80kg	
305206	NT30-ER25-55-7PCS	4-16	ER25 7PCS		A04(1/2"-12)	2.40kg
305208	NT30-ER32-55-18PCS	3-20	ER32 18PCS	M12(M12*1.75P)	4.20kg	
305210	NT30-ER32-55-11PCS	4-20	ER32 11PCS		A04(1/2"-12)	3.20kg
305212	NT30-ER32-55-6PCS	6-20	ER32 6PCS	M12(M12*1.75P)	2.80kg	
305214	NT30-ER40-70-23PCS	4-26	ER40 23PCS		A05(1/2"-13)	7.30kg
305216	NT30-ER40-70-15PCS	4-26	ER40 15PCS	M16(M16*2.0P)	6.00kg	
305218	NT30-ER40-70-7PCS	6-25	ER40 7PCS		A06(5/8"-11)	4.60kg
305220	NT40-ER16-76-10PCS	1-10	ER16 10PCS	M16(M16*2.0P)	2.40kg	
305222	NT40-ER20-76-12PCS	2-13	ER20 12PCS		A06(5/8"-11)	2.50kg
305224	NT40-ER25-50-15PCS	2-16	ER25 15PCS	M16(M16*2.0P)	3.30kg	
305226	NT40-ER25-50-7PCS	4-16	ER25 7PCS		A06(5/8"-11)	3.00kg
305228	NT40-ER32-50-18PCS	3-20	ER32 18PCS	M16(M16*2.0P)	4.80kg	
305230	NT40-ER32-50-11PCS	4-20	ER32 11PCS		A06(5/8"-11)	3.80kg
305232	NT40-ER32-50-6PCS	6-20	ER32 6PCS	M16(M16*2.0P)	3.40kg	
305234	NT40-ER40-60-23PCS	4-26	ER40 23PCS		A06(5/8"-11)	8.20kg
305236	NT40-ER40-60-15PCS	4-26	ER40 15PCS	M24(M24*3.0P)	6.90kg	
305238	NT40-ER40-60-7PCS	6-25	ER40 7PCS		A07(1"-8)	5.20kg
305240	NT40-ER50-80-12PCS	12-34	ER50 12PCS	M24(M24*3.0P)	10.0kg	
305242	NT50-ER32-60-18PCS	3-20	ER32 18PCS		A07(1"-8)	6.40kg
305244	NT50-ER32-60-11PCS	4-20	ER32 11PCS	M24(M24*3.0P)	5.40kg	
305246	NT50-ER32-60-6PCS	6-20	ER32 6PCS		A07(1"-8)	5.00kg
305248	NT50-ER40-65-23PCS	4-26	ER40 23PCS	M24(M24*3.0P)	9.80kg	
305250	NT50-ER40-65-15PCS	4-26	ER40 15PCS		A07(1"-8)	8.50kg
305252	NT50-ER40-65-7PCS	6-25	ER40 7PCS	M24(M24*3.0P)	7.00kg	
305254	NT50-ER50-65-12PCS	12-34	ER50 12PCS		A07(1"-8)	11.0kg

# Milling System

## MT-ER

MT-ER COLLET CHUCK

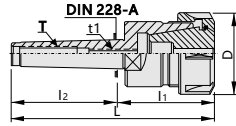

Order No.	Model	L	D	l2	t1	T Pull rod specification	N.W.	Price
305300	MTB2-ER20A-52	116	35	64	M10x1.5P	M10(M10*1.5P)	0.45kg	590
305302	MTB2-ER25-55	119	42			A02(3/8"-16)	0.50kg	685
305304	MTB3-ER25-55	136	42				0.60kg	705
305306	MTB3-ER32-60	141	50	81	M12x1.75P	M12(M12*1.75P)	0.80kg	825
305308	MTB3-ER40-70	151	63			A04(1/2"-12)	1.30kg	1130
305310	MTB4-ER32-60	162.5	50	102.5	M16x2.0P	M16(M16*2.0P)	0.95kg	885
305312	MTB4-ER40-70	172.5	63			A06(5/8"-11)	1.50kg	1205

Unit:mm

## R8-ER

R8-ER COLLET CHUCK



R8/ER Collet Holder

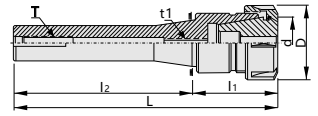

Order No.	Model	L	D	d	l2	t1	T Pull rod specification	N.W.	Price
305500	R8-ER16A-38	135	28	16		M10x1.5P		0.65kg	755
305502	R8-ER32-60	162	50	32	102	M12x1.75P	7/16"-20	0.90kg	895
305504	R8-ER40-65	168	63	40		M16x2.0P		1.10kg	1120

Unit:mm

## MT/ER Milling chuck group



Order No.	Model	Set Range	Collet	T Pull rod specification	N.W.	Price
305400	MTB2-ER16-40-10PCS	1-10	ER16 10PCS	M10(M10*1.5P)	1.05kg	
305402	MTB2-ER20-43-12PCS	2-13	ER20 12PCS		1.30kg	
305404	MTB2-ER25-47-15PCS	2-16	ER25 15PCS		2.40kg	
305406	MTB2-ER25-47-7PCS	4-16	ER25 7PCS		2.00kg	
305408	MTB3-ER16-40-10PCS	1-10	ER16 10PCS	M12(M12*1.75P)	1.15kg	
305410	MTB3-ER20-43-12PCS	2-13	ER20 12PCS		1.35kg	
305412	MTB3-ER25-47-15PCS	2-16	ER25 15PCS		2.50kg	
305414	MTB3-ER25-47-7PCS	4-16	ER25 7PCS		2.10kg	
305416	MTB3-ER32-70-18PCS	3-20	ER32 18PCS	M10(M10*1.5P)	4.10kg	
305418	MTB3-ER32-70-11PCS	4-20	ER32 11PCS		3.00kg	
305420	MTB3-ER32-70-6PCS	6-20	ER32 6PCS		2.70kg	
305422	MTB3-ER40-80-23PCS	4-26	ER40 23PCS		7.20kg	
305424	MTB3-ER40-80-15PCS	4-26	ER40 15PCS	M12(M12*1.75P)	6.00kg	
305426	MTB3-ER40-80-7PCS	6-25	ER40 7PCS		4.50kg	
305428	MTB4-ER32-60-18PCS	3-20	ER32 18PCS		4.30kg	
305430	MTB4-ER32-60-11PCS	4-20	ER32 11PCS		3.20kg	
305432	MTB4-ER32-60-6PCS	6-20	ER32 6PCS	M16(M16*2.0P)	2.90kg	
305434	MTB4-ER40-82-23PCS	4-26	ER40 23PCS		7.30kg	
305436	MTB4-ER40-82-15PCS	4-26	ER40 15PCS		6.10kg	
305438	MTB4-ER40-82-7PCS	6-25	ER40 7PCS		4.60kg	
305440	MTB5-ER40-82-23PCS	4-26	ER40 23PCS	M16(M16*2.0P)	8.20kg	
305442	MTB5-ER40-82-15PCS	4-26	ER40 15PCS		6.90kg	
305444	MTB5-ER40-82-7PCS	6-25	ER40 7PCS		5.40kg	
305446	MTB5-ER50-85-12PCS	12-34	ER50 12PCS		9.50kg	

## ST/ER Milling chuck group



Order No.	Model	Set Range	Collet	N.W.	Price
305600	R8-ER16-38-10PCS	1-10	ER16 10PCS	1.50kg	
305602	R8-ER32-40-18PCS	3-20	ER32 18PCS	4.30kg	
305604	R8-ER32-40-11PCS	4-20	ER32 11PCS	3.20kg	
305606	R8-ER32-40-6PCS	6-20	ER32 6PCS	2.90kg	
305608	R8-ER40-70-23PCS	4-26	ER40 23PCS	7.30kg	
305610	R8-ER40-70-15PCS	4-26	ER40 15PCS	6.10kg	
305612	R8-ER40-70-7PCS	6-25	ER40 7PCS	4.60kg	

## ER-A Type

ER STRAIGHT SHANK

### C/ER-A Straight Shank

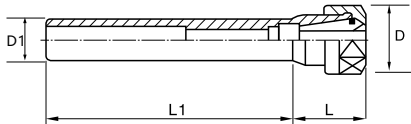

Wrench : P02  
Collet : P05-P06  
Nut : P02

Unit:mm

Order No.	Model	L1	D1	L	D	Collet	Price
305700	C20-ER16-50	50	20	30	28	ER16	485
305702	C20-ER16-100	100					535
305704	C20-ER16-150	150		645			
305706	C20-ER20-50	50		36	34	ER20	485
305708	C20-ER20-100	100	535				
305710	C20-ER25-50	50	46	46	42	ER25	590
305712	C20-ER25-100	100					645
305714	C20-ER25-150	150		755			
305716	C25-ER16-100	100		30	28	ER16	535
305718	C25-ER16-150	150	645				
305720	C25-ER20-150	150	36		34	ER20	645
305722	C25-ER25-100	100					46
305724	C25-ER25-150	150	755				
305726	C25-ER32-80	80	54	50	ER32	700	
305728	C25-ER40-100	100	55	63	ER40	965	
305730	C32-ER25-60	60	32	46	42	ER25	645
305732	C32-ER32-100	100		54	50	ER32	755
305734	C32-ER40-100	100		55	63	ER40	965
305736	C40-ER32-100	100	40	54	50	ER32	805
305738	C40-ER40-100	100		55	63	ER40	965

### ST/ER Milling chuck group



Order No.	Model	Set Range	Collet	N.W.	Price
305900	ST16-ER11-50-13PCS	1-7	ER11 13PCS	0.60kg	
305902	ST16-ER11-50-7PCS	1-7	ER11 7PCS	0.50kg	
305904	ST16-ER11-100-13PCS	1-7	ER11 13PCS	1.70kg	
305906	ST16-ER11-100-7PCS	1-7	ER11 7PCS	1.60kg	
305908	ST16-ER16-100-10PCS	1-10	ER16 10PCS	1.00kg	
305910	ST16-ER16-100-8PCS	3-10	ER16 8PCS	1.00kg	
305912	ST20-ER16-50-10PCS	1-10	ER16 10PCS	1.05kg	
305914	ST20-ER16-50-8PCS	3-10	ER16 8PCS	1.00kg	
305916	ST20-ER16-100-10PCS	1-10	ER16 10PCS	1.10kg	
305918	ST20-ER16-100-8PCS	3-10	ER16 8PCS	1.05kg	
305920	ST20-ER16-150-10PCS	1-10	ER16 10PCS	1.20kg	
305922	ST20-ER16-150-8PCS	3-10	ER16 8PCS	1.15kg	
305924	ST25-ER16-50-10PCS	1-10	ER16 10PCS	1.10kg	
305926	ST25-ER16-50-8PCS	3-10	ER16 8PCS	1.05kg	
305928	ST25-ER16-100-10PCS	1-10	ER16 10PCS	1.20kg	
305930	ST25-ER16-100-8PCS	3-10	ER16 8PCS	1.15kg	
305932	ST25-ER16-150-10PCS	1-10	ER16 10PCS	1.35kg	
305934	ST25-ER16-150-8PCS	3-10	ER16 8PCS	1.30kg	
305936	ST20-ER20-50-12PCS	2-13	ER20 12PCS	1.20kg	
305938	ST20-ER20-50-10PCS	4-13	ER20 10PCS	1.15kg	
305940	ST20-ER20-100-12PCS	2-13	ER20 12PCS	1.30kg	
305942	ST20-ER20-100-10PCS	4-13	ER20 10PCS	1.25kg	
305944	ST20-ER20-150-12PCS	2-13	ER20 12PCS	1.40kg	
305946	ST20-ER20-150-10PCS	4-13	ER20 10PCS	1.35kg	
305948	ST25-ER20-50-12PCS	2-13	ER20 12PCS	1.30kg	
305950	ST25-ER20-50-10PCS	4-13	ER20 10PCS	1.25kg	
305952	ST25-ER20-100-12PCS	2-13	ER20 12PCS	1.40kg	
305954	ST25-ER20-100-10PCS	4-13	ER20 10PCS	1.35kg	
305956	ST25-ER20-150-12PCS	2-13	ER20 12PCS	1.50kg	
305958	ST25-ER20-150-10PCS	4-13	ER20 10PCS	1.45kg	
305960	ST20-ER25-50-15PCS	2-16	ER25 15PCS	2.40kg	
305962	ST20-ER25-50-7PCS	4-16	ER25 7PCS	1.90kg	
305964	ST20-ER25-100-15PCS	2-16	ER25 15PCS	2.40kg	
305966	ST20-ER25-100-7PCS	4-16	ER25 7PCS	1.90kg	
305968	ST20-ER25-150-15PCS	2-16	ER25 15PCS	2.50kg	
305970	ST20-ER25-150-7PCS	4-16	ER25 7PCS	2.00kg	
305972	ST25-ER25-100-15PCS	2-16	ER25 15PCS	2.50kg	
305974	ST25-ER25-100-7PCS	4-16	ER25 7PCS	2.00kg	
305976	ST25-ER25-150-15PCS	2-16	ER25 15PCS	2.65kg	
305978	ST25-ER25-150-7PCS	4-16	ER25 7PCS	2.20kg	
305980	ST32-ER25-60-15PCS	2-16	ER25 15PCS	2.50kg	
305982	ST32-ER25-60-7PCS	4-16	ER25 7PCS	2.00kg	
305984	ST25-ER32-80-18PCS	3-20	ER32 18PCS	4.10kg	
305986	ST25-ER32-80-11PCS	4-20	ER32 11PCS	3.00kg	
305988	ST25-ER32-80-6PCS	6-20	ER32 6PCS	2.70kg	
305990	ST32-ER32-100-18PCS	3-20	ER32 18PCS	4.30kg	
305992	ST32-ER32-100-11PCS	4-20	ER32 11PCS	3.20kg	
305994	ST32-ER32-100-6PCS	6-20	ER32 6PCS	2.90kg	
305996	ST40-ER32-100-18PCS	3-20	ER32 18PCS	4.50kg	
305998	ST40-ER32-100-11PCS	4-20	ER32 11PCS	3.40kg	
306000	ST40-ER32-100-6PCS	6-20	ER32 6PCS	3.10kg	
306002	ST32-ER40-100-23PCS	4-26	ER40 23PCS	7.30kg	
306004	ST32-ER40-100-15PCS	4-26	ER40 15PCS	6.10kg	
306006	ST32-ER40-100-7PCS	6-25	ER40 7PCS	4.60kg	
306008	ST40-ER40-100-23PCS	4-26	ER40 23PCS	7.60kg	
306010	ST40-ER40-100-15PCS	4-26	ER40 15PCS	6.50kg	
306012	ST40-ER40-100-7PCS	6-25	ER40 7PCS	5.00kg	

### C/ER-M Straight Shank

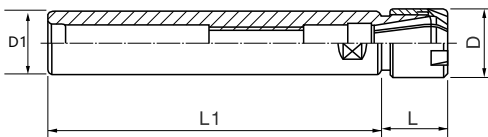

Wrench : P02  
Collet : P05-P06  
Nut : P02

Unit:mm

Order No.	Model	L1	D1	L	D	Collet	Price
305800	C16-ER11-50M	50	16	12	28	ER11	485
305802	C16-ER11-100M	100					535
305804	C20-ER16-50M	50	20	18	22	ER16	485
305806	C20-ER16-100M	100					535
305808	C20-ER16-150M	150		19	28	ER20	645
305810	C20-ER20-50M	50					485
305812	C20-ER20-100M	100	535				
305814	C20-ER20-150M	150	645				
305816	C25-ER20-50M	50	25	19	28	ER20	485
305818	C25-ER20-100M	100					535
305820	C25-ER20-150M	150		645			

### ST/ER Milling chuck group



Order No.	Model	Set Range	Collet	N.W.	Price
306100	ST16-ER11M-50-13PCS	1-7	ER11 13PCS	0.60kg	
306102	ST16-ER11M-100-13PCS	1-7	ER11 13PCS	0.70kg	
306104	ST16-ER16M-100-10PCS	1-10	ER16 10PCS	1.00kg	
306106	ST20-ER16M-50-10PCS	1-10	ER16 10PCS	1.05kg	
306108	ST20-ER16M-100-10PCS	1-10	ER16 10PCS	1.10kg	
306110	ST20-ER16M-150-10PCS	1-10	ER16 10PCS	1.20kg	
306112	ST25-ER16M-100-10PCS	1-10	ER16 10PCS	1.20kg	
306114	ST25-ER16M-150-10PCS	1-10	ER16 10PCS	1.35kg	
306116	ST20-ER20M-50-12PCS	2-13	ER20 12PCS	1.20kg	
306118	ST20-ER20M-100-12PCS	2-13	ER20 12PCS	1.30kg	
306120	ST20-ER20M-150-12PCS	2-13	ER20 12PCS	1.40kg	
306122	ST25-ER20M-100-12PCS	2-13	ER20 12PCS	1.40kg	
306124	ST25-ER20M-150-12PCS	2-13	ER20 12PCS	1.50kg	



## C-ER-M Type

C-ER-M STRAIGHT SHANK ER COLLET CHUCK HOLDER

Wrench : P02  
Collet : P05-P06  
Nut : P02

Model explanation

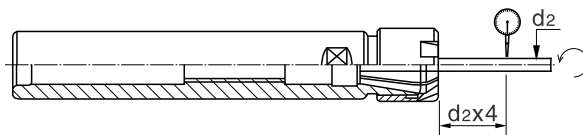
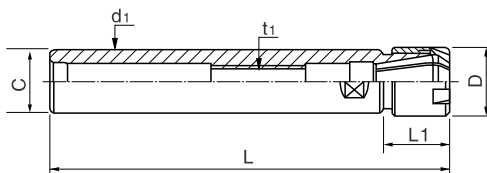
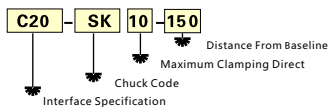

Order No.	Cat. No	Chucking Dia	D	C	L1	L	nut	Collet	spanner	PRICE (RMB)
306200	C12-ER11-100M	2.0~7.0	16	12	16.6	100	ER11M	ER11	ER11M	350
306202	-ER11-150M				16.6	150				400
306204	C16-ER11-100M	2.0~7.0	16	16	16.6	100	ER11M	ER11	ER11M	350
306206	-ER11-150M				16.6	150				400
306208	-ER16-100M	3.0~10	22	16	25	100	ER16M	ER16	ER16M	300
306210	-ER16-150M				25	150				350
306212	-ER16-200M	3.0~13	28	20	25	200	ER20M	ER20	ER20M	400
306214	-ER20-100M				40	100				300
306216	-ER20-150M	3.0~10	22	16	40	150	ER16M	ER16	ER16M	350
306218	C20-ER16-100M				40	100				300
306220	-ER16-150M	3.0~13	28	20	40	150	ER20M	ER20	ER20M	350
306222	-ER20-100M				40	100				300
306224	-ER20-150M	3.0~16.0	35	25	40	150	ER25UM	ER25	ER25UM	350
306226	-ER25-100M				40	100				400
306228	-ER25-150M	3.0~13	28	16	50	150	ER20M	ER20	ER20M	450
306230	C25-ER20-100M				40	100				350
306232	-ER20-150M	3.0~16.0	35	25	40	150	ER25UM	ER25	ER25UM	400
306234	-ER25-100M				50	100				400
306236	-ER25-150M	50	150	450						

## ER EXTENSION(FOR LATHE)

Model explanation

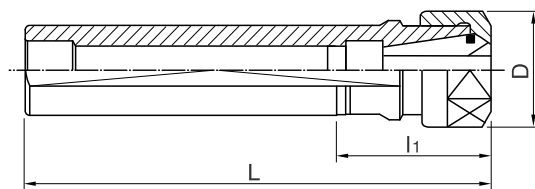
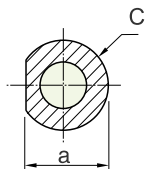
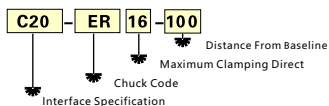

Wrench : P02  
Collet : P05-P06  
Nut : P02

Order No.	Cat. No	Size					nut	Collet	spanner	PRICE (RMB)
		L	L1	a	D	C				
306300	C20-ER16-100A	100	30	19	28	20	ER16A	ER16	ER16A	350
306302	C20-ER20-100A	100	30	19	34	20	ER20A	ER20	ER20A	350
306304	C25-ER20-100A	100	30	24	34	25	ER20A	ER20	ER20A	400
306306	C20-ER11-100A	100	30	19	19	20	ER11A	ER11	ER11A	400
306308	C25-ER11-100A	100	30	29	19	25	ER11A	ER11	ER11A	450
306310	C25-ER16-100M	100	30	19	22	20	ER16M	ER16	ER16M	400
306312	C32-ER20-100M	100	30	19	28	20	ER20M	ER20	ER20M	450
306314	C25-ER20-100M	100	30	24	28	25	ER20M	ER20	ER20M	400



## C-ER-A Type

C-ER-A STRAIGHT SHANK ER COLLET CHUCK HOLDER



### Model explanation

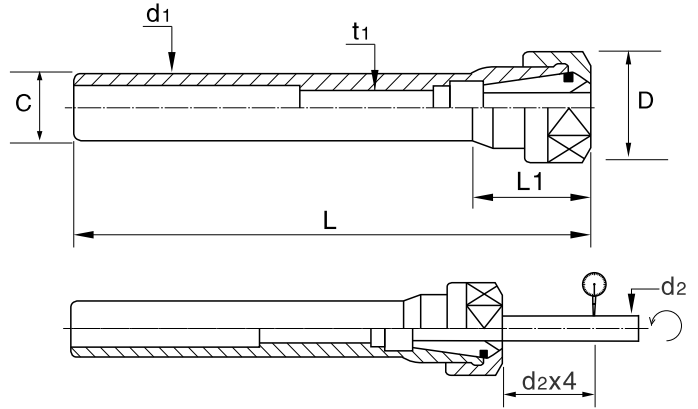
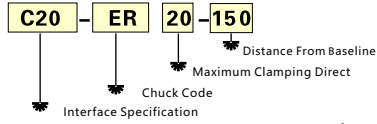

Wrench : P02  
 Collet : P05-P06  
 Nut : P02

Order No.	Cat. No	Chucking Dia	D	C	L1	L	nut	Collet	spanner	PRICE (RMB)
306400	<b>C12-ER11-50</b>	2.0~7	16.8	12	16.6	50	ER11A	ER11	ER11A	350
306402	<b>-ER11-100</b>				16.6	100				350
306404	<b>C16-ER11-50</b>	2.0~7	16.8	16	16.6	50	ER11A	ER11	ER11A	350
306406	<b>-ER11-100</b>				16.6	100				350
306408	<b>-ER11-150</b>	16.6	150		400					
306410	<b>-ER16-100</b>	3.0~10	24.9		40.0	100	ER16A	ER16	ER16A	300
306412	<b>-ER16-150</b>				40.0	150				350
306414	<b>-ER16-200</b>				40.0	200				400
306416	<b>-ER20-100</b>	3.0~13	29.8	40.0	100	ER20A	ER20	ER20A	300	
306418	<b>-ER20-150</b>			40.0	150				350	
306420	<b>C20-ER11-100</b>			40.0	100				400	
306422	<b>-ER11-150</b>	2.0~7	16.8	20	16.6	100	ER11A	ER11	ER11A	400
306424	<b>-ER11-200</b>				16.6	200				500
306426	<b>-ER16-100</b>	3.0~10	24.9		40.0	100	ER16A	ER16	ER16A	300
306428	<b>-ER16-150</b>				40.0	150				350
306430	<b>-ER16-200</b>				40.0	200				400
306432	<b>-ER20-100</b>	3.0~13	29.8		40.0	100	ER20A	ER20	ER20A	300
306434	<b>-ER20-150</b>			40.0	150	350				
306436	<b>-ER20-200</b>			40.0	200	400				
306438	<b>-ER25-100</b>	3.0~16	42	50.0	100	ER25UM	ER25	ER25UM	350	
306440	<b>-ER25-150</b>			50.0	150				400	
306442	<b>C25-ER16-100</b>	3.0~10	24.9	25	40.0	100	ER16A	ER16	ER16A	350
306444	<b>-ER16-150</b>				40.0	150				400
306446	<b>-ER16-200</b>	40.0	200		450					
306448	<b>-ER20-100</b>	3.0~13	29.8		40.0	100	ER20A	ER20	ER20A	400
306450	<b>-ER20-150</b>				40.0	150				450
306452	<b>-ER20-200</b>				40.0	200				500
306454	<b>-ER25-100</b>	3.0~16	42	50.0	100	ER25UM	ER25	ER25UM	400	
306456	<b>-ER25-150</b>			50.0	150				450	
306458	<b>-ER25-200</b>			50.0	200				500	
306460	<b>C25-ER20-150</b>	3.0~13	29.8	32	40.0	150	ER20A	ER20	ER20A	450
306462	<b>-ER20-200</b>				40.0	200				500
306464	<b>-ER25-150</b>	3.0~16	42		50.0	150	ER25UM	ER25	ER25UM	500
306466	<b>-ER25-200</b>				50.0	200				550
306468	<b>-ER32-150</b>				65.0	150				550
306470	<b>-ER32-200</b>	3.0~20	50		65.0	200	ER32UM	ER32	ER32UM	600
306472	<b>-ER40-150</b>	6.0~26	63	65.0	150	ER40UM	ER40	ER40UM	600	
306474	<b>C42-ER32-100</b>	3.0~20	50	42	65.0	100	ER32UM	ER32	ER32UM	600
306476	<b>-ER40-100</b>	6.0~26	63		65.0	100	ER40UM	ER40	ER40UM	650

OZ

OZ COLLET CHUCK

- Wrench : P02
- Collet : P05-P06
- Nut : P02
- Pull Stud : P03-P04
- Locking Device : P09

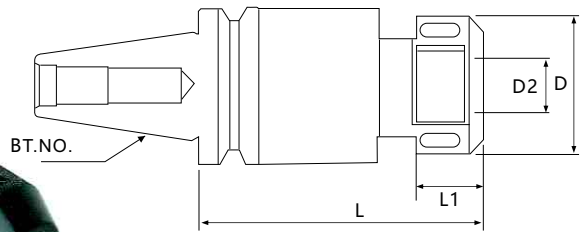

## OZ25

When ordering, please confirm the rod screw specifications for metric or imperial.

Unit:mm

Order No.	Model	L	D	Collet	Draw Bar	N.W.	Price
306500	NT30-OZ25-70	70	60	OZ25	M12(M12*1.75P) A04(1/2"-12) A05(1/2"-13)	1.00kg	925
306502	NT40-OZ25-70	70	60	OZ25	M16(M16*2.0P) A06(5/8"-11)	1.30kg	925
306504	NT50-OZ25-73	73	60	OZ25	M24(M24*3.0P) A07(1"-8)	3.20kg	1300
306506	MTB2-OZ25-85	85	60	OZ25	M10(M10*1.5P)	1.00kg	925
306508	MTB3-OZ25-70	70	60	OZ25	M10(M10*1.5P) M12(M12*1.75P) A04(1/2"-12) A05(1/2"-13) A02(3/8"-16)	1.00kg	925
306510	MTB4-OZ25-70	70	60	OZ25	M16(M16*2.0P) A06(5/8"-11)	1.20kg	925
306512	MTB5-OZ25-65	65	60	OZ25	M24(M24*3.0P) A07(1"-8)	2.00kg	1165
306514	R8-OZ25-70	70	60	OZ25	7/16"-20	1.20kg	925
306516	BT30-OZ25-70	70	60	OZ25	M12*1.75P	0.90kg	1085
306518	BT40-OZ25-80	80	60	OZ25	M16*2.0P	1.50kg	1100
306520	BT50-OZ25-100	100	60	OZ25	M24*3.0P	4.30kg	1795
306522	SK40-OZ25-80	80	60	OZ25	M16*2.0P	1.90kg	1220
306524	SK50-OZ25-100	100	60	OZ25	M24*3.0P	4.20kg	1855
306526	CAT40-OZ25-3"	3"	60	OZ25	5/8"-11	1.90kg	1220
306528	CAT50-OZ25-31/2"	31/2"	60	OZ25	1"-8	4.00kg	1850

## OZ32

306600	NT30-OZ32-100	100	78	OZ32	M12(M12*1.75P) A04(1/2"-12)	2.00kg	1455
306602	NT40-OZ32-85	85	78	OZ32	M16(M16*2.0P) A06(5/8"-11)	2.20kg	1455
306604	NT50-OZ32-80	80	78	OZ32	M24(M24*3.0P) A07(1"-8)	4.80kg	1650
306606	MTB5-OZ32-100	100	78	OZ32	M24(M24*3.0P) A07(1"-8)	3.00kg	1500
306608	BT40-OZ32-90	90	78	OZ32	M16*2.0P	2.30kg	1520
306610	BT50-OZ32-100	100	78	OZ32	M24*3.0P	5.00kg	2285
306612	BT50-OZ32-150	150	78	OZ32	M24*3.0P	6.00kg	2595
306614	SK40-OZ32-80	80	78	OZ32	M16*2.0P	2.30kg	1580
306616	SK50-OZ32-100	100	78	OZ32	M24*3.0P	5.00kg	2345
306618	CAT40-OZ32-3"	3"	78	OZ32	5/8"-11	2.30kg	1580
306620	CAT50-OZ32-31/2"	31/2"	78	OZ32	1"-8	5.00kg	2345

## OZ25 Collets Chuck Kit

### Set Metric Collet

7PCS: 6, 8, 10, 12, 16, 20, 25

15PCS: 3, 4, 5, 6, 7, 8, 9, 10, 11, 12, 13, 16, 18, 20, 25



Order No.	Model	Number	Rod thread	N.W.	Price
306700	NT30-OZ25	7	M12(M12*1.75P)	3.7kg	
306702	NT30-OZ25	15	A04(1/2"-12) A05(1/2"-13)	5.2kg	
306704	NT40-OZ25	7	M16(M16*2.0P)A06(5/8"-11)	4.0kg	
306706	NT40-OZ25	15		5.5kg	
306708	NT50-OZ25	7	M24(M24*3.0P)A07(1"-8)	6.5kg	
306710	NT50-OZ25	15		8.5kg	
306712	MTB2-OZ25	7	M10(M10*1.5P)A02(3/8"-16)	3.6kg	
306714	MTB2-OZ25	15		5.1kg	
306716	MTB3-OZ25	7	M10(M10*1.5P) M12(M12*1.75P)	3.7kg	
306718	MTB3-OZ25	15	A04(1/2"-12) A05(1/2"-13) A02(3/8"-16)	5.2kg	
306720	MTB4-OZ25	7	M16(M16*2.0P) A06(5/8"-11)	3.9kg	
306722	MTB4-OZ25	15		5.4kg	
306724	MTB5-OZ25	7	M24(M24*3.0P)A07(1"-8)	4.7kg	
306726	MTB5-OZ25	15		6.2kg	
306728	R8-OZ25	7	7/16"-20	3.7kg	
306730	R8-OZ25	15		5.2kg	
306732	BT40-OZ25	7		4.4kg	
306734	BT40-OZ25	15		5.9kg	
306736	BT50-OZ25	7		7.5kg	
306738	BT50-OZ25	15		9.5kg	
306740	SK40-OZ25	7	DIN69871A40 M16*2.0P	4.2kg	
306742	SK40-OZ25	15		5.7kg	
306744	SK50-OZ25	7	DIN69871A50 M24*3.0P	7.3kg	
306746	SK50-OZ25	15		9.3kg	

## OZ32 Collets Chuck Kit

### Set Metric Collet

8PCS: 6, 8, 10, 12, 16, 20, 25, 32

15PCS: 6, 8, 10, 12, 13, 14, 15, 16, 18, 20, 22, 25, 26, 30, 32



Order No.	Model	Number	Rod thread	N.W.	Price
306800	NT30-OZ32	8	M12(M12*1.75P)	7.0kg	
306802	NT30-OZ32	15	A04(1/2"-12) A05(1/2"-13)	9.0kg	
306804	NT40-OZ32	8	M16(M16*2.0P)A06(5/8"-11)	7.2kg	
306806	NT40-OZ32	15		9.2kg	
306808	NT50-OZ32	8	M24(M24*3.0P)A07(1"-8)	9.8kg	
306810	NT50-OZ32	15		11.8kg	
306812	MTB5-OZ32	8	M24(M24*3.0P)A07(1"-8)	8.0kg	
306814	MTB5-OZ32	15		10.0kg	
306816	BT40-OZ32	8		7.4kg	
306818	BT40-OZ32	15		9.4kg	
306820	BT50-OZ32	8		10.0kg	
306822	BT50-OZ32	15		12.0kg	
306824	SK40-OZ32	8	DIN69871A40 M16*2.0P	7.2kg	
306826	SK40-OZ32	15		9.2kg	
306828	SK50-OZ32	8	DIN69871A50 M24*3.0P	9.8kg	
306830	SK50-OZ32	15		11.8kg	

## BT-TC

BT-TC TAPPING TORQUE HANDLE



- ◆ torque tapping special tool holders, reduce the loss of wire tapping.
- ◆ Quick change to improve efficiency.



- Wrench : P02
- Collet : P07-P08
- Nut : P02
- Pull Stud : P03-P04
- Locking Device : P09

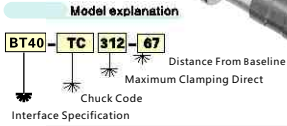
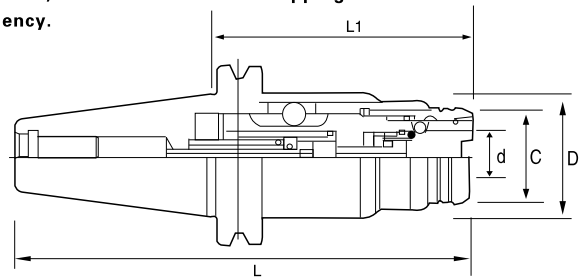

Order No.	Cat. No	C	D	L1	L	Telescopic scope		Collet	Tapping capacity	Weight ( KG )	PRICE (RMB)
						Nobuyuki	Shrinkage				
307000	BT30-TC312-57	33	46	57	105.4	6	12	TC312	M3 ~ M14	1.50	2250
307002	BT40-TC312-67	33	63	67	127.4	6	12	TC312	M3 ~ M14	1.80	2250
307004	-TC822-94	48		94	159.4	12.5	12.5	TC822	M8 ~ M22	2.50	2500
307006	-TC1638-164	72	100	164	229.4	20	20	TC1638	M14 ~ M36	3.20	5000
307008	BT50-TC312-100	33		100	172.8	6	12	TC312	M3 ~ M14	4.00	3250
307010	-TC822-102	48		102	203.8	12.5	12.5	TC822	M8 ~ M22	5.00	3800
307012	-TC1638-163	72		163	243.8	20	20	TC1638	M14 ~ M36	6.00	5500

### TAP HOLDER ARBOR

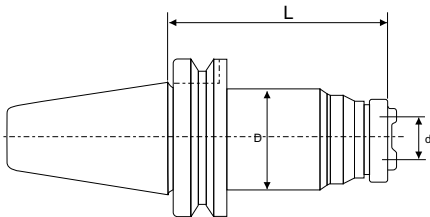

### TAPPER CHUCK

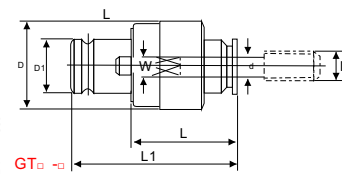

Order NO.	Model & Specification	Capacity	d	D	L	Tap Callets	Price
307020	□30-G3	M3-M12	19	46	90	GT3-M	1300
307022	□40-G3	M3-M12	19	46	90	GT3-M	1500
307024	-G12	M12-M24	30	66	130	GT12-M	1500
307026	□50-G3	M3-M12	19	46	95	GT3-M	2000
307028	-G12	M12-M24	30	66	130	GT12-M	2000
307030	-G24	M24-M42	45	92	180	GT24-M	2000

Note: □ represents various types of taper shank

### TAP HOLDER WITH MORSE TAPER

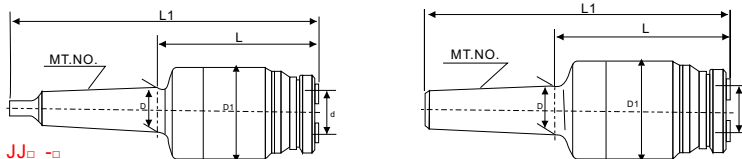

Order NO.	Model & Specification	Capacity	MT.NO.	D	D1	d	L	L1	Cutter Model	Price
307032	MT3-JJ3	M3 ~ M12	3	23.825	46	19	90	187	GT3-M	900
307034	MT4-JJ3	M12 ~ M24	4	31.267	66	30	130	212	GT12-M	900
307036	MT3-JJ4		3	23.825				216		900
307038	MT4-JJ4		4	31.267				241		900
307040	MT5-JJ4	M24 ~ M42	5	44.399	92	45	160	274	GT24-M	1200
307042	MT5-JJ5							314		1200
307046	MW6-JJ6	M45 ~ M80	6	63.348	135	78	156	338	GT45-M	1500

The tapping processing of drill press, lathe, milling machine and machining center can use different specifications of Tap Holders.

Tap Holder consists of arbor and tap sleeve with the tapping range M3-M80. The arbor has the front-back thread pitch compensation device while tap sleeve has torque overload protection device.

Order NO.	Model & Specification	M	d	D	D1	L	L1	W	Price
307050	GT3-3	3	3.25	38	19	33.7	56	2.5	260
307052	-4	4	4.1					3.15	260
307054	-5	5	5.1					4.0	260
307056	-6	6	6.4					5.0	260
307058	-8	8	6.4					5.0	260
307060	-10	10	8.1					6.3	260
307062	-12	12	9.1					7.1	260
307064	GT12-12	12	9.1					7.1	300
307068	-14	14	11.3					9.0	300
307070	-16	16	12.6					10.0	300
307072	-18	18	14.1	11.2	300				
307074	-20	20	14.1	11.2	300				
307076	-22	22	16.1	12.5	300				
307078	-24	24	18.1	14.0	300				
307080	GT24-24	24	18.1	85	45	74.5	123	14.0	400
307081	-27	27	20.1					16.0	400
307082	-30	30	20.1					16.0	400
307083	-33	33	22.5					18.0	400
307084	-36	36	25.1					20.2	400
307085	-39	39	28.1					22.4	400
307086	-42	42	28.1					22.4	400
307087	GT45-45	45	36.1					29	800
307088	-48	48	38.1					29	800
307089	-52	52	42.1					32	800
307090	-56	56	45.1	35	800				
307091	-60	60	45.1	35	800				
307092	-64	64	48.1	36	800				
307093	-68	68	52.1	39	800				
307094	-70	70	52.1	44	800				
307095	-76	76	56.1	46	800				
307096	-80	80	56.1	48	800				

## TP

Straight Shank ER Tapper(For CNC Lathe)

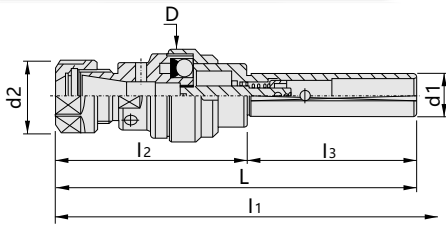

Wrench : P02  
Collet : P07-P08  
Nut : P02



### Characteristic :

- Using ER rigid Collet.
- The main body is made of SCM21 material, the tightening screw after precision grinding.
- Flexible design can avoid wire tapping fracture.
- A good floating assembly can automatically correct the position of the workpiece.
- If the material is hard, the speed is relatively slow.
- Before use, please determine the lathe spindle speed, otherwise it will be too fast or too slow, resulting in wire break or separation.

Order No.	Model	D	d1	d2	L	l1	l2	l3	COLLET	CAPACITY	N.W.	Price
306900	TP-20	44	20	34	159	172	79	80	ER20	M3~M16	0.5kg	900
306902	TP-225	44	25								0.7kg	900
306904	TP-232	44	32								0.9kg	960
306906	STP-20	37	20		155						1.0kg	900
306908	TP-32	56	32	50	174.5	190	94.5	80	ER32	M3~M27	1.6kg	1000
306910	TPM-320	44	MT3	34	165	178	79	86	ER20	M3~M16	1.4kg	900
306912	TPM-420	44	MT4								1.6kg	1000
306914	TPM-432	56	MT4	50	203.5	216.5	94.5	109	ER32	M3~M27	1.8kg	1000
306916	BT30-TER16										0.7kg	1000
306918	BT30-TER20										0.8kg	1000
306920	BT30-TER25										0.9kg	1000
306922	BT40-TER16										1.5kg	1100
306924	BT40-TER20										1.6kg	1100
306926	BT40-TER25										1.7kg	1100
306928	BT50-TER16										3.0kg	1500
306930	BT50-TER20										3.2kg	1500
306932	BT50-TER25										3.5kg	1500
306934	BT50-TER32										3.8kg	1500

## DT24/DT33



Model No	Tapper holder	Tap Collet	Sleeve
<b>DT24 MTA □ -10PCS/SET</b>	DT24-MT2 Holder DT24-MT3 Holder DT24-MT4 Holder DT24-MT5 Holder	M4,M5,M6,M8,M10,M12,M14,M16,M18,M20,M22,M24 W3/16,W1/4,W5/16,W3/8,W7/16,W1/2,W5/8,W3/4,W7/8,W1" PT1/8,PT1/4,PT1/2	DT24-MT1 DT24-MT2 DT24-MT3
<b>DT33 MTA □ -10PCS/SET</b>	DT33-MT3 Holder DT33-MT4 Holder DT33-MT5 Holder	M8,M10,M12,M14,M16,M18,M20,M22,M24,M27,M30,M33,M36 W5/16,W3/8,W7/16,W1/2,W5/8,W7/8,W1",W1-1/8,W1-1/4 PT1/8,PT1/4,PT3/8,PT1/2,PT3/4,PT1"	DT33-MT1 DT33-MT2 DT33-MT3 DT33-MT4

### STANDARD SET

Model No	Standard Size	PRICR
<b>DT24 MTA □-10PCS/SET</b>	DT24 MTA □ HOLDER,JTA6+1/2,DT24-M4,M6,M8,M10,M12,M16,M16,DT24-MT1,DT24-MT2	5500
<b>DT33 MTA □-10PCS/SET</b>	DT33 MTA □ HOLDER,JTA6+1/2,DT24-M8,M10,M12,M16,M20,M24,DT33-MT2,DT33-MT3	5500

- DT24/DT33 TAPER HOLDER de soid with standaer full set or you can choice buy each size separately
- According to the tapped mate material.the drill tapper holder could de adjusted the torque with high or low
- DT24/DT33 You can adjust the group purchase can also be purchased according to your needs
- DT24/DT33 Tapping group is simple, convenient and fast.
- DT24/DT33 The torque adjustment function. And according to the requirements of the teeth to do torque (H) and weak (L) adjustment operation.

### DT24/DT33 SET OF DRILL TAPPER CONSISTS:

- 1.TAPPER HOLDER(BODY) X 1PCS
- 2.DT24/DT33 JTA6+1/2 Keyless drill chuck
- 3.TAP SLEEVES X 2PCS
- 4.TAP COLLETS X 6 PCS
- 5.ADJUSTING WRENCH X I PCS



## BT-APU

BT-APU DRILL CHUCK

Wrench : P02  
Pull Stud : P03-P04  
Locking Device : P09

Drilling



- ◆ Please inserts the cutting tool handle department after the cartridge, do cause the handle part insertion cartridge. Locks when the cutting tool please completely insert cutting tool's handle diameter part.
- ◆ Specially in trail's situation, please confirm that beats the precision.
- ◆ When the cutting tool clamps, the cutting tool inserts the cartridge first, turns tight with the hand, finally uses the special spanner force to lock.

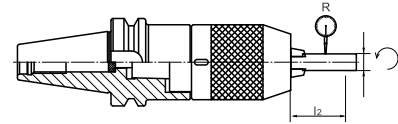
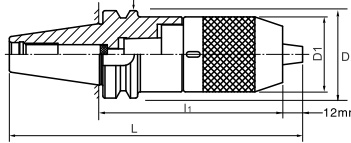
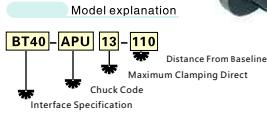

Circle precision  $\leq 0.05\text{mm}$

Order No.	Cat. No	Chucking Dia	D1	D2	L1	L	Spanner	Weight ( KG )	PRICE (RMB)
307100	BT30-APU8-75	0.3~8	37	46	75	128.4	APU8	0.80	1500
307102	BT40-APU8-85	0.3~8	37	63	85	150.4	APU8	1.46	1500
307104	-APU13-110	1~13	50		110	165.4	APU13	2.00	1200
307106	-APU16-120	3~16	57	100	120	195.4	APU16	2.60	1500
307108	BT50-APU13-110	1~13	50		110	201.8	APU13	4.70	1800
307110	-APU16-130	3~16	57		130	236.8	APU16	4.80	2750

## JM.. JM DRILL CHUCK

## Grated kyieess drill chuck

MT:

Order Number	Model No.	Clamp Scope		Mounts	Length(mm)			Weight kg	Price
		mm	inch		A	B	D		
307111	JM068H	0.2~8	1/64"~5/16"	MT2	140.5	60.5	37	0.45	600
307112	JM0613H	0.2~13	1/64"~1/2"	MT2	160	80	50.5	1.00	600
307113	JM0613H	0.2~13	1/64"~1/2"	MT3	179	80	50.5	1.08	650
307114	JM0613H	0.2~13	1/64"~1/2"	MT4	205	81	50.5	1.48	700
307115	JM0616H	0.2~16	1/64"~5/8"	MT3	184	85	57	1.40	650
307116	JM0616H	0.2~16	1/64"~5/8"	MT4	209	85	57	1.70	700

C:

Order Number	Model No.	Clamp Scope		Mounts	Length(mm)			Weight kg	Price
		mm	inch		A	B	D		
307120	JM078H	0.2~8	1/64"~5/16"	C20	120.5	60.5	37	0.52	600
307121	JM0713H	0.2~13	1/64"~1/2"	C20	140	80	50.5	0.98	600
307122	JM0713H	0.2~13	1/64"~1/2"	C25	160	80	50.5	1.12	700
307123	JM0713H	0.2~13	1/64"~1/2"	C32	161	81	50.5	1.37	800
307124	JM0716H	0.2~16	1/64"~5/8"	C20	145	85	57	1.33	600
307125	JM0716H	0.2~16	1/64"~5/8"	C25	165	85	57	1.48	700
307126	JM0716H	0.2~16	1/64"~5/8"	C32	165	85	57	1.66	800

R:

Order Number	Model No.	Clamp Scope		Mounts	Length(mm)			Weight kg	Price
		mm	inch		A	B	D		
307128	JM0613H	0.2~13	1/64"~1/2"	R8	186	81	50.5	1.25	700
307129	JM0616H	0.2~16	1/64"~5/8"	R8	190	85	57	1.54	800

Multi-choices of arborsspecification offerquickchange on integrated cuttingmachine.

## DRILL CHUCK

Precision Inspection Table

Model No.	d mm	L mm	Precision
JM068H	3	35	0.05
	6	50	
	8	50	
JM0610H	3	35	0.05
	6	58	
	10	58	
JM0613H	5	55	0.05
	10	75	
	13	75	
JM0616H	5	55	0.05
	10	80	
	16	80	

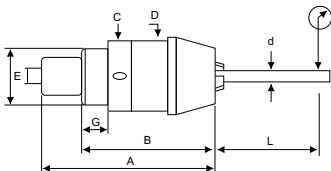

Order Number	Model No.	Clamp Scope		Mounts	A	B	C	D	E	F	G	Weight kg	Price
		mm	inch		mm	mm	mm	mm	mm	mm			
307130	JM068H	0.2~8	1/64"~5/16"	MT2	85	60.5	36	37.5	M6	30	10	0.37	350
307131	JM0610H	0.2~10	1/64"~3/8"	MT2	94.5	70	41	43	M6	34	13	0.64	350
307132	JM0613H	0.2~13	1/64"~1/2"	MT3	107	80	48	50.5	M8	38	15	0.92	350
307133	JM0616H	0.2~16	1/64"~5/8"	MT3	112	85	54	57	M8	43	16	1.26	400

## J DRILL CHUCK

## DRILL CHUCK ARBOR



Order Number	Model & Specification	Taper	D	L	Drill Collet Model	Price
307140	□30-Z10-25	B10	10.094	25	J216(0.6~6)	300
307141	-45			45		300
307142	-Z12-25	B12	12.065	25	J2110(1~10)	300
307143	-45			45		300
307144	-Z16-25	B16	15.733	25	J2113(1~13)	300
307145	-45			45		300
307146	□40-Z10-45	B10	10.094	45	J216(0.6~6)	300
307147	-90			90		300
307148	-Z12-45	B12	12.065	45	J2110(1~10)	300
307149	-90			90		300
307150	-Z16-45	B16	15.733	45	J2113(1~13)	300
307151	-90			90		300
307152	-Z18-45	B18	17.780	45	J2113(1~13)	350
307153	-90			90		350
307154	-Z22-45	B22	21.793	45	J2116(3~16)	400
307155	-90			90		400
307156	□50-Z10-45	B10	10.094	45	J2120(5~20)	600
307157	-105			105		600
307158	-Z12-45	B12	12.065	45	J216(0.6~6)	600
307159	-105			105		600
307160	-Z16-45	B16	15.733	45	J216(0.6~6)	600
307161	-105			105		600
307162	-Z18-45	B18	17.780	45	J2110(1~10)	650
307163	-105			105		700
307164	-Z22-60	B22	21.793	60	J2113(1~13)	700
307165	-105			105		800

Note: □ represents various types of taper shank J2116 (3~16)

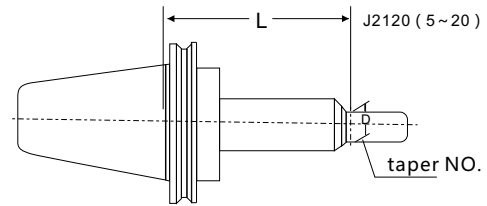

## J01 SERIES GRATE M TYPE H MORSE, JACQUARD SHORT TAPER STOCK



Order Number	Model	Clamp Scope mm	Tapering Hole Number	Taper	d mm	l mm	D mm	L mm	L1 mm	Weight kg	Check Rod		Precision mm	N.M	Price
											Big Rod	Small Rod			
307170	JM013H	0.2~3	B6	2° 51'26.7"	6.350	10.000	24	45.1	41.5	0.100	3×40	/	0.05	0.8	600
307171		1/64"~1/8"	J10	4° 49'24.7"	6.350	11.112									600
307172	JM014H	0.2~4	B10	2° 51'26.7"	10.094	14.500	29	60.8	55	0.190	4×50	/	0.05	1.2	550
307173		1/64"~5/32"	J1	4° 24'53.1"	9.754	16.669									550
307174	JM016H	0.2~6	B10	2° 51'26.7"	10.094	14.500	34	70.6	64	0.313	6×50	3×25	0.05	3	400
307175		1/64"~1/4"	J1	4° 24'53.1"	9.754	16.669									400
307176	JM018H	0.2~8	B12	2° 51'26.7"	12.065	18.500	39	80.4	73	0.477	8×50	4×25	0.05	4	350
307177		1/64"~5/16"	J2	4° 40'11.6"	14.199	22.225									350
307178	JM0110H	0.2~10	B12	2° 51'26.7"	12.065	18.500	44	90.2	82	0.685	10×75	5×37.5	0.05	6	350
307179		1/64"~3/8"	J2	4° 40'11.6"	14.199	22.225									350
307180	JM0113H	0.2~13	B16	2° 51'41.0"	15.733	24.000	49	100.6	91	0.946	13×100	6×50	0.05	12	300
307181		1/64"~1/2"	J33	3° 38'13.4"	15.850	25.400									300
307182	JM0116H	0.2~16	B18	2° 51'41.0"	17.780	32.000	54	112.2	102	1.270	16×100	8×50	0.05	14	350
307183		1/64"~5/8"	J6	2° 58'24.8"	17.170	25.400									350
307184	JM0120H	0.2~20	B22	2° 52'31.5"	21.793	40.500	59	131.5	119	1.717	20×125	10×62.5	0.07	16	500
307185		1/64"~3/4"	J3	3° 3'1.0"	20.599	30.956									500
307186	JM0125H	0.2~25	B22	2° 52'31.5"	21.793	40.500	74	156.5	142	3.430	25×125	13×62.5	0.09	18	800

## J01 SERIES GRATE PTYPE H MORSE, JACQUARD SHORT TAPER STOCK

## J03 SERIES TYPE H FEMALE THREAD STOCK

Order Number	Model	Clamp Scope mm	Tapering Hole Number	Taper	d mm	l mm	D mm	L mm	L1 mm	Weight kg	Check Rod		Precision mm	N.M	Price
											Big Rod	Small Rod			
307187	J016L	0.2~6	B10	2° 51'26.7"	10.094	14.500	34	70.6	64	0.313	6×50	3×25	0.12	3	350
307188		1/64"~1/4"	J1	4° 24'53.1"	9.754	16.669									350
307189	J018L	0.2~8	B12	2° 51'26.7"	12.065	18.500	39	80.4	73	0.477	8×50	4×25	0.12	4	320
307190		1/64"~5/16"	J2	4° 40'11.6"	14.199	22.225									320
307191	J0110L	0.2~10	B12	2° 51'26.7"	12.065	18.500	44	90.2	82	0.686	10×75	5×37.5	0.12	6	320
307192		1/64"~3/8"	J2	4° 40'11.6"	14.199	22.225									320
307193	J0113L	0.2~13	B16	2° 51'41.0"	15.733	24.000	49	100.6	91	0.944	13×100	6×50	0.16	12	300
307194		1/64"~1/2"	B33	3° 38'13.4"	15.850	25.400									300
307195	J0116L	0.2~16	B18	2° 51'41.0"	17.780	32.000	54	112.2	102	1.268	16×100	8×50	0.16	14	320
307196		1/64"~5/8"	J6	2° 58'24.8"	17.170	25.400									320
307197	J0120L	0.2~20	B22	2° 52'31.5"	21.793	40.500	59	131.5	119	1.716	20×125	10×62.5	0.16	16	400
307198		1/64"~3/4"	J3	3° 3'1.0"	20.599	30.956									400
307199	J0125H	0.2~25	B22	2° 52'31.5"	21.793	40.500	74	156.5	142	3.430	25×125	13×62.5	0.20	18	600

Order Number	Model	Clamp Scope mm	d mm	l mm	D mm	L mm	L1 mm	Weight kg	Check Rod		Precision mm	N.M	Price
									Big Rod	Small Rod			
307200	J036H	0.2~6	M10×1	14	34	70.6	64	0.313	6×50	3x25	0.20	3	380
307202		1/64"~1/4"	3/8"×24UNF										380
307204	J038H	0.2~8	M10×1	14	39	80.4	73	0.477	8×50	4x25	0.20	4	350
307206		1/64"~5/16"	3/8"×24UNF										350
307208	J0310H	0.2~10	M10×1	14	44	90.2	85	0.686	10×75	5x37.5	0.20	6	350
307210		1/64"~3/8"	3/8"×24UNF										350
307212	J0313H	0.2~13	M12×1.25	16	49	100.6	91	0.944	13×100	6x50	0.20	12	320
307214		1/64"~1/2"	1/2"×20UNF										320
307216	J0316H	0.2~16	M16×1.5	18	54	112.2	102	1.268	16×100	8x50	0.20	14	350
307218		1/64"~5/8"	5/8"×16UN										350

## J Wrench Spanner Drill Chuck

### FEATURES:

- \*Suitable for medium, heavy duty drilling use.
- \*For milling machine, lathe, drill Machine, CNC & wood working machine.
- \*High speed drilling can be performed for possessing high cutting power

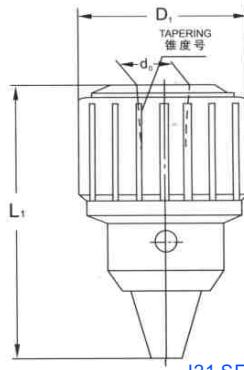

J21 SERIES TYPE L MORSE JACQUARD SHORT TAPER STOCK

### J31 SERIES TYPE H FEMALE THREAD STOCK

Order Number	Model	Clamp Scope mm	Mounts	D mm	L1 mm	Weight kg	Price
307220	J316L	0.5~6	M10×1.0	30	49	0.125	200
307222		1/64"~1/4"	3/8"-24UNF				200
307224	J3110L	1~10	M10×1.0	42.5	70	0.335	200
307226		1/32"~3/8"	3/8"-24UNF				200
307228	J3113L	1~13	M12×1.25	53	86	0.625	200
307230		1/32"~1/2"	1/2"-20UNF				200
307232	J3116L	3~16	M16×1.5	57	97	0.750	220
307234		1/8"~5/8"	5/8"-16UN				220

Order Number	Model	Clamp Scope mm	Tapering Hole Number	d <sub>0</sub> mm	D1 mm	L1 mm	Weight kg	Price
307240	J216L	0.5~6	B10	10.094	30	49	0.125	250
307242		1/64"~1/4"	J1	9.754				250
307244	J2110L	1~10	B12	12.065	42.5	70	0.335	250
307246		1/32"~3/8"	J2	14.199				250
307248	J2113L	1~13	B16	15.733	53	86	0.625	250
307250		1/32"~1/2"	J6	17.170				250
307252	J2116L	3~16	B18	17.780	57	97	0.750	280
307254		1/8"~5/8"	J3	20.599				280
307256	J2120H	5~20	B22	21.793	65	110	1.400	300
307258		3/16"~3/4"	J3	20.599				300

### Wrench Spanner drill chuck



### (-XS) SIDE MILLING CUTTER ARBOR

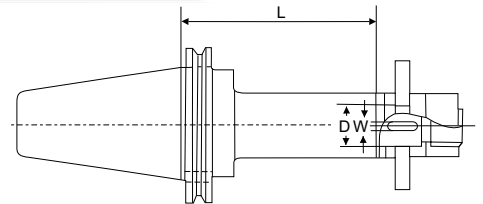

### J31 SERIES TYPE L FEMALE THREAD STOCK

Order Number	Model	Clamp Scope mm	Mounts	D mm	L1 mm	Weight kg	Price
307260	J316L	0.5~6	M10×1	30	49	0.115	300
307262		1/64"~1/4"	3/8"-24UNF				300
307264	J3110L	1~10	M10×1	34	60	0.160	300
307266		1/32"~3/8"	3/8"-24UNF				300
307268	J3113L	1.5~13	M12×1.25	43	75	0.305	300
307270		1/16"~1/2"	1/2"-20UNF				300
307272	J3116L	3~16	M16×1.5	53	88	0.625	400
307274		1/8"~5/8"	5/8"-16UN				400



Order Number	Model & Specification	D	L	W	Price
307900	□ 30-XS10-60	10	60	-	400
307902	-XS16-60	16	60	4	400
307904	-XS22-60	22	60	6	400
307906	□ 40-XS16-75	16	75	4	400
307908	-105		105		400
307910	-XS22-75		75		400
307912	-105	22	105	6	400
307914	-120		120		450
307916	-XS27-75		75		400
307918	-105	27	105	6	400
307920	-120		120		450
307922	-SX332-60	32	60	8	450
307924	-90		90		500
307926	□ 50-XS16-90	16	90	4	800
307928	-120		120		900
307930	-XS22-90		90		800
307932	-135	22	135	6	900
307934	-150		150		1000
307936	-XS27-90		90		800
307938	-135	27	135	6	900
307940	-150		150		1000
307942	XS32-75		75		800
307944	-90	32	90	8	900
307946	-120		120		950
307948	-135		135		1000
307950	-SX40-75		75		800
307952	-90	40	90	10	900
307954	-120		120		950
307956	-135		135		1000
307958	XT60-XS32-135	32	135	8	3000
307960	-XS40-135	40	135	10	3000
307962	-XS50-150	50	150	12	3000

注：□表示各种类型柄柄

### J21 SERIES TYPE L MORSE JACQUARD SHORT TAPER STOCK

Order Number	Model	Clamp Scope mm	Tapering Hole Number	d <sub>0</sub> mm	D mm	L1 mm	Weight kg	Price
307280	J216L	0.5~6	B10	10.094	30	49	0.115	300
307282		1/64"~1/4"	J1	9.754				300
307284	J2110L	1~10	B12	12.065	34	60	0.160	300
307286		1/32"~3/8"	J2	14.199				300
307288	J2113L	1.5~13	B16	15.733	43	75	0.305	300
307290		1/16"~1/2"	J33	17.170				300
307292	J2116L	3~16	B18	17.780	53	88	0.625	400
307294								400

## MT/JT

Morse Taper Drill Chuck Arbors

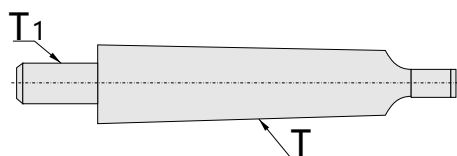

Order No.	Model	T	T1	Price
307300	MT1-JT0	MT1	JT0	
307302	MT1-JT1	MT1	JT1	
307304	MT1-JT2	MT1	JT2	
307306	MT1-JT3	MT1	JT3	
307308	MT1-JT4	MT1	JT4	
307310	MT1-JT5	MT1	JT5	
307312	MT1-JT6	MT1	JT6	
307314	MT1-JT33	MT1	JT33	
307316	MT2-JT0	MT2	JT0	
307318	MT2-JT1	MT2	JT1	
307320	MT2-JT2	MT2	JT2	
307322	MT2-JT3	MT2	JT3	
307324	MT2-JT4	MT2	JT4	
307326	MT2-JT5	MT2	JT5	
307328	MT2-JT6	MT2	JT6	
307330	MT2-JT33	MT2	JT33	
307332	MT3-JT1	MT3	JT1	
307334	MT3-JT2	MT3	JT2	
307336	MT3-JT3	MT3	JT3	
307338	MT3-JT4	MT3	JT4	
307340	MT3-JT5	MT3	JT5	
307342	MT3-JT6	MT3	JT6	
307344	MT3-JT33	MT3	JT33	
307346	MT4-JT2	MT4	JT2	
307348	MT4-JT3	MT4	JT3	
307350	MT4-JT4	MT4	JT4	
307352	MT4-JT5	MT4	JT5	
307354	MT4-JT6	MT4	JT6	
307356	MT4-JT33	MT4	JT33	
307358	MT5-JT2	MT5	JT2	
307360	MT5-JT3	MT5	JT3	
307362	MT5-JT4	MT5	JT4	
307364	MT5-JT5	MT5	JT5	
307366	MT5-JT6	MT5	JT6	
307368	MT5-JT33	MT5	JT33	

## R8/JT

R8 Drill Chuck Arbors

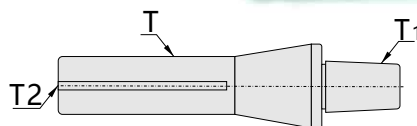

Order No.	Model	T	T2	T3	Price
307370	R8-JT1	R8	JT1	7/16"-UNF20	
307372	R8-JT2	R8	JT2		
307374	R8-JT3	R8	JT3		
307376	R8-JT4	R8	JT4		
307378	R8-JT5	R8	JT5		
307380	R8-JT6	R8	JT6		
307382	R8-JT33	R8	JT33		

## C/JT

Cylindrical Drill Chuck Arbors

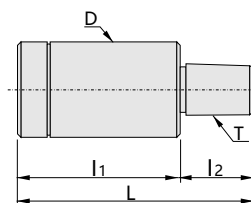

Order No.	Model	D	T	L	L1	L2	Price
307400	C20-JT6	C20	JT6	80	55	25	
307402	C32-JT3	C32	JT3	85	70	25	
307404	C32-JT6	C32	JT6	105.95	70	35.95	
307406	C42-JT3	C42	JT3	125	100	25	
307408	C42-JT5	C42	JT5	135.95	100	35.95	

## C/MT

Straight type chuck mandrel

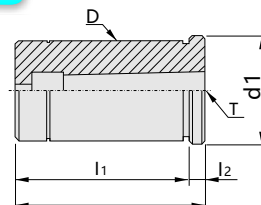

Order No.	Model	D	T	L	L1	L2	d1	Price
307500	C32-MT1	C32	Mt1	61	56	5	35	
307502	C32-MT2	C32	MT2	73	65	8	37	
307504	C32-MT3	C32	MT3	92	72	20	37	
307506	C42-MT1	C42	MT1	61	56	5	47	
307508	C42-MT2	C42	MT2	74	66	8	47	
307510	C42-MT3	C42	MT3	92	75	17	47	

## BT-FMA

BT-FMA FACE MILL HOLDER

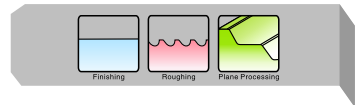

### ◆ Face milling cutter shank special

Wrench : P02  
Pull Stud : P03-P04  
Locking Device : P09

**Characteristic :**

- D1 Tolerance : h6
- With side screws
- The center hole with cooling ( DIN69871-AD )
- Dynamic balance can be achieved G6.3 , 8000RPM.
- Balance and speed can be based on customer requirements, but the need for a separate offer.

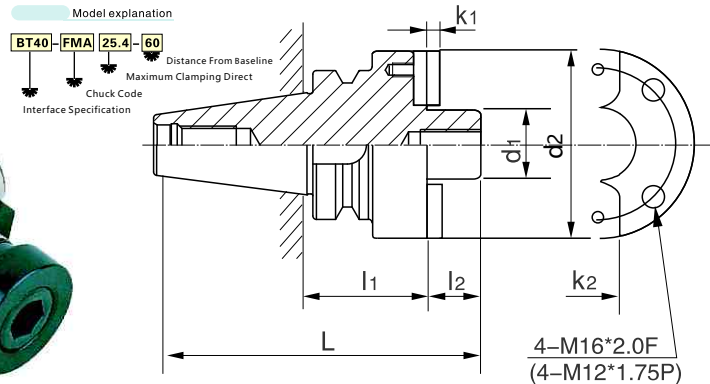

Order No.	Model	L	L1	L2	D	d1	d2	k1	k2	图示	WG	Price					
307600	BT30-FMA25.4-45	113.4	45	20	50	25.4	31.5	4.52	9.52	1	1.10kg	605					
307602	BT30-FMA25.4-60	128.4	60								1.30kg	635					
307604	BT30-FMA31.75-45	115.4	45	22	60	31.75	41	6.7	12.7		1.35kg	705					
307606	BT40-FMA25.4-45	130.4	45								1.80kg	755					
307608	BT40-FMA25.4-60	145.4	60	20	50	25.4	31.5	4.52	9.52		2.00kg	805					
307610	BT40-FMA25.4-90	175.4	90								2.60kg	945					
307612	BT40-FMA25.4-105	190.4	105								2.70kg	990					
307614	BT40-FMA31.75-45	132.4	45	22	60	31.75	41	6.7	12.7		2.00kg	795					
307616	BT40-FMA31.75-75	162.4	75								2.70kg	915					
307618	BT40-FMA31.75-90	177.4	90								2.90kg	970					
307620	BT40-FMA38.10-60	150.4	60							25	75	38.1	44.5	8.87	15.87	2.80kg	1155
307622	BT40-FMA50.80-60	161.4	60	36	98	50.8	65	9.75	19.05	4.00kg	1500						
307624	BT50-FMA25.4-45	166.8	45	20	50	25.4	31.5	4.52	9.52	4.40kg	1545						
307626	BT50-FMA25.4-90	211.8	90							5.10kg	1845						
307628	BT50-FMA25.4-150	271.8	150							6.10kg	1905						
307630	BT50-FMA31.75-45	168.8	45	22	60	31.75	41	6.2	12.7	4.50kg	1605						
307632	BT50-FMA31.75-75	198.8	75							6.7	5.30kg	1805					
307634	BT50-FMA31.75-105	228.8	105					25	80	38.1	44.5	8.87	15.87	5.70kg	2005		
307636	BT50-FMA38.10-45	171.8	45											4.80kg	1670		
307638	BT50-FMA38.10-75	210.8	75	36	98	50.8	65	9.75	19.05	6.00kg	1950						
307640	BT50-FMA50.80-45	182.8	45							5.70kg	1855						
307642	BT50-FMA50.80-75	212.8	75							6.80kg	2060						
307644	BT50-FMA47.62-75	208.8	75							32	128.75	47.62	-	12.5	25.4	2	7.90kg
307646	BT50-FMA25.4-125BG	246.8	125	20	48	25.4	31.5	60	4.25	9.52	5.3kg	1795					
307648	BT50-FMA25.4-150BG	271.8	150								6.4kg	1910					
307650	BT50-FMA25.4-200BG	321.8	200								7.5kg	2125					
307652	BT50-FMA25.4-250BG	371.8	250								8.6kg	2450					
307654	BT50-FMA25.4-300BG	421.8	300		58			70			31.75	41	75	6.7	12.7	9.7kg	2615
307656	BT50-FMA25.4-350BG	471.8	350													10.8kg	2805
307658	BT50-FMA25.4-400BG	521.8	400													11.9kg	3155
307660	BT50-FMA31.75-125BG	248.8	125													22	70
307662	BT50-FMA31.75-150BG	273.8	150	6.3kg	2095												
307664	BT50-FMA31.75-175BG	298.8	175	8.3kg	2405												
307666	BT50-FMA31.75-200BG	323.8	200	9.1kg	2425												
307668	BT50-FMA31.75-250BG	373.8	250	10.6kg	2715												
307670	BT50-FMA31.75-300BG	423.8	300	12.1kg	3035												
307672	BT50-FMA31.75-350BG	473.8	350	13.6kg	3280												



## BT-FMB FMB FACE MILL HOLDER

### ◆ Face milling cutter shank special

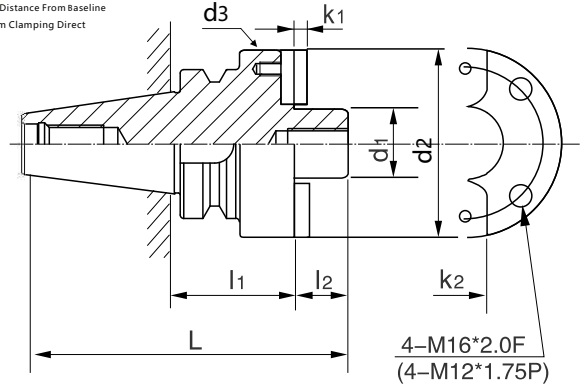
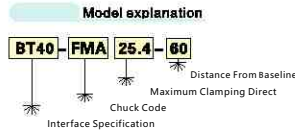
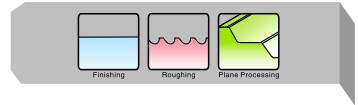

Wrench : P02  
Pull Stud : P03-P04  
Locking Device : P09

**Characteristic :**

- D1 Tolerance : h6
- With side screws
- The center hole with cooling ( DIN69871-AD )
- Dynamic balance can be achieved G6.3 , 8000RPM.
- Balance and speed can be based on customer requirements, but the need for a separate offer.

Order No.	Model	L	L1	L2	D	d1	d2	k1	k2	圖示 d3	WG	Price
307700	BT30-FMB22-45	115.4	45	19	48	22	26	4.8	10	1	0.85kg	560
307702	BT30-FMB22-60	127.4	60								1.25kg	555
307704	BT30-FMB27-45	113.4	45	20	60	27	31.5	5.8	12		1.20kg	735
307706	BT30-FMB27-60	128.4	60								1.35kg	705
307708	BT30-FMB32-45	115.4	45	22	78	32	41	6.8	14		1.35kg	890
307710	BT40-FMB22-45	129.4	45								1.45kg	760
307712	BT40-FMB22-60	144.4	60	19	48	22	26	4.8	10		1.70kg	750
307714	BT40-FMB22-100	184.4	100								2.20kg	895
307716	BT40-FMB27-45	130.4	45	20	60	27	31.5	5.8	12		1.60kg	725
307718	BT40-FMB27-60	145.4	60								2.00kg	785
307720	BT40-FMB27-90	175.4	90	22	78	32	41	6.8	14		2.30kg	850
307722	BT40-FMB27-105	190.4	105								2.50kg	925
307724	BT40-FMB32-45	132.4	45	25	80	40	48	8.3	16	1.75kg	885	
307726	BT40-FMB32-60	147.4	60							2.10kg	955	
307728	BT40-FMB40-60	150.4	60	19	48	22	26	4.8	10	2.80kg	1065	
307730	BT50-FMB22-45	165.8	45							4.50kg	1480	
307732	BT50-FMB22-90	210.8	90	20	60	27	31.5	5.8	12	5.10kg	1590	
307734	BT50-FMB22-150	270.8	150							6.80kg	1825	
307736	BT50-FMB22-200	320.8	200	22	78	32	41	6.8	14	7.00kg	1945	
307738	BT50-FMB22-250	370.8	250							8.00kg	2215	
307740	BT50-FMB27-50	171.8	50	20	60	27	31.5	5.8	12	4.60kg	1520	
307742	BT50-FMB27-90	211.8	90							5.40kg	1675	
307744	BT50-FMB27-150	271.8	150	25	80	40	48	8.3	16	7.50kg	1965	
307746	BT50-FMB27-200	321.8	200							9.50kg	2260	
307748	BT50-FMB27-250	371.8	250	18	48	22	31.75	4.25	9.52	11.0kg	2510	
307750	BT50-FMB32-50	173.8	50							5.70kg	1660	
307752	BT50-FMB32-90	213.8	90	20	58	22	31.75	4.25	9.52	5.80kg	1815	
307754	BT50-FMB40-50	176.8	50							5.2kg	1635	
307756	BT50-FMB40-90	216.8	90	25	80	40	48	8.3	16	6.00kg	1870	
307758	BT50-FMB40-105	231.8	105							7.20kg	2085	
307760												
307762	BT50-FS40F-75	202.8	75	26	110	40	-	8.3	16	2	6.00kg	2355
307764	BT50-FS60F-75	201.8	75	25	138	60	-	12.5	25.4		8.50kg	3345
307766	BT40-FMB22-150BG	233.4	150	18	48	22	31.75	4.25	9.52	51	3.1kg	1020
307768	BT40-FMB22-200BG	283.4	200								4.0kg	1250
307770	BT40-FMB22-250BG	333.4	250	20	58	22	31.75	4.25	9.52		4.9kg	1305
307772	BT50-FMB22-150BG	271.8	150								6.8kg	1825
307774	BT50-FMB22-200BG	321.8	200	62.5	58	22	31.75	4.25	9.52		8.4kg	1970
307776	BT50-FMB22-250BG	371.8	250								9.4kg	2240
307778	BT50-FMB22-300BG	421.8	300							10.4kg	2360	
307780	BT50-FMB22-350BG	471.8	350							11.4kg	2505	
307782	BT50-FMB22-400BG	521.8	400							12.4kg	2740	
307784	BT50-FMB22-450BG	571.8	450							13.4kg	2895	
307786	BT50-FMB22-500BG	621.8	500	14.4kg	3110							

## NT/FM Face Mill Arbor



Wrench : P02  
Pull Stud : P03-P04  
Locking Device : P09

### Characteristic :

- D1=Outer diameter of face milling cutter
- The end of the handle has a plastic ring to protect the spindle.

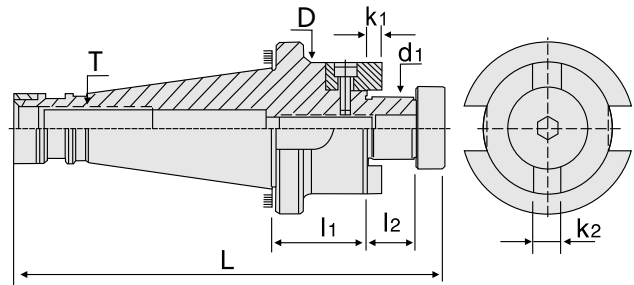

When ordering, please confirm the pull rod screw specification for metric or imperial.

Unit:mm

Order No.	Model	D	L	l1	l2	K1	K2	T	WG	Price	
307800	NT30-FMA25.40	46	139.4	35	20	4.5	9.52	M12(M12*1.75P) A04(1/2"-12)	0.55kg	610	
307802	NT30-FMA31.75	60	141.4		22	5.7	12.7		0.75kg	725	
307804	NT30-FMA38.10	70	148.9		25	6.87	15.87		2.10kg	915	
307806	NT40-FMA25.40	63	164.4		24	20	4.5	9.52	M16(M16*2.0P) A06(5/8"-11)	1.45kg	795
307808	NT40-FMA31.75	63	166.4			22	5.7	12.7		1.75kg	835
307810	NT40-FMA38.10	70	173.4			25	6.87	15.87		2.00kg	970
307812	NT40-FMA50.80	98	174.9			36	9.75	19.05		2.55kg	1390
307814	NT40-FMA47.62	128.75	149.4	32		12.5	25.4	2.90kg		2050	
307816	NT50-FMA25.40	50	182.8	45	20	4.5	9.52	M24(M24*3.0P) A07(1"-8)	3.30kg	1580	
307818	NT50-FMA31.75	60	184.8		22	5.7	12.7		3.40kg	1605	
307820	NT50-FMA38.10	70	192.3		25	6.87	15.87		3.60kg	1640	
307822	NT50-FMA50.80	90	193.3		36	9.75	19.05		3.90kg	1730	
307824	NT50-FMA47.62	128.75	157.8	24	32	12.5	25.4	4.90kg	2215		
307826	NT30-FMB22mm	42	136.4	35	19	4	10	M12(M12*1.75P) A04(1/2"-12)	0.67kg	615	
307828	NT30-FMB27mm	60	139.4		20	5	12		1.00kg	720	
307830	NT30-FMB32mm	65	141.4		22	6	14		1.20kg	805	
307832	NT30-FMB40mm	80	148.9		25	7	16	1.40kg	980		
307834	NT40-FMB22mm	48	163.4		45	19	4	10	M16(M16*2.0P) A06(5/8"-11)	1.25kg	770
307836	NT40-FMB27mm	58	166.4			20	5	12		1.45kg	795
307838	NT40-FMB32mm	65	168.4			22	6	14		1.70kg	885
307840	NT40-FMB40mm	80	175.9	25		7	16	2.50kg		1115	
307842	NT50-FMB22mm	48	206.8	45		19	4	10		M24(M24*3.0P) A07(1"-8)	3.50kg
307844	NT50-FMB27mm	58	207.8		20	5	12	3.90kg	1610		
307846	NT50-FMB32mm	65	214.3		22	6	14	4.00kg	1635		
307848	NT50-FMB40mm	80	217.3		25	7	16	4.83kg	1705		

## HSK/FMB Face Mill Arbor



Wrench : P02  
Pull Stud : P03-P04  
Locking Device : P09

### Characteristic :

- D1 Tolerance : h6
- Dynamic balance can reach G6.3 , 3000RPM.
- Balance and speed can be based on customer requirements, but the need for a separate offer.

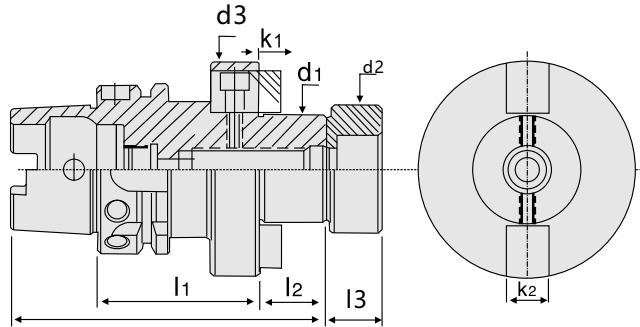

Order No.	Model	L	l2	l3	d2	d3	k1	k2	WG	Price
307900	HSK40A-FMB16-50	87	17	-	-	40	3.8	8	0.7kg	1169
307902	HSK40A-FMB22-60	99	19	14	26	50	4.8	10	0.8kg	1400
307904	HSK40A-FMB27-60	101	21	16	31.5	60	5.8	12	1.0kg	1431
307906	HSK40A-FMB32-60	104	24	16	41	78	6.8	14	1.1kg	1975
307908	HSK50A-FMB16-50	92	17	-	-	40	3.8	8	1.1kg	1350
307910	HSK50A-FMB22-60	104	19	14	26	50	4.8	10	1.2kg	1406
307912	HSK50A-FMB27-60	106	21	16	31.5	60	5.8	12	1.3kg	1606
307914	HSK50A-FMB32-60	109	24	16	41	78	6.8	14	1.5kg	2025
307916	HSK63A-FMB16-50	99	17	-	-	40	3.8	8	1.2kg	1544
307918	HSK63A-FMB22-50	101	19	14	26	50	4.8	10	1.3kg	1581
307920	HSK63A-FMB27-60	113	21	16	31.5	60	5.8	12	1.5kg	1681
307922	HSK63A-FMB32-60	116	24	16	41	78	6.8	14	1.6kg	2106
307924	HSK63A-FMB40-60	119	25	20.5	48	89	8.3	16	2.1kg	2306
307926	HSK100A-FMB22-50	119	19	14	26	50	4.8	10	2.7kg	3194
307928	HSK100A-FMB27-50	121	21	16	31.5	60	5.8	12	2.9kg	3231
307930	HSK100A-FMB32-50	124	24	16	41	78	6.8	14	3.0kg	3325
307932	HSK100A-FMB40-60	137	25	20.5	48	89	8.3	16	4.0kg	3563
307934	HSK100A-FMB50-70	150	30	25	68	120	9.7	19	5.1kg	5131
307936	HSK100A-FMB60-70	160	40	-	-	129	12.5	25.4	5.5kg	5469

## DAT/FMB Face Mill Arbor



Wrench : P02  
Pull Stud : P03-P04  
Locking Device : P09

### Characteristic :

- D1 Tolerance : h6
- 7/24 Conical Degree Tolerance : AT3
- Dynamic balance can be achieved G6.3 , 3000RPM.
- Balance and speed can be based on customer requirements, but the need for a separate offer.

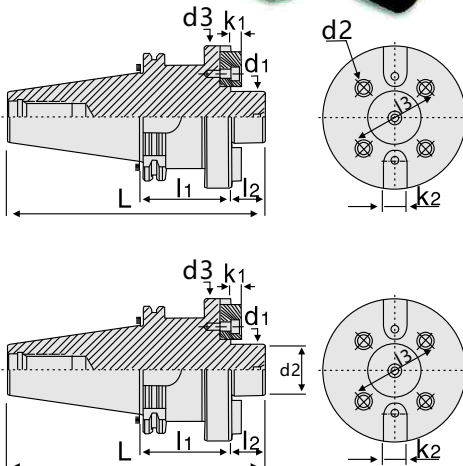
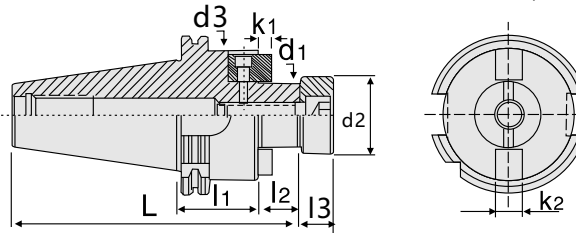

Order No	Model	L	L2	L3	d2	d3	k1	k2	fig	WG	Price
308000	DAT30-FMB22-35	101.8	19	14	26	45	4.8	10	1	1.00kg	625
308002	DAT30-FMB27-55	122.8	20	16	31.5	58	5.8	12		1.05kg	675
308004	DAT40-FMB22-35	122.4	19	14	26	48	4.8	10		1.20kg	725
308006	DAT40-FMB27-60	148.4	20	16	31.5	58	5.8	12		1.80kg	795
308008	DAT40-FMB32-60	150.4	22	16	41	66	6.8	14		2.30kg	875
308010	DAT40-FMB40-60	153.4	25	20.5	48	80	8.3	16		2.80kg	1030
308012	DAT50-FMB22-35	155.75	19	14	26	48	4.8	10		3.40kg	1315
308014	DAT50-FMB27-35	156.75	20	16	31.5	58	5.8	12		3.5kg	1365
308016	DAT50-FMB32-35	158.75	22	16	41	66	6.8	14		3.70kg	1380
308018	DAT50-FMB40-50	189.75	25	20.5	48	80	8.3	16		4.70kg	1490
308020	DAT40-FMB50-60	191.75	30	25	68	95	9.7	19		5.80kg	1725
308022	DAT40-FMB40F-60	158.4	30	66.7	M12	89	8.3	15.9		2	2.90kg
308024	DAT50-FMB40F-60	201.75	30	66.7	M12	89	8.3	15.9	2	5.50kg	2025
308026	DAT50-FMB40F-70	211.75	40	101.6	M16	129	12.5	25.4	2	5.70kg	2310
308028	DAT40-FS40-60	154.4	26	66.7	50	110	8.3	16	3	3.20kg	1945
308030	DAT50-FS40-70	197.75	26	66.7	50	110	8.3	16	3	5.70kg	2120
308032	DAT50-FS60-70	196.75	25	101.6	M16	140	12.5	25.4	2	5.50kg	3265

## BT-MTA 莫式錐度刀柄

BT-MTA MOSE TAPER SLEEVE

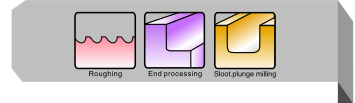

☞ Pull Stud : P03-P04  
Locking Device : P09

### Characteristic :

- High precision work flow, even if the use of lengthened drill, concentricity is still in 0.015mm.
- Morse taper shank drill bit.

◆ When installs the cutting tool, the flat tail direction and the hilt hole alignment insertion, the cutting tool with the copper clock, layer on layer raps puller bolt part several upwardly then.

◆ When unloads the cutting tool, aims at the flat hole the symbol, with the clock sub-rap, unloads the cutting tool.  
By now please note do not let the cutting tool fly .

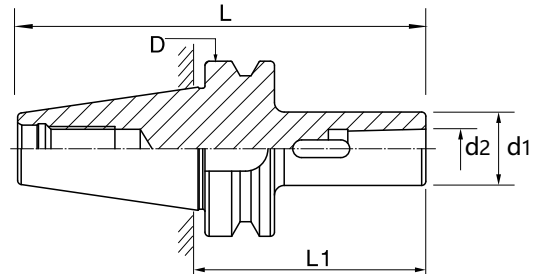
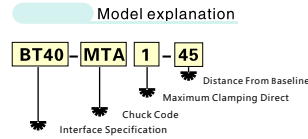

Order No.	Model	L	L1	d1	d2	图示	WG	Price
308100	BT30-MTA1-45	93.4	45	25	12.065	1	0.55kg	390
308102	BT30-MTA1-105	153.4	105			2	0.80kg	485
308104	BT30-MTA2-60	108.4	60	32	17.78	1	0.60kg	405
308106	BT30-MTA2-120	168.4	120			2	0.90kg	515
308108	BT30-MTA3-80	128.4	80	40	23.825	1	0.80kg	465
308110	BT40-MTA1-45	110.4	45	25	12.065	1	1.05kg	540
308112	BT40-MTA1-120	185.4	120			2	1.40kg	745
308114	BT40-MTA2-50	115.4	50	32	17.78	1	1.10kg	555
308116	BT40-MTA2-120	185.4	120			2	1.80kg	790
308118	BT40-MTA3-70	135.4	70	40	23.825	1	1.20kg	590
308120	BT40-MTA3-135	200.4	135			2	1.90kg	815
308122	BT40-MTA4-95	160.4	95	48	31.267	1	1.40kg	685
308124	BT40-MTA4-165	230.4	165			2	2.50kg	970
308126	BT50-MTA1-45	146.8	45	25	12.065	1	3.80kg	1320
308128	BT50-MTA1-120	221.8	120			2	4.30kg	1475
308130	BT50-MTA1-180	281.8	180	32	17.78	2	5.00kg	1630
308132	BT50-MTA2-60	161.8	60			1	4.00kg	1345
308134	BT50-MTA2-135	236.8	135	40	23.825	2	4.70kg	1515
308136	BT50-MTA2-180	281.8	180			2	5.00kg	1640
308138	BT50-MTA3-65	166.8	65	40	23.825	1	3.90kg	1375
308140	BT50-MTA3-150	251.8	150			2	5.00kg	1600
308142	BT50-MTA3-180	281.8	180	48	31.267	2	5.50kg	1735
308144	BT50-MTA4-95	196.8	95			1	4.20kg	1465
308146	BT50-MTA4-180	281.8	180	63	44.399	2	5.50kg	1775
308148	BT50-MTA5-105	206.8	105			1	4.30kg	1655

## NT/MTA

Morse Taper Adapter



☞ Pull Stud : P03-P04  
Locking Device : P09

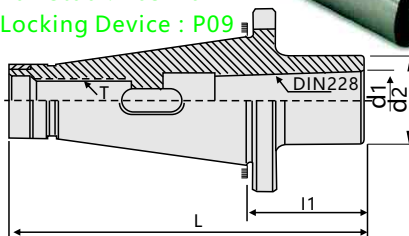

### Characteristic :

- Hardened and precision grinding (inside and outside).
- True roundness : 0.005mm.
- MTA=TANG Type=DIN 228-B.
- MTB=Pull rod type=DIN 228-A
- Adopt advanced tool steel after complete quenching and grinding.  
Hole And Excircle Morse taper.

When ordering, please confirm the pull rod screw specification for metric or Inch.

Unit:mm

Order No.	Model	L	l1	d1	d2	T	WG	Price
308200	NT30-MTA2	123.9	55.5	17.78	32	M12(M12*1.75P)	0.50kg	520
308202	NT30-MTA3	142.4	74	23.825	40	A04(1/2"-12)	0.55kg	565
308204	NT40-MTA2	118.4	25	17.78	32	M16(M16*2.0P)	0.80kg	605
308206	NT40-MTA3	140.4	47	13.825	40		0.85kg	665
308208	NT40-MTA4	175.4	82	31.267	48	A06(5/8"-11)	1.25kg	720
308210	NT40-MTA5	263.4	170	44.399	63		1.45kg	920
308212	NT50-MTA2	146.8	20	17.78	32	M24(M24*3.0P)	2.80kg	1145
308214	NT50-MTA3	156.8	30	13.825	40		2.90kg	1130
308216	NT50-MTA4	186.8	60	31.267	48	A07(1"-8)	3.00kg	1290
308218	NT50-MTA5	209.8	86.2	44.399	63		3.10kg	1335



## DAT/MTA

### Morse Taper Adapter

☞ Pull Stud : P03-P04  
Locking Device : P09

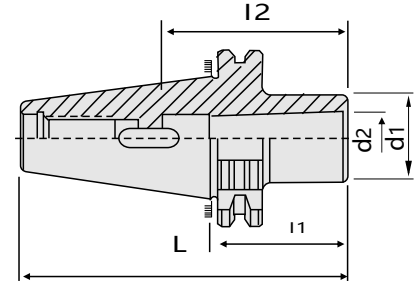
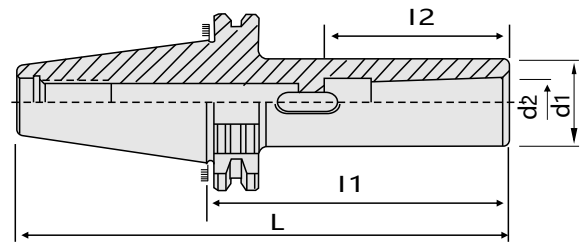

#### Characteristic :

- High precision work flow, even if the use of lengthened drill, concentricity is still in 0.015mm.
- Morse taper shank drill bit.

Order No.	Model	L	L2	d1	d2	WG	Price
308300	DAT30-MTA1-50	97.8	56	25	12.065	0.55kg	495
308302	DAT30-MTA2-60	117.8	67	32	17.78	0.80kg	510
308304	DAT30-MTA3-75	122.8	84	40	23.825	1.00kg	535
308306	DAT40-MTA1-50	118.4	56	25	12.065	1.20kg	640
308308	DAT40-MTA2-50	118.4	67	32	17.78	1.00kg	610
308310	DAT40-MTA3-70	138.4	84	40	23.825	1.10kg	645
308312	DAT40-MTA4-95	163.4	107	48	31.627	1.35kg	685
308314	DAT50-MTA1-45	146.75	56	25	12.065	3.00kg	1190
308316	DAT50-MTA2-60	161.75	67	32	17.78	3.10kg	1230
308318	DAT50-MTA3-65	166.75	84	40	23.825	3.20kg	1550
308320	DAT50-MTA4-95	196.75	107	48	31.627	3.40kg	1335
308322	DAT50-MTA5-105	206.75	133	63	44.399	3.60kg	1465

## HSK/MTA

### Morse Taper Adapter

#### Characteristic :

- The rotation of the cutter rod is detected by the balancing machine.
- True roundness : 0.005mm.
- MTA=TANG Type=DIN 228-B
- Morse taper shank drill bit.



☞ Pull Stud : P03-P04  
Locking Device : P09

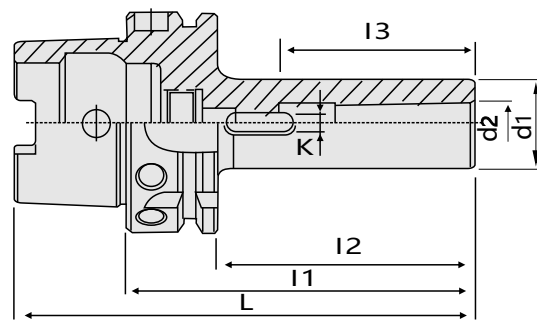

Order No.	Model	L	L2	L3	d1	d2	K	WG	Price
308400	HSK50A-MTA1-100	125	74	56	25	12.065	5.2	1.5kg	1406
308402	HSK50A-MTA2-120	145	94	67	32	17.78	6.3	1.8kg	1475
308404	HSK50A-MTA3-140	165	114	84	40	23.825	7.9	1.9kg	1550
308406	HSK63A-MTA1-100	132	74	56	25	12.065	5.2	1.9kg	1675
308408	HSK63A-MTA2-120	152	94	67	32	17.78	6.3	2.0kg	1756
308410	HSK63A-MTA3-140	172	114	84	40	23.825	7.9	2.2kg	1869
308412	HSK63A-MTA4-160	192	134	107	48	31.627	11.9	2.5kg	2019
308414	HSK100A-MTA1-110	160	81	56	25	12.065	5.2	3.4kg	3475
308416	HSK100A-MTA2-120	170	91	67	32	17.78	6.3	3.8kg	3600
308418	HSK100A-MTA3-150	200	121	84	40	23.825	7.9	4.0kg	3981
308420	HSK100A-MTA4-170	220	141	107	48	31.627	11.9	4.6kg	4256
308422	HSK100A-MTA5-200	250	171	135	63	44.399	15.9	5.2kg	4700



## MT Morse Taper Sleeve

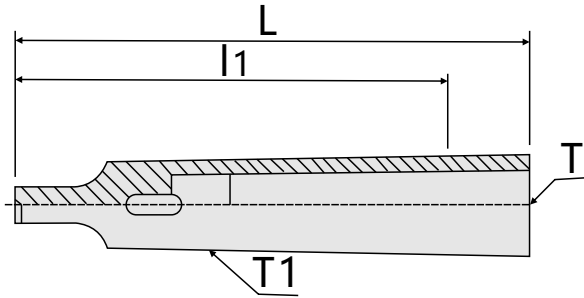

Order No.	Model	T	T1	L	l1	Price
308500	MT1-MT2	MT1	MT2	89	75	
308502	MT1-MT3	MT1	MT3	100	94	
308504	MT2-MT3	MT2	MT3	112	94	
308506	MT1-MT4	MT1	MT4	124	117.5	
308508	MT2-MT4	MT2	MT4	124	117.5	
308510	MT3-MT4	MT3	MT4	140	117.5	
308512	MT1-MT5	MT1	MT5	156	149	
308514	MT2-MT5	MT2	MT5	156	149	
308516	MT3-MT5	MT3	MT5	156	149	
308518	MT4-MT5	MT4	MT5	167	149	
308520	MT4-MT6	MT4	MT6	220	210	
308522	MT5-MT6	MT5	MT6	224	210	

## R8/MT R8 Drill Sleeve

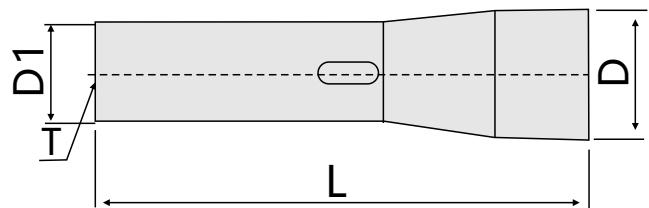

Order No.	Model	L	D	D1	T	Price
308600	R8-MT1	124	32	24.1	7/16"UNF20	
308602	R8-MT2	136.5				
308604	R8-MT3	150				
308606	R8-MT4	245				

## MT2-5 Angle extractor Drift



### Characteristic :

- This product is made of special steel by precision die forging, the tip part of the heat treatment, hard and durable, handle the use of high toughness spring, great power, easy to retreat knife.

Order No.	Model	Applicable slope	long	N.W	1 pcs box size	20 PCS box size	Price
308650	MT2-5	M.T.#2 #3 #4 #5	380mm	1.3kg	390x45x37mm	410x200x225mm	

## BT-MTB MOSE TAPER SLEEVE



- ◆ When the cutting tool is installing, please lock the gib screw which the hilt upper garment knife uses.
- ◆ When disassembles the cutting tool, relaxes the tautness bolt first 2-3, then in the hilt head part with the clock sub-rap, after relaxing the contact face, then turns the loose bolt, takes out the cutting tool.

☞ Pull Stud : P03-P04  
Locking Device : P09

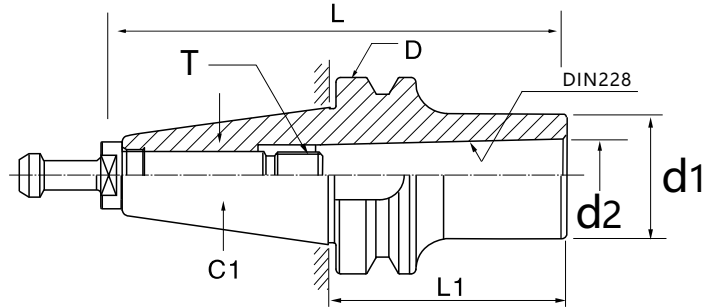
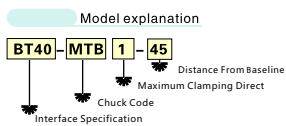

### Characteristic :

- High precision work flow, even if the use of lengthened drill, concentricity is still in 0.015mm.
- Back pull type inclined shank drill.

Order No.	Model	L	L1	d1	d2	T	WG	Price
308700	BT30-MTB1-45	93.4	45	25	12.065	M6(M6*1.0P) A01(1/4"-20)	0.55kg	405
308702	BT30-MTB2-60	108.4	60	32	17.78	M10(M10*1.5P) A02(3/8"-16)	0.60kg	535
308704	BT40-MTB1-45	110.4	45	25	12.065	M6(M6*1.0P) A01(1/4"-20)	1.05kg	945
308706	BT40-MTB2-45	110.4	45	32	17.78	M10(M10*1.5P) A02(3/8"-16)	1.85kg	695
308708	BT40-MTB2-185	250.4	185	32	17.078	M10(M10*1.5P) A02(3/8"-16)	2.20kg	1000
308710	BT40-MTB3-75	140.4	75	40	23.528	M12(M12*1.75P) A04(1/2"-12)	1.30kg	700
308712	BT40-MTB3-90	155.4	90				1.40kg	900
308714	BT40-MTB3-120	185.4	120				1.80kg	1100
308716	BT40-MTB3-180	245.4	180				2.40kg	1300
308718	BT40-MTB4-100	165.4	100	48	31.267	M16(M16*2.0P) A06(5/8"-11)	1.60kg	900
308720	BT40-MTB4-120	185.4	120				1.80kg	1100
308722	BT40-MTB4-180	245.4	180				2.60kg	1300
308724	BT50-MTB1-45	146.8	45	25	12.065	M6(M6*1.0P) A01(1/4"-20)	3.80kg	1500
308726	BT50-MTB2-45	146.8	45	32	17.78	M10(M10*1.5P) A02(3/8"-16)	3.90kg	2100
308728	BT50-MTB3-60	161.8	60	40	23.825	M12(M12*1.75P) A04(1/2"-12)	3.90kg	2400
308730	BT50-MTB4-75	176.8	75	48	31.267	M16(M16*2.0P) A06(5/8"-11)	4.20kg	2700
308732	BT50-MTB5-120	221.8	120	63	44.399	M24(M24*3.0P) A07(1"-8)	4.30kg	2830

## BT-SLN

BT-SLN Side Lock End Mill Holder

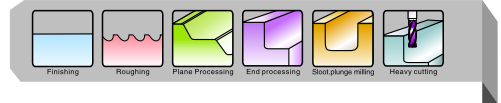

Wrench : P02  
Pull Stud : P03-P04  
Locking Device : P09

Model explanation

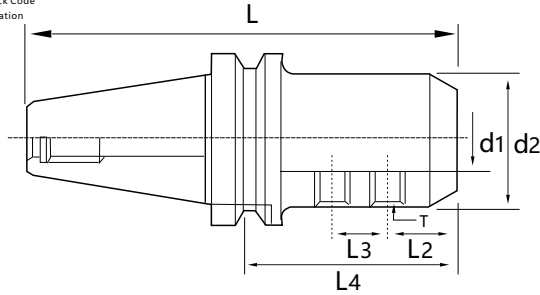
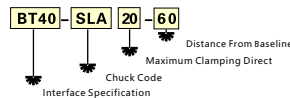

- ◆ When the cutting tool is installing, when edge's notch even face aligns with the hilt side solid bolt, force locking.
- ◆ The side solid-like handle department shape has the difference, the use side solid-like hilt also has the difference, must confirm the side solid-like bolt's position.

Order No.	Model	L	L2	L3	L4	d2	T	图示	WG	Price
308800	BT30-SLN6-60	108.4	18	--	40	25	M6x1.0P	1	0.55kg	440
308802	BT30-SLN8-60	108.4				28	M8x1.25P		0.60kg	445
308804	BT30-SLN10-60	108.4				35	M10x1.5P		0.70kg	445
308806	BT30-SLN12-60	108.4				42	M12x1.75P		0.75kg	445
308808	BT30-SLN16-75	123.4				48	M14x2.0P		1.05kg	570
308810	BT30-SLN20-75	123.4				52	M16x2.0P		1.10kg	575
308812	BT30-SLN25-90	138.4	24	25	59	65	M18x2.0P	2	1.70kg	750
308814	BT40-SLN6-50	115.4	18	--	40	25	M6x1.0P	1	1.10kg	555
308816	BT40-SLN6-150	215.4				28	M8x1.25P		1.32kg	825
308818	BT40-SLN8-50	115.4				35	M10x1.5P		1.10kg	555
308820	BT40-SLN8-150	215.4				42	M12x1.75P		1.30kg	825
308822	BT40-SLN10-63	128.4				48	M14x2.0P		1.25kg	635
308824	BT40-SLN10-150	215.4				52	M16x2.0P		1.40kg	830
308826	BT40-SLN12-63	128.4	24	--	44	35	M10x1.5P	1	1.30kg	635
308828	BT40-SLN12-150	215.4				42	M12x1.75P		1.40kg	830
308830	BT40-SLN16-63	128.4				50	M14x2.0P		1.30kg	635
308832	BT40-SLN16-150	215.4				48	M14x2.0P		1.53kg	830
308834	BT40-SLN18-63	128.4				52	M16x2.0P		1.40kg	635
308836	BT40-SLN20-63	128.4				50	M16x2.0P		1.40kg	635
308838	BT40-SLN25-100	165.4	24	25	59	65	M18x2.0P	2	2.50kg	910
308840	BT40-SLN32-100	165.4		28	63	72	M20x2.0P		2.75kg	955
308842	BT50-SLN6-63	164.8	18	--	40	25	M6x1.0P	1	3.80kg	1465
308844	BT50-SLN8-63	164.8				28	M8x1.25P		3.80kg	1440
308846	BT50-SLN10-63	164.8				35	M10x1.5P		3.00kg	1450
308848	BT50-SLN12-80	181.8				42	M12x1.75P		4.00kg	1590
308850	BT50-SLN16-80	181.8				48	M14x2.0P		4.40kg	1595
308852	BT50-SLN20-80	181.8				52	M16x2.0P		4.40kg	1595
308854	BT50-SLN25-100	201.8	24	25	59	65	M18x2.0P	2	5.10kg	1725
308856	BT50-SLN32-105	206.8		28	63	72	M20x2.0P		5.20kg	1785
308858	BT50-SLN40-115	216.8	30	32	73	90	M20x2.0P	2	6.60kg	2080
308860	BT50-SLN40-120	221.8							6.70kg	2110
308862	BT50-SLN42-120	221.8							6.70kg	2110
308864	BT50-SLN50-120	221.8	35	35	78	100	M24x2.0P	3	6.80kg	2255
308866	BT50-SLN50.8-120	221.8	33.1	28.58	78	95	M20x2.0P		6.80kg	2255
308868	BT50-SLN50.8-120	221.8	33.1	25.58	78	95	M20x2.0P		6.60kg	3110
308870	BT50-SLN63-120	221.8	33.1	25.58	80	125	M16x2.0P	3	6.60kg	3110

## BT/SLN Side Lock End Mill Holder



Wrench : P02  
Pull Stud : P03-P04  
Locking Device : P09

### Characteristic :

- Hole Tolerance : H5
- With side screws
- Central cooling hole ( DIN69871-AD )
- Dynamic balance can be achieved G6.3 , 8000RPM.
- Balance and speed can be based on customer requirements, but the need for a separate offer.

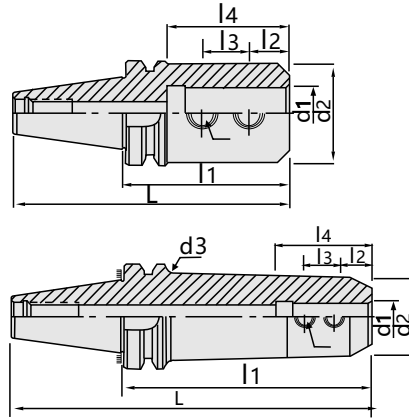

Order No.	Model	L	L2	L3	L4	d2	d3	T	图示	WG	Price
308900	BT40-SLN6-75J	140.4	12	10	45	25	-	M6x1.0P	1	1.30kg	680
308902	BT40-SLN6-150J	215.4	12	10	45	25	30		2	1.50kg	830
308904	BT40-SLN8-75J	140.4	14	12	45	28	-	M8x1.25P	1	1.30kg	680
308906	BT40-SLN8-150J	215.4	14	12	45	28	33		2	1.50kg	830
308908	BT40-SLN10-75J	140.4	15	14	49	35	-	M10x1.05P	1	1.30kg	680
308910	BT40-SLN10-150J	215.4	15	14	49	24	40		2	1.50kg	830
308912	BT40-SLN12-75J	140.4	20	16	54	42	-	M10x1.05P	1	1.50kg	685
308914	BT40-SLN12-150J	215.4	20	16	54	42	47		2	1.70kg	835
308916	BT40-SLN16-75J	140.4	22	18	57	48	-	M12x1.75P	1	1.50kg	685
308918	BT40-SLN16-150J	215.4	22	18	57	48	53		2	1.70kg	835
308920	BT40-SLN20-90J	155.4	25	20	65	50	-	M12x1.75P	1	1.60kg	775
308922	BT40-SLN20-150J	215.4	25	20	65	50	57		2	1.80kg	835
308924	BT40-SLN25-90J	155.4	24	25	68	50	-	M16x2.0P	1	2.50kg	910
308926	BT40-SLN32-100J	165.4	24	28	73	60	47		1	2.75kg	955
308928	BT50-SLN6-75J	176.8	12	10	45	25	47	M6x1.0P	1	3.90kg	1545
308930	BT50-SLN8-75J	176.8	14	12	45	28	47	M8x1.25P	1	3.90kg	1545
308932	BT50-SLN10-75J	176.8	15	14	49	35	47	M10x1.05P	1	3.90kg	1545
308934	BT50-SLN12-90J	191.8	20	16	54	42	47		1	3.90kg	1620
308936	BT50-SLN12-165J	266.8	20	16	54	42	47	M10x1.05P	2	5.00kg	1805
308938	BT50-SLN16-90J	191.8	22	18	57	48	-		1	3.90kg	1620
308940	BT50-SLN16-165J	266.8	22	18	57	48	53	M12x1.75P	2	5.00kg	1845
308942	BT50-SLN20-90J	191.8	25	20	65	50	-		1	4.50kg	1630
308944	BT50-SLN20-165J	266.8	25	20	65	50	57	M12x1.75P	2	6.00kg	1950
308946	BT50-SLN20-210J	311.8	25	20	65	50	57		2	7.00kg	2255
308948	BT50-SLN25-100J	201.8	24	25	68	50	-	M12x1.75P	1	4.5kg	1715
308950	BT50-SLN25-165J	266.8	24	25	68	50	57		2	5.5kg	2035
308952	BT50-SLN25-210J	311.8	24	25	68	50	57	M16x2.0P	2	6.0kg	2360
308954	BT50-SLN25-250J	351.8	24	25	68	50	57		2	7.0kg	2620
308956	BT50-SLN32-105J	351.8	24	28	73	60	-	M16x2.0P	1	4.8kg	1780
308958	BT50-SLN32-165J	266.8	24	28	73	50	60		2	6.2kg	2105
308960	BT50-SLN32-210J	311.8	24	28	73	50	60	M16x2.0P	2	6.3kg	2430
308962	BT50-SLN32-250J	351.8	24	28	73	50	60		2	7.5kg	2715
308964	BT50-SLN32-300J	401.8	24	28	73	60	65	2	8.0kg	3015	

## DAT/SLN Lock End Mill Holder



### Characteristic :

- Hole Tolerance : H5
- The dynamic balance of the shank diameter must conform to DIN-1835-B , And its supporting tools are also consistent with this standard.
- Diameter allowed Tolerance h6~h7 With side screws.
- Dynamic balance can be achieved G6.3 , 8000RPM.
- Balance and speed can be based on customer requirements, but the need for a separate offer.

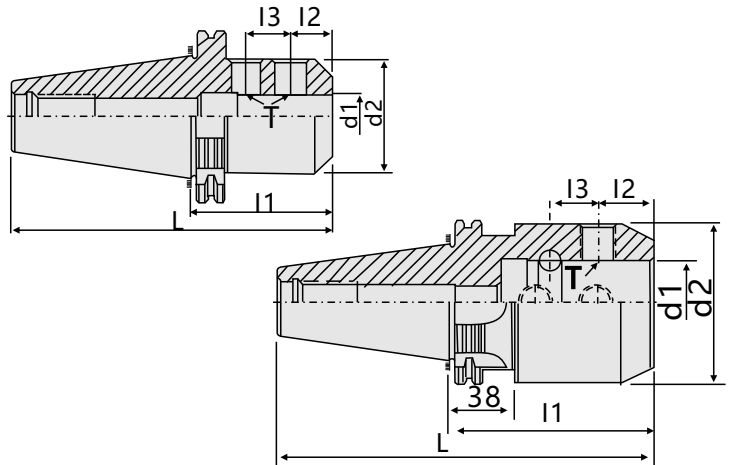

Wrench : P02  
Pull Stud : P03-P04  
Locking Device : P09

Order No.	Model	L	L2	L3	d2	T	图示	WG	Price	
309000	DAT30-SLN6-50	97.8	18	-	25	M6x1.0P	1	0.73kg	540	
309002	DAT30-SLN8-50	97.8	18		28	M18x2.0P		0.80kg	540	
309004	DAT30-SLN10-50	97.8	20		35	M10x1.5P		0.90kg	540	
309006	DAT30-SLN12-50	97.8	22.5		42	M12x1.75P		0.90kg	525	
309008	DAT30-SLN16-63	110.8	24		48	M14x2.0P		1.10kg	550	
309010	DAT40-SLN6-50	118.4	18		25	M6x1.0P		0.85kg	660	
309012	DAT40-SLN8-50	118.4	18		28	M18x2.0P		1.00kg	670	
309014	DAT40-SLN10-50	118.4	20		35	M10x1.5P		1.10kg	670	
309016	DAT40-SLN12-50	118.4	22.5		42	M12x1.75P		1.15kg	655	
309018	DAT40-SLN16-63	131.4	24		48	M14x2.0P		1.40kg	695	
309020	DAT40-SLN20-63	131.4	25		52	M16x2.0P		1.30kg	695	
309022	DAT40-SLN25-100	168.4	24		25	65		M18x2.0P	2.40kg	840
309024	DAT40-SLN32-100	168.4	24	28	72	M20x2.0P	2.70kg	900		
309026	DAT50-SLN6-63	164.75	18	-	25	M6x1.0P	1	3.10kg	1295	
309028	DAT50-SLN8-63	164.75	18		28	M18x2.0P		3.10kg	1295	
309030	DAT50-SLN10-63	164.75	20		35	M10x1.5P		3.30kg	1300	
309032	DAT50-SLN12-63	164.75	22.5		42	M12x1.75P		3.50kg	1670	
309034	DAT50-SLN16-63	164.75	24		48	M14x2.0P		3.45kg	1305	
309036	DAT50-SLN20-63	164.75	25		52	M16x2.0P		3.50kg	1310	
309038	DAT50-SLN25-80	181.75	24		25	65		M18x2.0P	4.20kg	1400
309040	DAT50-SLN32-100	201.75	24		28	72		M20x2.0P	5.00kg	1515
309042	DAT50-SLN40-100	201.75	30		32	90		M20x2.0P	5.60kg	1550
309044	DAT50-SLN42-100	201.75	30		35	90		M20x2.0P	5.70kg	1555
309046	DAT50-SLN50-125	226.75	35		35	100		M24x2.0P	5.90kg	1760
309048	DAT50-SLN50.8-120	221.75	33.1		28.58	95		M20x2.0P	2	5.80kg
309050	DAT50-SLN63-150	250.75	40	40	125	M20x2.0P	1	6.20kg	2395	
309052	DAT50-SLN63-150	250.75	40	24	125	M16x2.0P	1	6.20kg	3305	



NT/SLN

Lock End Mill Holder

Characteristic :

● Hole Tolerance : H5



Wrench : P02  
Pull Stud : P03-P04  
Locking Device : P09

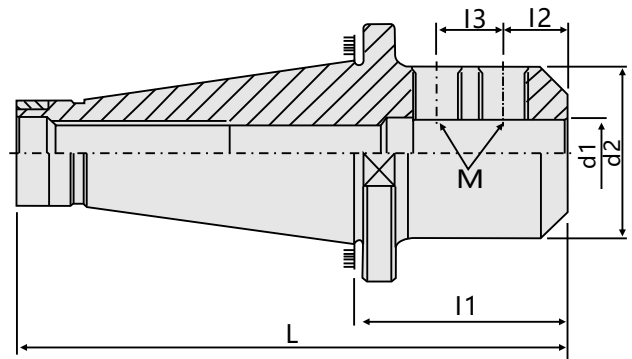

When ordering, please confirm the pull rod screw specification for metric or Inch.

Unit:mm

Order No.	Model	L	d2	l2	l3	M	WG	Price	
309100	NT30-SLN6-40	108.4	25	18	--	M6x1.0P	0.50kg	595	
309102	NT30-SLN8-40		28	18		M8x1.25P	0.60kg	600	
309104	NT30-SLN10-40		35	20		M10x1.5P	0.60kg	600	
309106	NT30-SLN12-50	118.4	42	22.5	--	M12x1.75P	0.65kg	600	
309108	NT30-SLN16-50		48	24		M14x2.0P	0.75kg	600	
309110	NT30-SLN20-63		52	25		M16x2.0P	1.10kg	610	
309112	NT30-SLN25-80	148.4	65	24	25	M18x2.0P	1.20kg	640	
309114	NT40-SLN6-50	143.4	25	18	--	M6x1.0P	0.90kg	705	
309116	NT40-SLN8-50		28	18		M8x1.25P	0.95kg	695	
309118	NT40-SLN10-50		35	20		M10x1.5P	1.10kg	695	
309120	NT40-SLN12-50	156.4	42	22.5	--	M12x1.75P	1.00kg	675	
309122	NT40-SLN16-63		48	24		M14x2.0P	1.40kg	715	
309124	NT40-SLN20-63		52	25		M16x2.0P	1.45kg	745	
309126	NT40-SLN25-80	173.4	65	24	25	M18x2.0P	2.10kg	880	
309128	NT40-SLN32-80		72	24	28	M20x2.0P	2.50kg	955	
309130	NT50-SLN6-63	189.8	25	18	--	M6x1.0P	2.90kg	1490	
309132	NT50-SLN8-63		28	18		M8x1.25P	3.00kg	1480	
309134	NT50-SLN10-63		35	20		M10x1.5P	3.20kg	1485	
309136	NT50-SLN12-63		42	22.5		M12x1.75P	3.30kg	1475	
309138	NT50-SLN16-63		48	24		M14x2.0P	3.50kg	1485	
309140	NT50-SLN20-63		52	25		M16x2.0P	3.60kg	1535	
309142	NT50-SLN25-80	206.8	65	24	25	M18x2.0P	4.20kg	1665	
309144	NT50-SLN32-80		72	24	28	M20x2.0P	4.40kg	1670	
309146	NT50-SLN40-100	226.8	90	30	32	M20x2.0P	4.40kg	1760	
309148	NT50-SLN40-120		90	30			4.20kg	1850	
309150	NT50-SLN42-120		90	30			4.60kg	1715	
309152	NT50-SLN50-120	246.8	100	35	35	M24x2.0P	4.80kg	1855	
309154	NT50-SLN63-120		125	40			40	5.40kg	2665
309156	NT50-SLN50.8-120		95	33.1			28.58	M20x2.0P	5.00kg

## HSK-SLN

HSK-SLN Side Lock End Mill Holder



Wrench : P02  
Pull Stud : P03-P04  
Locking Device : P09

### Characteristic :

- Hole Tolerance : H5
- The dynamic balance of the shank diameter must conform to DIN-1835-B , Shank diameter allow Tolerance within h6~h7.
- Balancing machine detection.
- Dynamic balance can be achieved G6.3 , 8000RPM.
- Balance and speed can be based on customer requirements, but the need for a separate offer.

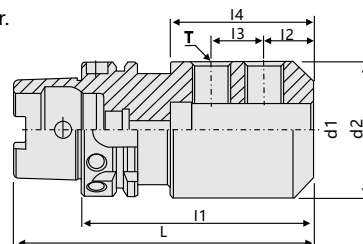
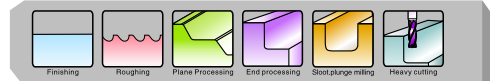

Order No.	Model	L	l2	l3	l4	d2	T	WG	Price			
309200	HSK50A-SLN6-65	90	39	18		25	M6x1.0P	0.7kg	1617			
309202	HSK50A-SLN8-65			18		28	M8x1.25P	0.8kg	1625			
309204	HSK50A-SLN10-65			20		35	M10x1.5P	0.8kg	1592			
309206	HSK50A-SLN12-80	105	54	22.5		42	M12x1.75P	1.2kg	1658			
309208	HSK50A-SLN14-80			22.5		44	M14x2.0P	1.3kg	1667			
309210	HSK50A-SLN16-80			24		48		1.3kg	1675			
309212	HSK50A-SLN18-80			24		50		1.4kg	1683			
309214	HSK50A-SLN20-80			25		52	M16x2.0P	1.5kg	1700			
309216	HSK63A-SLN6-65	97	39	18		25	M6x1.0P	0.9kg	1908			
309218	HSK63A-SLN8-65			18		28	M8x1.25P	1.0kg	1917			
309220	HSK63A-SLN10-65			20		35	M10x1.5P	1.0kg	1883			
309222	HSK63A-SLN12-80			22.5		42	M12x1.75P	1.7kg	2000			
309224	HSK63A-SLN14-80			22.5		44	M14x2.0P	1.7kg	1925			
309226	HSK63A-SLN16-80	24	48	1.7kg	1925							
309228	HSK63A-SLN18-80	24	50	1.8kg	1933							
309230	HSK63A-SLN20-80	112	54	25		52	M16x2.0P	1.8kg	1933			
309232	HSK63A-SLN25-110			24		25	65	M18x2.0P	2.5kg	2433		
309234	HSK63A-SLN32-110			24		28	72	M20x2.0P	2.7kg	2583		
309236	HSK100A-SLN6-80			130		51	18		25	M6x1.0P	3.0kg	3875
309238	HSK100A-SLN8-80						18		28	M8x1.25P	3.2kg	3883
309240	HSK100A-SLN10-80	20	35		M10x1.5P		3.4kg		3892			
309242	HSK100A-SLN12-80	22.5	42		M12x1.75P		3.4kg		3975			
309244	HSK100A-SLN14-80	22.5	44				3.5kg		3983			
309246	HSK100A-SLN16-100	150	71	24		48	M14x2.0P	3.8kg	4158			
309248	HSK100A-SLN18-100			24		50	M16x2.0P	3.8kg	4158			
309250	HSK100A-SLN20-100			25		52		3.9kg	4175			
309252	HSK100A-SLN25-100			24		25	65	M18x2.0P	4.0kg	4242		
309254	HSK100A-SLN32-100			24		28	72	M20x2.0P	4.1kg	4242		
309256	HSK100A-SLN40-120	170	30	32	90	4.4kg	4542					

## INCH

Order No.	Model	L	l2	l3	l4	d2	T	WG	Price	
309300	HSK40A-SLN1/4"-2.5"	3.287	0.63		1.38	0.78	1/4-28	0.31kg	1358	
309302	HSK40A-SLN3/8"-2.5"	3.287	0.75		1.535	1	3/8-24	0.42kg	1325	
309304	HSK40A-SLN1/2"-2.75"	3.537	0.875		1.732	1.25	7/16-20	0.57kg	1342	
309306	HSK40A-SLN5/8"-3"	3.787	0.937		1.85	1.5	1/2-20	0.69kg	1417	
309308	HSK63A-SLN1/4"-3"	4.26	0.63		--	1.38	0.78	1/4-28	0.76kg	1767
309310	HSK63A-SLN3/8"-3"	4.26	0.75	1.535		1	3/8-24	0.88kg	1758	
309312	HSK63A-SLN1/2"-3"	4.26	0.875	1.73		1.25	7/16-20	1.13kg	1742	
309314	HSK63A-SLN5/8"-3.75"	5	0.937	1.85		1.5	1/2-20	1.26kg	1842	
309316	HSK63A-SLN3/4"-3.75"	5	1	1.929		1.75	5/8-18	1.33kg	1858	
309318	HSK63A-SLN1"-3.75"	5	1.125	1	2.559	2	3/4-16	2.30kg	1942	
309320	HSK63A-SLN1-1/4"-4.25"	5.51	1.125		2.559	2.5		2.52kg	2100	
309322	HSK100A-SLN1/4"-3"	4.97	0.63		--	1.38	0.78	1/4-28	2.16kg	3367
309324	HSK100A-SLN3/8"-3"	4.97	0.75	1.535		1	3/8-24	2.31kg	3358	
309326	HSK100A-SLN1/2"-3.25"	5.219	0.875	1.732		1.25	7/16-20	2.45kg	3425	
309328	HSK100A-SLN5/8"-3.75"	5.719	0.937	1.85		1.5	1/2-20	2.84kg	3592	
309330	HSK100A-SLN3/4"-3.75"	5.719	1	1.929		1.75	5/8-18	2.95kg	3608	
309332	HSK100A-SLN1"-4.25"	6.219	1.125	1	2.559	2	3/4-16	3.46kg	3808	
309334	HSK100A-SLN1-1/4"-4.25"	6.219	1.125		2.559	2.5		3.73kg	3842	
309336	HSK100A-SLN1-1/2"-4.5"	6.469	1.125		2.756	2.5	5.51kg	4008		
309338	HSK100A-SLN2"-5.5"	7.469	1.335		1.41	3.347	3.75	1-14	6.37kg	4433

HSK/SLN

Lock End Mill Holder



**Characteristic :**

- Hole Tolerance : H5
- The dynamic balance of the shank diameter must conform to DIN-1835-B , Shank diameter allow Tolerance within h6~h7.
- Side screw angle 2°.
- Balancing machine detection.
- Dynamic balance can be achieved G6.3 , 8000RPM.
- Balance and speed can be based on customer requirements, but the need for a separate offer.

Wrench : P02  
 Pull Stud : P03-P04  
 Locking Device : P09

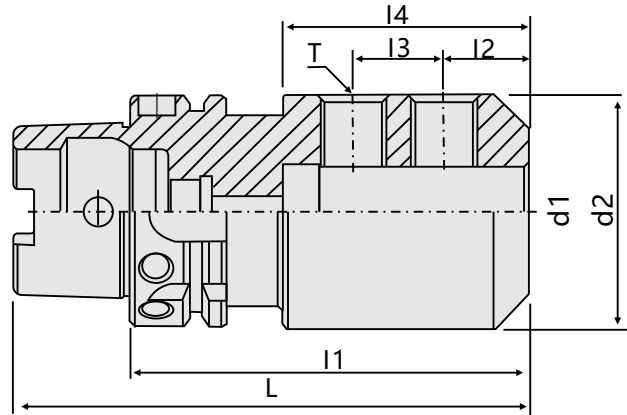

Order No.	Model	L	l2	l3	l4	d2	t	T	WG	Price
309400	HSK50A-SLNB6-80	105	54	18	--	25	M5	M6x1.0P	0.8kg	1675
309402	HSK50A-SLNB8-80			18		28	M6	M8x1.25P	0.9kg	1675
309404	HSK50A-SLNB10-80			20		35	M8	M10x1.5P	0.9kg	1658
309406	HSK50A-SLNB12-90	115	64	22.5	--	42	M10	M12x1.75P	1.3kg	1700
309408	HSK50A-SLNB14-90			22.5		44			1.4kg	1975
309410	HSK50A-SLNB16-90			24		48	M12	M14x2.0P	1.4kg	1775
309412	HSK50A-SLNB18-90	24	50	1.6kg	1792					
309414	HSK50A-SLNB20-100	125	74	25	--	52	M16	M16x2.0P	1.7kg	1833
309416	HSK63A-SLNB6-80	112	54	18	--	25	M5	M6x1.0P	1.0kg	2425
309418	HSK63A-SLNB8-80			18		28	M6	M8x1.25P	1.1kg	2433
309420	HSK63A-SLNB10-80			20		35	M8	M10x1.5P	1.1kg	2400
309422	HSK63A-SLNB12-90	122	64	22.5	--	42	M10	M12x1.75P	2.0kg	2525
309424	HSK63A-SLNB14-90			22.5		44			2.0kg	2525
309426	HSK63A-SLNB16-100	132	74	24	--	48	M12	M14x2.0P	2.0kg	2583
309428	HSK63A-SLNB18-100			24		50			2.1kg	2592
309430	HSK63A-SLNB20-100			25		52	M16	M16x2.0P	2.1kg	2592
309432	HSK63A-SLNB25-110	142	84	24	25	65	M20	M18x2.0P	2.6kg	2575
309434	HSK63A-SLNB32-110			24	28	72		M20x2.0P	2.8kg	3083
309436	HSK100A-SLNB6-90	140	61	18	--	25	M5	M6x1.0P	3.4kg	4758
309438	HSK100A-SLNB8-90			18		28	M6	M8x1.25P	3.5kg	4758
309440	HSK100A-SLNB10-90			20		35	M8	M10x1.5P	3.8kg	4758
309442	HSK100A-SLNB12-100	150	71	22.5	--	42	M10	M12x1.75P	3.8kg	4725
309444	HSK100A-SLNB14-100			22.5		44			4.0kg	4750
309446	HSK100A-SLNB16-100			24		48	M12	M14x2.0P	4.0kg	4758
309448	HSK100A-SLNB18-100			24		50			4.0kg	4758
309450	HSK100A-SLNB20-110	160	81	25	--	52	M16	M16x2.0P	4.2kg	5075
309452	HSK100A-SLNB25-120	170	91	24	25	65	M20	M18x2.0P	4.4kg	5325
309454	HSK100A-SLNB32-120			24	28	72		M20x2.0P	4.5kg	5342
309456	HSK100A-SLNB40-120			30	32	90		M20x2.0P	5.0kg	5392

## BT/OSL Lock Oil Hole Holder



Wrench : P02  
Pull Stud : P03-P04  
Locking Device : P09

### Characteristic :

- When ordering, please confirm "S" (center distance).
- Please confirm the high voltage device of the machining center before use. Withstand water pressure above 7kgf/cm<sup>2</sup>. Max speed: 3000rpm. The hydraulic oil knife can be based on customer requirements, but need to quote separately.

Unit:mm

Order No.	Model	l1	l2	l3	D	d2	S	T	N.W.	Price
309500	BT40-OSL16-165	48	25	-	82	46.5	65	M12x1.75P	3.1kg	4665
309502	BT40-OSL20-165	50							3.5kg	4670
309504	BT40-OSL25-165	56	15	20				47	M16x2.0P	3.5kg
309506	BT40-OSL32-165	60				3.5kg	4670			
309508	BT40-OSL16-165S	48	25	-		48	60		M12x1.75P	3.1kg
309510	BT40-OSL20-165S	50						3.5kg		5535
309512	BT40-OSL25-165S	56	15	20	49.5			M12x1.75P	3.5kg	5535
309514	BT40-OSL32-165S	60				3.8kg	5540			
309516	BT50-OSL16-165	48	25	-		98	58	80	M14x2.0P	7.0kg
309518	BT50-OSL20-165	50			7.5kg					6175
309520	BT50-OSL25-165	56	15	20	M16x2.0P				7.5kg	6175
309522	BT50-OSL32-165	60							7.8kg	6180
309524	BT50-OSL40-170	62	15	25	105	56	M14x2.0P	8.5kg	6195	
309526	BT50-OSL16-165M	48	25	-	98	58	82	M12x1.75P	7.1kg	7585
309528	BT50-OSL20-165M	50							7.6kg	7595
309530	BT50-OSL25-165M	56	15	20				M16x2.0P	7.7kg	7595
309532	BT50-OSL32-165M	60							7.8kg	7595
309534	BT50-OSL40-170M	62	15	25	105	56	M14x2.0P	8.5kg	7610	
309536	BT50-OSL16-165L	48	25	-	98	58	85	M12x1.75P	7.2kg	7585
309538	BT50-OSL20-165L	50							7.8kg	7595
309540	BT50-OSL25-165L	56	15	20				M16x2.0P	7.8kg	7595
309542	BT50-OSL32-165L	60							8.0kg	7600
309544	BT50-OSL40-170L	62	15	25	105	56	M14x2.0P	8.7kg	7615	

**OSL  
Straight sleeve**

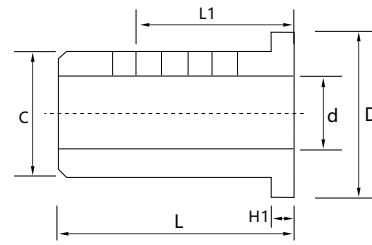

Unit:mm

Order No.	Model	l1	L	D	l2	N.W.	Price
309600	OSL-20-16	48	54	30	5.5	0.07kg	305
309602	OSL-25-16	48	60	35		0.19kg	310
309604	OSL-25-20	50				0.15kg	305
309606	OSL-32-16	48				0.35kg	310
309608	OSL-32-20	50	64	42		0.32kg	310
309610	OSL-32-25	56				0.22kg	310
309612	OSL-40-16	48				0.57kg	405
309614	OSL-40-20	50	75	50		0.54kg	405
309616	OSL-40-25	56				0.45kg	405
309618	OSL-40-32	60				0.30kg	400

**BT/OHER  
Oil hole collet chuck**

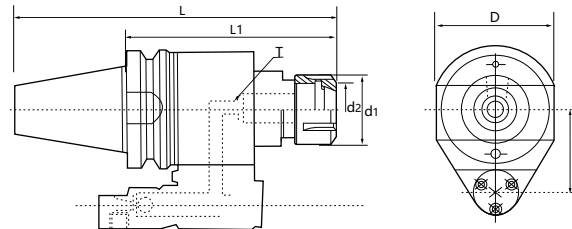

- Wrench : P02
- Collet : P05-P06
- Nut : P02
- Pull Stud : P03-P04
- Locking Device : P09

Unit:mm

Order No.	Model	L	l1	D	d1	d2	B	T	N.W.	Price
309700	BT40-OHER16-160	225.4	160	82	28	16	65	M10	3.80kg	4755
309702	BT40-OHER20-160				34	20		M12	4.10kg	4765
309704	BT40-OHER25-160				42	25		M16	4.30kg	4785
309706	BT40-OHER32-160				50	32		4.50kg	4820	
309708	BT50-OHER16-160	261.8	160	98	28	16	80	M10	7.00kg	6165
309710	BT50-OHER20-160				34	20		M12	7.10kg	6165
309712	BT50-OHER25-160				42	25		M16	7.20kg	6180
309714	BT50-OHER32-160				50	32		7.30kg	6205	
309716	BT50-OHER40-160				63	40		M20	7.50kg	6140