

TAF Disposable Fast Drill

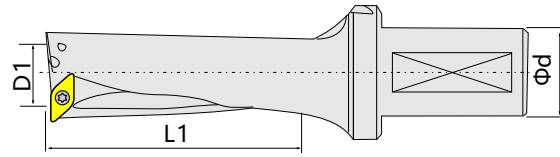

Note: the U series is ideal for machining stainless steel.

Model No	Insert	parts	(d) Interface	D1	D×2				D×3				D×4			
					Order	Type	L1	Price	Order	Type	L1	Price	Order	Type	L1	Price
TAF	GCMT 040204-U..	M2.0x4 T6	(20) PT 1/8	12.0	556100	S1200F20	29	1100	556300	M1200F20	41	1320	556500	L1200F20	55	1584
TAF				12.5	556102	S1250F20	29	1100	556302	M1250F20	41	1320	556502	L1250F20	55	1584
TAF				13.0	556104	S1300F20	31	1100	556304	M1300F20	44	1320	556504	L1300F20	60	1584
TAF				13.5	556106	S1350F20	31	1100	556306	M1350F20	44	1320	556506	L1350F20	60	1584
TAF				14.0	556108	S1400F20	33	1100	556308	M1400F20	47	1320	556508	L1400F20	60	1584
TAF				14.5	556110	S1450F20	33	1100	556310	M1450F20	47	1320	556510	L1450F20	60	1584
TAF				15.0	556112	S1500F20	35	900	556312	M1500F20	50	1080	556512	L1500F20	70	1296
TAF				15.5	556114	S1550F20	35	900	556314	M1550F20	50	1080	556514	L1550F20	70	1296
TAF				16.0	556116	S1600F25	38	900	556316	M1600F25	54	1080	556516	L1600F25	75	1296
TAF				16.5	556118	S1650F25	38	900	556318	M1650F25	54	1080	556518	L1650F25	75	1296
TAF	GPMT 060204-U..	M2.5x6 T8	(25) PT 1/8	17.0	556120	S1700F25	41	900	556320	M1700F25	58	1080	556520	L1700F25	75	1296
TAF				17.5	556122	S1750F25	41	900	556322	M1750F25	58	1080	556522	L1750F25	75	1296
TAF				18.0	556124	S1800F25	43	900	556324	M1800F25	61	1080	556524	L1800F25	79	1296
TAF				18.5	556126	S1850F25	43	900	556326	M1850F25	61	1080	556526	L1850F25	79	1296
TAF				19.0	556128	S1900F25	46	900	556328	M1900F25	65	1080	556528	L1900F25	84	1296
TAF				19.5	556130	S1950F25	46	900	556330	M1950F25	65	1080	556530	L1950F25	84	1296
TAF				20.0	556132	S2000F25	48	900	556332	M2000F25	68	1080	556532	L2000F25	88	1296
TAF				20.5	556134	S2050F25	48	1000	556334	M2050F25	68	1200	556534	L2050F25	88	1440
TAF				21.0	556136	S2100F25	50	1000	556336	M2100F25	71	1200	556536	L2100F25	92	1440
TAF				21.5	556138	S2150F25	50	1000	556338	M2150F25	71	1200	556538	L2150F25	92	1440
TAF	GPMT 070204-U..	M3.0x8 T8	(32) PT 1/8	22.0	556140	S2200F25	53	1000	556340	M2200F25	75	1200	556540	L2200F25	97	1440
TAF				22.5	556142	S2250F25	53	1000	556342	M2250F25	75	1200	556542	L2250F25	97	1440
TAF				23.0	556144	S2300F25	55	1000	556344	M2300F25	78	1200	556544	L2300F25	101	1440
TAF				23.5	556146	S2350F25	55	1000	556346	M2350F25	78	1200	556546	L2350F25	101	1440
TAF				24.0	556148	S2400F25	58	1000	556348	M2400F25	82	1200	556548	L2400F25	106	1440
TAF				24.5	556150	S2450F25	58	1000	556350	M2450F25	82	1200	556550	L2450F25	106	1440
TAF				25.0	556152	S2500F32	60	1000	556352	M2500F32	85	1200	556552	L2500F32	110	1440
TAF				25.5	556154	S2550F32	60	1000	556354	M2550F32	85	1200	556554	L2550F32	110	1440
TAF				26.0	556156	S2600F32	62	1200	556356	M2600F32	88	1440	556556	L2600F32	114	1728
TAF				26.5	556158	S2650F32	62	1200	556358	M2650F32	88	1440	556558	L2650F32	114	1728
TAF	GPMT 090304-U..	M4.0x9 T15	(32) PT 1/8	27.0	556160	S2700F32	65	1200	556360	M2700F32	92	1440	556560	L2700F32	119	1728
TAF				27.5	556162	S2750F32	65	1200	556362	M2750F32	92	1440	556562	L2750F32	119	1728
TAF				28.0	556164	S2800F32	67	1200	556364	M2800F32	95	1440	556564	L2800F32	123	1728
TAF				28.5	556166	S2850F32	67	1200	556366	M2850F32	95	1440	556566	L2850F32	123	1728
TAF				29.0	556168	S2900F32	70	1200	556368	M2900F32	99	1440	556568	L2900F32	128	1728
TAF				29.5	556170	S2950F32	70	1200	556370	M2950F32	99	1440	556570	L2950F32	128	1728
TAF				30.0	556172	S3000F40	82	1200	556372	M3000F40	102	1440	556572	L3000F40	132	1728
TAF				31.0	556174	S3100F40	74	1300	556374	M3100F40	105	1560	556574	L3100F40	136	1872
TAF				32.0	556176	S3200F40	77	1300	556376	M3200F40	109	1560	556576	L3200F40	141	1872
TAF				33.0	556178	S3300F40	79	1300	556378	M3300F40	112	1560	556578	L3300F40	145	1872
TAF	GPMT 11T308-U..	M5.5x12 T20	(40) PT 1/4	34.0	556180	S3400F40	82	1300	556380	M3400F40	116	1560	556580	L3400F40	150	1872
TAF				35.0	556182	S3500F40	84	1300	556382	M3500F40	119	1560	556582	L3500F40	150	1872
TAF				36.0	556184	S3600F40	86	1500	556384	M3600F40	122	1800	556584	L3600F40	154	2160
TAF				37.0	556186	S3700F40	89	1500	556386	M3700F40	126	1800	556586	L3700F40	158	2160
TAF				38.0	556188	S3800F40	91	1500	556388	M3800F40	129	1800	556588	L3800F40	162	2160
TAF				39.0	556190	S3900F40	94	1500	556390	M3900F40	133	1800	556590	L3900F40	166	2160
TAF				40.0	556192	S4000F40	96	1500	556392	M4000F40	136	1800	556592	L4000F40	170	2160
TAF				41.0	556194	S4100F40	98	1800	556394	M4100F40	139	2160	556594	L4100F40	174	2592
TAF				42.0	556196	S4200F40	101	1800	556396	M4200F40	143	2160	556596	L4200F40	178	2592
TAF				43.0	556198	S4300F40	103	1800	556398	M4300F40	146	2160	556598	L4300F40	182	2592
TAF	GPMT 140408-U..	M3.0x8 T8	(40) PT 1/4	44.0	556200	S4400F40	106	1800	556400	M4400F40	150	2160	556600	L4400F40	186	2592
TAF				45.0	556202	S4500F40	108	1800	556402	M4500F40	153	2160	556602	L4500F40	190	2592
TAF				46.0	556204	S4600F40	110	2000	556404	M4600F40	156	2400	556604	L4600F40	194	2880
TAF				47.0	556206	S4700F40	113	2000	556406	M4700F40	160	2400	556606	L4700F40	198	2880
TAF				48.0	556208	S4800F40	115	2000	556408	M4800F40	163	2400	556608	L4800F40	202	2880
TAF				49.0	556210	S4900F40	118	2000	556410	M4900F40	167	2400	556610	L4900F40	206	2880
TAF				50.0	556212	S5000F40	120	2000	556412	M5000F40	170	2400	556612	L5000F40	210	2880
TAF				51.0	556214	S5100F40	122	2500	556414	M5100F40	173	3000	556614	L5100F40	214	3600
TAF				52.0	556216	S5200F40	125	2500	556416	M5200F40	177	3000	556616	L5200F40	218	3600
TAF				53.0	556218	S5300F40	127	2500	556418	M5300F40	180	3000	556618	L5300F40	222	3600
TAF	GPMT 090304-U..	M3.0x8 T8	(40) PT 1/4	54.0	556220	S5400F40	128	2500	556420	M5400F40	182	3000	556620	L5400F40	226	3600
TAF				55.0	556222	S5500F40	130	3000	556422	M5500F40	185	3600	556622	L5500F40	230	4320
TAF				56.0	556224	S5600F40	132	3000	556424	M5600F40	188	3600	556624	L5600F40	234	4320

Abandon Type Drill

WD Disposable Fast Drill

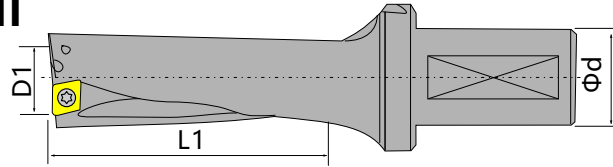
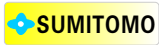

Model No	Insert	parts	d	D1	D×2		D×3		D×4		D×5					
					Type	L1	Price	Type	L1	Price	Type	L1	Price	Type	L1	Price
WDX 130	WDXT 042004	M1.6x4 T6	20	13.0	D2S20	29	4066	D3S20	42.0	4275	D4S20	55	4920	D5S20	68.0	5352
WDX 135				13.5	D2S20	30	4066	D3S20	43.5	4275	D4S20	57	4920	D5S20	70.5	5352
WDX 140				14.0	D2S20	31	4066	D3S20	45.0	4275	D4S20	59	4920	D5S20	73.0	5352
WDX 145				14.5	D2S20	32	4066	D3S20	46.5	4275	D4S20	61	4920	D5S20	75.5	5352
WDX 150				15.0	D2S20	33	4066	D3S20	48.0	4275	D4S20	63	4920	D5S20	78.0	5352
WDX 155	WDXT 052504	M2.0x4 T6	20	15.5	D2S20	34	4160	D3S20	49.5	4379	D4S20	65	5039	D5S20	80.5	5471
WDX 160				16.0	D2S20	35	4160	D3S20	51.0	4379	D4S20	67	5039	D5S20	83.0	5471
WDX 165				16.5	D2S20	36	4160	D3S20	52.5	4379	D4S20	69	5039	D5S20	85.5	5471
WDX 170				17.0	D2S20	37	4160	D3S20	54.0	4379	D4S20	71	5039	D5S20	88.0	5471
WDX 175				17.5	D2S25	38	4361	D3S25	55.5	4588	D4S25	73	5278	D5S25	90.5	5736
WDX 180	WDXT 063006	M2.2x6 T7	25	18.0	D2S25	39	4361	D3S25	57.0	4588	D4S25	75	5278	D5S25	93.0	5736
WDX 185				18.5	D2S25	40	4461	D3S25	58.5	4689	D4S25	77	5397	D5S25	95.5	5867
WDX 190				19.0	D2S25	41	4461	D3S25	60.0	4689	D4S25	79	5397	D5S25	98.0	5867
WDX 195				19.5	D2S25	42	4461	D3S25	61.5	4689	D4S25	81	5397	D5S25	100.5	5867
WDX 200				20.0	D2S25	43	4461	D3S25	63.0	4689	D4S25	83	5397	D5S25	103.0	5867
WDX 205	WDXT 073506	M2.5x6 T8	32	20.5	D2S25	44	4461	D3S25	64.5	4689	D4S25	85	5397	D5S25	105.5	5867
WDX 210				21.0	D2S25	45	4461	D3S25	66.0	4689	D4S25	87	5397	D5S25	108.0	5867
WDX 215				21.5	D2S25	46	4461	D3S25	67.5	4689	D4S25	89	5397	D5S25	110.5	5867
WDX 220				22.0	D2S25	47	4461	D3S25	69.0	4689	D4S25	91	5397	D5S25	113.0	5867
WDX 225				22.5	D2S25	48	4461	D3S25	70.5	4689	D4S25	93	5397	D5S25	115.5	5867
WDX 230	WDXT 094008	M3.5x8 T15	40	23.0	D2S25	49	4558	D3S25	72.0	4797	D4S25	95	5512	D5S25	118.0	5993
WDX 235				23.5	D2S25	50	4558	D3S25	73.5	4797	D4S25	97	5512	D5S25	120.5	5993
WDX 240				24.0	D2S25	51	4558	D3S25	75.0	4797	D4S25	99	5512	D5S25	123.0	5993
WDX 245				24.5	D2S25	52	4558	D3S25	76.5	4797	D4S25	101	5512	D5S25	125.5	5993
WDX 250				25.0	D2S25	53	4558	D3S25	78.0	4797	D4S25	103	5512	D5S25	128.0	5993
WDX 255	WDXT 125012	M5.0x12 T15	40	25.5	D2S32	54	4752	D3S32	79.5	5002	D4S32	105	5755	D5S32	-	-
WDX 260				26.0	D2S32	55	4752	D3S32	81.0	5002	D4S32	107	5755	D5S32	133	6254
WDX 265				26.5	D2S32	56	4752	D3S32	82.5	5002	D4S32	109	5755	D5S32	-	-
WDX 270				27.0	D2S32	57	4752	D3S32	84.0	5002	D4S32	111	5755	D5S32	138	6254
WDX 275				27.5	D2S32	58	4752	D3S32	85.5	5002	D4S32	113	5755	D5S32	-	-
WDX 280	WDXT 156012	M6.0x15 T15	40	28.0	D2S32	59	4752	D3S32	87.0	5002	D4S32	115	5755	D5S32	143	6254
WDX 285				28.5	D2S32	60	4752	D3S32	88.5	5002	D4S32	117	5755	D5S32	-	-
WDX 290				29.0	D2S32	62	4752	D3S32	91.0	5002	D4S32	120	5755	D5S32	149	6254
WDX 295				29.5	D2S32	63	4752	D3S32	92.5	5002	D4S32	122	5755	D5S32	-	-
WDX 300				30.0	D2S32	64	-	D3S32	94.0	-	D4S32	124	6400	D5S32	154	6776
WDX 310	WDXT 186012	M6.0x15 T15	40	31.0	D2S32	66	-	D3S32	97.0	-	D4S32	128	6250	D5S32	159	6776
WDX 320				32.0	D2S32	68	-	D3S32	100	-	D4S32	132	6400	D5S32	164	6776
WDX 300				30.0	D2S40	64	5147	D3S40	94.0	5423	D4S40	124	6250	D5S40	154	6776
WDX 310				31.0	D2S40	66	5147	D3S40	97.0	5423	D4S40	128	6400	D5S40	159	6776
WDX 320				32.0	D2S40	68	5147	D3S40	100	5423	D4S40	132	6250	D5S40	164	6776
WDX 330	WDXT 156012	M6.0x15 T15	40	33.0	D2S40	70	5147	D3S40	103	5423	D4S40	136	6250	D5S40	169	6776
WDX 340				34.0	D2S40	72	5147	D3S40	106	5423	D4S40	140	6250	D5S40	174	6776
WDX 350				35.0	D2S40	74	5147	D3S40	109	5423	D4S40	144	6250	D5S40	179	6776
WDX 360				36.0	D2S40	76	5147	D3S40	112	5423	D4S40	148	6250	D5S40	184	6776
WDX 370				37.0	D2S40	79	5941	D3S40	116	6254	D4S40	153	7190	D5S40	190	
WDX 380	WDXT 186012	M6.0x15 T15	40	38.0	D2S40	81	5941	D3S40	119	6254	D4S40	157	7190	D5S40	195	
WDX 390				39.0	D2S40	83	5941	D3S40	122	6254	D4S40	161	7190	D5S40	200	
WDX 400				40.0	D2S40	85	5941	D3S40	125	6254	D4S40	165	7190	D5S40	205	
WDX 410				41.0	D2S40	87	5941	D3S40	128	6254	D4S40	169	7190	D5S40	210	
WDX 420				42.0	D2S40	89	5941	D3S40	131	6254	D4S40	173	7190	D5S40	215	
WDX 430	WDXT 186012	M6.0x15 T15	40	43.0	D2S40	91	5941	D3S40	134	6254	D4S40	177	7190	D5S40	220	
WDX 440				44.0	D2S40	93	5941	D3S40	137	6254	D4S40	181	7190	D5S40	225	
WDX 450				45.0	D2S40	95	5941	D3S40	140	6254	D4S40	185	7190	D5S40	230	
WDX 460				46.0	D2S40	97	6444	D3S40	143	6776	D4S40	189	7797	D5S40	235	
WDX 470				47.0	D2S40	99	6444	D3S40	146	6776	D4S40	193	7797	D5S40	240	
WDX 480	WDXT 186012	M6.0x15 T15	40	48.0	D2S40	101	6444	D3S40	149	6776	D4S40	197	7797	D5S40	245	
WDX 490				49.0	D2S40	103	6444	D3S40	152	6776	D4S40	201	7797	D5S40	250	
WDX 500				50.0	D2S40	105	6444	D3S40	155	6776	D4S40	205	7797	D5S40	255	
WDX 510				51.0	D2S40	107	6765	D3S40	158	7115	D4S40	209	8192	D5S40	260	
WDX 520				52.0	D2S40	109	6765	D3S40	161	7115	D4S40	213	8192	D5S40	265	
WDX 530	WDXT 186012	M6.0x15 T15	40	53.0	D2S40	111	6765	D3S40	164	7115	D4S40	217	8192	D5S40	270	
WDX 540				54.0	D2S40	113	6765	D3S40	167	7115	D4S40	221	8192	D5S40	275	
WDX 550				55.0	D2S40	115	6765	D3S40	170	7115	D4S40	225	8192	D5S40	280	
WDX 560				56.0	D2S40	120	7611	D3S40	176	8442	D4S40	232	9642	D5S40		
WDX 570				57.0	D2S40	122	7611	D3S40	179	8442	D4S40	236	9642	D5S40		
WDX 580	WDXT 186012	M6.0x15 T15	40	58.0	D2S40	124	7611	D3S40	182	8442	D4S40	240	9642	D5S40		
WDX 590				59.0	D2S40	126	7611	D3S40	185	8442	D4S40	244	9642	D5S40		
WDX 600				60.0	D2S40	128	7611	D3S40	188	8442	D4S40	248	9642	D5S40		
WDX 610				61.0	D2S40	130	7924	D3S40	191	8807	D4S40	252	10112	D5S40		
WDX 620				62.0	D2S40	132	7924	D3S40	194	8807	D4S40	256	10112	D5S40		
WDX 630	WDXT 186012	M6.0x15 T15	40	63.0	D2S40	134	7924	D3S40	197	8807	D4S40	260	10112	D5S40		
WDX 640				64.0	D2S40	136	7924	D3S40	200	8807	D4S40			D5S40		
WDX 650				65.0	D2S40	138	7924	D3S40	203	8807	D4S40			D5S40		

WC Type Disposable Fast Drill

2 Multiple Fast Drill-WC Insert

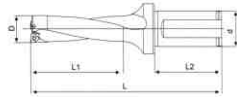

3 Multiple Fast Drill-WC Insert

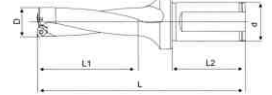

Order	Type Model	L1	L2	L	D	d	Applicable to insert	screw	Wrench	Price
503100	ZD02-14.0-XP25-WC03-02	33	56	106	14	25	WCMT030208	M2.5×6.5	T8	700
503102	ZD02-15.0-XP25-WC03-02	36	58	108	15					700
503104	ZD02-16.0-XP25-WC03-02	37	56	110	16					700
503106	ZD02-17.0-XP25-WC03-02	39	56	112	17					700
503108	ZD02-18.0-XP25-WC03-02	41	56	114	18					700
503110	ZD02-19.0-XP25-WC03-02	43	56	116	19					700
503112	ZD02-20.0-XP25-WC03-02	45	56	119	20					700
503114	ZD02-21.0-XP25-WC03-02	47	56	121	21					875
503116	ZD02-22.0-XP25-WC04-02	49	56	123	22					875
503118	ZD02-23.0-XP25-WC04-02	51	56	125	23					875
503120	ZD02-24.0-XP25-WC04-02	53	56	127	24	875				
503122	ZD02-25.0-XP25-WC05-02	55	60	141	25	32	WCMT040208	M3×7	988	
503124	ZD02-26.0-XP25-WC05-02	57	60	143	26				988	
503126	ZD02-27.0-XP25-WC05-02	59	60	145	27				988	
503128	ZD02-28.0-XP25-WC05-02	61	60	147	28				988	
503130	ZD02-29.0-XP25-WC05-02	63	60	149	29				988	
503132	ZD02-30.0-XP25-WC05-02	65	60	151	30				1150	
503134	ZD02-31.0-XP25-WC05-02	67	60	153	31				1150	
503136	ZD02-32.0-XP25-WC06-02	69	60	155	32				1150	
503138	ZD02-33.0-XP25-WC06-02	71	60	157	33				1150	
503140	ZD02-34.0-XP25-WC06-02	73	60	159	34				1150	
503142	ZD02-35.0-XP25-WC06-02	75	60	161	35	1258				
503144	ZD02-36.0-XP25-WC06-02	77	60	163	36	1258				
503146	ZD02-37.0-XP25-WC06-02	79	60	165	37	1258				
503148	ZD02-38.0-XP25-WC06-02	81	60	167	38	1258				
503150	ZD02-39.0-XP25-WC06-02	83	60	169	39	1258				
503152	ZD02-40.0-XP25-WC06-02	85	60	171	40	1450				
503154	ZD02-41.0-XP25-WC06-02	87	60	173	41	1450				
503156	ZD02-42.0-XP25-WC06-02	89	60	175	42	1450				
503158	ZD02-43.0-XP40-WC08-02	91	65	186	43	1450				
503160	ZD02-44.0-XP40-WC08-02	93	65	188	44	1450				
503162	ZD02-45.0-XP40-WC08-02	95	65	190	45	1638				
503164	ZD02-46.0-XP40-WC08-02	97	65	192	46	1638				
503166	ZD02-47.0-XP40-WC08-02	99	65	194	47	1638				
503168	ZD02-48.0-XP40-WC08-02	101	65	196	48	1638				
503170	ZD02-49.0-XP40-WC08-02	103	65	198	49	1638				
503172	ZD02-50.0-XP40-WC08-02	105	65	200	50	1853				
503174	ZD02-51.0-XP40-WC08-02	107	65	202	51	1853				
503176	ZD02-52.0-XP40-WC08-02	109	65	204	52	1853				
503178	ZD02-53.0-XP40-WC08-02	111	65	206	53	1853				
503180	ZD02-54.0-XP40-WC08-02	113	65	208	54	1853				
503182	ZD02-55.0-XP40-WC08-02	115	65	210	55	2043				
503184	ZD02-56.0-XP40-WC08-02	117	65	212	56	2043				
503186	ZD02-57.0-XP40-WC08-02	119	65	214	57	2043				
503188	ZD02-58.0-XP40-WC08-02	121	65	216	58	2043				
503190	ZD02-59.0-XP40-WC08-02	123	65	218	59	2043				
503192	ZD02-60.0-XP40-WC08-02	125	65	220	60	2043				
503194	ZD02-61.0-XP40-WC08-02	127	65	222	61	2043				
503196	ZD02-62.0-XP40-WC08-02	129	65	224	62	2043				
503198	ZD02-63.0-XP40-WC08-02	131	65	226	63	2043				
503200	ZD02-64.0-XP40-WC08-02	133	65	228	64	2043				
503202	ZD02-65.0-XP40-WC08-02	135	65	230	65	2043				

Order	Type Model	L1	L2	L	D	d	Applicable to insert	screw	Wrench	Price
503300	ZD03-14.0-XP25-WC03-02	47	56	120	14	25	WCMT030208	M2.5×6.5	T8	738
503302	ZD03-14.5-XP25-WC03-02	48.5	56	122	14.5					738
503304	ZD03-15.0-XP25-WC03-02	50	56	123	15					738
503306	ZD03-15.5-XP25-WC03-02	51.5	56	124	15.5					738
503308	ZD03-16.0-XP25-WC03-02	53	56	126	16					738
503310	ZD03-16.5-XP25-WC03-02	54.5	56	127	16.5					738
503312	ZD03-17.0-XP25-WC03-02	56	56	129	17					738
503314	ZD03-17.5-XP25-WC03-02	57.5	56	130	17.5					738
503316	ZD03-18.0-XP25-WC03-02	59	56	132	18					738
503318	ZD03-18.5-XP25-WC03-02	60.5	56	133	18.5					738
503320	ZD03-19.0-XP25-WC03-02	62	56	135	19	738				
503322	ZD03-19.5-XP25-WC03-02	63.5	56	136	19.5	738				
503324	ZD03-20.0-XP25-WC03-02	65	56	139	20	738				
503326	ZD03-20.5-XP25-WC03-02	66.5	56	140	20.5	925				
503328	ZD03-21.0-XP25-WC03-02	68	56	142	21	925				
503330	ZD03-21.5-XP25-WC04-02	69.5	56	143	21.5	925				
503332	ZD03-22.0-XP25-WC04-02	71	56	145	22	925				
503334	ZD03-22.5-XP25-WC04-02	72.5	56	148	22.5	925				
503336	ZD03-23.0-XP25-WC04-02	74	56	148	23	925				
503338	ZD03-23.5-XP25-WC04-02	75.5	56	149	23.5	925				
503340	ZD03-24.0-XP25-WC04-02	77	56	151	24	925				
503342	ZD03-24.5-XP25-WC04-02	78.5	56	152	24.5	925				
503344	ZD03-25.0-XP25-WC04-02	80	60	166	25	1038				
503346	ZD03-25.5-XP25-WC04-02	81.5	60	167	25.5	1038				
503348	ZD03-26.0-XP25-WC05-02	83	60	169	26	1038				
503350	ZD03-26.5-XP25-WC05-02	84.5	60	170	26.5	1038				
503352	ZD03-27.0-XP25-WC05-02	86	60	172	27	1038				
503354	ZD03-27.5-XP25-WC05-02	87.5	60	173	27.5	1038				
503356	ZD03-28.0-XP25-WC05-02	89	60	175	28	1038				
503358	ZD03-28.5-XP25-WC05-02	90.5	60	176	28.5	1038				
503360	ZD03-29.0-XP25-WC05-02	92	60	178	29	1038				
503362	ZD03-29.5-XP25-WC05-02	93.5	60	179	29.5	1038				
503364	ZD03-30.0-XP25-WC05-02	95	60	181	30	1213				
503366	ZD03-30.5-XP25-WC05-02	96.5	60	182	30.5	1213				
503368	ZD03-31.0-XP25-WC05-02	98	60	184	31	1213				
503370	ZD03-31.5-XP25-WC05-02	99.5	60	185	31.5	1213				
503372	ZD03-32.0-XP25-WC05-02	101	60	187	32	1213				
503374	ZD03-32.5-XP25-WC06-02	102.5	60	188	32.5	1213				
503376	ZD03-33.0-XP25-WC06-02	104	60	190	33	1213				
503378	ZD03-33.5-XP25-WC06-02	105.5	60	191	33.5	1213				
503380	ZD03-34.0-XP25-WC06-02	107	60	193	34	1213				
503382	ZD03-34.5-XP25-WC06-02	108.5	60	194	34.5	1213				
503384	ZD03-35.0-XP25-WC06-02	110	60	196	35	1325				
503386	ZD03-35.5-XP25-WC06-02	111.5	60	197	35.5	1325				
503388	ZD03-36.0-XP25-WC06-02	113	60	199	36	1325				
503390	ZD03-36.5-XP25-WC06-02	114.5	60	200	36.5	1325				
503392	ZD03-37.0-XP25-WC06-02	116	60	202	37	1325				
503394	ZD03-37.5-XP25-WC06-02	117.5	60	203	37.5	1325				
503396	ZD03-38.0-XP25-WC06-02	119	60	205	38	1325				
503398	ZD03-38.5-XP25-WC06-02	120.5	60	206	38.5	1325				
503400	ZD03-39.0-XP25-WC06-02	122	60	206	39	1325				
503402	ZD03-39.5-XP25-WC06-02	123.5	60	209	39.5	1325				
503404	ZD03-40.0-XP25-WC06-02	125	60	211	40	1325				
503406	ZD03-41.0-XP25-WC06-02	128	60	214	41	1525				
503408	ZD03-42.0-XP25-WC06-02	131	60	217	42	1525				
503410	ZD03-43.0-XP40-WC08-02	134	65	229	43	1525				
503412	ZD03-44.0-XP40-WC08-02	137	65	232	44	1525				
503414	ZD03-45.0-XP40-WC08-02	140	65	235	45	1525				
503416	ZD03-46.0-XP40-WC08-02	143	65	238	46	1725				
503418	ZD03-47.0-XP40-WC08-02	146	65	241	47	1725				
503420	ZD03-48.0-XP40-WC08-02	149	65	244	48	1725				
503422	ZD03-49.0-XP40-WC08-02	152	65	247	49	1725				
503424	ZD03-50.0-XP40-WC08-02	155	65	250	50	1725				
503426	ZD03-51.0-XP40-WC08-02	158	65	253	51	1950				
503428	ZD03-52.0-XP40-WC08-02	161	65	256	52	1950				
503430	ZD03-53.0-XP40-WC08-02	164	65	259	53	1950				
503432	ZD03-54.0-XP40-WC08-02	167	65	262	54	1950				
503434	ZD03-55.0-XP40-WC08-02	170	65	265	55	2150				
503436	ZD03-56.0-XP40-WC08-02	173	65	268	56	2150				
503438	ZD03-57.0-XP40-WC08-02	176	65	271	57	2150				
503440	ZD03-58.0-XP40-WC06-04	179	65	274	58	2150				
503442	ZD03-59.0-XP40-WC06-04	182	65	277	59	2150				
503444	ZD03-60.0-XP40-WC06-04	185	65	280	60	2150				
503446	ZD03-61.0-XP40-WC06-04	188	65	283	61	2150				
503448	ZD03-62.0-XP40-WC06-04	191	65	286	62	2150				
503450	ZD03-63.0-XP40-WC06-04	194	65	289	63	2150				
503452	ZD03-64.0-XP40-WC06-04	197	65	292	64	2150				
503454	ZD03-65.0-XP40-WC06-04	200	65	295	65	2150				

Quick drill cutting data reference table

Diameter	Material	RPM	2xD Feeding	3xD Feeding	4xD Feeding	5xD Feeding	Material
14-17	Carbide Steel	2500-2300	Lathe F0.06-0.07	Lathe F0.06-0.07	Lathe F0.05-0.06	Lathe F0.05-0.06	Special Material rpm Reduce 20%~30%
			Machine F150-180	Machine F150-180	Machine F130-150	Machine F130-150	
18-20	Carbide Steel	2300-2100	Lathe F0.085-0.10	Lathe F0.085-0.10	Lathe F0.06-0.07	Lathe F0.06-0.07	Special Material rpm Reduce 20%~30%
			Machine F180-200	Machine F180-200	Machine F150-170	Machine F150-170	
21-23	Carbide Steel	2100-1900	Lathe F0.085-0.10	Lathe F0.085-0.10	Lathe F0.06-0.07	Lathe F0.06-0.07	Special Material rpm Reduce 20%~30%
			Machine F180-200	Machine F180-200	Machine F150-170	Machine F150-170	
24-26	Carbide Steel	1800-1700	Lathe F0.10-0.12	Lathe F0.10-0.12	Lathe F0.09-0.11	Lathe F0.08-0.09	Special Material rpm Reduce 20%~30%
			Machine F170-200	Machine F170-200	Machine F160-190	Machine F150-180	
27-29	Carbide Steel	1600-1500	Lathe F0.10-0.13	Lathe F0.10-0.13	Lathe F0.10-0.12	Lathe F0.09-0.11	Special Material rpm Reduce 20%~30%
			Machine F160-200	Machine F160-200	Machine F160-180	Machine F140-160	
30-32	Carbide Steel	1500-1400	Lathe F0.10-0.13	Lathe F0.10-0.13	Lathe F0		

Abandon Type Drill

WC Type Disposable Fast Drill

4 Multiple Fast Drill-WC Insert

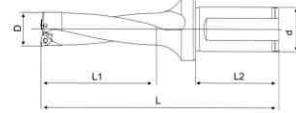

5 Multiple Fast Drill-WC Insert

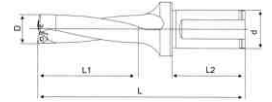

Order	Type Model	L1	L2	L	D	d	Applicable to insert	screw	Wrench	Price
503500	ZD04-14.0-XP25-WC03-02	61	56	134	14	25	WCMT030208	M2.5×6.5	T8	825
503502	ZD04-14.5-XP25-WC03-02	63	56	136	14.5					825
503504	ZD04-15.0-XP25-WC03-02	65	56	138	15					825
503506	ZD04-15.5-XP25-WC03-02	67	56	140	15.5					825
503508	ZD04-16.0-XP25-WC03-02	69	56	142	16					825
503510	ZD04-16.5-XP25-WC03-02	71	56	144	16.5					825
503512	ZD04-17.0-XP25-WC03-02	73	56	146	17					825
503514	ZD04-17.5-XP25-WC03-02	75	56	148	17.5					825
503516	ZD04-18.0-XP25-WC03-02	77	56	150	18					825
503518	ZD04-18.5-XP25-WC03-02	79	56	152	18.5					825
503520	ZD04-19.0-XP25-WC03-02	81	56	154	19					825
503522	ZD04-19.5-XP25-WC03-02	83	56	155	19.5					825
503524	ZD04-20.0-XP25-WC03-02	85	56	159	20					1025
503526	ZD04-20.5-XP25-WC03-02	87	56	161	20.5					1025
503528	ZD04-21.0-XP25-WC03-02	89	56	163	21					1025
503530	ZD04-21.5-XP25-WC04-02	91	56	165	21.5					1025
503532	ZD04-22.0-XP25-WC04-02	93	56	167	22					1025
503534	ZD04-22.5-XP25-WC04-02	95	56	169	22.5					1025
503536	ZD04-23.0-XP25-WC04-02	97	56	171	23					1025
503538	ZD04-23.5-XP25-WC04-02	99	56	173	23.5					1025
503540	ZD04-24.0-XP25-WC04-02	101	56	175	24					1025
503542	ZD04-24.5-XP25-WC04-02	103	56	177	24.5					1025
503544	ZD04-25.0-XP25-WC04-02	105	60	191	25					1150
503546	ZD04-25.5-XP25-WC03-02	107	60	193	25.5					1150
503548	ZD04-26.0-XP32-WC03-02	109	60	195	26					1150
503550	ZD04-26.5-XP32-WC03-02	111	60	197	26.5	1150				
503552	ZD04-27.0-XP32-WC03-02	113	60	199	27	1150				
503554	ZD04-27.5-XP32-WC03-02	115	60	201	27.5	1150				
503556	ZD04-28.0-XP32-WC03-02	117	60	203	28	1150				
503558	ZD04-28.5-XP32-WC03-02	119	60	205	28.5	1150				
503560	ZD04-29.0-XP32-WC03-02	121	60	207	29	1150				
503562	ZD04-29.5-XP32-WC03-02	123	60	209	29.5	1150				
503564	ZD04-30.0-XP32-WC03-02	125	60	211	30	1325				
503566	ZD04-30.5-XP32-WC03-02	127	60	213	30.5	1325				
503568	ZD04-31.0-XP32-WC03-02	129	60	215	31	1325				
503570	ZD04-31.5-XP32-WC03-02	131	60	217	31.5	1325				
503572	ZD04-32.0-XP32-WC03-02	133	60	219	32	1325				
503574	ZD04-32.5-XP32-WC06-02	135	60	221	32.5	1325				
503576	ZD04-33.0-XP32-WC06-02	137	60	223	33	1325				
503578	ZD04-33.5-XP32-WC06-02	139	60	225	33.5	1325				
503580	ZD04-34.0-XP32-WC06-02	141	60	227	34	1325				
503582	ZD04-34.5-XP32-WC06-02	143	60	229	34.5	1325				
503584	ZD04-35.0-XP32-WC06-02	145	60	231	35	1475				
503586	ZD04-35.5-XP32-WC06-02	147	60	233	35.5	1475				
503588	ZD04-36.0-XP32-WC06-02	149	60	235	36	1475				
503590	ZD04-36.5-XP32-WC06-02	151	60	237	36.5	1475				
503592	ZD04-37.0-XP32-WC06-02	153	60	239	37	1475				
503594	ZD04-37.5-XP32-WC06-02	155	60	241	37.5	1475				
503596	ZD04-38.0-XP32-WC06-02	157	60	243	38	1475				
503598	ZD04-38.5-XP32-WC06-02	159	60	245	38.5	1475				
503600	ZD04-39.0-XP32-WC06-02	161	60	247	39	1475				
503602	ZD04-39.5-XP32-WC06-02	163	60	249	39.5	1475				
503604	ZD04-40.0-XP32-WC06-02	165	60	251	40	1700				
503606	ZD04-41.0-XP32-WC06-02	169	60	255	41	1700				
503608	ZD04-42.0-XP32-WC06-02	173	60	259	42	1700				
503610	ZD04-43.0-XP40-WC08-02	177	65	272	43	1700				
503612	ZD04-44.0-XP40-WC08-02	181	65	276	44	1700				
503614	ZD04-45.0-XP40-WC08-02	185	65	280	45	1900				
503616	ZD04-46.0-XP40-WC08-02	189	65	284	46	1900				
503618	ZD04-47.0-XP40-WC08-02	193	65	288	47	1900				
503620	ZD04-48.0-XP40-WC08-02	197	65	292	48	1900				
503622	ZD04-49.0-XP40-WC08-02	201	65	296	49	1900				
503624	ZD04-50.0-XP40-WC08-02	205	65	300	50	2150				
503626	ZD04-51.0-XP40-WC08-02	209	65	304	51	2150				
503628	ZD04-52.0-XP40-WC08-02	213	65	308	52	2150				
503630	ZD04-53.0-XP40-WC08-02	217	65	312	53	2150				
503632	ZD04-54.0-XP40-WC08-02	221	65	316	54	2150				
503634	ZD04-55.0-XP40-WC08-02	225	65	320	55	2150				
503636	ZD04-56.0-XP40-WC08-02	229	65	324	56	2375				
503638	ZD04-57.0-XP40-WC08-02	233	65	328	57	2375				
503640	ZD04-58.0-XP40-WC06-04	237	65	332	58	2375				
503642	ZD04-59.0-XP40-WC06-04	241	65	336	59	2375				
503644	ZD04-60.0-XP40-WC06-04	245	65	340	60	2375				
503646	ZD04-61.0-XP40-WC06-04	249	65	344	61					
503648	ZD04-62.0-XP40-WC06-04	253	65	348	62					
503650	ZD04-63.0-XP40-WC06-04	257	65	352	63					
503652	ZD04-64.0-XP40-WC06-04	261	65	356	64					
503654	ZD04-65.0-XP40-WC06-04	265	65	360	65					

Order	Type Model	L1	L2	L	D	d	Applicable to insert	screw	Wrench	Price
503700	ZD05-14.0-XP25-WC03-02	75	56	148	14	25	WCMT030208	M2.5×6.5	T8	950
503702	ZD05-14.5-XP25-WC03-02	77.5	56	150	14.5					950
503704	ZD05-15.0-XP25-WC03-02	80	56	153	15					950
503706	ZD05-15.5-XP25-WC03-02	82.5	56	155	15.5					950
503708	ZD05-16.0-XP25-WC03-02	85	56	158	16					950
503710	ZD05-16.5-XP25-WC03-02	87.5	56	160	16.5					950
503712	ZD05-17.0-XP25-WC03-02	90	56	163	17					950
503714	ZD05-17.5-XP25-WC03-02	92.5	56	165	17.5					950
503716	ZD05-18.0-XP25-WC03-02	95	56	168	18					950
503718	ZD05-18.5-XP25-WC03-02	97.5	56	170	18.5					950
503720	ZD05-19.0-XP25-WC03-02	100	56	173	19					950
503722	ZD05-19.5-XP25-WC03-02	102.5	56	174	19.5					950
503724	ZD05-20.0-XP25-WC03-02	105	56	179	20					1150
503726	ZD05-20.5-XP25-WC03-02	107.5	56	181	20.5					1150
503728	ZD05-21.0-XP25-WC04-02	110	56	184	21					1150
503730	ZD05-21.5-XP25-WC04-02	112.5	56	186	21.5					1150
503732	ZD05-22.0-XP25-WC04-02	115	56	189	22					1150
503734	ZD05-22.5-XP25-WC04-02	117.5	56	193	22.5					1150
503736	ZD05-23.0-XP25-WC04-02	120	56	194	23					1150
503738	ZD05-23.5-XP25-WC04-02	122.5	56	196	23.5					1150
503740	ZD05-24.0-XP25-WC04-02	125	56	199	24					1150
503742	ZD05-24.5-XP25-WC04-02	127.5	56	201	24.5					1150
503744	ZD05-25.0-XP32-WC05-02	130	60	216	25					1300
503746	ZD05-25.5-XP32-WC05-02	132.5	60	218	25.5					1300
503748	ZD05-26.0-XP32-WC05-02	135	60	221	26					1300
503750	ZD05-26.5-XP32-WC05-02	137.5	60	223	26.5	1300				
503752	ZD05-27.0-XP32-WC05-02	140	60	226	27	1300				
503754	ZD05-27.5-XP32-WC05-02	142.5	60	228	27.5	1300				
503756	ZD05-28.0-XP32-WC05-02	145	60	231	28	1300				
503758	ZD05-28.5-XP32-WC05-02	147.5	60	233	28.5	1300				
503760	ZD05-29.0-XP32-WC05-02	150	60	236	29	1300				
503762	ZD05-29.5-XP32-WC05-02	152.5	60	238	29.5	1300				
503764	ZD05-30.0-XP32-WC05-02	155	60	241	30	1300				
503766	ZD05-30.5-XP32-WC05-02	157.5	60	243	30.5	1450				
503768	ZD05-31.0-XP32-WC05-02	160	60	246	31	1450				
503770	ZD05-31.5-XP32-WC05-02	162.5	60	248	31.5	1450				
503772	ZD05-32.0-XP32-WC06-02	165	60	251	32	1450				
503774	ZD05-32.5-XP32-WC06-02	167.5	60	253	32.5	1450				
503776	ZD05-33.0-XP32-WC06-02	170	60	256	33	1450				
503778	ZD05-33.5-XP32-WC06-02	172.5	60	258	33.5	1450				
503780	ZD05-34.0-XP32-WC06-02	175	60	261	34	1450				
503782	ZD05-34.5-XP32-WC06-02	177.5	60	263	34.5	1450				
503784	ZD05-35.0-XP32-WC06-02	180	60	266	35	1600				
503786	ZD05-35.5-XP32-WC06-02	182.5	60	268	35.5	1600				
503788	ZD05-36.0-XP32-WC06-02	185	60	271	36	1600				
503790	ZD05-36.5-XP32-WC06-02	187.5	60	273	36.5	1600				
503792	ZD05-37.0-XP32-WC06-02	190	60	276	37	1600				
503794	ZD05-37.5-XP32-WC06-02	192.5	60	278	37.5	1600				
503796	ZD05-38.0-XP32-WC06-02	195	60	281	38	1600				
503798	ZD05-38.5-XP32-WC06-02	197.5	60	283	38.5	1600				
503800	ZD05-39.0-XP32-WC06-02	200	60	284	39	1600				
503802	ZD05-39.5-XP32-WC06-02	202.5	60	288	39.5	1600				
503804	ZD05-40.0-XP32-WC06-02	205	60	291	40	1600				
503806	ZD05-41.0-XP32-WC06-02	210	60	296	41	1900				
503808	ZD05-42.0-XP32-WC06-02	215	60	301	42	1900				
503810	ZD05-43.0-XP40-WC08-02	220	65	315	43	1900				
503812	ZD05-44.0-XP40-WC08-02	225	65	320	44	1900				
503814	ZD05-45.0-XP40-WC08-02	230	65	325	45	2100				
503816	ZD05-46.0-XP40-WC08-02	235	65	330	46	2100				
503818	ZD05-47.0-XP40-WC08-02	240	65	335	47	2100				
503820	ZD05-48.0-XP40-WC08-02	245	65	340	48	2100				
503822	ZD05-49.0-XP40-WC08-02	250	65	345	49	2100				
503824	ZD05-50.0-XP40-WC08-02	255	65	350	50	2300				
503826	ZD05-51.0-XP40-WC08-02	260	65	355	51	2300				
503828	ZD05-52.0-XP40-WC08-02	265	65	360	52	2300				
503830	ZD05-53.0-XP40-WC08-02	270	65	365	53	2300				
503832	ZD05-54.0-XP40-WC08-02	275	65	370	54	2300				
503834	ZD05-55.0-XP40-WC08-02	280	65	375	55	230				

SP Type Disposable Fast Drill

2 Multiple Fast Drill-SP Insert

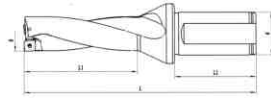

Order	Type Model	L1	L2	L	D	d	Applicable to insert	screw	Wrench	Price
504100	ZD02-13.0-XP25-SP05-02	31	56	104	13	25	SPMG050204	M2×5	T6	700
504102	ZD02-14.0-XP25-SP05-02	33	56	106	14					700
504104	ZD02-15.0-XP25-SP05-02	35	56	108	15					700
504106	ZD02-16.0-XP25-SP06-02	37	56	110	16					700
504108	ZD02-17.0-XP25-SP06-02	39	56	112	17					700
504110	ZD02-18.0-XP25-SP06-02	41	56	114	18					700
504112	ZD02-19.0-XP25-SP06-02	43	56	116	19		700			
504114	ZD02-20.0-XP25-SP06-02	45	56	119	20		875			
504116	ZD02-21.0-XP25-SP06-02	47	56	121	21		875			
504118	ZD02-22.0-XP25-SP07-02	49	56	123	22		875			
504120	ZD02-23.0-XP25-SP07-02	51	56	125	23		875			
504122	ZD02-24.0-XP25-SP07-02	53	56	127	24		875			
504124	ZD02-25.0-XP32-SP07-02	55	60	141	25	32	SPMG07T308	M12.5×6	T8	988
504126	ZD02-26.0-XP32-SP07-02	57	60	143	26					988
504128	ZD02-27.0-XP32-SP07-02	59	60	145	27					988
504130	ZD02-28.0-XP32-SP09-02	61	60	147	28					988
504132	ZD02-29.0-XP32-SP09-02	63	60	149	29					988
504134	ZD02-30.0-XP32-SP09-02	65	60	151	30					988
504136	ZD02-31.0-XP32-SP09-02	67	60	153	31		1150			
504138	ZD02-32.0-XP32-SP09-02	69	60	155	32		1150			
504140	ZD02-33.0-XP32-SP09-02	71	60	157	33		1150			
504142	ZD02-34.0-XP32-SP11-02	73	60	159	34		1150			
504144	ZD02-35.0-XP32-SP11-02	75	60	161	35		1150			
504146	ZD02-36.0-XP32-SP11-02	77	60	163	36		1258			
504148	ZD02-37.0-XP32-SP11-02	79	60	165	37	1258				
504150	ZD02-38.0-XP32-SP11-02	81	60	167	38	1258				
504152	ZD02-39.0-XP32-SP11-02	83	60	169	39	1258				
504154	ZD02-40.0-XP32-SP11-02	85	60	171	40	1258				
504156	ZD02-41.0-XP32-SP14-02	87	60	173	41	1450				
504158	ZD02-42.0-XP32-SP14-02	89	60	175	42	1450				
504160	ZD02-43.0-XP40-SP14-02	91	65	186	43	1450				
504162	ZD02-44.0-XP40-SP14-02	93	65	188	44	1450				
504164	ZD02-45.0-XP40-SP14-02	95	65	190	45	1450				
504166	ZD02-46.0-XP40-SP14-02	97	65	192	46	1638				
504168	ZD02-47.0-XP40-SP14-02	99	65	194	47	1638				
504170	ZD02-48.0-XP40-SP07-04	101	65	196	48	1638				
504172	ZD02-49.0-XP40-SP07-04	103	65	198	49	1638				
504174	ZD02-50.0-XP40-SP07-04	105	65	200	50	1853				
504176	ZD02-51.0-XP40-SP07-04	107	65	202	51	1853				
504178	ZD02-52.0-XP40-SP09-04	109	65	204	52	1853				
504180	ZD02-53.0-XP40-SP09-04	111	65	206	53	1853				
504182	ZD02-54.0-XP40-SP09-04	113	65	208	54	1853				
504184	ZD02-55.0-XP40-SP09-04	115	65	210	55	2043				
504186	ZD02-56.0-XP40-SP09-04	117	65	212	56	2043				
504188	ZD02-57.0-XP40-SP09-04	119	65	214	57	2043				
504190	ZD02-58.0-XP40-SP09-04	121	65	216	58	2043				
504192	ZD02-59.0-XP40-SP09-04	123	65	218	59	2043				
504194	ZD02-60.0-XP40-SP09-04	125	65	220	60	2043				

3 Multiple Fast Drill-SP Insert

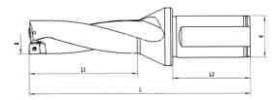

Order	Type Model	L1	L2	L	D	d	Applicable to insert	screw	Wrench	Price
504200	ZD03-13.0-XP25-SP05-02	44	56	117	13	25	SPMG050204	M2×5	T6	738
504202	ZD03-13.5-XP25-SP05-02	45.5	56	118	13.5					738
504204	ZD03-14.0-XP25-SP05-02	47	56	120	14					738
504206	ZD03-14.5-XP25-SP05-02	48.5	56	122	14.5					738
504208	ZD03-15.0-XP25-SP05-02	50	56	123	15					738
504210	ZD03-15.5-XP25-SP06-02	51.5	56	124	15.5					738
504212	ZD03-16.0-XP25-SP06-02	53	56	126	16		738			
504214	ZD03-16.5-XP25-SP06-02	54.5	56	127	16.5		738			
504216	ZD03-17.0-XP25-SP06-02	56	56	129	17		738			
504218	ZD03-17.5-XP25-SP06-02	57.5	56	130	17.5		738			
504220	ZD03-18.0-XP25-SP06-02	59	56	132	18		738			
504222	ZD03-18.5-XP25-SP06-02	60.5	56	133	18.5		738			
504224	ZD03-19.0-XP25-SP06-02	62	56	135	19	32	SPMG060204	M2.2×5	T6	925
504226	ZD03-19.5-XP25-SP06-02	63.5	56	136	19.5					925
504228	ZD03-20.0-XP25-SP06-02	65	56	139	20					925
504230	ZD03-20.5-XP25-SP06-02	66.5	56	140	20.5					925
504232	ZD03-21.0-XP25-SP06-02	68	56	142	21					925
504234	ZD03-21.5-XP25-SP06-02	69.5	56	143	21.5					925
504236	ZD03-22.0-XP25-SP07-02	71	56	145	22		925			
504238	ZD03-22.5-XP25-SP07-02	72.5	56	148	22.5		925			
504240	ZD03-23.0-XP25-SP07-02	74	56	148	23		925			
504242	ZD03-23.5-XP25-SP07-02	75.5	56	149	23.5		925			
504244	ZD03-24.0-XP25-SP07-02	77	56	151	24		925			
504246	ZD03-24.5-XP25-SP07-02	78.5	56	152	24.5		925			
504248	ZD03-25.0-XP32-SP07-02	80	60	166	25	925				
504250	ZD03-25.5-XP32-SP07-02	81.5	60	167	25.5	1038				
504252	ZD03-26.0-XP32-SP07-02	83	60	169	26	1038				
504254	ZD03-26.5-XP32-SP07-02	84.5	60	170	26.5	1038				
504256	ZD03-27.0-XP32-SP07-02	86	60	172	27	1038				
504258	ZD03-27.5-XP32-SP07-02	87.5	60	173	27.5	1038				
504260	ZD03-28.0-XP32-SP09-02	89	60	175	28	1038				
504262	ZD03-28.5-XP32-SP09-02	90.5	60	176	28.5	1038				
504264	ZD03-29.0-XP32-SP09-02	92	60	178	29	1038				
504266	ZD03-29.5-XP32-SP09-02	93.5	60	179	29.5	1038				
504268	ZD03-30.0-XP32-SP09-02	95	60	181	30	1213				
504270	ZD03-30.5-XP32-SP09-02	96.5	60	182	30.5	1213				
504272	ZD03-31.0-XP32-SP09-02	98	60	184	31	1213				
504274	ZD03-31.5-XP32-SP09-02	99.5	60	185	31.5	1213				
504276	ZD03-32.0-XP32-SP09-02	101	60	187	32	1213				
504278	ZD03-32.5-XP32-SP09-02	102.5	60	188	32.5	1213				
504280	ZD03-33.0-XP32-SP09-02	104	60	190	33	1213				
504282	ZD03-33.5-XP32-SP09-02	105.5	60	191	33.5	1213				
504284	ZD03-34.0-XP32-SP11-02	107	60	193	34	1213				
504286	ZD03-34.5-XP32-SP11-02	108.5	60	194	34.5	1213				
504288	ZD03-35.0-XP32-SP11-02	110	60	196	35	1213				
504290	ZD03-35.5-XP32-SP11-02	111.5	60	197	35.5	1325				
504292	ZD03-36.0-XP32-SP11-02	113	60	199	36	1325				
504294	ZD03-36.5-XP32-SP11-02	114.5	60	200	36.5	1325				
504296	ZD03-37.0-XP32-SP11-02	116	60	202	37	1325				
504298	ZD03-37.5-XP32-SP11-02	117.5	60	203	37.5	1325				
504300	ZD03-38.0-XP32-SP11-02	119	60	205	38	1325				
504302	ZD03-38.5-XP32-SP11-02	120.5	60	206	38.5	1325				
504304	ZD03-39.0-XP32-SP11-02	122	60	206	39	1325				
504306	ZD03-39.5-XP32-SP11-02	123.5	60	209	39.5	1325				
504308	ZD03-40.0-XP32-SP11-02	125	60	211	40	1325				
504310	ZD03-41.0-XP32-SP14-02	128	60	214	41	1525				
504312	ZD03-42.0-XP32-SP14-02	131	60	217	42	1525				
504314	ZD03-43.0-XP40-SP14-02	134	65	229	43	1525				
504316	ZD03-44.0-XP40-SP14-02	137	65	232	44	1525				
504318	ZD03-45.0-XP40-SP14-02	140	65	235	45	1525				
504320	ZD03-46.0-XP40-SP14-02	143	65	238	46	1725				
504322	ZD03-47.0-XP40-SP14-02	146	65	241	47	1725				
504324	ZD03-48.0-XP40-SP07-04	149	65	244	48	1725				
504326	ZD03-49.0-XP40-SP07-04	152	65	247	49	1950				
504328	ZD03-50.0-XP40-SP07-04	155	65	250	50	1950				
504330	ZD03-51.0-XP40-SP07-04	158	65	253	51	1950				
504332	ZD03-52.0-XP40-SP09-04	161	65	256	52	1950				
504334	ZD03-53.0-XP40-SP09-04	164	65	259	53	1950				
504336	ZD03-54.0-XP40-SP09-04	167	65	262	54	1950				
504338	ZD03-55.0-XP40-SP09-04	170	65	265	55	1950				
504340	ZD03-56.0-XP40-SP09-04	173	65	268	56	2150				
504342	ZD03-57.0-XP40-SP09-04	176	65	271	57	2150				
504344	ZD03-58.0-XP40-SP09-04	179	65	274	58	2150				
504346	ZD03-59.0-XP40-SP09-04	182	65	277	59	2150				
504348	ZD03-60.0-XP40-SP09-04	185	65	280	60	2150				

Coolant flow (1/min)

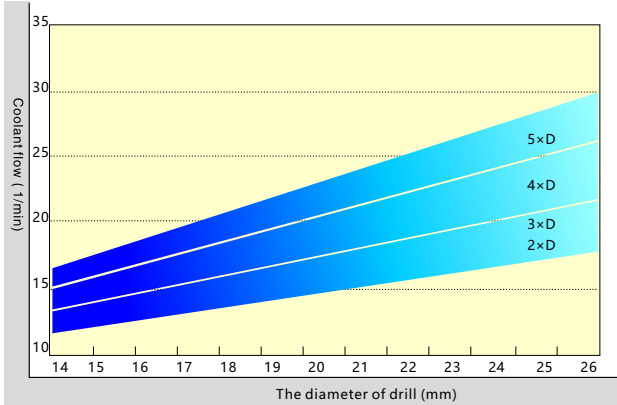

Processing power required

The following chart is the cutting force required for drilling
 U-Drill bits for off duty machine tools

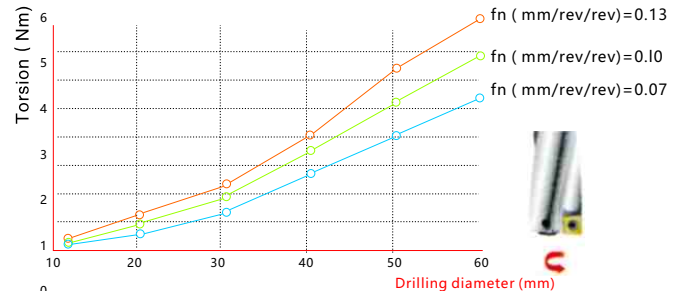
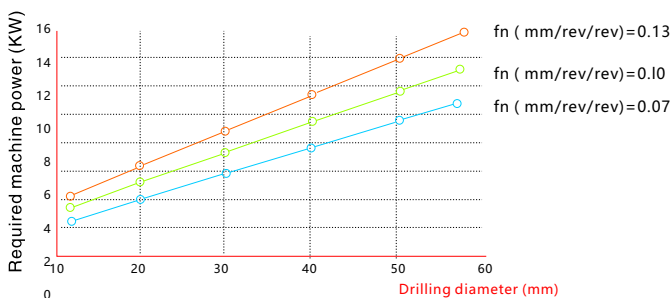

Abandon Type Drill

SP Type Disposable Fast Drill

4 Multiple Fast Drill-SP Insert



5 Multiple Fast Drill-SP Insert



Order	Type Model	L1	L2	L	D	d	Applicable to insert	screw	Wrench	Price
504400	ZD04-13.0-XP25-SP05-02	57	56	130	13	25	SPMG060204	M2x5		825
504402	ZD04-13.5-XP25-SP05-02	59	56	132	13.5					825
504404	ZD04-14.0-XP25-SP05-02	61	56	134	14					825
504406	ZD04-14.5-XP25-SP05-02	63	56	136	14.5					825
504408	ZD04-15.0-XP25-SP05-02	65	56	138	15					825
504410	ZD04-15.5-XP25-SP06-02	67	56	140	15.5					825
504412	ZD04-16.0-XP25-SP06-02	69	56	142	16					825
504414	ZD04-16.5-XP25-SP06-02	71	56	144	16.5					825
504416	ZD04-17.0-XP25-SP06-02	73	56	146	17					825
504418	ZD04-17.5-XP25-SP06-02	75	56	148	17.5					825
504420	ZD04-18.0-XP25-SP06-02	77	56	150	18		825			
504422	ZD04-18.5-XP25-SP06-02	79	56	152	18.5		825			
504424	ZD04-19.0-XP25-SP06-02	81	56	154	19		825			
504426	ZD04-19.5-XP25-SP06-02	83	56	155	19.5		825			
504428	ZD04-20.0-XP25-SP06-02	85	56	159	20		825			
504430	ZD04-20.5-XP25-SP06-02	87	56	161	20.5		1025			
504432	ZD04-21.0-XP25-SP06-02	89	56	163	21		1025			
504434	ZD04-21.5-XP25-SP06-02	91	56	165	21.5		1025			
504436	ZD04-22.0-XP25-SP07-02	93	56	167	22		1025			
504438	ZD04-22.5-XP25-SP07-02	95	56	169	22.5		1025			
504440	ZD04-23.0-XP25-SP07-02	97	56	171	23		1025			
504442	ZD04-23.5-XP25-SP07-02	99	56	173	23.5		1025			
504444	ZD04-24.0-XP25-SP07-02	101	56	175	24		1025			
504446	ZD04-24.5-XP25-SP07-02	103	56	177	24.5		1025			
504448	ZD04-25.0-XP32-SP07-02	105	60	191	25		1025			
504450	ZD04-25.5-XP32-SP07-02	107	60	193	25.5	1150				
504452	ZD04-26.0-XP32-SP07-02	109	60	195	26	1150				
504454	ZD04-26.5-XP32-SP07-02	111	60	197	26.5	1150				
504456	ZD04-27.0-XP32-SP07-02	113	60	199	27	1150				
504458	ZD04-27.5-XP32-SP07-02	115	60	201	27.5	1150				
504460	ZD04-28.0-XP32-SP09-02	117	60	203	28	1150				
504462	ZD04-28.5-XP32-SP09-02	119	60	205	28.5	1150				
504464	ZD04-29.0-XP32-SP09-02	121	60	207	29	1150				
504466	ZD04-29.5-XP32-SP09-02	123	60	209	29.5	1150				
504468	ZD04-30.0-XP32-SP09-02	125	60	211	30	1150				
504470	ZD04-30.5-XP32-SP09-02	127	60	213	30.5	1325				
504472	ZD04-31.0-XP32-SP09-02	129	60	215	31	1325				
504474	ZD04-31.5-XP32-SP09-02	131	60	217	31.5	1325				
504476	ZD04-32.0-XP32-SP09-02	133	60	219	32	1325				
504478	ZD04-32.5-XP32-SP09-02	135	60	221	32.5	1325				
504480	ZD04-33.0-XP32-SP09-02	137	60	223	33	1325				
504482	ZD04-33.5-XP32-SP09-02	139	60	225	33.5	1325				
504484	ZD04-34.0-XP32-SP11-02	141	60	227	34	1325				
504486	ZD04-34.5-XP32-SP11-02	143	60	229	34.5	1325				
504488	ZD04-35.0-XP32-SP11-02	145	60	231	35	1475				
504490	ZD04-35.5-XP32-SP11-02	147	60	233	35.5	1475				
504492	ZD04-36.0-XP32-SP11-02	149	60	235	36	1475				
504494	ZD04-36.5-XP32-SP11-02	151	60	237	36.5	1475				
504496	ZD04-37.0-XP32-SP11-02	153	60	239	37	1475				
504498	ZD04-37.5-XP32-SP11-02	155	60	241	37.5	1475				
504500	ZD04-38.0-XP32-SP11-02	157	60	243	38	1475				
504502	ZD04-38.5-XP32-SP11-02	159	60	245	38.5	1475				
504504	ZD04-39.0-XP32-SP11-02	161	60	247	39	1475				
504506	ZD04-39.5-XP32-SP11-02	163	60	249	39.5	1475				
504508	ZD04-40.0-XP32-SP11-02	165	60	251	40	1700				
504510	ZD04-41.0-XP32-SP14-02	169	60	255	41	1700				
504512	ZD04-42.0-XP32-SP14-02	173	60	259	42	1700				
504514	ZD04-43.0-XP40-SP14-02	177	65	272	43	1700				
504516	ZD04-44.0-XP40-SP14-02	181	65	276	44	1700				
504518	ZD04-45.0-XP40-SP14-02	185	65	280	45	1700				
504520	ZD04-46.0-XP40-SP14-02	189	65	284	46	1900				
504522	ZD04-47.0-XP40-SP14-02	193	65	288	47	1900				
504524	ZD04-48.0-XP40-SP07-04	197	65	292	48	1900				
504526	ZD04-49.0-XP40-SP07-04	201	65	296	49	1900				
504528	ZD04-50.0-XP40-SP07-04	205	65	300	50	1900				
504530	ZD04-51.0-XP40-SP07-04	209	65	304	51	2150				
504532	ZD04-52.0-XP40-SP09-04	213	65	308	52	2150				
504534	ZD04-53.0-XP40-SP09-04	217	65	312	53	2150				
504536	ZD04-54.0-XP40-SP09-04	221	65	316	54	2150				
504538	ZD04-55.0-XP40-SP09-04	225	65	320	55	2150				
504540	ZD04-56.0-XP40-SP09-04	229	65	324	56	2375				
504542	ZD04-57.0-XP40-SP09-04	233	65	328	57	2375				
504544	ZD04-58.0-XP40-SP09-04	237	65	332	58	2375				
504546	ZD04-59.0-XP40-SP09-04	241	65	336	59	2375				
504548	ZD04-60.0-XP40-SP09-04	245	65	340	60	2375				

Order	Type Model	L1	L2	L	D	d	Applicable to insert	screw	Wrench	Price
504600	ZD05-13.0-XP25-SP05-02	70	56	143	13	25	SPMG050204	M2x5		950
504602	ZD05-13.5-XP25-SP05-02	72.5	56	145	13.5					950
504604	ZD05-14.0-XP25-SP05-02	75	56	148	14					950
504606	ZD05-14.5-XP25-SP05-02	77.5	56	150	14.5					950
504608	ZD05-15.0-XP25-SP05-02	80	56	153	15					950
504610	ZD05-15.5-XP25-SP06-02	82.5	56	155	15.5					950
504612	ZD05-16.0-XP25-SP06-02	85	56	158	16					950
504614	ZD05-16.5-XP25-SP06-02	87.5	56	160	16.5					950
504616	ZD05-17.0-XP25-SP06-02	90	56	163	17					950
504618	ZD05-17.5-XP25-SP06-02	92.5	56	165	17.5					950
504620	ZD05-18.0-XP25-SP06-02	95	56	168	18		950			
504622	ZD05-18.5-XP25-SP06-02	97.5	56	170	18.5		950			
504624	ZD05-19.0-XP25-SP06-02	100	56	173	19		950			
504626	ZD05-19.5-XP25-SP06-02	102.5	56	174	19.5		950			
504628	ZD05-20.0-XP25-SP06-02	105	56	179	20		950			
504630	ZD05-20.5-XP25-SP06-02	107.5	56	181	20.5		1150			
504632	ZD05-21.0-XP25-SP06-02	110	56	184	21		1150			
504634	ZD05-21.5-XP25-SP06-02	112.5	56	186	21.5		1150			
504636	ZD05-22.0-XP25-SP07-02	115	56	190	22		1150			
504638	ZD05-22.5-XP25-SP07-02	117.5	56	193	22.5		1150			
504640	ZD05-23.0-XP25-SP07-02	120	56	194	23		1150			
504642	ZD05-23.5-XP25-SP07-02	122.5	56	196	23.5		1150			
504644	ZD05-24.0-XP35-SP07-02	125	56	199	24		1150			
504646	ZD05-24.5-XP35-SP07-02	127.5	56	201	24.5		1150			
504648	ZD05-25.0-XP32-SP07-02	130	60	216	25		1150			
504650	ZD05-25.5-XP32-SP07-02	132.5	60	218	25.5	1300				
504652	ZD05-26.0-XP32-SP07-02	135	60	221	26	1300				
504654	ZD05-26.5-XP32-SP07-02	137.5	60	223	26.5	1300				
504656	ZD05-27.0-XP32-SP07-02	140	60	226	27	1300				
504658	ZD05-27.5-XP32-SP07-02	142.5	60	226	27.5	1300				
504660	ZD05-28.0-XP32-SP09-02	145	60	231	28	1300				
504662	ZD05-28.5-XP32-SP09-02	147.5	60	233	28.5	1300				
504664	ZD05-29.0-XP32-SP09-02	150	60	236	29	1300				
504666	ZD05-29.5-XP32-SP09-02	152.5	60	238	29.5	1300				
504668	ZD05-30.0-XP32-SP09-02	155	60	241	30	1300				
504670	ZD05-30.5-XP32-SP09-02	157.5	60	243	30.5	1450				
504672	ZD05-31.0-XP32-SP09-02	160	60	246	31	1450				
504674	ZD05-31.5-XP32-SP09-02	162.5	60	248	31.5	1450				
504676	ZD05-32.0-XP32-SP09-02	165	60	251	32	1450				
504678	ZD05-32.5-XP32-SP09-02	167.5	60	253	32.5	1450				
504680	ZD05-33.0-XP32-SP09-02	170	60	256	33	1450				
504682	ZD05-33.5-XP32-SP09-02	172.5	60	258	33.5	1450				
504684	ZD05-34.0-XP32-SP11-02	175	60	261	34	1450				
504686	ZD05-34.5-XP32-SP11-02	177.5	60	263	34.5	1450				
504688	ZD05-35.0-XP32-SP11-02	180	60	266	35	1450				
504690	ZD05-35.5-XP32-SP11-02	182.5	60	268	35.5	1600				
504692	ZD05-36.0-XP32-SP11-02	185	60	271	36	1600				
504694	ZD05-36.5-XP32-SP11-02	187.5	60	273	36.5	1600				
504696	ZD05-37.0-XP32-SP11-02	190	60	276	37	1600				
504698	ZD05-37.5-XP32-SP11-02	192.5	60	278	37.5	1600				
504700	ZD05-38.0-XP32-SP11-02	195	60	281	38	1600				
504702	ZD05-38.5-XP32-SP11-02	197.5	60	283	38.5	1600				
504704	ZD05-39.0-XP32-SP11-02	200	60	284	39	1600				
504706	ZD05-39.5-XP32-SP11-02	202.5	60	288	39.5	1600				
504708	ZD05-40.0-XP32-SP11-02	205	60	291	40	1600				
504710	ZD05-41.0-XP32-SP14-02	210	60	296	41	1900				
504712	ZD05-42.0-XP32-SP14-02	215	60	301	42	1900				
504714	ZD05-43.0-XP40-SP14-02	220	65	315	43	1900				
504716	ZD05-44.0-XP40-SP14-02	225	65	320	44	1900				
504718	ZD05-45.0-XP40-SP14-02	230	65	325	45	1900				
504720	ZD05-46.0-XP40-SP14-02	235	65	330	46	2100				
504722	ZD05-47.0-XP40-SP14-02	240	65	335	47	2100				
504724	ZD05-48.0-XP40-SP07-04	245	65	340	48	2100				
504726	ZD05-49.0-XP40-SP07-04	250	65	345	49	2100				
504728	ZD05-50.0-XP40-SP07-04	255	65	350	50	2100				
504730	ZD05-51.0-XP40-SP07-04	260	65	355	51	2300				
504732	ZD05-52.0-XP40-SP09-04	265	65	360	52	2300				
504734	ZD05-53.0-XP40-SP09-04	270	65	365	53	2300				
504736	ZD05-54.0-XP40-SP09-04	275	65	370	54	2300				
504738	ZD05-55.0-XP40-SP09-04	280	65	375	55	2300				
504740	ZD05-56.0-XP40-SP09-04	285	65	380	56	2600				
504742	ZD05-57.0-XP40-SP09-04	290	65	385	57	2600				
504744	ZD05									

Carbide drill bit 3*D Flanged Shank



Order	Type Model	L	L1	L2	D	D1	screw	Wrench	Price
500100	SDT03-11.0-11.9-H-XP20	112	36	48	11.0-11.9	20	M1.8*4.5	T6	
500102	SDT03-12.0-12.9-H-XP20	116	39	48	12.0-12.9	20	M2*5	T6	
500104	SDT03-13.0-13.9-H-XP20	118	42	48	13.0-13.9	20	M2*5	T6	
500106	SDT03-14.0-14.9-H-XP20	122	45	48	14.0-14.9	20	M2*5	T6	
500108	SDT03-15.0-15.9-H-XP20	126	48	48	15.0-15.9	20	M2*5	T6	
500110	SDT03-16.0-16.9-H-XP20	130	51	48	16.0-16.9	20	M2.5*6	T8	
500112	SDT03-17.0-17.9-H-XP20	134	54	48	17.0-17.9	20	M2.5*7	T8	
500114	SDT03-18.0-19.9-H-XP25	150	57	56	18.0-19.9	25	M3*7.5	T10	
500116	SDT03-20.0-21.9-H-XP25	156	66	56	20.0-21.9	25	M3*7.5	T10	
500118	SDT03-22.0-23.9-H-XP25	162	72	56	22.0-23.9	25	M3*9	T10	
500120	SDT03-24.0-25.9-H-XP20	168	78	56	24.0-25.9	25	M3*9	T10	
500122	SDT03-26.0-28.9-H-XP32	186	87	60	26.0-28.9	32	M4*10	T15	
500124	SDT03-29.0-31.9-H-XP32	195	96	60	29.0-31.9	32	M4*10	T15	
500126	SDT03-32.0-35.0-H-XP32	205	105	60	32.0-35.0	32	M4*10	T15	

5*D Flanged Shank Straight Flute H0lder



Order	Type Model	L	L1	L2	D	D1	screw	Wrench	Price
500200	SDT05-11.0-11.9-H-XP20	136	60	48	11.0-11.9	20	M1.8*4.5	T6	
500202	SDT05-12.0-12.9-H-XP20	142	65	48	12.0-12.9	20	M2*5	T6	
500204	SDT05-13.0-13.9-H-XP20	146	70	48	13.0-13.9	20	M2*5	T6	
500206	SDT05-14.0-14.9-H-XP20	152	75	48	14.0-14.9	20	M2*5	T6	
500208	SDT05-15.0-15.9-H-XP20	158	80	48	15.0-15.9	20	M2*5	T6	
500210	SDT05-16.0-16.9-H-XP20	164	85	48	16.0-16.9	20	M2.5*6	T8	
500212	SDT05-17.0-17.9-H-XP20	170	90	48	17.0-17.9	20	M2.5*7	T8	
500214	SDT05-19.0-19.9-H-XP25	190	100	56	18.0-19.9	25	M3*7.5	T10	
500216	SDT05-20.0-21.9-H-XP25	200	110	56	20.0-21.9	25	M3*7.5	T10	
500218	SDT05-22.0-23.9-H-XP25	210	120	56	22.0-23.9	25	M3*9	T10	
500220	SDT05-24.0-25.9-H-XP25	220	130	56	24.0-25.9	25	M3*9	T10	
500222	SDT05-26.0-28.9-H-XP32	245	145	60	26.0-28.9	32	M4*10	T15	
500224	SDT05-29.0-31.9-H-XP32	259	160	60	29.0-31.9	32	M4*10	T15	
500226	SDT05-32.0-35.0-H-XP32	275	175	60	32.0-35.0	32	M4*10	T15	

7*D Flanged Shank Straight Flute H0lder

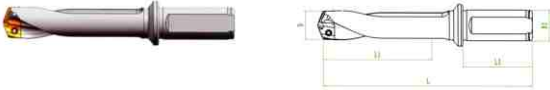

Order	Type Model	L	L1	L2	D	D1	screw	Wrench	Price
500300	SDT07-11.0-11.9-H-XP20	160	84	48	11.0-11.9	20	M1.8*4.5	T6	
500302	SDT07-12.0-12.9-H-XP20	168	91	48	12.0-12.9	20	M2*5	T6	
500304	SDT07-13.0-13.9-H-XP20	174	98	48	13.0-13.9	20	M2*5	T6	
500306	SDT07-14.0-14.9-H-XP20	182	105	48	14.0-14.9	20	M2*5	T6	
500308	SDT07-15.0-15.9-H-XP20	190	112	48	15.0-15.9	20	M2*5	T6	
500310	SDT07-16.0-16.9-H-XP20	198	119	48	16.0-16.9	20	M2.5*6	T8	
500312	SDT07-17.0-17.9-H-XP20	206	126	48	17.0-17.9	20	M2.5*7	T8	
500314	SDT07-18.0-19.9-H-XP25	230	140	56	18.0-19.9	25	M3*7.5	T10	
500316	SDT07-20.0-21.9-H-XP25	244	154	56	20.0-21.9	25	M3*7.5	T10	
500318	SDT07-22.0-23.9-H-XP25	258	168	56	22.0-23.9	25	M3*9	T10	
500320	SDT07-24.0-25.9-H-XP25	272	182	56	24.0-25.9	25	M3*9	T10	
500322	SDT07-26.0-28.9-H-XP32	303	203	60	26.0-28.9	32	M4*10	T15	
500324	SDT07-29.0-31.9-H-XP32	323	224	60	29.0-31.9	32	M4*10	T15	
500326	SDT07-32.0-35.0-H-XP32	345	245	60	32.0-35.0	32	M4*10	T15	

Tips: Using of spade drill

- 1.spade drill. an upgraded replacement product of traditional twist drill, can be applied to CNC and a variety of conventional equipment. such as vertical drill. radial drill etc
- 2.The material of spade drill inserts include carbide and HSS, which are mounted on different holder and can not be interchanged.
- 3.Recommndation of HSS inserts for vertical drilland radial dr... . carbide inserts are likely to cause jump edge due to 1ow speed. poor rigidity and large gap.
- 4.All spade dr...holders have center water hole with reconmendation of higrtpressure and high-flow coolant.which will greatly extend insert life and accelerate chip evacuation.
- 5.All inserts and designed for chip breaker and the out of tho filing are small debris
- 6.spade dr...inserts with self-centering. double synmetric uniform stress are suitable for deep hole drilling. The length to diameter ratio within 5*D.we suggest preferred shallow hole drll(u drill) for saving tool costMore than 5*D we recommend spade drill
- 7.under enough coolant pressure and flow.and smooth chip evacuation, spade drill can be used for one shot drilling.

High speed steel spade drill rod 3*D Morse Shank Spade Drill

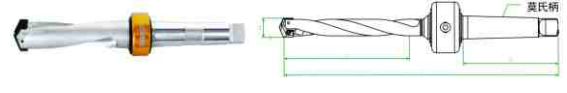

Order	Type Model	L	L1	L2	D	D1	screw	Wrench	Price
501100	SDS03-09.5-11.0-MT2	181	36	80	9.5-11.0	MT2	M2*5	T6	7281
501102	SDS03-11.1-12.9-MT2	187	42	80	11.1-12.9	MT2	M2*5	T6	7281
501104	SDS03-13.0-15.0-MT2	193	48	80	13.0-15.0	MT2	M2.5*6	T8	7281
501106	SDS03-15.1-17.5-MT2	200	55	80	15.1-17.5	MT2	M2.5*6	T8	7500
501108	SDS03-17.6-19.5-MT3	226	61	99	17.6-19.5	MT3	M3*8	T10	8250
501110	SDS03-19.6-21.5-MT3	232	67	99	19.6-21.5	MT3	M3*8	T10	8250
501112	SDS03-21.6-24.4-MT3	241	76	99	21.6-24.4	MT3	M3*8	T10	8250
501114	SDS03-24.5-26.5-MT4	284	82	124	24.5-26.5	MT4	M3.5*10	T15	9156
501116	SDS03-26.6-28.5-MT4	290	88	124	26.6-28.5	MT4	M3.5*10	T15	9156
501118	SDS03-28.6-30.5-MT4	296	94	124	28.6-30.5	MT4	M3.5*10	T15	9500
501120	SDS03-30.6-32.5-MT4	302	100	124	30.6-32.5	MT4	M3.5*10	T15	9500
501122	SDS03-32.6-34.9-MT4	309	107	124	32.6-34.9	MT4	M3.5*10	T15	9500
501124	SDS03-35.0-37.9-MT5	360	11	156	35.0-37.9	MT5	M3.5*10	T15	10594
501126	SDS03-38.0-40.9-MT5	369	125	156	38.0-40.9	MT5	M3.5*10	T15	10594
501128	SDS03-41.0-43.9-MT5	378	134	156	41.0-43.9	MT5	M3.5*10	T15	11000
501130	SDS03-44.0-47.9-MT5	390	146	156	44.0-47.9	MT5	M3.5*10	T15	11469
501132	SDS03-48.0-51.9-MT5	402	158	156	48.0-51.9	MT5	M5*15	T20	12031
501134	SDS03-52.0-55.9-MT5	414	170	156	52.0-55.9	MT5	M5*15	T20	12656
501136	SDS03-56.0-59.9-MT5	426	182	156	56.0-59.9	MT5	M5*15	T20	13281
501138	SDS03-60.0-65.0-MT5	442	198	156	60.0-65.0	Mt5	M5*15	T20	13875

5*D Morse Shank Spade Drill

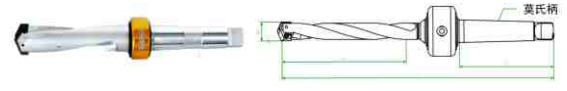

Order	Type Model	L	L1	L2	D	D1	screw	Wrench	Price
501200	SDS05-09.5-11.0-MT2	203	58	80	9.5-11.0	MT2	M2*5	T6	8063
501202	SDS05-11.1-12.9-MT2	213	68	80	11.1-12.9	MT2	M2*5	T6	8063
501204	SDS05-13.0-15.0-MT2	223	78	80	13.0-15.0	MT2	M2.5*6	T8	8063
501206	SDS05-15.1-17.5-MT2	235	90	80	15.1-17.5	MT2	M2.5*6	T8	8313
501208	SDS05-17.6-19.5-MT3	265	100	99	17.6-19.5	MT3	M3*8	T10	9094
501210	SDS05-19.6-21.5-MT3	275	110	99	19.6-21.5	MT3	M3*8	T10	9094
501212	SDS05-21.6-24.4-MT3	290	125	99	21.6-24.4	MT3	M3*8	T10	9094
501214	SDS05-24.5-26.5-MT4	337	135	124	24.5-26.5	MT4	M3.5*10	T15	10031
501216	SDS05-26.6-28.5-MT4	347	145	124	26.6-28.5	MT4	M3.5*10	T15	10031
501218	SDS05-28.6-30.5-MT4	357	155	124	28.6-30.5	MT4	M3.5*10	T15	10438
501220	SDS05-30.6-32.5-MT4	367	165	124	30.6-32.5	MT4	M3.5*10	T15	10438
501222	SDS05-32.6-34.9-MT4	380	178	124	32.6-34.9	MT4	M3.5*10	T15	10438
501224	SDS05-35.0-37.9-MT5	436	192	156	35.0-37.9	MT5	M3.5*10	T15	11594
501226	SDS05-38.0-40.9-MT5	452	208	156	38.0-40.9	MT5	M3.5*10	T15	11594
501228	SDS05-41.0-43.9-MT5	566	222	156	41.0-43.9	MT5	M3.5*10	T15	12063
501230	SDS05-44.0-47.9-MT5	486	242	156	44.0-47.9	MT5	M3.5*10	T15	12625
501232	SDS05-48.0-51.9-MT5	506	262	156	48.0-51.9	MT5	M5*15	T20	13281
501234	SDS05-52.0-55.9-MT5	526	282	156	52.0-55.9	MT5	M5*15	T20	13969
501236	SDS05-56.0-59.9-MT5	546	302	156	56.0-59.9	MT5	M5*15	T20	14688
501238	SDS05 60.0-65.0-MT5	572	328	156	60.0-65.0	MT5	M5*15	T20	15406

7*D Morse Shank Spade Drill

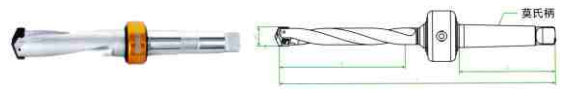

Order	Type Model	L	L1	L2	D	D1	screw	Wrench	Price
501300	SDS07-09.5-11.0-MT2	225	80	80	9.5-11.0	Mt2	M2*5	T6	9625
501302	SDS07-11.1-12.9-MT2	238	93	80	11.1-12.9	MT2	M2*5	T6	9625
501304	SDS07-13.0-15.0-MT2	253	108	80	13.0-15.0	MT2	M2.5*6	T8	9625
501306	SDS07-15.1-17.5-MT2	270	125	80	15.1-17.5	MT2	M2.5*6	T8	9906
501308	SDS07-17.6-19.5-MT3	304	139	99	17.6-19.5	MT3	M3*8	T10	10750
501310	SDS07-19.6-21.5-MT3	318	153	99	19.6-21.5	MT3	M3*8	T10	10750
501312	SDS07-21.6-24.4-MT3	338	173	99	21.6-24.4	MT3	M3*8	T10	10750
501314	SDS07-24.5-26.5-MT4	390	188	124	24.5-26.5	MT4	M3.5*10	T15	11750
501316	SDS07-26.6-28.5-MT4	404	202	124	26.6-28.5	MT4	M3.5*10	T15	11750
501318	SDS07-28.6-30.5-MT4	418	216	124	28.6-30.5	MT4	M3.5*10	T15	12281
501320	SDS07-30.6-32.5-MT4	432	230	124	30.6-32.5	MT4	M3.5*10	T15	12281
501322	SDS07-32.6-34.9-MT4	449	247	124	32.6-34.9	MT4	M3.5*10	T15	12281
501324	SDS07-35.0-37.9-MT5	512	268	156	35.0-37.9	MT5	M3.5*10	T15	13500
501326	SDS07-38.0-40.9-MT5	533	289	156	38.0-40.9	MT5	M3.5*10	T15	13500
501328	SDS07-41.0-43.9-MT5	554	310	156	41.0-43.9	MT5	M3.5*10	T15	14094
501330	SDS07-44.0-47.9-MT5	582	338	156	44.0-47.9	MT5	M3.5*10	T15	14781
501332	SDS07-48.0-51.9-MT5	610							

Abandon Type Drill

High speed steel spade drill rod

3*D Flanged Shank Spade Drill

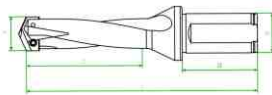

Order	Type Model	L	L1	L2	D	D1	screw	Wrench	Price
502100	SDS03-09.5-11.0-P20	106	36	48	9.5-11.0	20	M2*5	T6	5375
502102	SDS03-11.1-12.9-P20	112	42	48	11.1-12.9	20	M2*5	T6	5375
502104	SDS03-13.0-15.0-P20	118	48	48	13.0-15.0	20	M2.5*6	T8	5375
502106	SDS03-15.1-17.5-P20	125	55	48	15.1-17.5	20	M2.5*6	T8	5563
502108	SDS03-17.6-19.5-P25	140	61	56	17.6-19.5	25	M3*8	T10	5781
502110	SDS03-19.6-21.5-P25	146	67	56	19.6-21.5	25	M3*8	T10	5781
502112	SDS03-21.6-24.4-P25	155	76	56	21.6-24.4	25	M3*8	T10	5781
502114	SDS03-24.5-26.5-P32	170	82	60	24.5-26.5	32	M3.5*10	T15	5969
502116	SDS03-26.6-28.5-P32	176	88	60	26.6-28.5	32	M3.5*10	T15	5969
502118	SDS03-28.6-30.5-P32	182	94	60	28.6-30.5	32	M3.5*10	T15	6313
502120	SDS03-30.6-32.5-P32	188	100	60	30.6-32.5	32	M3.5*10	T15	6313
502122	SDS03-32.6-34.9-P32	195	107	60	32.6-34.9	32	M3.5*10	T15	6313
502124	SDS03-35.0-37.9-P32	206	116	60	35.0-37.9	32	M3.5*10	T15	6656
502126	SDS03-38.0-40.9-P32	215	125	60	38.0-40.9	32	M3.5*10	T15	6656
502128	SDS03-41.0-43.9-P40	232	134	65	41.0-43.9	40	M3.5*10	T15	7094
502130	SDS03-44.0-47.9-P40	244	146	65	44.0-47.9	40	M3.5*10	T15	7563
502132	SDS03-48.0-51.9-P40	256	158	65	48.0-51.9	40	M5*15	T20	8125
502134	SDS03-52.0-55.9-P40	268	170	65	52.0-55.9	40	M5*15	T20	8719
502136	SDS03-56.0-59.9-P40	280	182	65	56.0-59.9	40	M5*15	T20	9344
502138	SDS03 60.0-65.0-P40	296	198	65	60.0-65.0	40	M5*15	T20	9969

5*D Flanged Shank Spade Drill

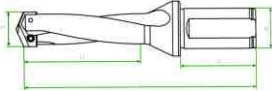

Order	Type Model	L	L1	L2	D	D1	screw	Wrench	Price
502200	SDS05-09.5-11.0-P20	128	58	48	9.5-11.0	20	M2*5	T6	6156
502202	SDS05-11.1-12.9-P20	138	68	48	11.1-12.9	20	M2*5	T6	6156
502204	SDS05-13.0-15.0-P20	148	78	48	13.0-15.0	20	M2.5*6	T8	6156
502206	SDS05-15.1-17.5-P20	160	90	48	15.1-17.5	20	M2.5*6	T8	6406
502208	SDS05-17.6-19.5-P25	179	100	56	17.6-19.5	25	M3*8	T10	6625
502210	SDS05-19.6-21.5-P25	189	110	56	19.6-21.5	25	M3*8	T10	6625
502212	SDS05-21.6-24.4-P25	204	125	56	21.6-24.4	25	M3*8	T10	6625
502214	SDS05-24.5-26.5-P32	223	135	60	24.5-26.5	32	M3.5*10	T15	6875
502216	SDS05-26.6-28.5-P32	233	145	60	26.6-28.5	32	M3.5*10	T15	6875
502218	SDS05-28.6-30.5-P32	243	155	60	28.6-30.5	32	M3.5*10	T15	7281
502220	SDS05-30.6-32.5-P32	253	165	60	30.6-32.5	32	M3.5*10	T15	7281
502222	SDS05-32.6-34.9-P32	266	178	60	32.6-34.9	32	M3.5*10	T15	7281
502224	SDS05-35.0-37.9-P32	282	192	60	35.0-37.9	32	M3.5*10	T15	7656
502226	SDS05-38.0-40.9-P32	298	208	60	38.0-40.9	32	M3.5*10	T15	7656
502228	SDS05-41.0-43.9-P40	320	222	65	41.0-43.9	40	M3.5*10	T15	8156
502230	SDS05-44.0-47.9-P40	332	242	65	44.0-47.9	40	M3.5*10	T15	8688
502232	SDS05-48.0-51.9-P40	352	262	65	48.0-51.9	40	M5*15	T20	9344
502234	SDS05-52.0-55.9-P40	372	282	65	52.0-55.9	40	M5*15	T20	10031
502236	SDS05-56.0-59.9-P40	392	302	65	56.0-59.9	40	M5*15	T20	10750
502238	SDS05 60.0-65.0-P40	426	328	65	60.0-65.0	40	M5*15	T20	11469

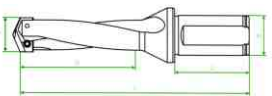

7*D Flanged Shank Spade Drill

Order	Type Model	L	L1	L2	D	D1	screw	Wrench	Price
502300	SDS07-09.5-11.0-P20	150	80	48	9.5-11.0	20	M2*5	T6	7688
502302	SDS07-11.1-12.9-P20	163	93	48	11.1-12.9	20	M2*5	T6	7688
502304	SDS07-13.0-15.0-P20	178	108	48	13.0-15.0	20	M2.5*6	T8	7688
502306	SDS07-15.1-17.5-P20	195	125	48	15.1-17.5	20	M2.5*6	T8	7969
502308	SDS07-17.6-19.5-P25	218	139	56	17.6-19.5	25	M3*8	T10	8281
502310	SDS07-19.6-21.5-P25	232	153	56	19.6-21.5	25	M3*8	T10	8281
502312	SDS07-21.6-24.4-P25	252	173	56	21.6-24.4	25	M3*8	T10	8281
502314	SDS07-24.5-26.5-P32	276	188	60	24.5-26.5	32	M3.5*10	T15	8594
502316	SDS07-26.6-28.5-P32	290	202	60	26.6-28.5	32	M3.5*10	T15	8594
502318	SDS07-28.6-30.5-P32	304	216	60	28.6-30.5	32	M3.5*10	T15	9094
502320	SDS07-30.6-32.5-P32	318	230	60	30.6-32.5	32	M3.5*10	T15	9094
502322	SDS07-32.6-34.9-P32	335	247	60	32.6-34.9	32	M3.5*10	T15	9094
502324	SDS07-35.0-37.9-P32	358	268	60	35.0-37.9	32	M3.5*10	T15	9594
502326	SDS07-38.0-40.9-P32	379	289	60	38.0-40.9	32	M3.5*10	T15	9594
502328	SDS07-41.0-43.9-P40	408	310	65	41.0-43.9	40	M3.5*10	T15	10188
502330	SDS07-44.0-47.9-P40	436	338	65	44.0-47.9	40	M3.5*10	T15	10875
502332	SDS07-48.0-51.9-P40	464	366	65	48.0-51.9	40	M5*15	T20	11688
502334	SDS07-52.0-55.9-P40	492	394	65	52.0-55.9	40	M5*15	T20	12531
502336	SDS07-56.0-59.9-P40	520	422	65	56.0-59.9	40	M5*15	T20	13438
502338	SDS07 60.0-65.0-P40	556	458	65	60.0-65.0	40	M5*15	T20	14344

Drill blade specification

Carbide insert



11.00-G12-A	11.50-G12-A	12.00-G12-A	12.50-G12-A	13.00-G12-A	13.50-G12-A	14.0-G12-A	14.50-G12-A	15.00-G12-A
15.50-G12-A	16.00-G12-A	16.50-G12-A	17.00-G12-A	17.50-G12-A	18.00-G12-A	18.5-A12-A	19.00-G12-A	19.50-G12-A
20.00-G12-A	20.50-G12-A	21.00-G12-A	21.50-G12-A	22.00-G12-A	22.50-G12-A	23.0-G12-A	23.50-G12-A	24.00-G12-A
24.50-G12-A	25.00-G12-A	25.50-G12-A	26.00-G12-A	26.50-G12-A	27.00-G12-A	27.5-G12-A	28.00-G12-A	28.50-G12-A
29.00-G12-A	29.50-G12-A	30.00-G12-A	30.50-G12-A	31.00-G12-A	31.50-G12-A	32.0-G12-A	32.50-G12-A	33.00-G12-A
33.50-G12-A	34.00-G12-A	34.50-G12-A	35.00-G12-A					

HSS Insert



9.00-M42-A	9.50-M42-A	10.00-M42-A	10.50-M42-A	11.00-M42-A	11.50-M42-A	12.00-M42-A	12.50-M42-A	13.00-M42-A
13.50-M42-A	14.00-M42-A	14.50-M42-A	15.00-M42-A	15.50-M42-A	16.00-M42-A	16.50-M42-A	17.00-M42-A	17.50-M42-A
18.00-M42-A	18.50-M42-A	19.00-M42-A	19.50-M42-A	20.00-M42-A	20.50-M42-A	21.00-M42-A	21.50-M42-A	22.00-M42-A
22.50-M42-A	23.00-M42-A	23.50-M42-A	24.00-M42-A	24.50-M42-A	25.00-M42-A	25.50-M42-A	26.00-M42-A	26.50-M42-A
27.00-M42-A	27.50-M42-A	28.00-M42-A	28.50-M42-A	29.00-M42-A	29.50-M42-A	30.00-M42-A	30.50-M42-A	31.00-M42-A
31.50-M42-A	32.00-M42-A	32.50-M42-A	33.00-M42-A	33.50-M42-A	34.00-M42-A	34.50-M42-A	35.00-M42-A	35.50-M42-A
36.00-M42-A	36.50-M42-A	37.00-M42-A	37.50-M42-A	38.00-M42-A	38.50-M42-A	39.00-M42-A	39.50-M42-A	40.00-M42-A
40.50-M42-A	41.00-M42-A	41.50-M42-A	42.00-M42-A	42.50-M42-A	43.00-M42-A	43.50-M42-A	44.00-M42-A	44.50-M42-A
45.00-M42-A	45.50-M42-A	46.00-M42-A	46.50-M42-A	47.00-M42-A	47.50-M42-A	48.00-M42-A	48.50-M42-A	49.00-M42-A
49.50-M42-A	49.50-M42-A	50.50-M42-A	51.00-M42-A	51.50-M42-A	52.00-M42-A	52.50-M42-A	53.00-M42-A	53.50-M42-A
54.00-M42-A	54.00-M42-A	55.00-M42-A	55.50-M42-A	56.00-M42-A	56.50-M42-A	57.00-M42-A	57.50-M42-A	58.00-M42-A
58.50-M42-A	58.50-M42-A	59.50-M42-A	60.00-M42-A	60.50-M42-A	61.00-M42-A	62.50-M42-A	63.00-M42-A	63.50-M42-A
64.00-M42-A	64.00-M42-A	65.00-M42-A						

The Regulation Of Insert named

Insert Material

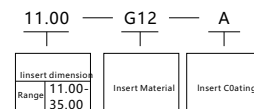

Material	Code
N-NonE	WITHOUT
T-TIN	Titanium nitride
C-TIALN	Titanium carbonitride
A-TIALN	Tialn

Insert Material

M4-HSS M4	high speed steel M4
M42-HSS M42	Highspeed steel cobalt 8%
S40-SKH40	Powder metallurgy high steel
G12-G12xF	Carbide

the Regulation Of Spade Drill HOlder named

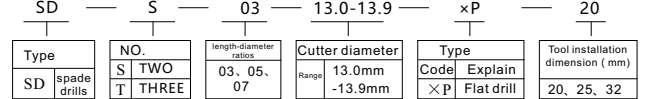

Multifunctional drill pipe

Multifunctional series products

USED

- The insert turning, drilling, using a cutting tool
- The save installation time. Shorten the time
- We reduce the cutting tool cost saving effect

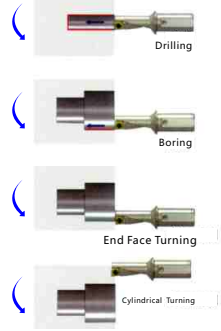
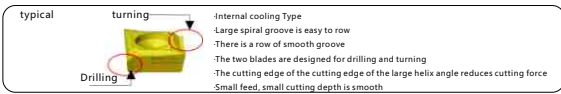
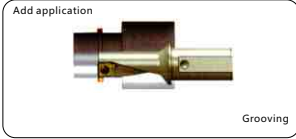
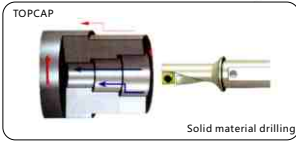
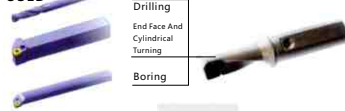

Order	Type	Model	D	d	L1	L	Applicable to insert	screw	Wrench	Price
505100	TCAP-08R/L-3.0DN		8	12	24	75	XCMT 04 01 04	M1.8x3.5	T6	1875
505102	TCAP-09R/L-3.0DN		9	12	27	83	XCMT 05 02 04	M2x5	T6	1875
505104	TCAP-10R/L-3.0DN		10	12	30	85	XCMT 05 02 04	M2x5	T6	1875
505106	TCAP-11R/L-3.0DN		11	16	33	92	XCMT 06 02 04	M2.2x5	T6	1875
505108	TCAP-12R/L-3.0DN		12	16	36	95	XCMT 06 02 04	M2.2x5	T6	1875
505110	TCAP-13R/L-3.0DN		13	16	39	100	XCMT 07 03 04	M2.5x6.5	T8	1875
505112	TCAP-14R/L-3.0DN		14	16	42	101	XCMT 07 03 04	M2.5x6.5	T8	1875
505114	TCAP-08R/L-2.25DN		8	12	18	69	XCMT 04 01 04	M1.8x3.5	T6	1875
505116	TCAP-09R/L-2.25DN		9	12	20.5	76	XCMT 05 02 04	M2x5	T6	1875
505118	TCAP-10R/L-2.25DN		10	12	22.5	78	XCMT 05 02 04	M2x5	T6	1875
505120	TCAP-11R/L-2.25DN		11	16	25	84	XCMT 06 02 04	M2.2x5	T6	1875
505122	TCAP-12R/L-2.25DN		12	16	27	86	XCMT 06 02 04	M2.2x5	T6	1875
505124	TCAP-13R/L-2.25DN		13	16	29.5	91	XCMT 07 03 04	M2.5x6.5	T8	1875
505126	TCAP-14R/L-2.25DN		14	16	31.5	91	XCMT 07 03 04	M2.5x6.5	T8	1875

Reducer sleeve

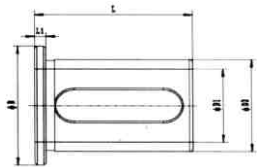

Order	Type	Dimension(mm)					Price
		D	D1	D2	L	L1	
505200	BJT-322062	20	49	32	62	5	500
505202	BJT-322562	25	49	32	62	5	500
505204	BJT-402065	20	58	40	65	6	625
505206	BJT-402565	25	58	40	65	6	625
505208	BJT-403265	32	58	40	65	6	625
505210	BJT-502572	25	65	50	70	6	750
505212	BJT-503272	32	65	50	70	6	750
505214	BJT-504072	40	65	50	70	6	750

Eccentric sleeve

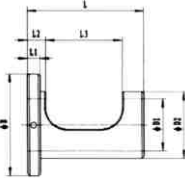

Order	Type	Dimension(mm)							Diameter adjustment range	Center height adjustment range	Price
		ΦD1	ΦD2	ΦD	L	L1	L2	L3			
505300	2025-43	20	25	41	47	6	11	33	+0.4-0.2	+0.2-0.15	1250
505302	2532-48	25	32	49	60	6	11	45	+0.4-0.2	+0.2-0.15	1250
505304	3240-53	32	40	58	65	6	11	50	+0.4-0.2	+0.2-0.15	1563
505306	4050-63	40	50	68	76	6	11	61	+0.6-0.2	+0.2-0.2	1750

Fixed seat

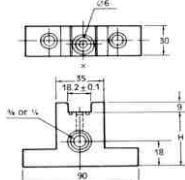

Oil handle

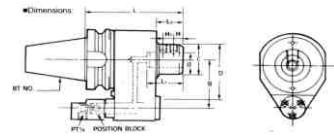

Order	Type	d	L	B	c	D	LO	L1	H	L3	Price
505400	BT40-OSL32-155	32	155	60/65	53	90	50	60	15	15	
505402	BT40-OSL40-155	40	155	60/65	70	90	50	70	19	18	
505404	BT50-OSL32-160	32	160	80/82	54	100	50	60	15	15	
505406	BT50-OSL40-160	40	160	80/82	64	100	50	70	19	18	



Installation diagram of Morse handle Schematic diagram of BT handle installation

Morse switch

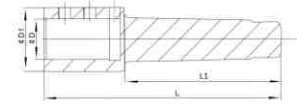

Order	Type	D	D1	L	L1	Price
505500	DIN228-B-32-MTA4	32	64	204	124	1438
505502	DIN228-B-40-MTA4	40	64	204	124	1438
505504	DIN228-B-32-MTA5	32	64	204	156	1563
505506	DIN228-B-40-MTA5	40	64	204	156	1563
505508	DIN228-B-32-MTA6	32	64	303	218	1875
505510	DIN228-B-40-MTA6	40	64	303	218	1875
505512	DIN228-B-50-MTA6	50	74	303	218	2188

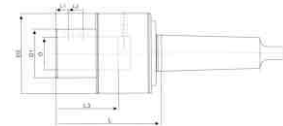

Order	Type	D	D1	D2	L	L1	L2	L3	Price
505600	MT5-YLDB-32	32	55	92	127	15	18	60	5000
505602	MT5-YLDB-40	40	60	98	127	15	18	65	5313
505604	MT6-YLDB-32	32	55	92	127	15	18	60	5625
505606	MT6-YLDB-40	40	60	98	127	15	18	65	5625
505608	MT6-YLDB-50	50	70	108	127	15	18	70	5938

Composite tool success case

Product	Drawings	Instruction
		Three process, boring, chamfer, counterbore concentrates in one tool.
		After boring, through clamp finishing boring to ensure dimensional accuracy.
		Optimizing insert angle to play overlay board, then clamp finishing boring dimension.
		Efficiently and conveniently boring, chamfer, spot facing. With Morse shank, and work in vertical drill, tailstock, etc..
		Wind power bearing bore dedicate holder, special chip-breaker, symmetrical double blade, targeted and optimized design, 42CrMo, HB280, S1000, F200, low speed, high feed, low wear, high efficiency.
		Dedicated boring for yacht FRP. Special material, designed in double blow, product dimension for stability, no deformation.
		Modular structure match twist drill to the problem of compound tool of keyhole.

* Note: all composite tools are used in actual production.

Abandon Type Drill

Insert holder



Order	Type	Internal Edge	External Edge	Insert	Edge	Screw	Wrench	Price
506100	45-50	VNC-045050N	VMC-045050T	WC.030204	2	TSB-22045	T6	1125
506102	50-55	VNC-050055N	VMC-050055T					1125
506104	55-60	VNC-055060N	VMC-055060T	WC.040204	2	TSB-25055		1125
506106	60-65	VNC-060065N	VMC-060065T					1250
506108	65-70	VNC-065070N	VMC-065070T	WC.050308	2	TSB-30070	T10	1250
506110	70-75	VNC-070075N	VMC-070075T					1250
506112	75-80	VNC-075080N	VMC-075080T					1563
506114	80-85	VNC-080085N	VMC-080085T					1563
506116	85-90	VNC-085090N	VMC-085090T	WC.06T308	2	TSB-35090	T15	1563
506118	90-95	VNC-090095N	VMC-090095T					1563
506120	95-100	VNC-095100N	VMC-095100T					1875
506122	100-105	VNC-100105N	VMC-100105T	WC.050308	3	TSB-30070	T10	1875
506124	105-110	VNC-105110N	VMC-105110T					1875
506126	110-115	VNC-110115N	VMC-110115T					1875
506128	115-120	VNC-115120N	VMC-115120T					1875
506130	120-125	VNC-120125N	VMC-120125T	WC.06T308	3	TSB-35090		1875
506132	125-130	VNC-125130N	VMC-125130T					1875
506134	130-135	VNC-130135N	VMC-130135T					1875
506136	135-140	VNC-135140N	VMC-135140T					2500
506138	140-150	VNC-140150N	VMC-140150T					2500
506140	150-160	VNC-150160N	VMC-150160T					2500
506142	160-170	VNC-160170N	VMC-160170T	WC.080408	3	TSB-40110		3125
506144	170-180	VNC-170180N	VMC-170180T					3125

VMD Drilling

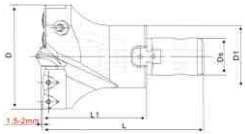

Order	Type	D	Ds	D1	Guide drill D2	L	L1	Tool holder	Applicable blade	Screw	Wrench	Price
506200	VMD-045050		16	30	PLS-1035 TIN-H	60	95	VMC-045050N/T	WCMT030208	TSB-25055	T8	7875
506202	VMD-050055							VMC-050055N/T				7875
506204	VMD-055060							VMC-055060N/T	WCMT040208			7875
506206	VMD-060065							VMC-060065N/T				7875
506208	VMD-065070		25	45	TIN-H	127		VMC-065070N/T	WCMT050308	TSB-30070		8438
506210	VMD-070075							VMC-070075N/T				9500
506212	VMD-075080							VMC-075080N/T				9500
506214	VMD-080085				PLS-1645	82		VMC-080085N/T	WCMT06T308	TSB-35090	T15	10063
506216	VMD-085090		30	50	TIN-H	139		VMC-085090N/T				10063
506218	VMD-090095							VMC-090095N/T				11813
506220	VMD-095100							VMC-095100N/T	WCMT050308	TSB-30070	T8	11938
506222	VMD-100105		32	58	PLS-2045 TIN-H	94		VMC-100105N/T				12625
506224	VMD-105110							VMC-105110N/T				13625
506226	VMD-110115							VMC-110115N/T				14438
506228	VMD-115120					154		VMC-115120N/T				15813
506230	VMD-120125		40	70		104		VMC-120125N/T	WCMT06T308	TSB-35090		16438
506232	VMD-125130							VMC-125130N/T				17125
506234	VMD-130135							VMC-130135N/T				17875
506236	VMD-135140							VMC-135140N/T				18688
506238	VMD-140145							VMC-140145N/T				21188
506240	VMD-145150							VMC-145150N/T				21969
506242	VMD-150155		50	80	PLS-2556 TIN-H	116	176	VMC-150155N/T				22750
506244	VMD-155160							VMC-155160N/T				23581
506246	VMD-160165							VMC-160165N/T	WCMT080408	TSB-40110		24688
506248	VMD-165170							VMC-165170N/T				25625
506250	VMD-170175							VMC-170175N/T				26563
506252	VMD-175180							VMC-175180N/T				28125

Connecting rod



Order	Type	D	D1	D2	L	L1	M	Application	Price
506300	DX2-3016100	30	16	32	100	75	M10X1	φ45--φ55	2188
506302	DX2-3013150	30	16	32	150	75	M10X1		2188
506304	DX2-3016200	30	16	32	200	75	M10X1		2500
506306	DX2-3016250	30	16	32	250	75	M10X1		2800
506308	DX2-3016300	30	16	32	300	75	M10X1	3100	
506310	DX2-3016400	30	16	32	400	75	M10X1	3400	
506312	DX2-4525100	45	25	40	100	75	M10X1	φ60--φ80	2500
506314	DX2-4525150	45	25	40	150	75	M10X1		2500
506316	DX2-4525200	45	25	40	200	75	M10X1		2813
506318	DX2-4525250	45	25	40	250	75	M10X1		3125
506320	DX2-4525300	45	25	40	300	75	M10X1	3438	
506322	DX2-4525400	45	25	40	400	75	M10X1	3750	
506324	DX2-5030100	50	30	40	100	75	M12X1	φ85--φ95	3125
506326	DX2-5030150	50	30	40	150	75	M12X1		3125
506328	DX2-5030200	50	30	40	200	75	M12X1		3438
506330	DX2-5030250	50	30	40	250	75	M12X1		3750
506332	DX2-5030300	50	30	40	300	75	M12X1	3750	
506334	DX2-5030400	50	30	40	400	75	M12X1	3950	
506336	DX2-5832100	58	32	40	100	75	M12X1	φ100--φ110	3750
506338	DX2-5832150	58	32	40	150	75	M12X1		3750
506340	DX2-5832200	58	32	40	200	75	M12X1		4063
506342	DX2-5832250	58	32	40	250	75	M12X1		4375
506344	DX2-5832300	58	32	40	300	75	M12X1	4600	
506346	DX2-5832400	58	32	40	400	75	M12X1	4900	
506348	DX2-7040100	70	40	50	100	80	M12X1	φ115--φ135	5000
506350	DX2-7040150	70	40	50	150	80	M12X1		5000
506352	DX2-7040200	70	40	50	200	80	M12X1		5625
506354	DX2-7040250	70	40	50	250	80	M12X1		5625
506356	DX2-7040300	70	40	50	300	80	M12X1	6250	
506358	DX2-7040400	70	40	50	400	80	M12X1	7500	
506360	DX2-8050100	80	50	50	100	80	M12X1	φ140--φ195	6250
506362	DX2-8050150	80	50	50	150	80	M12X1		6250
506364	DX2-8050200	80	50	50	200	80	M12X1		6875
506366	DX2-8050250	80	50	50	250	80	M12X1		7500
506368	DX2-8050300	80	50	50	300	80	M12X1	8125	
506370	DX2-8050400	80	50	50	400	80	M12X1	9375	

Centering drill

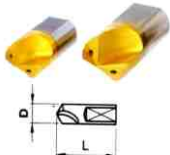

Order	Type	D	L	Price
506400	PLD-V1035 TIN-H	10	35	769
506402	PLD-V1238 TIN-H	12	38	988
506404	PLD-V1645 TIN-H	16	45	1125
506406	PLD-2045 TIN-H	20		1625
506408	PLD-2556 TIN-H	25		2100
506410	PLD-3068 TIN-H	30		2800

VMD indexable inserts greatly improve processing efficiency

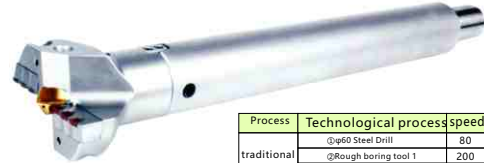

Process	Technological process	Speed	Feed	Processing time	Long time
traditional process	φ98 Steel Drill	80	16	1 hour	10 Minutes
	φRough boring tool 1	200	30	40 Minutes	150 Minutes
New process	φRough boring tool 2	200	30	40 Minutes	
	VMD Drilling φ105	280	45	18 Minutes	18 Minutes

Processing 105mm hole depth 550mm, material 42CrMo, HB 220

Drilling Speed

$$S = \frac{Vc \times 1000}{\pi \times Dc}$$

Vc=Linear velocity 100m/min
Dc=Drill diameter
S=Spindle speed

Example: Taking the diameter of drill bit φ100mm as an example.
 $S = \frac{100 \times 1000}{3.14 \times 100} = 318 \text{ rev/min}$

Feeding speed

$$Vf = Fr \times S$$

Vf=Feeding speed
Fr=Feed per revolution
S=Spindle speed

Example: Taking the diameter of drill bit φ100mm as an example. Feed per revolution 0.15mm/rev.
 $Vf = 0.15 \times 318 = 47.7 \text{ mm/min}$

Hole processing time

$$Tc = \frac{H}{Vf} \times 60$$

Tc(s)=Processing time
H=The depth of processing hole

Example: the diameter of the drill bit 100, for example, the hole processing depth of 100mm.
 $Tc = \frac{100 \times 60}{47.7} = 126 \text{ (s)}$

Machining φ105mm depth 550mm, material 42CrMo, HB220

In the oil, coal and other machine industries, as oversize hole machining becomes more and more common, the application of VMD indexable drill can greatly improve the machining efficiency.

The bright spot of VMD indexable drill:

- 1 Using the structure of center guide drill with better centering effect to make sure hole site a good straightness.
- 2 Internal and External cutter edge is applied to the structure of replaceable clamp tool. In practical using, the most vulnerable is external edge clamp. Replacing clamp can avoid the drill scrapped to save the tool cost.
- 3 Adjusting external clamp, the dimension of drill machining can vary within 0-5 mm.
- 4 Cutter head and shank are modular structure. Only change different length shank during processing the different depth of the hole.
- 5 Drill with center water hole can cool insert better, extend insert life and accelerate chip evacuation.
- 6 Using indexable carbide insert cutting with high speed and feed, surface finish has greatly improved.

Jet drill series



1. Coolant oil fluid supply is fed through an oil pressure head between the outside of the drill tube and the hole wall.
2. A seal between the workpiece and the drill bush is necessary.
3. Double the coolant pressure and quantity are required than with the Ejector system.
4. Preferably used for materials with long chip formation, such as stainless steel, low carbon steel and materials with an uneven structure.
5. Single thbe system is more advantageous for extremely long workpieces and for workpieces with large holes.

