

5920

BORING HEAD GIN-BHC2



Order No.	Model	ACTUAL SIZE	OVERALL LENGTH	BORING BAR HOLE SIZE	CENTER DIST. BETWEEN HOLES	CROSS HOLE DIA	OFFSET	M	N.W. (Kg)
5920-11	BHC ₂ inch	2" Dia	2-7/16"	1/2"	5/8"	1/2"	5/8"	7/8"-20	0.7
5920-12	BHC ₂ m/m	φ50	63	12	15	12	15	1-1/2-18"	0.7
5920-13	BHC ₂ inch	2" Dia	2-7/16"	1/2"	5/8"	1/2"	5/8"	1-1/2-18"	0.7

5920A

BORING HEAD+SHANK

Order No.	Model	Specification	N.W. (Kg)
5920A-02	BHC2+BT40	M16×P2.0	2.4
5920A-04	BHC2+BT50	M24×P3.0	5.3
5920A-06	BHC2+R8	7/16"×20UNC	1.8
5920A-08	BHC2+NT30	1/2"×12UNC	1.7
5920A-10	BHC2+NT30	M12×P1.75	1.7
5920A-12	BHC2+NT40	5/8"×11UNC	2.3
5920A-14	BHC2+NT40	M16×P2.0	2.3
5920A-16	BHC2+NT50	1"×8UNC	4.5
5920A-18	BHC2+NT50	M24×P3.0	4.5
5920A-20	BHC2+MT2	3/8"×16UNC	1.4
5920A-22	BHC2+MT2	M10×P1.5	1.4
5920A-24	BHC2+MT3	3/8"×16UNC	1.55
5920A-26	BHC2+MT3	1/2"×13UNC	1.55
5920A-28	BHC2+MT3	1/2"×12UNC	1.55
5920A-30	BHC2+MT3	M12×P1.75	1.55
5920A-32	BHC2+MT4	5/8"×11UNC	1.9
5920A-34	BHC2+MT4	M16×P2.0	1.9
5920A-36	BHC2+MT5	1"×8UNC	2.6
5920A-38	BHC2+MT5	M24×P3.0	2.6
5920A-40	BHC2+MT2	TANGED	1.5
5920A-42	BHC2+MT3	TANGED	1.6
5920A-44	BHC2+MT4	TANGED	2
5920A-46	BHC2+MT5	TANGED	3
5920A-48	BHC2+20φ	20φx60L	1.5
5920A-50	BHC2+25φ	25φx60L	1.55
5920A-52	BHC2+32φ	32φx60L	1.7

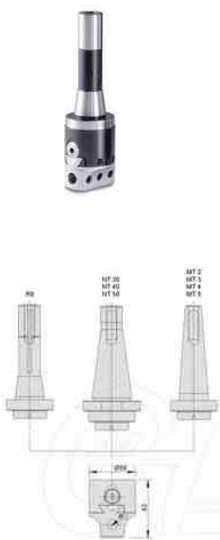

5920B

BORING HEAD+SHANK+BAR

Order No.	Model	Specification	Bar	N.W. (Kg)
5920B-02	BHC2+BT40	M16×P2.0	+Bar 902063	2.55
5920B-04	BHC2+BT50	M24×P3.0	+Bar 902063	5.55
5920B-06	BHC2+R8	7/16"×20UNC	+Bar 902063	1.95
5920B-08	BHC2+NT30	1/2"×12UNC	+Bar 902063	1.85
5920B-10	BHC2+NT30	M12×P1.75	+Bar 902063	1.85
5920B-12	BHC2+NT40	5/8"×11UNC	+Bar 902063	2.45
5920B-14	BHC2+NT40	M16×P2.0	+Bar 902063	2.45
5920B-16	BHC2+NT50	1"×8UNC	+Bar 902063	4.65
5920B-18	BHC2+NT50	M24×P3.0	+Bar 902063	4.65
5920B-20	BHC2+MT2	3/8"×16UNC	+Bar 902063	1.55
5920B-22	BHC2+MT2	M10×P1.5	+Bar 902063	1.55
5920B-24	BHC2+MT3	3/8"×16UNC	+Bar 902063	1.7
5920B-26	BHC2+MT3	1/2"×13UNC	+Bar 902063	1.7
5920B-28	BHC2+MT3	1/2"×12UNC	+Bar 902063	1.7
5920B-30	BHC2+MT3	M12×P1.75	+Bar 902063	1.7
5920B-32	BHC2+MT4	5/8"×11UNC	+Bar 902063	2.05
5920B-34	BHC2+MT4	M16×P2.0	+Bar 902063	2.05
5920B-36	BHC2+MT5	1"×8UNC	+Bar 902063	2.75
5920B-38	BHC2+MT5	M24×P3.0	+Bar 902063	2.75
5920B-40	BHC2+MT2	TANGED	+Bar 902063	1.65
5920B-42	BHC2+MT3	TANGED	+Bar 902063	1.75
5920B-44	BHC2+MT4	TANGED	+Bar 902063	2.15
5920B-46	BHC2+MT5	TANGED	+Bar 902063	3.15
5920B-48	BHC2+20φ	20φx60L	+Bar 902063	1.65
5920B-50	BHC2+25φ	25φx60L	+Bar 902063	1.7
5920B-52	BHC2+32φ	32φx60L	+Bar 902063	1.85

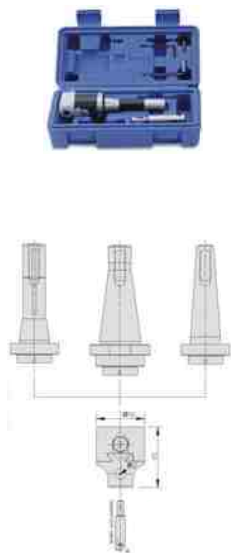

5920C

BORING HEAD+SHANK+TOOL

Min Boring Diameter 10mm ,
Max Boring Diameter 150mm
Max Height Boring Diameter 50mm ,
Any taper shank can be replaced as schedule

Order No.	Model	Specification	Tool	N.W. (kg)
5920C-02	BHC2+BT40	M16×P2.0	+BH12-08/12/20	2.65
5920C-04	BHC2+BT50	M24×P3.0	+BH12-08/12/20	5.65
5920C-06	BHC2+R8	7/16"×20UNC	+BH12-08/12/20	2.05
5920C-08	BHC2+NT30	1/2"×12UNC	+BH12-08/12/20	1.95
5920C-10	BHC2+NT30	M12×P1.75	+BH12-08/12/20	1.95
5920C-12	BHC2+NT40	5/8"×11UNC	+BH12-08/12/20	2.55
5920C-14	BHC2+NT40	M16×P2.0	+BH12-08/12/20	2.55
5920C-16	BHC2+NT50	1"×8UNC	+BH12-08/12/20	4.75
5920C-18	BHC2+NT50	M24×P3.0	+BH12-08/12/20	4.75
5920C-20	BHC2+MT2	3/8"×16UNC	+BH12-08/12/20	1.65
5920C-22	BHC2+MT2	M10×P1.5	+BH12-08/12/20	1.65
5920C-24	BHC2+MT3	3/8"×16UNC	+BH12-08/12/20	1.8
5920C-26	BHC2+MT3	1/2"×13UNC	+BH12-08/12/20	1.8
5920C-28	BHC2+MT3	1/2"×12UNC	+BH12-08/12/20	1.8
5920C-30	BHC2+MT3	M12×P1.75	+BH12-08/12/20	1.8
5920C-32	BHC2+MT4	5/8"×11UNC	+BH12-08/12/20	2.15
5920C-34	BHC2+MT4	M16×P2.0	+BH12-08/12/20	2.15
5920C-36	BHC2+MT5	1"×8UNC	+BH12-08/12/20	2.85
5920C-38	BHC2+MT5	M24×P3.0	+BH12-08/12/20	2.85
5920C-40	BHC2+MT2	TANGED	+BH12-08/12/20	1.75
5920C-42	BHC2+MT3	TANGED	+BH12-08/12/20	1.75
5920C-44	BHC2+MT4	TANGED	+BH12-08/12/20	2.25
5920C-46	BHC2+MT5	TANGED	+BH12-08/12/20	3.25
5920C-48	BHC2+20φ	20φx60L	+BH12-08/12/20	1.75
5920C-50	BHC2+25φ	25φx60L	+BH12-08/12/20	1.8
5920C-52	BHC2+32φ	32φx60L	+BH12-08/12/20	1.95



5920D

BORING HEAD SETS(BHC2)

Min Boring Diameter 10mm ,
Max Boring Diameter 150mm
Max Height Boring Diameter 50mm ,
Any taper shank can be replaced as schedule

Order No.	Model	Specification	N.W. (kg)
5920D-01	BHC2	Without shank	1.4
5920D-02	BHC2-BT40	M16×P2.0	2.65
5920D-04	BHC2-BT50	M24×P3.0	5.65
5920D-06	BHC2-R8	7/16"×20UNC	2.05
5920D-08	BHC2-NT30	1/2"×12UNC	1.95
5920D-10	BHC2-NT30	M12×P1.75	1.95
5920D-12	BHC2-NT40	5/8"×11UNC	2.55
5920D-14	BHC2-NT40	M16×P2.0	2.55
5920D-16	BHC2-NT50	1"×8UNC	4.75
5920D-18	BHC2-NT50	M24×P3.0	4.75
5920D-20	BHC2-MT2	3/8"×16UNC	1.65
5920D-22	BHC2-MT2	M10×P1.5	1.65
5920D-24	BHC2-MT3	3/8"×16UNC	1.8
5920D-26	BHC2-MT3	1/2"×13UNC	1.8
5920D-28	BHC2-MT3	1/2"×12UNC	1.8
5920D-30	BHC2-MT3	M12×P1.75	1.8
5920D-32	BHC2-MT4	5/8"×11UNC	2.15
5920D-34	BHC2-MT4	M16×P2.0	2.15
5920D-36	BHC2-MT5	1"×8UNC	2.85
5920D-38	BHC2-MT5	M24×P3.0	2.85
5920D-40	BHC2-MT2	TANGED	1.75
5920D-42	BHC2-MT3	TANGED	1.75
5920D-44	BHC2-MT4	TANGED	2.25
5920D-46	BHC2-MT5	TANGED	3.25



STRAIGHT SHANK

Order No.	Model	Specification	N.W. (Kg)
5920D-48	BHC2-20φ	20φx60L	1.75
5920D-50	BHC2-25φ	25φx60L	1.8
5920D-52	BHC2-32φ	32φx60L	1.95

5925

BORING HEAD GIN-BHC3

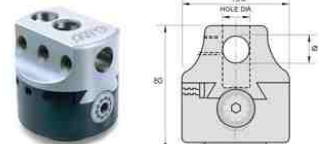

Order No.	Model	ACTUAL SIZE	OVERALL LENGTH	BORING BAR HOLE SIZE	CENTER DIST. BETWEEN HOLES	CROSS HOLE DIA	OFFSET	N.W. (Kg)
5925-11	BHC ₃ inch	3" Dia	3-5/32"	3/4"	15/16"	3/4"	1"	2
5925-12	BHC ₃ m/m	75	80	18	23	18	25	2

5925A

BORING HEAD +SHANK

Order No.	Model	Specification	N.W. (Kg)
5925A-02	BHC2+BT40	M16×P2.0	3.6
5925A-04	BHC2+BT50	M24×P3.0	6.9
5925A-06	BHC2+R8	7/16"×20UNC	2.95
5925A-08	BHC2+NT30	1/2"×12UNC	2.9
5925A-10	BHC2+NT30	M12×P1.75	2.9
5925A-12	BHC2+NT40	5/8"×11UNC	3.5
5925A-14	BHC2+NT40	M16×P2.0	3.5
5925A-16	BHC2+NT50	1"×8UNC	6.05
5925A-18	BHC2+NT50	M24×P3.0	6.05
5925A-20	BHC2+MT2	3/8"×16UNC	2.65
5925A-22	BHC2+MT2	M10×P1.5	2.65
5925A-24	BHC2+MT3	3/8"×16UNC	2.8
5925A-26	BHC2+MT3	1/2"×13UNC	2.8
5925A-28	BHC2+MT3	1/2"×12UNC	2.8
5925A-30	BHC2+MT3	M12×P1.75	2.8
5925A-32	BHC2+MT4	5/8"×11UNC	3.1
5925A-34	BHC2+MT4	M16×P2.0	3.1
5925A-36	BHC2+MT5	1"×8UNC	3.8
5925A-38	BHC2+MT5	M24×P3.0	3.8
5925A-40	BHC2+MT2	TANGED	2.7
5925A-42	BHC2+MT3	TANGED	2.8
5925A-44	BHC2+MT4	TANGED	5.5
5925A-46	BHC2+MT5	TANGED	4.1



STRAIGHT SHANK

Order No.	Model	Specification	N.W. (Kg)
5925A-48	BHC3+20φ	20φx60L	2.7
5925A-50	BHC3+25φ	25φx60L	2.8
5925A-52	BHC3+32φ	32φx60L	2.9

5925B

BORING HEAD+SHANK+TOOL

Order No.	Model	Specification	Bar	N.W.(kg)
5925B-02	BHC3+BT40	M16xP2.0	+Bar 902023	3.85
5925B-04	BHC3+BT50	M24xP3.0	+Bar 902023	7.15
5925B-06	BHC3+R8	7/16"x20UNC	+Bar 902023	3.2
5925B-08	BHC3+NT30	1/2"x12UNC	+Bar 902023	3.15
5925B-10	BHC3+NT30	M12xP1.75	+Bar 902023	3.15
5925B-12	BHC3+NT40	5/8"x11UNC	+Bar 902023	3.75
5925B-14	BHC3+NT40	M16xP2.0	+Bar 902023	3.75
5925B-16	BHC3+NT50	1"x8UNC	+Bar 902023	6.3
5925B-18	BHC3+NT50	M24xP3.0	+Bar 902023	6.3
5925B-20	BHC3+MT2	3/8"x16UNC	+Bar 902023	2.9
5925B-22	BHC3+MT2	M10xP1.5	+Bar 902023	2.9
5925B-24	BHC3+MT3	3/8"x16UNC	+Bar 902023	3.05
5925B-26	BHC3+MT3	1/2"x13UNC	+Bar 902023	3.05
5925B-28	BHC3+MT3	1/2"x12UNC	+Bar 902023	3.05
5925B-30	BHC3+MT3	M12xP1.75	+Bar 902023	3.05
5925B-32	BHC3+MT4	5/8"x11UNC	+Bar 902023	3.35
5925B-34	BHC3+MT4	M16xP2.0	+Bar 902023	3.35
5925B-36	BHC3+MT5	1"x8UNC	+Bar 902023	4.05
5925B-38	BHC3+MT5	M24xP3.0	+Bar 902023	4.05
5925B-40	BHC3+MT2	TANGED	+Bar 902023	2.95
5925B-42	BHC3+MT3	TANGED	+Bar 902023	3.05
5925B-44	BHC3+MT4	TANGED	+Bar 902023	5.75
5925B-46	BHC3+MT5	TANGED	+Bar 902023	4.35

STRAIGHT SHANK

Order No.	Model	Specification	Bar	N.W.(kg)
5925B-48	BHC3+20φ	20φx60L	+Bar 902023	2.95
5925B-50	BHC3+25φ	25φx60L	+Bar 902023	3.05
5925B-52	BHC3+32φ	32φx60L	+Bar 902023	3.15

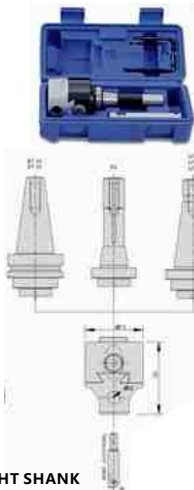

5930A

BORING HEAD+SHANK

Order NO.	Model	Specification	N.W(kg)
5930A-02	BHC4+BT40	M16xP2.0	5.8
5930A-04	BHC4+BT50	M24xP3.0	9
5930A-06	BHC4+R8	7/16"x20UNC	5.2
5930A-08	BHC4+NT30	1/2"x12UNC	5.15
5930A-10	BHC4+NT30	M12xP1.75	5.15
5930A-12	BHC4+NT40	5/8"x11UNC	5.7
5930A-14	BHC4+NT40	M16xP2.0	5.7
5930A-16	BHC4+NT50	1"x8UNC	8.2
5930A-18	BHC4+NT50	M24xP3.0	8.2
5930A-20	BHC4+MT2	3/8"x16UNC	4.9
5930A-22	BHC4+MT2	M10xP1.5	4.9
5930A-24	BHC4+MT3	3/8"x16UNC	5
5930A-26	BHC4+MT3	1/2"x13UNC	5
5930A-28	BHC4+MT3	1/2"x12UNC	5
5930A-30	BHC4+MT3	M12xP1.75	5
5930A-32	BHC4+MT4	5/8"x11UNC	5.3
5930A-34	BHC4+MT4	M16xP2.0	5.3
5930A-36	BHC4+MT5	1"x8UNC	6.4
5930A-38	BHC4+MT5	M24xP3.0	6.4
5930A-40	BHC4+MT2	TANGED	4.9
5930A-42	BHC4+MT3	TANGED	5
5930A-44	BHC4+MT4	TANGED	5.4
5930A-46	BHC4+MT5	TANGED	6.7

STRAIGHT SHANK

Order NO.	Model	Specification	N.W(kg)
5930A-48	BHC4+20φ	20φx60L	4.95
5930A-50	BHC4+25φ	25φx60L	5
5930A-52	BHC4+32φ	32φx60L	5.15



5925C

BORING HEAD+SHANK+TOOL

Order No.	Model	Specification	Tool	N.W.(kg)
5925C-02	BHC3+BT40	M16xP2.0	+BH18-12/20/3φ	4.2
5925C-04	BHC3+BT50	M24xP3.0	+BH18-12/20/3φ	7.5
5925C-06	BHC3+R8	7/16"x20UNC	+BH18-12/20/3φ	3.55
5925C-08	BHC3+NT30	1/2"x12UNC	+BH18-12/20/3φ	3.5
5925C-10	BHC3+NT30	M12xP1.75	+BH18-12/20/3φ	3.5
5925C-12	BHC3+NT40	5/8"x11UNC	+BH18-12/20/3φ	4.1
5925C-14	BHC3+NT40	M16xP2.0	+BH18-12/20/3φ	4.1
5925C-16	BHC3+NT50	1"x8UNC	+BH18-12/20/3φ	6.65
5925C-18	BHC3+NT50	M24xP3.0	+BH18-12/20/3φ	6.65
5925C-20	BHC3+MT2	3/8"x16UNC	+BH18-12/20/3φ	3.25
5925C-22	BHC3+MT2	M10xP1.5	+BH18-12/20/3φ	3.25
5925C-24	BHC3+MT3	3/8"x16UNC	+BH18-12/20/3φ	3.4
5925C-26	BHC3+MT3	1/2"x13UNC	+BH18-12/20/3φ	3.4
5925C-28	BHC3+MT3	1/2"x12UNC	+BH18-12/20/3φ	3.4
5925C-30	BHC3+MT3	M12xP1.75	+BH18-12/20/3φ	3.4
5925C-32	BHC3+MT4	5/8"x11UNC	+BH18-12/20/3φ	3.7
5925C-34	BHC3+MT4	M16xP2.0	+BH18-12/20/3φ	3.7
5925C-36	BHC3+MT5	1"x8UNC	+BH18-12/20/3φ	4.4
5925C-38	BHC3+MT5	M24xP3.0	+BH18-12/20/3φ	4.4
5925C-40	BHC3+MT2	TANGED	+BH18-12/20/3φ	3.3
5925C-42	BHC3+MT3	TANGED	+BH18-12/20/3φ	3.4
5925C-44	BHC3+MT4	TANGED	+BH18-12/20/3φ	6.1
5925C-46	BHC3+MT5	TANGED	+BH18-12/20/3φ	4.7

STRAIGHT SHANK

Order No.	Model	Specification	Tool	N.W.(kg)
5925C-48	BHC3+20φ	20φx60L	+BH18-12/20/3φ	3.3
5925C-50	BHC3+25φ	25φx60L	+BH18-12/20/3φ	3.4
5925C-52	BHC3+32φ	32φx60L	+BH18-12/20/3φ	3.5

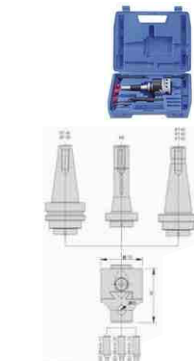

5930C

BORING HEAD+SHANK+TOOL

Order NO.	Model	Specification	Tool	N.W(kg)
5930C-02	BHC4+BT40	M16xP2.0	BH25-30	7.3
5930C-04	BHC4+BT50	M24xP3.0	BH25-30	10.5
5930C-06	BHC4+R8	7/16"x20UNC	BH25-30	6.7
5930C-08	BHC4+NT30	1/2"x12UNC	BH25-30	6.65
5930C-10	BHC4+NT30	M12xP1.75	BH25-30	6.65
5930C-12	BHC4+NT40	5/8"x11UNC	BH25-30	7.2
5930C-14	BHC4+NT40	M16xP2.0	BH25-30	7.2
5930C-16	BHC4+NT50	1"x8UNC	BH25-30	9.7
5930C-18	BHC4+NT50	M24xP3.0	BH25-30	9.7
5930C-20	BHC4+MT2	3/8"x16UNC	BH25-30	6.4
5930C-22	BHC4+MT2	M10xP1.5	BH25-30	6.4
5930C-24	BHC4+MT3	3/8"x16UNC	BH25-30	6.5
5930C-26	BHC4+MT3	1/2"x13UNC	BH25-30	6.5
5930C-28	BHC4+MT3	1/2"x12UNC	BH25-30	6.5
5930C-30	BHC4+MT3	M12xP1.75	BH25-30	6.5
5930C-32	BHC4+MT4	5/8"x11UNC	BH25-30	6.8
5930C-34	BHC4+MT4	M16xP2.0	BH25-30	6.9
5930C-36	BHC4+MT5	1"x8UNC	BH25-30	7.9
5930C-38	BHC4+MT5	M24xP3.0	BH25-30	7.9
5930C-40	BHC4+MT2	TANGED	BH25-30	6.4
5930C-42	BHC4+MT3	TANGED	BH25-30	6.5
5930C-44	BHC4+MT4	TANGED	BH25-30	6.9
5930C-46	BHC4+MT5	TANGED	BH25-30	8.2

STRAIGHT SHANK

Order NO.	Model	Specification	Tool	N.W(kg)
5930C-48	BHC4+20φ	20φx60L	BH25-30	4.95
5930C-50	BHC4+25φ	25φx60L	BH25-30	5
5930C-52	BHC4+32φ	32φx60L	BH25-30	5.15

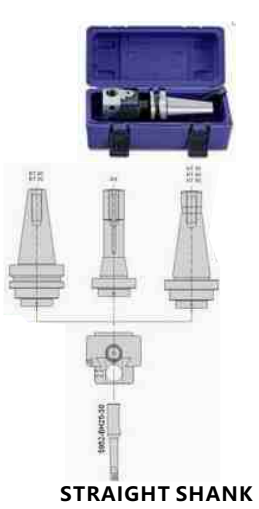

5925D

BORING HEAD SETS(BHC3)

Order NO.	Model	Specification	N.W(kg)
5925D-01	BHC3	Without shank	3.6
5925D-02	BHC3-BT40	M16xP2.0	4.7
5925D-04	BHC3-BT50	M24xP3.0	7.7
5925D-06	BHC3-R8	7/16"x20UNC	4.2
5925D-08	BHC3-NT30	1/2"x12UNC	4.2
5925D-10	BHC3-NT30	M12xP1.75	4.2
5925D-12	BHC3-NT40	5/8"x11UNC	4.8
5925D-14	BHC3-NT40	M16xP2.0	4.8
5925D-16	BHC3-NT50	1"x8UNC	6.8
5925D-18	BHC3-NT50	M24xP3.0	6.8
5925D-20	BHC3-MT2	3/8"x16UNC	3.9
5925D-22	BHC3-MT2	M10xP1.5	3.9
5925D-24	BHC3-MT3	3/8"x16UNC	4
5925D-26	BHC3-MT3	1/2"x13UNC	4
5925D-28	BHC3-MT3	1/2"x12UNC	4
5925D-30	BHC3-MT3	M12xP1.75	4
5925D-32	BHC3-MT4	5/8"x11UNC	4.4
5925D-34	BHC3-MT4	M16xP2.0	4.4
5925D-36	BHC3-MT5	1"x8UNC	5.1
5925D-38	BHC3-MT5	M24xP3.0	5.1
5925D-40	BHC3-MT2	TANGED	4
5925D-42	BHC3-MT3	TANGED	4.1
5925D-44	BHC3-MT4	TANGED	4.4
5925D-46	BHC3-MT5	TANGED	5.4

STRAIGHT SHANK

Order NO.	Model	Specification	N.W(kg)
5925D-48	BHC3-20φ	20φx60L	4
5925D-50	BHC3-25φ	25φx60L	4.1
5925D-52	BHC3-32φ	32φx60L	4.2



5932

BORING HEAD SHANK

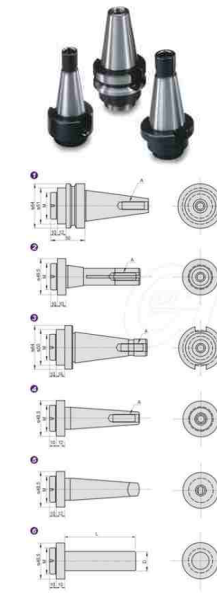

Fig 1

Order NO.	Model	Specification	N.W(kg)
5932-02	BT40	M16x2.0	1.24
5932-04	BT50	M24x3.0	3.97

Fig 2

5932-06	R8	7/16" x 20UNC	0.6
---------	----	---------------	-----

Fig 3

5932-08	NT30	1/2" x 12UNC	0.6
5932-10	NT30	M12xP1.75	0.6
5932-12	NT40	5/8" x 11UNC	1.2
5932-14	NT40	M16xP2.0	1.2
5932-16	NT50	1" x 8UNC	3.14
5932-18	NT50	M24xP3.0	3.14

Fig 4

5932-20	MT2	3/8" x 16UNC	0.4
5932-22	MT2	M10xP1.5	0.4
5932-24	MT3	3/8" x 16UNC	0.44
5932-26	MT3	1/2" x 13UNC	0.44
5932-28	MT3	1/2" x 12UNC	0.44
5932-30	MT3	M12xP1.75	0.44
5932-32	MT4	5/8" x 11UNC	0.95
5932-34	MT4	M16xP2.0	0.95
5932-36	MT5	1" x 8UNC	1.7
5932-38	MT5	M24xP3.0	1.7

Fig 5

5932-40	MT2	TANGED	0.4
5932-42	MT3	TANGED	0.5
5932-44	MT4	TANGED	0.8
5932-46	MT5	TANGED	1.8

Fig 6

STRAIGHT SHANK

Order NO.	Model	D	L	N.W(kg)
5932-48	φ20	20	60	0.4
5932-50	φ25	25	60	0.5
5932-52	φ32	32	60	0.6

5930

BORING HEAD GIN-BHC4

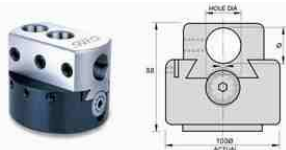

Order NO.	Model	Actual Size	Overall length	Boring Bar Hole Size	Distance	Cross Hole Dia	Offset	N.W(kg)
5930-11	BHC4 inch	4" Dia	3-1/2"	1"	1-1/4"	1"	1"	4
5930-12	BHC4 m/m	100	88	25	32	25	25	4

RBH Indexable Twin-bit Rough Boring Head 《Boring Range from φ25-φ204mm》

Specifications

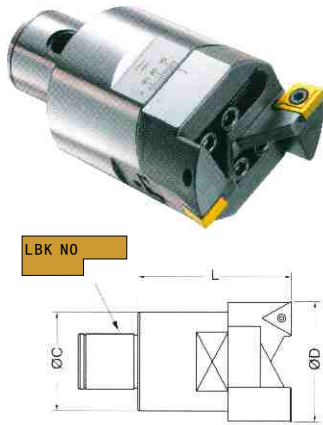

Boring Head Type	LBK No.	Boring Range	mm	mm	Insert	Weight	Order Number	(RMB) Price
RBH25-33-C	LBK2	25-33	45	24	CCMT060204	0.15	511400	805
RBH32-42-C	LBK3	32-42	55	31	CCMT060204	0.3	511402	1050
RBH32-42-T		TCMT110204			511404		1050	
RBH40-55-C	LBK4	40-55	65	39	CCMT09T304	0.5	511406	1225
RBH40-55-T		TCMT116T304			511408		1225	
RBH40-55-S	LBK5	40-55	75	50	SCMT09T304	1	511410	1225
RBH52-70-C		CCMT09T304			511412		1400	
RBH52-70-T	LBK6	52-70	85	64	TCMT116T304	2	511414	1400
RBH52-70-S		SCMT09T304			511416		1400	
RBH68-92-C	LBK6	68-92	100	80	CCMT120408	2.9	511418	2275
RBH68-92-T		TCMT116T304			511420		2275	
RBH68-92-S	LBK6	68-92	100	80	SCMT120404	2.9	511422	2275
RBH90-122-C		CCMT120408			511424		2625	
RBH90-122-T	LBK6	90-122	100	80	TCMT220408	4.8	511426	2625
RBH90-122-S		SCMT120404			511428		2625	
RBH120-164-C	BST Series	120-164	95	100	CCMT120408	3.8	511430	3150
RBH120-164-T		TCMT120408			511432		3150	
RBH120-164-S	BST Series	120-164	95	100	SCMT120404	3.8	511434	3150
RBH160-204-C		CCMT120408			511436		4200	
RBH160-204-T	BST Series	160-204	95	130	TCMT220408	4.8	511438	4200
RBH160-204-S		SCMT120404			511440		4200	

RBH Indexable Twin-bit Rough Boring Head +LBK Shank (MAS 403BT)

Specifications

▲ IBT is the improved type dedicated to resonance in boring



Tape	Fig.	ø (Dmm)	Z	Tool Connection		LBK No	L	L1	D1	KG	Order Number	(RMB) Price	
				LBK shank	RBH boring head								
BT30-RBH25-125	2	25-33	95	BT30-LBK2-80	RBH25	2	125	80	24	0.8	511500		
BT30-RBH32-135		32-42	105	BT30-LBK3-80	RBH32	3	135	80	31	1.0	511502		
BT30-RBH40-135		40-55		BT30-LBK4-70	RBH40	4		70	39	1.3	511504		
BT30-RBH52-135		52-70	115	BT30-LBK5-60	RBH52	5	115	60	50	1.8	511506		
BT30-RBH68-145		68-92		BT30-LBK6-60	RBH68	6		145	64	3.0	511508		
BT30-RBH90-160		90-122	130	BT30-LBK6-60	RBH90	6	160	60	3.9	511510			
BT40-RBH25-130		2	25-33	95	BT40-LBK2-85	RBH25	2	130	85	24	1.3	511512	
BT40-RBH25-160			32-42	115	BT40-LBK2-115	RBH32	3	160	115	24	1.6	511514	
BT40-RBH32-180			40-55		BT40-LBK3-95	RBH32	3	150	95	1.5	511516		
BT40-RBH32-210			52-70	145	BT40-LBK3-125	RBH32	3	180	125	1.8	511518		
BT40-RBH40-150	68-92		BT40-LBK3-155		RBH32	3	200	155	2.0	511520			
BT40-RBH40-195	92-122		115	BT40-LBK4-85	RBH40	4	150	85	1.8	511522			
BT40-RBH40-240	120-164			BT40-LBK4-130	RBH40	4	195	130	2.4	511524			
BT40-RBH52-150	160-204		160	BT40-LBK4-175	RBH40	4	240	175	2.7	511526			
BT40-RBH52-200	210-255			BT40-LBK5-75	RBH52	5	150	75	2.3	511528			
BT40-RBH68-150	2		68-92	115	BT40-LBK5-125	RBH52	5	200	125	3.3	511530		
BT40-RBH68-200		92-122	BT40-LBK5-175		RBH52	5	250	175	4.0	511532			
BT40-RBH68-250		120-164	215	BT40-LBK6-65	RBH68	6	150	65	3.3	511534			
BT40-RBH90-165		160-204		BT40-LBK6-115	RBH68	6	200	115	4.7	511536			
BT40-RBH90-215		130	180	BT40-LBK6-165	RBH68	6	250	165	5.9	511538			
BT40-RBH90-265				210-255	BT40-LBK6-65	RBH90	6	165	65	4.2	511540		
BT40-RBH120-165		180	230	BT40-LBK6-115	RBH90	6	215	115	5.6	511542			
BT40-RBH120-215				265	BT40-LBK6-165	RBH90	6	265	165	6.8	511544		
BT40-RBH160-165		160-204	130	BT40-BST-70	RBH120	BST	165	70	95	7.0	511546		
BT50-RBH25-155		2	25-33	105	BT50-LBK2-110	RBH25	2	155	110	24	4.1	511550	
BT50-RBH25-185	32-42		130	BT50-LBK2-140	RBH25	2	185	140	4.2	511552			
BT50-RBH32-180	40-55			BT50-LBK3-125	RBH32	3	180	125	4.4	511554			
BT50-RBH32-210	52-70		160	BT50-LBK3-155	RBH32	3	210	155	4.5	511556			
BT50-RBH40-180	68-92			BT50-LBK4-115	RBH40	4	180	115	4.8	511558			
BT50-RBH40-210	92-122		160	BT50-LBK4-145	RBH40	4	210	145	4.9	511560			
BT50-RBH40-240	120-164			BT50-LBK4-175	RBH40	4	240	175	5.3	511562			
BT50-RBH40-270	130		180	BT50-LBK4-205	RBH40	4	270	205	5.4	511564			
BT50-RBH52-180				160-204	BT50-LBK5-105	RBH52	5	180	105	5.5	511566		
BT50-RBH52-255	205		265	BT50-LBK5-180	RBH52	5	255	180	6.5	511568			
BT50-RBH52-315		315		BT50-LBK5-240	RBH52	5	315	240	7.2	511570			
BT50-RBH52-375	375	300	BT50-LBK5-300	RBH52	5	375	300	8.6	511572				
BT50-RBH68-180	2	68-92	130	BT50-LBK6-95	RBH68	6	180	95	6.5	511574			
BT50-RBH68-255		92-122		BT50-LBK6-170	RBH68	6	255	170	8.3	511576			
BT50-RBH68-315		315	230	BT50-LBK6-230	RBH68	6	315	230	9.6	511578			
BT50-RBH68-375				375	BT50-LBK6-290	RBH68	6	375	290	11.0	511580		
BT50-RBH68-435		385	350	BT50-LBK6-350	RBH68	6	435	350	15.5	511582			
BT50-RBH90-195				120-164	BT50-LBK6-95	RBH90	6	195	95	7.4	511586		
BT50-RBH90-270		220	280	BT50-LBK6-170	RBH90	6	270	170	9.2	511588			
BT50-RBH90-330				330	BT50-LBK6-230	RBH90	6	330	230	10.5	511590		
BT50-RBH90-390		340	400	BT50-LBK6-290	RBH90	6	390	290	11.9	511592			
BT50-RBH90-450				450	BT50-LBK6-350	RBH90	6	450	350	16.4	511594		
IBT50-RBH90-450	450	350	BT50-LBK6-350	RBH90	6	450	350	14.1	511596				
BT50-RBH120-195	2	120-164	150	BT50-BST-100	RBH120	BST	195	100	8.9	511598			
BT50-RBH120-245		245		BT50-BST-150	RBH120	BST	245	150	10.6	511600			
BT50-RBH120-295		250	300	BT50-BST-200	RBH120	BST	295	200	13.3	511602			
BT50-RBH120-345				345	BT50-BST-250	RBH120	BST	345	250	15.3	511604		
BT50-RBH120-395		350	400	BT50-BST-300	RBH120	BST	395	300	17.3	511606			
BT50-RBH120-445				445	BT50-BST-350	RBH120	BST	445	350	19.3	511608		
BT50-RBH120-495		450	500	BT50-BST-400	RBH120	BST	495	400	21.3	511610			
BT50-RBH160-195				195	BT50-BST-100	RBH160	BST	195	100	13.3	511612		
BT50-RBH160-245		200	250	BT50-BST-150	RBH160	BST	245	150	13.8	511614			
BT50-RBH160-295				295	BT50-BST-200	RBH160	BST	295	200	14.3	511616		
BT50-RBH160-345	300	350	BT50-BST-250	RBH160	BST	345	250	16.3	511618				
BT50-RBH160-395			395	BT50-BST-300	RBH160	BST	395	300	18.3	511620			
BT50-RBH160-445	400	450	BT50-BST-350	RBH160	BST	445	350	20.3	511622				
BT50-RBH160-495			495	BT50-BST-400	RBH160	BST	495	400	22.3	511624			

Fig.1

Fig.2

Features

- 1, suitable for single blade hole, double hole and high and low hole. The range of drilling hole is from 25 to 204mm.
- 2, the new blade slide design, blade reinforcement. During processing, the rain force acting on the sliding seat is offset by each other to produce the maximum rigidity and cutting force. Suitable for various types of drilling operations.
- 3, according to a variety of processing requirements, easy to adjust the knife, do a small variety of processing. The processing depth can be extended to the required length with the extension rod.
- 4, clear side scale, to help users easily adjusted to the desired range, no need to set the tool presetting.
- 5, the most suitable for use in various types of machine centers or boring, and collocation of various brands of specified blades of the same size, reduce tool grinding and greatly improve the efficiency of boring.
- 6, the patent high and low segment design, flat blade or high and low blade can be used.

RBH Boring Cutter System

Indexable Twin-bit Rough Boring Head RBH-A «Boring Range fromφ25-φ204mm»

Specifications



LBK NO

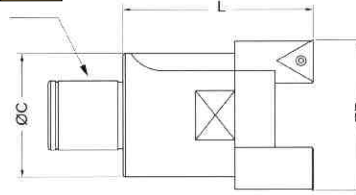

Boring Head Type	LBK No.	φDmm Boring Range	L mm	C mm	Insert	kg Weight	Order Number	(RMB) Price
RBH25-35A-C	LBK2	25-35	50	24	CCMT060204	0.15	510800	
RBH32-45A-C	LBK3	32-45	60	31	CCMT060204	0.3	510801	
RBH40-55A-T	LBK4	40-55	74	39	TCMT110204	0.6	510802	
RBH40-55A-C		CCMT09T304			510803			
RBH40-55A-T	LBK5	40-55	80	50	TCMT11T1304	1	510804	
RBH40-55A-C		SCMT09T304			510805			
RBH52-75A-T	LBK6	52-75	90	66	CCMT09T304	2.5	510806	
RBH52-75A-C		TCMT11T1304			510807			
RBH68-100A-C	LBK6	68-100	100	88	SCMT09T304	3.1	510808	
RBH68-100A-T		TCMT11T1304			510809			
RBH90-130A-C	BST Series	90-130	95	100	CCMT120408	3.8	510810	
RBH90-130A-T		TCMT120408			510811			
RBH120-164A-C	BST Series	120-164	130	130	SCMT120404	4.8	510812	
RBH120-164A-T		TCMT120408			510813			
RBH160-204A-C	BST Series	160-204	160	160	SCMT120404	5.8	510814	
RBH160-204A-T		TCMT120408			510815			
RBH160-204A-S	BST Series	160-204	160	160	SCMT120404	5.8	510816	

▲ RBH120A and RBH160A are the improved type dedicated to resonance in boring.

RBH-A Indexable Twin-bit Rough Boring Head + LBK Shank(MAS 403BT)

Specifications

▲ IBT is the improved type dedicated to resonance in boring



Fig.1

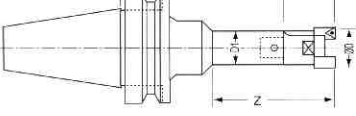
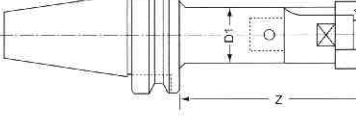

Fig.2



Tape	Fig.	φ(φEE)	Z	Tool Connection	LBK No	L	L1	D1	KG	Order Number	(RMB) Price	
BT30-RBH25A-130	2	25-35	100	BT30-LBK2-80	RBH25A	2	130	80	24	0.8	510821	0.8
BT30-RBH32A-140		32-45	110	BT30-LBK3-80	RBH32A	3	140	70	39	1.0	510822	1.0
BT30-RBH40A-140	2	40-55	110	BT30-LBK4-70	RBH40A	4	140	70	39	1.3	510823	1.3
BT30-RBH52A-140		52-75		110	BT30-LBK5-60	RBH52A				5	1.8	510824
BT30-RBH68A-150	2	68-100	120	BT30-LBK6-60	RBH68A	6	150	60	64	3.0	510825	3.0
BT30-RBH90A-160		90-130		130	BT30-LBK6-60	RBH90A	6	160	60	64	3.9	510826
BT40-RBH25A-135	2	25-35	100	BT40-LBK2-85	RBH25A	2	135	85	24	1.3	510827	1.3
BT40-RBH25A-165		32-45	110	BT40-LBK2-115	RBH25A	2	165	115	24	1.6	510828	1.6
BT40-RBH32A-155	2	40-55	110	BT40-LBK3-95	RBH32A	3	155	95	31	1.5	510829	1.5
BT40-RBH32A-185		52-75		110	BT40-LBK3-125	RBH32A	3	185	125	31	1.8	510830
BT40-RBH32A-215	2	40-55	110	BT40-LBK3-155	RBH32A	3	215	155	31	2.0	510831	2.0
BT40-RBH40A-155		120		120	BT40-LBK4-85	RBH40A	4	155	85	39	1.8	510832
BT40-RBH40A-200	2	40-55	110	BT40-LBK4-130	RBH40A	4	200	130	39	2.4	510833	2.4
BT40-RBH40A-245		52-75		110	BT40-LBK4-175	RBH40A	4	245	175	39	2.7	510834
BT40-RBH52A-155	2	52-75	120	BT40-LBK5-75	RBH52A	5	155	75	50	2.3	510835	2.3
BT40-RBH52A-205		68-100		120	BT40-LBK5-125	RBH52A	5	205	125	50	3.3	510836
BT40-RBH52A-255	2	68-100	120	BT40-LBK5-175	RBH52A	5	255	175	50	4.0	510837	4.0
BT40-RBH68A-155		90-130		120	BT40-LBK6-65	RBH68A	6	155	65	64	3.3	510838
BT40-RBH68A-205	2	68-100	120	BT40-LBK6-115	RBH68A	6	205	115	64	4.7	510839	4.7
BT40-RBH68A-255		90-130		120	BT40-LBK6-165	RBH68A	6	255	165	64	5.9	510840
BT40-RBH90A-165	2	90-130	130	BT40-LBK6-65	RBH90A	6	165	65	64	4.2	510841	4.2
BT40-RBH90A-215		120-164		130	BT40-LBK6-115	RBH90A	6	215	115	95	5.6	510842
BT40-RBH90A-265	2	120-164	130	BT40-LBK6-165	RBH90A	6	265	165	95	6.8	510843	6.8
BT40-RBH120A-165		160-204		130	BT40-BST-70	RBH120A	BST	165	70	95	7.0	510844
BT40-RBH160A-165	2	160-204	130	BT40-BST-70	RBH160A	BST	165	70	95	8.0	510845	8.0
BT50-RBH25A-160		25-35		110	BT50-LBK2-110	RBH25A	2	160	110	24	4.1	510846
BT50-RBH25A-190	2	25-35	110	BT50-LBK2-140	RBH25A	2	190	140	24	4.2	510847	4.2
BT50-RBH32A-185		32-45		110	BT50-LBK3-125	RBH32A	3	185	125	31	4.4	510848
BT50-RBH32A-215	2	32-45	110	BT50-LBK3-155	RBH32A	3	215	155	31	4.5	510849	4.5
BT50-RBH40A-185		40-55		110	BT50-LBK4-115	RBH40A	4	180	115	39	4.8	510850
BT50-RBH40A-215	2	40-55	110	BT50-LBK4-145	RBH40A	4	215	145	39	4.9	510851	4.9
BT50-RBH40A-245		52-75		110	BT50-LBK4-175	RBH40A	4	245	175	39	5.3	510852
BT50-RBH40A-275	2	40-55	110	BT50-LBK4-205	RBH40A	4	275	205	39	5.4	510853	5.4
BT50-RBH52A-185		52-75		110	BT50-LBK5-105	RBH52A	5	185	105	50	5.5	510854
BT50-RBH52A-260	2	52-75	120	BT50-LBK5-180	RBH52A	5	260	180	50	6.5	510855	6.5
BT50-RBH52A-320		68-100		120	BT50-LBK5-240	RBH52A	5	320	240	50	7.2	510856
BT50-RBH52A-380	2	68-100	120	BT50-LBK5-300	RBH52A	5	380	300	64/50	8.6	510857	8.6
BT50-RBH68A-185		90-130		120	BT50-LBK6-95	RBH68A	6	185	95	64	6.5	510858
BT50-RBH68A-260	2	90-130	120	BT50-LBK6-170	RBH68A	6	260	170	64	8.3	510859	8.3
BT50-RBH68A-320		120-164		120	BT50-LBK6-230	RBH68A	6	320	230	64	9.6	510860
BT50-RBH68A-380	2	120-164	120	BT50-LBK6-290	RBH68A	6	380	290	64	11.0	510861	11.0
BT50-RBH68A-440		160-204		120	BT50-LBK6-350	RBH68A	6	440	350	90/64	15.5	510862
BT50-RBH90A-195	2	90-130	130	BT50-LBK6-95	RBH90A	6	195	95	64	7.4	510863	7.4
BT50-RBH90A-270		120-164		130	BT50-LBK6-170	RBH90A	6	270	170	64	9.2	510865
BT50-RBH90A-330	2	90-130	130	BT50-LBK6-230	RBH90A	6	330	230	64	10.5	510866	10.5
BT50-RBH90A-390		160-204		130	BT50-LBK6-290	RBH90A	6	390	290	64	11.9	510867
BT50-RBH90A-450	2	160-204	130	BT50-LBK6-350	RBH90A	6	450	350	90/64	16.4	510868	16.4
BT50-RBH90A-450		160-204		130	BT50-LBK6-350	RBH90A	6	450	350	64	14.1	510869
BT50-RBH120A-195	2	120-164	130	BT50-RST-100	RBH120A	BST	195	100	95	8.9	510870	8.9
BT50-RBH120A-245		160-204		130	BT50-RST-150	RBH120A	BST	245	150	95	10.6	510871
BT50-RBH120A-295	2	120-164	130	BT50-RST-200	RBH120A	BST	295	200	95	13.3	510872	13.3
BT50-RBH120A-345		160-204		130	BT50-RST-250	RBH120A	BST	345	250	95	15.3	510873
BT50-RBH120A-395	2	120-164	130	BT50-RST-300	RBH120A	BST	395	300	95	17.3	510874	17.3
BT50-RBH120A-445		160-204		130	BT50-RST-350	RBH120A	BST	445	350	95	19.3	510875
BT50-RBH120A-495	2	120-164	130	BT50-RST-400	RBH120A	BST	495	400	95	21.3	510876	21.3
BT50-RBH160A-195		160-204		130	BT50-RST-100	RBH160A	BST	195	100	95	13.3	510877
BT50-RBH160A-245	2	160-204	130	BT50-RST-150	RBH160A	BST	245	150	95	13.8	510878	13.8
BT50-RBH160A-295		160-204		130	BT50-RST-200	RBH160A	BST	295	200	95	14.3	510879
BT50-RBH160A-345	2	160-204	130	BT50-RST-250	RBH160A	BST	345	250	95	16.3	510880	16.3
BT50-RBH160A-395		160-204		130	BT50-RST-300	RBH160A	BST	395	300	95	18.3	510881
BT50-RBH160A-445	2	160-204	130	BT50-RST-350	RBH160A	BST	445	350	95	20.3	510882	20.3
BT50-RBH160A-495		160-204		130	BT50-RST-400	RBH160A	BST	495	400	95	22.3	510883

Features

1. Thickened cartridge with higher rigidity .
2. Coolant nozzle easily cools the insert elongating its working life .
3. Completed with chip pocket , improving chip flow of deep boring .
4. Clamp plate solidifies cartridges and head , upgrading cutting rigidity .
5. Patented step boring design ; suitable for both level boring and step boring .

Boring Cutter System

RBH Indexable Twin-bit Rough Boring Head 《Boring Range fromφ200-φ454mm》

Features

1. The head is suitable for single bit boring , twin-bit boring and step boring with working diameter from φ200mm to φ454mm on diameter.
2. New cartridge style with built-up rib . The pressure imposed on both cartridges counteracts producing highest rigidity and cutting efficiency, most suitable for a variety of borings .
3. Boring head can be easily adjusted to different boring needs for machining on demand . Boring depth can be extended by tool connection .
4. Clear side division provides a convenient adjustment without using a tool pre-setter .
5. Most suitable for boring on various machine centers or boring mills . Universal design accepts inserts of any brands , which will reduce tool grinding and greatly improve boring performance .
6. Patented step boring design; suitable for both level boring and step boring .
7. Boring heads over φ200mm feature directmodule , simple structure and high rigidity with adjustment range 50mm on diameter.

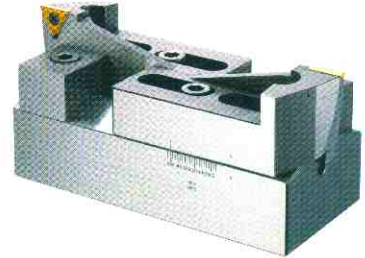

Specifications

	Boring Head Type	LBK No .	φDmm Boring Range	mm Length	Insert	kg Weight	Order Number	(RMB) Price
	RBH200-254-C	BST series	φ200-254	95	CCMT1 20408	6.5	510901	
	RBH200-254-T				TCMT220408		510902	
	RBH200-254-S				SCMT120404		510903	
	RBH250-304-C				CCMT120408	8.3	510904	
	RBH250-304-T				TCMT220408		510905	
	RBH250-304-S				SCMT1 20404		510906	
	RBH300-354-C		CCMT1 20408		10	510907		
	RBH300-354-T		TCMT220408			510908		
	RBH300-354-S		SCMT120404			510909		
	RBH350-404-C		CCMT120408		11.7	510910		
	RBH350-404-T		TCMT220408			510911		
	RBH350-404-S		SCMT1 20404			510912		
	RBH400-454-C		CCMT1 20408		13.4	510913		
	RBH400-454-T		TCMT220408			510914		
	RBH400-454-S		SCMT120404			510915		

RBH Indexable Twin-bit Rough Boring Head for Large Hole Boring+BST Shank(MAS 403BT)

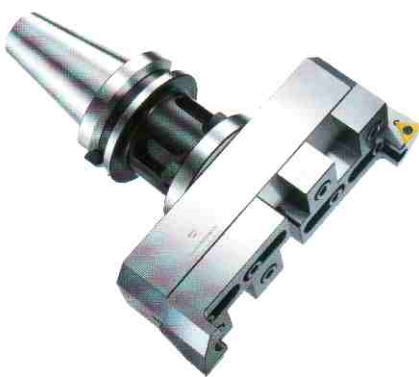

Specifications

Tape	φ(φEE)	Z	Tool Connection		LBK No	L	L1	D1	KG	Order Number	Price
			φDmm Boring Range	mm Length							
BT50-RBH200-195	φ200-254	150	BT50-BST-100	RBH200	BST	195	100	95	1.16	510916	
BT50-RBH200-245		200	BT50-BST-150			245	150		13.3	510917	
BT50-RBH200-295		250	BT50-BST-200			295	200		16.0	510918	
BT50-RBH200-345		300	BT50-BST-250			345	250		18.0	510919	
BT50-RBH200-395		350	BT50-BST-300			395	300		20.0	510920	
BT50-RBH200-445		400	BT50-BST-350			445	350		22.0	510921	
BT50-RBH250-195	φ250-304	150	BT50-BST-100	RBH250	BST	195	100	95	13.4	510923	
BT50-RBH250-245		200	BT50-BST-150			245	150		15.1	510924	
BT50-RBH250-295		250	BT50-BST-200			295	200		17.8	510925	
BT50-RBH250-345		300	BT50-BST-250			345	250		19.8	510926	
BT50-RBH250-395		350	BT50-BST-300			395	300		21.8	510927	
BT50-RBH250-445		400	BT50-BST-350			445	350		23.8	510928	
BT50-RBH300-195	φ300-354	150	BT50-BST-100	RBH300	BST	195	100	95	15.1	510930	
BT50-RBH300-245		200	BT50-BST-150			245	150		16.8	510931	
BT50-RBH300-295		250	BT50-BST-200			295	200		19.5	510932	
BT50-RBH300-345		300	BT50-BST-250			345	250		21.5	510933	
BT50-RBH300-395		350	BT50-BST-300			395	300		23.5	510934	
BT50-RBH300-445		400	BT50-BST-350			445	350		25.5	510935	
BT50-RBH350-195	φ350-404	150	BT50-BST-100	RBH350	BST	195	100	95	16.8	510937	
BT50-RBH350-245		200	BT50-BST-150			245	150		18.5	510938	
BT50-RBH350-295		250	BT50-BST-200			295	200		21.2	510939	
BT50-RBH350-345		300	BT50-BST-250			345	250		23.2	510940	
BT50-RBH350-395		350	BT50-BST-300			395	300		25.2	510941	
BT50-RBH350-445		400	BT50-BST-350			445	350		27.2	510942	
BT50-RBH400-195	φ400-554	150	BT50-BST-100	RBH400	BST	195	100	95	18.5	510944	
BT50-RBH400-245		200	BT50-BST-150			245	150		20.2	510945	
BT50-RBH400-295		250	BT50-BST-200			295	200		22.9	510946	
BT50-RBH400-345		300	BT50-BST-250			345	250		24.9	510947	
BT50-RBH400-395		350	BT50-BST-300			395	300		26.9	510948	
BT50-RBH400-445		400	BT50-BST-350			445	350		28.9	510949	
BT50-RBH400-495	450	BT50-BST-400	495	400	30.9	510950					

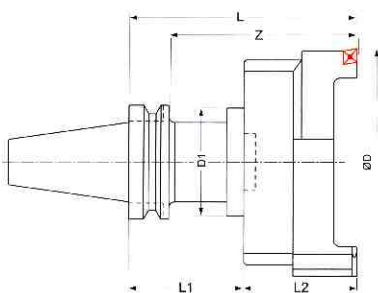

RBH Boring Cutter System

RBH-A Large Diameter Modular Rough Boring Head with Diameter over $\phi 200\text{mm}$

Specifications



Features

1. This type is suitable for large diameter boring with ranges from $\phi 200\text{mm}$ to $\phi 1250\text{mm}$.
2. The structure includes common flange and extension slide for both rough and finish boring heads. Available can be optional accessories for different works. Adjustment range is within 110mm on diameter. The adjustment range for both 600A and 900A is 350mm.
3. Options of various inserts for rough boring of different materials and boring styles.
4. Available is the horizontal slide made of Aluminum alloy to reduce total weight.
5. Options of external boring kit with boring range from $\phi 20\text{mm}$ to $\phi 300\text{mm}$.

Boring Head Type	Type		RBH 200A	RBH 300A	RBH 400A	RBH 500A	RBH 600A	RBH 900A	
	Length(mm)		130	130	130	130	150	150	
Total Weight(kg)	Alloy Steel	9.5	11.5	13.5	15.5	33	43		
	Aluminum Alloy	7.2	8.0	8.8	9.6	16.0	20.7		
D(mm)Boring Diameter		$\phi 200 \sim \phi 310$	$\phi 300 \sim \phi 410$	$\phi 400 \sim \phi 510$	$\phi 500 \sim \phi 610$	$\phi 600 \sim \phi 950$	$\phi 900 \sim \phi 1250$		
Taper Shank		BT50-BST/NT50-BST Series					BT50-FMA-47.625		
Flange		BR200					BR600	BR900	
Weight (kg)	Alloy Steel	Alloy Steel					2.7kg	19	29
	Aluminum Alloy							8.8	13.5
Extension Slide		RST200	RST300	RST400	RST500	RST300X2只(pieces)			
	Weight (kg)	3.4	5.4	7.4	9.4	10.8			
Clamp Base		RS200							
	Weight (kg)	0.98kg							
Height Setting Shim		RS201							
	Weight (kg)	0.05kg							
Insert Holder		RB200C12	RB200T16	RB200T22	RB200S12				
Applicable Insert		CCMT120404	TCMT16T304	TCMT220404	SCMT120404				
	Weight (kg)	0.68kg							

RBH-A Indexable Twin-bit Rough Boring Head for Large Hole Boring+ BST Shank(MAS 403BT)

《Boring Range from $\phi 200 \sim \phi 1250\text{mm}$ 》

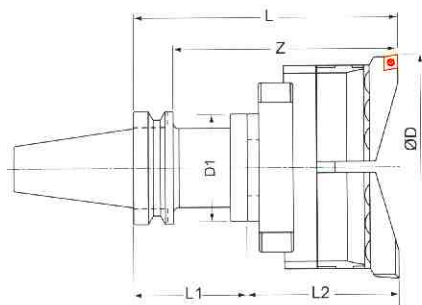

Boring Head Type	LBK No.	ϕ Dmm Boring Range	mm Length	Insert	KG		Order Number	Price
					Alloy Steel	Aluminum Alloy		
RBH200-310LA	BST series	200~310	130	(选配刀片座) Optional Inserts CCMT16T304 TCMT16T304 TCMT220408 SCMT120404	9.5	7.2	510680	8864
RBH300-410LA		300~410			11.5	8.0	510682	10098
RBH400-510LA		400~510			13.5	8.8	510684	12922
RBH500-610LA		500~610			15.5	9.6	510686	15348
RBH600-950LA	FMA-47.625	600~950	150	TCMT220408 SCMT120404	33.0	16.0	510688	16961
RBH900-1250LA	900~1250	43.0			20.7	510690	24231	

Tape	ϕ (Dmm)	Z	Tool Connection		LBK No	L	L1	D1	KG	
			Tool Connection	Tool Connection					Alloy Steel	Aluminum Alloy
BT50-RBH200A-230	$\phi 200 \sim \phi 310$	185	BT50-BST-100	RBH200A	BST	230	100	95	14.6	12.3
BT50-RBH200A-280		235	BT50-BST-150			280	150		16.3	14
BT50-RBH200A-330		285	BT50-BST-200			330	200		19	16.7
BT50-RBH200A-380		335	BT50-BST-250			380	250		21	18.7
BT50-RBH200A-430		385	BT50-BST-300			430	300		23	20.7
BT50-RBH200A-480		435	BT50-BST-350			480	350		25	22.7
BT50-RBH200A-530		485	BT50-BST-400			530	400		27	24.7
BT50-RBH300A-230		185	BT50-BST-100			230	100		16.6	13.1
BT50-RBH300A-280		235	BT50-BST-150			280	150		18.3	14.8
BT50-RBH300A-330		285	BT50-BST-200			330	200		21	17.5
BT50-RBH300A-380	335	BT50-BST-250	380	250	23	19.5				
BT50-RBH300A-430	385	BT50-BST-300	430	300	25	21.5				
BT50-RBH300A-480	435	BT50-BST-350	480	350	27	23.5				
BT50-RBH300A-530	485	BT50-BST-400	530	400	29	25.5				
BT50-RBH400A-230	185	BT50-BST-100	230	100	18.6	13.9				
BT50-RBH400A-280	235	BT50-BST-150	280	150	20.3	15.6				
BT50-RBH400A-330	285	BT50-BST-200	330	200	23	18.3				
BT50-RBH400A-380	335	BT50-BST-250	380	250	25	20.3				
BT50-RBH400A-430	385	BT50-BST-300	430	300	27	22.3				
BT50-RBH400A-480	435	BT50-BST-350	480	350	29	24.3				
BT50-RBH400A-530	485	BT50-BST-400	530	400	31	26.3				
BT50-RBH500A-230	185	BT50-BST-100	230	100	20.6	14.7				
BT50-RBH500A-280	235	BT50-BST-150	280	150	22.3	16.4				
BT50-RBH500A-330	285	BT50-BST-200	330	200	25	19.1				
BT50-RBH500A-380	335	BT50-BST-250	380	250	27	21.1				
BT50-RBH500A-430	385	BT50-BST-300	430	300	29	23.1				
BT50-RBH500A-480	435	BT50-BST-350	480	350	31	25.1				
BT50-RBH500A-530	485	BT50-BST-400	530	400	33	27.1				
BT50-RBH600A-230	600~950	185	BT50-FMA47.625-75	RBH600A	FMA 47.625	230	75	128	40	23
BT50-RBH900A-230	900~1250		RBH900A			50	27.7			

CBH Finish Boring Head 《Boring Range fromφ20-φ202mm》

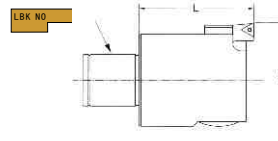

Features

- 1, CBH fine knife is suitable for fine cutting hole, the working range of phi 20- phi 202mm can be used with.
- 2, adjust the scale of the circumference of the 50 equal, each grid to adjust the size of the bit diameter of 0.01mm, and the other side can be more precise adjustment.
- 3, precision lead screw is located in the interior, free from chip, wear, rust and other effects, with internal lubrication, precision and durable.
- 4, built-in water hole, knife tip cooling, blade life.
- 5, adjust the expansion part for the square structure, double support surface is fixed, so the cutting is stable and rigid.

Boring Head Type	LBK No .	φDmm Boring Range	Length	kg Weight	Insert / Clamping Screw / Wrench	Order Number	(RMB)Price
CBH20	LBK1	20-26	35	0.1	TB06/M2/T6	511100	3483
CBH25	LBK2	25-33	40	0.2		TP08/M2.2/T7	511102
CBH32	LBK3	32-42		0.3	TC09/M2.2/T7		511104
CBH40	LBK4	40-55	50	0.5		TP08/M2.2/T7	511106
CBH52	LBK5	52-75	60	1	TP09/M2.5/T8		511108
CBH68		68-102		2		511110	6675
CBH100	LBK6	100-152	72	2.9	TC11/M2.5/T8	511112	7368
CBH150		150-202		4.2		511114	10920

CBH Finish Boring Head+LBK Shank (MAS 403BT)

Specifications

▲ IBT is the improved type dedicated to resonance in boring

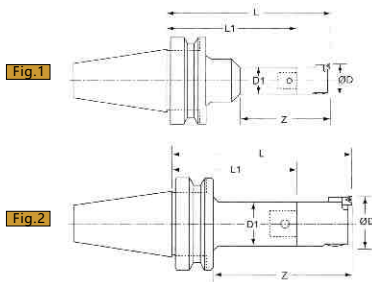

Tape	Fig.	φ (D)	Z	Tool		LBK No	L	L1	D1	KG	Order Number	(RMB) Price						
				LBK shank	Connection CBH boring head													
BT30-CBH20-105	2	20-26	75	BT30-LBK1-70	CBH20	1	105	70	19	0.6	511200							
BT30-CBH25-120		25-33	90	BT30-LBK2-80	CBH25	2	120	80	24	0.8	511202							
BT30-CBH32-120		32-42		BT30-LBK3-80	CBH32	3		31	1.0	511204								
BT30-CBH40-120		40-55	BT30-LBK4-70	CBH40	4	70	1.3	511206										
BT30-CBH52-120		52-75	BT30-LBK5-60	CBH52	5	50	1.8	511208										
BT30-CBH68-130	2	68-102	100	BT30-LBK6-60	CBH68	6	130	60	64	3.0	511210							
BT40-CBH20-110		20-26	75	BT40-LBK1-75	CBH20	1	110	75	19	1.1	511212							
BT40-CBH20-140		25-33	105	BT40-LBK1-105	CBH25	2	140	105	24	1.3	511214							
BT40-CBH25-125			90	BT40-LBK2-85								125	85	1.5	511216			
BT40-CBH25-155		32-42	120	BT40-LBK2-115	CBH32	3	165	125	31	1.8	511222							
BT40-CBH32-135	100		BT40-LBK3-95	135								95	2.0	511224				
BT40-CBH32-165	130		BT40-LBK3-125	165								125	1.8	511222				
BT40-CBH32-195	40-55	160	BT40-LBK3-155	CBH40	4	225	175	39	2.7	511230								
BT40-CBH40-135		100	BT40-LBK4-85								135	85	1.8	511226				
BT40-CBH40-180		145	BT40-LBK4-130								180	130	2.4	511228				
BT40-CBH40-225	2	190	BT40-LBK4-175	CBH52	5	225	175	50	3.3	511234								
BT40-CBH52-135		100	BT40-LBK5-75								135	75	2.3	511232				
BT40-CBH52-185		150	BT40-LBK5-125								185	125	3.0	511236				
BT40-CBH52-235		200	BT40-LBK5-175								235	175	4.0	511238				
BT40-CBH68-135		100	BT40-LBK6-65								135	65	3.3	511238				
BT40-CBH68-185	68-102	150	BT40-LBK6-115	CBH68	6	185	115	64	4.2	511240								
BT40-CBH68-235		200	BT40-LBK6-165								235	165	5.9	511242				
BT40-CBH100-135		100	BT40-LBK6-65								135	65	4.2	511244				
BT40-CBH100-235	100-152	150	BT40-LBK6-115	CBH100	6	235	165	64	5.6	511246								
BT40-CBH150-135		100	BT40-LBK6-65								135	65	6.8	511248				
BT40-CBH150-185		150	BT40-LBK6-115								185	115	5.5	511250				
BT40-CBH150-235	150-202	200	BT40-LBK6-165	CBH150	6	235	165	64	6.9	511252								
BT50-CBH20-150		20-26	75								BT50-LBK1-115	CBH20	1	150	115	4.1	511256	
BT50-CBH20-180		25-33	105								BT50-LBK1-145	CBH25	2	180	145	24	4.2	511258
BT50-CBH25-150	105		BT50-LBK2-110	150	110	4.1	511260											
BT50-CBH25-180	32-42	135	BT50-LBK2-140	CBH32	3	195	155	31	4.5	511262								
BT50-CBH32-165		120	BT50-LBK3-125								165	125	4.4	511264				
BT50-CBH32-195		150	BT50-LBK3-155								195	155	4.5	511266				
BT50-CBH40-165	40-55	120	BT50-LBK4-115	CBH40	4	165	115	39	4.8	511268								
BT50-CBH40-195		150	BT50-LBK4-145								195	145	4.9	511270				
BT50-CBH40-225		180	BT50-LBK4-175								225	175	5.3	511272				
BT50-CBH40-255	2	210	BT50-LBK4-205	CBH52	5	225	205	50	5.4	511274								
BT50-CBH52-165		120	BT50-LBK5-105								165	105	5.5	511276				
BT50-CBH52-240		195	BT50-LBK5-180								240	180	6.5	511278				
BT50-CBH52-300		255	BT50-LBK5-240								300	240	7.2	511280				
BT50-CBH52-360		255	BT50-LBK5-300								360	300	8.6	511282				
BT50-CBH68-165	68-102	120	BT50-LBK6-95	CBH68	6	165	95	64	6.5	511284								
BT50-CBH68-240		195	BT50-LBK6-170								240	170	8.3	511286				
BT50-CBH68-300		255	BT50-LBK6-230								300	230	9.6	511288				
BT50-CBH68-360	1	315	BT50-LBK6-290	CBH100	6	360	290	90/64	11.0	511290								
BT50-CBH68-420		375	BT50-LBK6-350								420	350	15.5	511292				
IBT50-CBH68-420		375	IBT50-LBK6-350								420	350	13.2	511294				
BT50-CBH100-165	2	120	BT50-LBK6-95	CBH100	6	165	95	64	7.4	511296								
BT50-CBH100-240		195	BT50-LBK6-170								240	170	9.2	511298				
BT50-CBH100-300		255	BT50-LBK6-230								300	230	10.5	511300				
BT50-CBH100-360	1	315	BT50-LBK6-290	CBH150	6	360	290	90/64	11.9	511302								
BT50-CBH100-420		375	BT50-LBK6-350								420	350	16.4	511304				
IBT50-CBH100-420		375	IBT50-LBK6-350								420	350	14.1	511306				
BT50-CBH150-165	2	120	BT50-LBK6-95	CBH150	6	165	95	64	8.7	511308								
BT50-CBH150-240		195	BT50-LBK6-170								240	170	10.5	511310				
BT50-CBH150-300		255	BT50-LBK6-230								300	230	11.8	511312				
BT50-CBH150-360	1	315	BT50-LBK6-290	CBH150	6	360	290	90/64	13.2	511314								
BT50-CBH150-420		375	BT50-LBK6-350								420	350	17.7	511316				
IBT50-CBH150-420		375	IBT50-LBK6-350								420	350	15.4	511318				

CBH Boring Cutter System

CBH Large Diameter Modular Finish Boring Head with Diameter over φ200mm

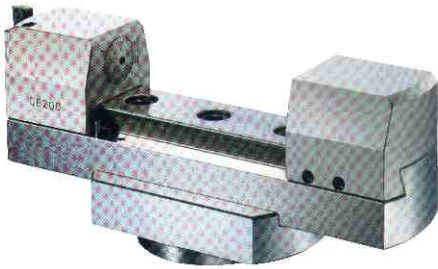

Features

1. This type is suitable for large diameter boring with ranges from φ200mm to φ1250mm .
2. The structure includes common flange and extension slide for both rough and finish boring heads . Available can be optional accessories for different works .
Adjustment range is within 110mm on diameter .
The adjustment range for bother CBH600 and CBH900 is 350mm .
3. Available is the horizontal slide made of Aluminum alloy to reduce total weight.

Type		CBH200	CBH300	CBH400	CBH500	CBH600	CBH900	
Boring Head Type	Length(mm)	130	130	130	130	150	150	
	Total Weight(kg)	Alloy Steel	9.7	11.7	13.7	15.7	33	43
		Aluminum Alloy	7	7.8	8.6	9.4	15.8	20.5
D(mm)Boring Diameter		200-310	300-410	400-510	500-610	600-950	900-1250	
Taper Shank		BT50-BST/NT50-BST Series				BT50-FMA-47.625		
Flange		BR200				BR600	BR900	
		Alloy Steel 2.7kg				19	29	
Weight	Aluminum Alloy					8.8	13.5	
	Extension Slide	RST200	RST300	RST400	RST500	RST300X2R(pieces)		
Weight	Alloy Steel	3.4	5.4	7.4	9.4	10.8		
	Aluminum Alloy	1.1	1.9	2.7	3.5	3.8		
Balance Weight		RBN200						
		1.6kg						
Finish Head		CB200						
		1.6kg						
Applicable Insert		TP08/M2.2/T7, TP09/M2.5/T8, TC11/M2.5/T8						

CBH Large Diameter Modular Finish Boring Head+BST Shank(MAS 403BT)

《Boring Range fromφ200-φ1250mm》

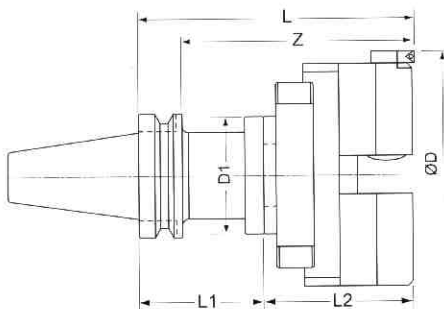
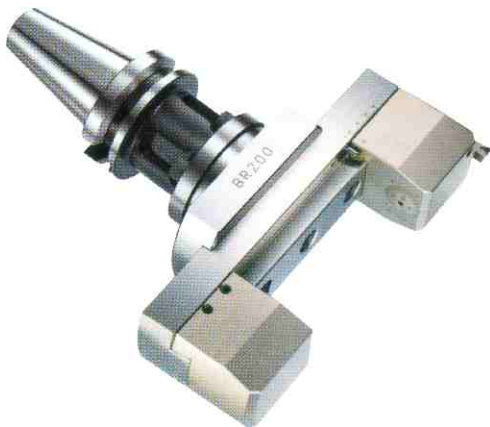

Type	Boring Head Type	LBK No .	φDmm Boring Range	L2 mm	Insert/ Clamp Screw / Wrench	KG		Order Number	Price
						Alloy Steel	Aluminum Alloy		
	CBH200	BST series	200-310	130	TP08/M2.2/T7 TP09/M2.8/T8 TC11/M2.5/T8	9.7	7.0	510691	16800
	CBH300		300-410			11.7	7.8	510692	20423
	CBH400		400-510			13.7	8.6	510693	26135
	CBH500	500-610	15.7			9.4	510694	28560	
	CBH600	FMA-47.625	600-950			33.0	15.8	510695	35700
	CBH900		900-1250			43.0	20.5	510696	

Type	φ (Dmm)	Z	Tool Connection		LBK No	L	L1	D1	KG	
			LBK hank	CBH boring end					Alloy Steel	Aluminum Alloy
BT50-CBH200-230	200-310	185	BT50-BST-100	CBH200	BST	230	100	95	14.8	12.1
BT50-CBH200-280		235	BT50-BST-150			280	150		16.5	13.8
BT50-CBH200-330		285	BT50-BST-200			330	200		19.2	16.5
BT50-CBH200-380		335	BT50-BST-250			380	250		21.2	18.5
BT50-CBH200-430		385	BT50-BST-300			430	300		23.2	20.5
BT50-CBH200-480		435	BT50-BST-350			480	350		25.2	22.5
BT50-CBH200-530		485	BT50-BST-400			530	400		27.2	24.5
BT50-CBH300-230		185	BT50-BST-100			230	100		16.8	12.9
BT50-CBH300-280		235	BT50-BST-150			280	150		18.5	14.6
BT50-CBH300-330		285	BT50-BST-200			330	200		21.2	17.3
BT50-CBH300-380	335	BT50-BST-250	380	250	23.2	19.3				
BT50-CBH300-430	385	BT50-BST-300	430	300	25.2	21.3				
BT50-CBH300-480	435	BT50-BST-350	480	350	27.2	23.3				
BT50-CBH300-530	485	BT50-BST-400	530	400	29.2	25.3				
BT50-CBH400-230	185	BT50-BST-100	230	100	18.8	13.7				
BT50-CBH400-280	235	BT50-BST-150	280	150	20.5	15.4				
BT50-CBH400-330	285	BT50-BST-200	330	200	23.2	18.1				
BT50-CBH400-380	335	BT50-BST-250	380	250	25.2	20.1				
BT50-CBH400-430	385	BT50-BST-300	430	300	27.2	22.1				
BT50-CBH400-480	435	BT50-BST-350	480	350	29.2	24.1				
BT50-CBH400-530	485	BT50-BST-400	530	400	31.5	26.1				
BT50-CBH500-230	185	BT50-BST-100	230	100	20.8	14.5				
BT50-CBH500-280	235	BT50-BST-150	280	150	22.5	16.2				
BT50-CBH500-330	285	BT50-BST-200	330	200	25.2	18.9				
BT50-CBH500-380	335	BT50-BST-250	380	250	27.2	20.9				
BT50-CBH500-430	385	BT50-BST-300	430	300	29.2	22.9				
BT50-CBH500-480	435	BT50-BST-350	480	350	31.2	24.9				
BT50-CBH500-530	485	BT50-BST-400	530	400	33.2	26.9				
BT50-CBH600-230	600-950	185	BT50-FMA47.625-75	CBH600	FMA 47.625	230	75	128	40.0	22.8
BT50-CBH900-230	900-1250			CBH900					50.0	27.5

Boring Cutter System

CBR Large Diameter Modular Finish Boring Head with Diameter over $\Phi 200\text{mm}$ (Boring Range from $\Phi 10\sim\Phi 850\text{mm}$)

Specifications

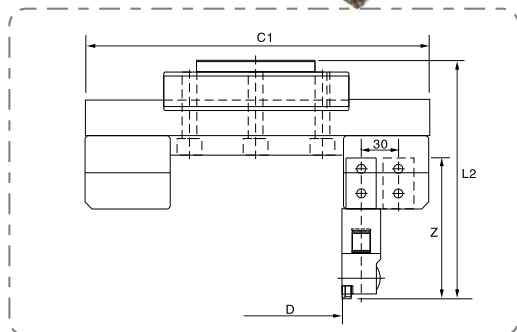

Boring Head Type	Type	CBR200	CBR300	CBR400	CBR500	CBR600	CBR900
	L2(mm)	190/220					
Z(mm)	115/145						
Total Weight(kg)	Alloy Steel	9.7	11.5	13.5	15.5	33	47
	Aluminum Alloy	7	8	8.8	9.6	16	22.3
D(mm)Boring Diameter		10 - 150	10 - 250	10 - 350	10 - 450	10 - 550	10 - 850
Taper Shank		BT50-BST-100L				BT50-FMA-47.625	
Flange		BR200				BR600	BR900
Weight	Alloy Steel	Alloy Steel 2.7kg				19	29
	Aluminum Alloy					8.8	13.5
Extension Slide		RST200	RST300	RST400	RST500	RST300X2枚 (pieces)	RST400X2枚 (pieces)
Weight	Alloy Steel	3.4	5.4	7.4	9.4	10.8	14.8
	Aluminum Alloy	1.1	1.9	2.7	3.5	3.8	5.4
Balance Weight		RBN200					
Weight		1.6kg					
Clamp Base		CB200					
Weight		1.3kg					
Adapter for External Boring		C25-LBK3-30			C25-LBK3-60		
Weight		0.3			0.5		
Applicable Boring Heads		WBH32					

WBST Tool Rest

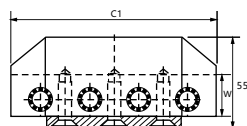

Tape	LBK NO	External Diameter(mm)	Length(mm)	C1 (mm)	W (mm)	Weight
WBST150	BST	150-250	55	125	25	2.5
W		200-300		175		3.6
W		300-400		275		6.0
W		400-500		375		8.3

Square Shank Boring Tool holder for WBST Tool Rest

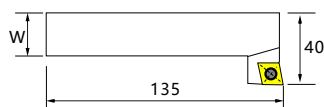

Tape	□W(mm)	Length(mm)	Insert	Clamp screw	Weight
BSB25-T16-135	25	135	TCMT16...	M4	0.67
			TCMT22...	M5	
			CCMT12...	M5	
			SCMT12...	M5	

Square Shank External Boring Tool holder for WBST Tool Rest

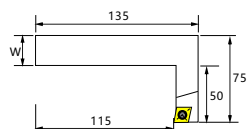

Tape	□W(mm)	Length(mm)	A (mm)	Insert	Clamp screw	Weight
EBSB25-T16-135-50	25	135	40	TCMT16T304	M4	0.8
EBSB25-C12-135-50				CCMT120404	M5	

Internal & External Square Shank Finish Boring Tool holder for WBST Tool Rest

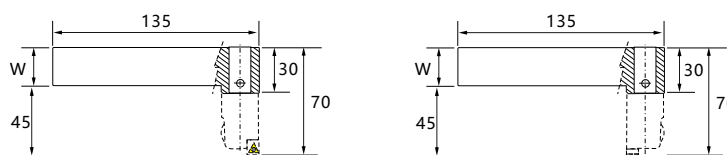
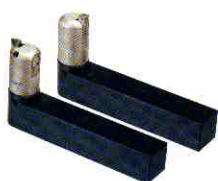

Tape	W (mm)	Length(mm)	(mm)	Applicable Boring Heads	Insert	Clamp screw	Weight
BSB25-LBK2-135	25	135	36	WBH25	TP08	M2.2	0.63

*Boring heads is not included

Small Diameter Finish Boring Head Type CBI 《Boring Range fromφ3-φ40mm》

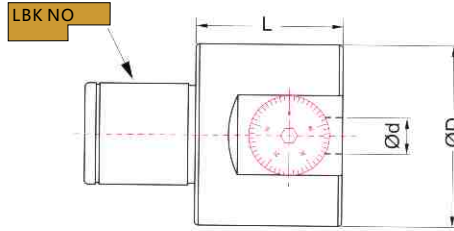

Features

1. Available are three different styles enabling small diameter boring from φ8mm to φ40mm. Boring range can be within φ3mm to φ10mm if small diameter solid carbide boring bar has been employed.
2. The dial has been graduated into 50 divisions, each of which is 0.01mm on diameter. Available is a sub-dial for finer adjustment.
3. High precision internal lead screw with inner lubrication is free from the effects of chip, featuring high durability.

Boring Head Type	LBK No.	φDmm Internal Diameter	φDmm External Diameter	Length	Feed	kg Weight
CBI 4	LBK 4	10	36	32	0-2.0	0.4
CBI 5	LBK 5	12	50	40	0-3.5	0.8
CBI 6	LBK 6	16	64	50	0-5.0	1.4

CBI Small Diameter Finish Boring Head +LBK Shank(MAS 403BT)

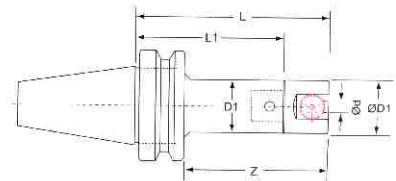

CBI Small Diameter Finish Boring

Tape	F mm	Z	Tool Connection		LBK No	L	L1	D1	d mm	KG
			BT30-LBK4-070	BT30-LBK5-060						
BT30-CBI4-100	0-2.0	70	BT30-LBK4-070	CBI4	4	100	70	39	10	1.2
BT30-CBI5-100	0-3.5	70	BT30-LBK5-060	CBI5	5	100	60	50	12	1.6
BT30-CBI6-110	0-5.0	80	BT30-LBK6-060	CBI6	6	110	60	64	16	2.4
BT40-CBI4-115	0-2.0	75	BT40-LBK4-085	CBI4	4	115	85	39	10	1.7
BT40-CBI5-115	0-3.5	75	BT40-LBK5-075	CBI5	5	115	75	50	12	2.1
BT40-CBI6-115	0-5.0	75	BT40-LBK6-065	CBI6	6	115	65	64	16	2.7
BT50-CBI4-145	0-2.0	95	BT50-LBK4-115	CBI4	4	145	115	39	10	4.7
BT50-CBI5-145	0-3.5	95	BT50-LBK5-105	CBI5	5	145	105	50	12	5.3
BT50-CBI6-145	0-5.0	95	BT50-LBK6-095	CBI6	6	145	95	64	16	5.9

CBI Small Diameter Finish Boring Head +LBK Shank(MAS 403BT) +Tool Extension Type BJ

Tape	F mm	Z	Tool Connection			LBK No	L	L1	D1	KG
			BT30-LBK4-070	CBI	Bar					
BT30-CBI4-BJ10-5PCS	0-2.0	70	BT30-LBK4-070	CBI4	BJ10-5PCS	4	100	70	39	1.9
BT30-CBI5-BJ12-5PCS	0-3.5	70	BT30-LBK5-060	CBI5	BJ12-5PCS	5	100	60	50	2.3
BT30-CBI6-BJ16-8PCS	0-5.0	80	BT30-LBK6-060	CBI6	BJ16-8PCS	6	110	60	64	4.6
BT40-CBI4-BJ10-5PCS	0-2.0	75	BT40-LBK4-085	CBI4	BJ10-5PCS	4	115	85	39	2.4
BT40-CBI5-BJ12-5PCS	0-3.5	75	BT40-LBK5-075	CBI5	BJ12-5PCS	5	115	75	50	2.8
BT40-CBI6-BJ16-8PCS	0-5.0	75	BT40-LBK6-065	CBI6	BJ16-8PCS	6	115	65	64	4.9
BT50-CBI4-BJ10-5PCS	0-2.0	95	BT50-LBK4-115	CBI4	BJ10-5PCS	4	145	115	39	5.4
BT50-CBI5-BJ12-5PCS	0-3.5	95	BT50-LBK5-105	CBI5	BJ12-5PCS	5	145	105	50	6.0
BT50-CBI6-BJ16-8PCS	0-5.0	95	BT50-LBK6-095	CBI6	BJ16-8PCS	6	145	95	64	8.1



Extension Adapter for Small Diameter Boring Bar Dedicated to CBI Series Type AC

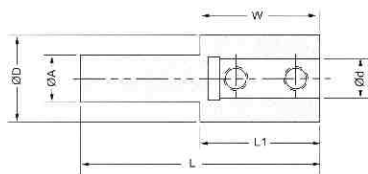

Type	φA(mm)	φDmm External Diameter	φDmm Internal Diameter	L1(mm)	W(mm)	L(mm)
AC1206-35	12	22	06	35	25	65
AC1210-35	12	22	10	35	30	65
AC1606-35	16	16	06	35	25	85
AC1610-35	16	22	10	35	30	85

Super Fine Diameter Trungsten Carbide Boring Bar Dedicated to CBI Series Type SBJ



Type	φD min	Boring Range φ max			φA(mm)	L1(mm)	L(mm)
		CBI4	CBI5	CBI6			
SBJ0603-15	3	3	10	13	6	15	50
SBJ0604-20	4	4	11	14	6	20	50
SBJ0605-25	5	5	12	15	6	25	60
SBJ0606-30	6	6	13	16	6	30	60
SBJ1008-35	8	8	15	18	10	35	75
SBJ1010-40	10	10	17	20	10	40	75



CBI4 《φ8-φ24mm》

Type	Fig	φD (mm)	φd (mm)	L (mm)	L2 (mm)	H (mm)	Insert	Clamp Screw	Wrench
BJ1008-32	1	10	8	64	32	9	TB..0601..	M2	T6
BJ1010-40			10	72	40				
BJ1012-45	2		12	77	27		TP..0902..	M2.5	T8
BJ1016-45			16	77	27				
BJ1020-45			20	77	27				
★ BJ10-5PCS			BJ1008-32 BJ1010-40 BJ1012-45 BJ1016-45 BJ1020-45						

CBI5 《φ8-φ27mm》

Type	Fig	φD (mm)	φd (mm)	L (mm)	L2 (mm)	H (mm)	Insert	Clamp Screw	Wrench
BJ1208-32	1	12	8	64	32	9	TB..0601..	M2	T6
BJ1210-40			10	72	40				
BJ1212-45	2		12	77	45		TP..0902..	M2.5	T8
BJ1216-45			16	77	22				
BJ1220-45			20	77	25				
★ BJ12-45PCS			BJ1208-32 BJ1210-40 BJ1212-45 BJ1216-45 BJ1220-45						

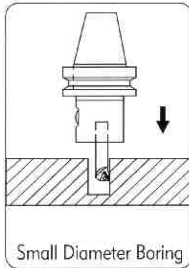

CBI6 《φ8-φ50mm》

Type	Fig	φD (mm)	φd (mm)	L (mm)	L2 (mm)	H (mm)	Insert	Clamp Screw	Wrench	
BJ1608-32	1	16	8	74	32	15	TB..0601..	M2	T6	
BJ1610-40			10	75	40					
BJ1612-53			2	12	85		53	TP..0902..	M2.5	T8
BJ1616-68				16	100		68			
BJ1620-83	20			115	83					
BJ1625-90	25			122	90					
BJ1630-90	2		30	122	90		TP..0902..	M3	T9	
BJ1640-90			40	122	90					
★ BJ16-8PCS	BJ1608-32 BJ1610-40 BJ1612-53 BJ1616-68 BJ1620-83 BJ1625-90 BJ1630-90 BJ1640-90									

Fig.1

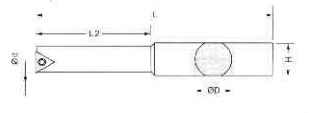
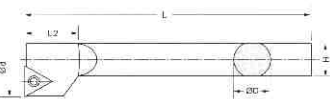

Fig.2



★ In Box Package

★ Note : outstretch of small diameter boring is better within 3 times of its diameter when in use .

TUNGSTEN CARBIDE COMPOSITE SMALL DIAMETER CUTTER ROD SPECIAL TYPE EC

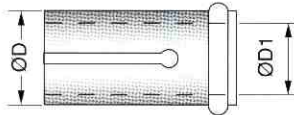

Type	D (mm)	D1 (mm)	Applicable Carbide Tool Holder
EC1608	16	8	ST08 . HC08
EC1610	16	10	ST10 . HC10
EC1612	16	12	ST12 . HC12
EC1614	16	14	STL4

TUNGSTEN CARBIDE COMBINATION TYPE SMALL DIAMETER ST TYPE

Type	L (mm)	D (mm)	M (mm)	Applicable Carbide Tool Holder	Applicable Bushing
ST08-W5-100L	100	8	M5	BE09A . BE10.5A	EC1608
ST10-W6-110L	110	10		BE12A	EC1610
ST12-W6-120L	120	12	M6	BE14A . BE16A	EC1612
ST14-W6-160L	160	14		BE16A	EC1614
ST16-W10-160L	160	16	M10	BE18A BE20A BE22A BE24A BE26A BE28A BE30A BE32A BE34A BE36A BE38A BE40A	---

HIGH SPEED TUNGSTEN COMPOSITE SMALL DIAMETER CUTTER ROD TYPE HC



Type	L (mm)	D (mm)	M (mm)	Applicable Carbide Tool Holder	Applicable Bushing
HC08-M5-075	75	8	M5	BE09A . BE10.5A	EC1608
HC10-M6-095	95	10	M6	BE12A	EC1610
HC12-M6-115	115	12	M6	BE14A . BE16A	EC1612
HC12-M10-130		16		BE18A BE20A BE22A BE24A BE26A BE28A BE30A BE32A BE34A BE36A BE38A BE40A	
HC16-M10-130	130	16	M10	BE18A BE20A BE22A BE24A BE26A BE28A BE30A BE32A BE34A BE36A BE38A BE40A	---

COMBINED BORING HEAD TYPE BE 《φ9-φ50mm》

Type	d (mm)	H (mm)	L (mm)	M (mm)	Insert	Clamp Screw	Wrench
BE09A	9	7	18	M5	TP..0802..	M2.2	T7
BE10.5A	10.5						
BE12A	12						
BE14A	14	10	M6				
BE16A	16						
BE18A	18	14	27	M10			
BE20A	20						
BE22A	22						
BE24A	24						
BE26A	26						
BE28A	28						
BE30A	30						
BE32A	32						
BE34A	34						
BE36A	36						
BE38A	38						
BE40A	40						

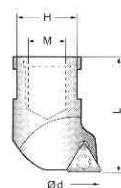

Super Hard Solid Tungsten Carbide Boring Bar «Boring Range from $\phi 20$ - $\phi 75$ mm»

Features

- 1、 Super hard tungsten carbide boring bar made from high toughness compound is tough and durable , highly materializing features of super hardness , high rigidity and extra vibration resistance , most suitable for extra depth boring (10D) .
- 2、 Standard internal coolant hole is built in every size of the bar , best for cooling and chip evacuation in deep hole boring .
- 3、 Featuring straight shank structure , the bar can be adjusted to different working lengths .
- 4、 On both ends of main body integrated are soldering holes . One hole will be superseded by the other upon breaking . This will reduce your cost and greatly increase the value of boring bar .



Super Hard Solid Tungsten Carbide Boring Bar

Tape	Fig	ϕ Dmm Internal Dia.	ϕ Dmm External Dia.	L(mm)	Z(mm)	Applicable Boring Heads	Boring Range (mm)	KG
SC19-LBK1-150L	1	11	19	225	150	CBH20	20-26	0.8
SC19-LBK1-200L				275	200			1
SC24-LBK2-180L		14	24	260	180	CBH25	25-33	1.45
SC24-LBK2-240L				320	240			1.8
SC32-LBK3-240L	2	18	32	320	240	CBH32	33-42	2.8
SC32-LBK3-310L				390	310			3.5
SC32-LBK3/4-280L		18/22	32/39	365	280	CBH40	40-55	3.1
SC32-LBK3/4-350L				435	350			3.8
SC40-LBK4-310L	1	22	40	390	310	CBH52	52-75	5
SC40-LBK4-400L	2	22/28	40/50	480	400			6.5
SC40-LBK4/5-360L				445	360			5.6
SC40-LBK4/5-450L	535	450	7.1					

- * Boring head is not includea.
- * LBK3/4 and LBK4/5 are extensions with magnifying diameter.

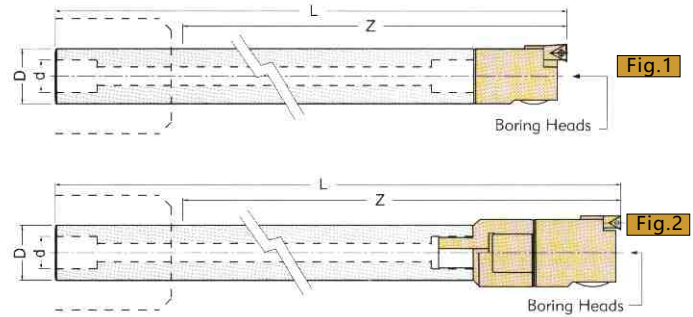
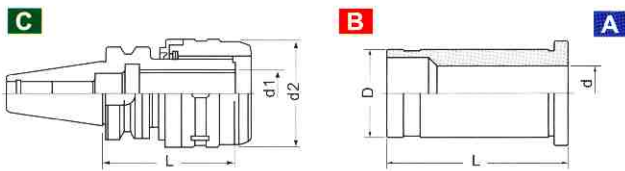

C32 Straight Shank Boring Bar

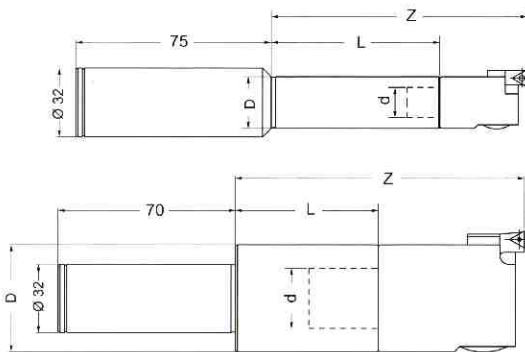

Specifications

Tape	ϕ Dmm Internal Dia.	ϕ Dmm External Dia.	L(mm)	Z(mm)	Applicable Boring Heads	KG
C32-LBK1-075L	11	19	75	110	CBH20	0.5
C32-LBK2-070L	14	24	70	110	RBH25 RBH25A CBH25	0.55
C32-LBK2-120L	14	24	120	160		0.8
C32-LBK3-070L	18	31	70	110	RBH32 RBH32A CBH32	0.65
C32-LBK3-120L	18	31	120	160		0.95
C32-LBK4-060L	22	39	60	110	RBH40 RBH40A CBH40 CBI 4	0.8
C32-LBK4-110L	22	39	110	160		1.2
C32-LBK5-060L	28	50	60	120	RBH52 RBH52A CBH52 CBI 5	1
C32-LBK5-120L	28	50	120	180		1.95
C32-LBK6-060L	36	64	60	130	RBH68 RBH90 RBH68A RBH90A CBH68 , 100 , 150 ; CBI 6	1.55
C32-LBK6-120L	36	64	120	190		2.9

- * Boring head is not includea.



NBH2084/NBJ16

NBH2084

NBH2084 FINE TUNING BORE SYSTEM (WHOLE SET)

Model explanation

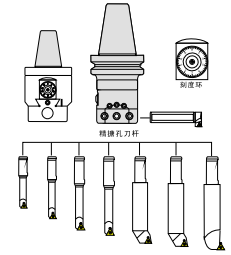
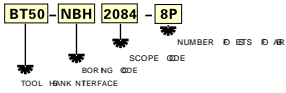

Cat. No	Boring Range	Spindle handle models	Head NO	Bar keep out	Weight (KG)	PRICE (RMB)
BT40-NBH2084-8P	8~280	BT40-NBH-50	NBH2084	NBH-20..	9.5	9100
BT50-NBH2084-8P	8~280	BT50-NBH-55		NBH-20..	12.0	9200
NT40-NBH2084-8P	8~280	NT40-NBH-50		NBH-20..	9.3	9100
NT50-NBH2084-8P	8~280	NT50-NBH-55		NBH-20..	10.8	9200
SK40-NBH2084-8P	8~280	SK40-NBH-50		NBH-20..	9.5	9100
SK50-NBH2084-8P	8~280	SK50-NBH-55		NBH-20..	12.0	9200
R8-NBH2084-8P	8~280	R8-NBH-50		NBH-20..	10.0	9000

Cat. No	Boring Range	Tuning precision	Stroke	Weight (KG)
NBH2084	Φ8~Φ280	Φ0.01mm/格	28.0mm	3.0

Cat. No	Boring Range	D	L1	L	Applicable inserts	Clamp screw	spanner	Weight (KG)	PRICE (RMB)
NBH-2008-32	8~11	20	32	80	TBGT0601..L	M2.0X5	T6	0.095	500
-2010-40	10~13		40	87				0.095	500
-2012-53	12~17		53	98	TPGH0902..L	M2.5X6	T8	0.12	500
-2016-68	16~21		68	110				0.16	500
-2020-83	20~130		83	123	TPGH1103..L	M3.0X7	T8	0.22	500
-2025-96	25~135		96	137				0.34	500
-2030-115	30~140		115	152				0.54	500
-2020-L	120~280		84+BTL1	100				0.23	500

NBJ16

NBJ16 FINE TUNING BORE SYSTEM (WHOLE SET)

Model explanation

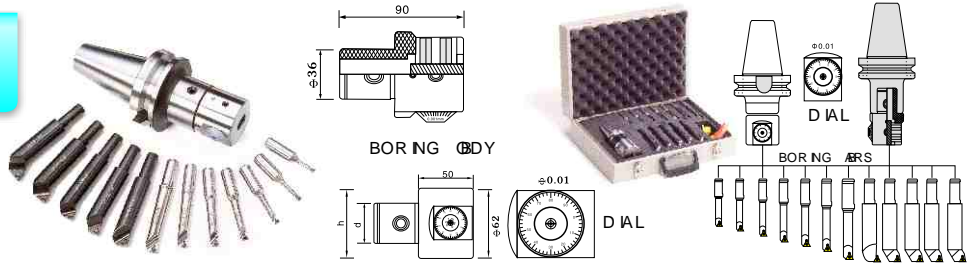
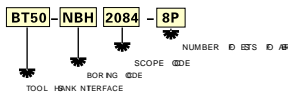

Cat. No	Boring Range	Spindle handle models	Head NO	Bar keep out	Weight (KG)	PRICE (RMB)
BT30-NBJ16-8P	8~50	BT30-CK6-55	NBJ16	NBJ-16..	8	10000
BT40-NBJ16-8P	8~50	BT40-CK6-55		NBJ-16..	9.1	10200
BT50-NBJ16-8P	8~50	BT50-CK6-65		NBJ-16..	11.7	10500
NT40-NBJ16-8P	8~50	NT40-CK6-55		NBJ-16..	8.5	10000
NT50-NBJ16-8P	8~50	NT50-CK6-65		NBJ-16..	10.3	10500
SK40-NBJ16-8P	8~50	SK40-CK6-55		NBJ-16..	8.9	10000
SK50-NBJ16-8P	8~50	SK50-CK6-65		NBJ-16..	10.5	10500

Cat. No	Boring Range	Tuning precision	Stroke	Weight (KG)
NBJ16	Φ8~Φ50	Each rig 0.01mm	6.0mm	1.2

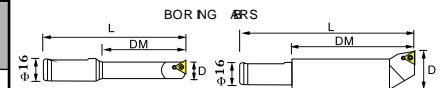

Cat. No	Boring Range	D	L1	L	Applicable inserts	Clamp screw	spanner	Weight (KG)	PRICE (RMB)
NBJ-1608-32	8~11	16	32	80	TBGT0601..L	M2X5	T6	0.077	500
NBJ-1610-40	10~13		40	87				0.082	500
NBJ-1612-53	12~15		53	98	TPGH0902..L	M2.5X6	T8	0.095	500
NBJ-1616-68	16~21		68	110				0.143	500
NBJ-1620-83	20~26		83	125	TPGH1103..L	M3.0X7	T8	0.203	500
NBJ-1625-90	25~31		90	128				0.275	500
NBJ-1630-90	30~41		90	128				0.275	500
NBJ-1640-90	40~51		90	128				0.286	500

Extension(Constant Diameter)

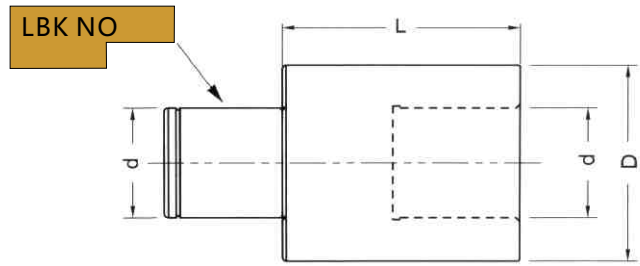

Tape	d mm	D mm	L mm	Applicable Boring Heads	KG	Order Number	Price
LBK1-1-30L	11	19	30	CBH20	0.07	512000	400
LBK2-2-30L	14	24	30	RBH25 CBH25	0.1	512002	400
LBK3-3-30L	18	31	30	RBHH32 CBH32	0.15	512004	400
LBK4-4-45L	22	39	45	RBH40 CBH40 CBI 4	0.4	512006	400
LBK5-5-60L	28	50	60	RBH52 CBH52 CBI 5	0.8	512008	400
LBK6-6-60L	36	64	60	RBH68/RBH90 CBH68,100,150 CBI 5	1.4	512010	400

Extension(Reducing)

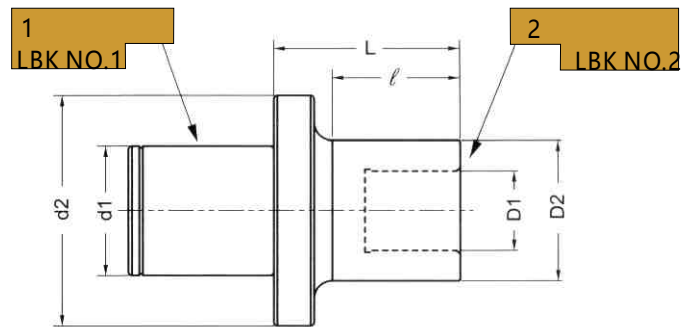

Tape	d1 mm	d2 mm	D1 mm	D2 mm	L mm	E mm	Applicable Boring Heads	KG	Order Number	Price
LBK2-1-36L	14	24			36	30	CBH20	0.1	512100	400
LBK3-1-41L					41	30	CBH20	0.15	512102	400
LBK3-2-37L	18	31	14	24	37	25	RBH25 ; CBH25	0.15	512104	400
LBK4-1-58L			11	19	58	40	CBH20	0.3	512106	400
LBK4-2-50L	22	39	14	24	50	36	RBH25 ; CBH25	0.3	512108	400
LBK4-3-50L			18	31	50	37	RBH32 ; CBH32	0.35	512110	40
LBK5-1-60L			11	19	60	40	CBH20	0.45	512112	400
LBK5-2-54L					54	35	RBH25 ; CBH25	0.45	512114	400
LBK5-2-74L			14	24	74	55	RBH25 ; CBH25	0.5	512116	400
LBK5-3-47L	28	50	18	31	47	29	RBH32 ; CBH32	0.5	512118	400
LBK5-3-72L					72	54	RBH32 ; CBH32	0.6	512120	400
LBK5-4-42L			22	39	42	25	RBH40 ; CBH40	0.5	512122	400
LBK5-4-67L					67	50	RBH40 ; CBH40	0.7	512124	400
LBK6-1-70L			11	19	70	40	CBH20	0.9	512126	500
LBK6-2-63L					63	45	RBH25 ; CBH25	0.7	512128	500
LBK6-2-93L			14	24	93	75	RBH25 ; CBH25	0.8	512130	500
LBK6-3-56L			18	31	56	39	RBH32 ; CBH32	0.75	512132	500
LBK6-3-96L	36	64			96	79	RBH32 ; CBH32	0.95	512134	500
LBK6-4-51L			22	39	51	35	RBH40 ; CBH40	0.85	512136	500
LBK6-4-101L					101	85	RBH40 ; CBH40	1.3	512138	500
LBK6-5-41L			28	52	41	25	RBH52 ; CBH52	0.85	512140	500
LBK6-5-91L					91	75	RBH52 ; CBH52	1.45	512142	500

Boring Cutter System

Taper Shank for Boring Heads Series BST, LBK

LBK Series



BST Series

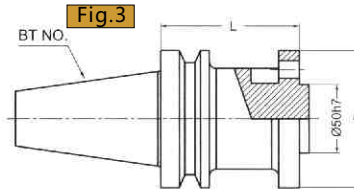
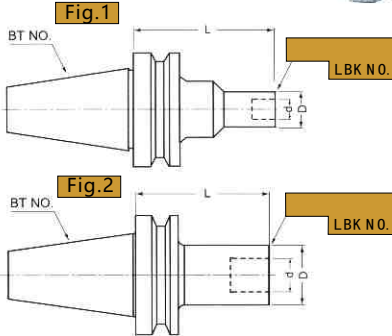

Tape	Fig.	L(mm)	φDmm External Dia.	Applicable Boring Heads	KG	Order Number	Price		
BT30-LBK1-070L	2	70	19	CBH20	0.5	512200	500		
BT30-LBK2-080L		80	24	RBH25 ; CBH25	0.6	512202	500		
BT30-LBK3-080L		80	31	RBHH32 ; CBH32	0.7	512204	500		
BT30-LBK4-070L		70	39	RBH40 ; CBH40 ; CBI4	0.8	512206	500		
BT30-LBK5-060L		60	50	RBH52 ; CBH52 ; CBI 5	0.8	512208	500		
BT30-LBK6-060L		60	64	RBH68 ; RBH90 ; CBH68 ; CBH100 ; CBH150 ; CBI6	1.0	512210	500		
BT40-LBK1-075L	2	75	19	CBH20	1.0	512212	500		
BT40-LBK1-105L		105	19	CBH20	1.2	512214	500		
BT40-LBK2-085L		85	24	RBH25 ; CBH25	1.1	512216	500		
BT40-LBK2-115L		115	24	RBH25 ; CBH25	1.4	512218	500		
BT40-LBK3-095L		95	31	RBH32 ; CBH32	1.2	512220	500		
BT40-LBK3-125L		125	31	RBH32 ; CBH32	1.5	512222	500		
BT40-LBK3-155L		155	31	RBH32 ; CBH32	1.7	512224	500		
BT40-LBK4-085L		85	39	RBH40 ; CBH40 ; CBI4	1.3	512226	500		
BT40-LBK4-130L		130	39	RBH40 ; CBH40 ; CBI4	1.9	512228	500		
BT40-LBK4-175L		175	39	RBH40 ; CBH40 ; CBI4	2.2	512230	600		
BT40-LBK5-075L		75	50	RBH52 ; CBH52 ; CBI 5	1.3	512232	500		
BT40-LBK5-125L		125	50	RBH52 ; CBH52 ; CBI 5	2.3	512234	500		
BT40-LBK5-175L		175	50	RBH52 ; CBH52 ; CBI 5	3.0	512236	500		
BT40-LBK6-065L		65	64	RBH68 ; RBH90 ; CBH68 ; CBH100 ; CBH150 ; CBI6	1.3	512238	500		
BT40-LBK6-115L		115	64	RBH68 ; RBH90 ; CBH68 ; CBH100 ; CBH150 ; CBI6	2.7	512240	500		
BT40-LBK6-165L		165	64	RBH68 ; RBH90 ; CBH68 ; CBH100 ; CBH150 ; CBI6	3.9	512242	600		
BT50-LBK1-115L		1	115	31/19	CBH20	4.0	512244	800	
BT50-LBK1-145L			145	31/19	CBH20	4.1	512246	900	
BT50-LBK2-110L	2		110	24	RBH25 ; CBH25	3.9	512248	800	
BT50-LBK2-140L			140	24	RBH25 ; CBH25	4.0	512250	900	
BT50-LBK3-125L			125	31	RBH32 ; CBH32	4.1	512252	800	
BT50-LBK3-155L			155	31	RBH32 ; CBH32	4.2	512254	900	
BT50-LBK4-115L			115	39	RBH40 ; CBH40 ; CBI4	4.3	512256	800	
BT50-LBK4-145L			145	39	RBH40 ; CBH40 ; CBI4	4.4	512258	900	
BT50-LBK4-175L	175		39	RBH40 ; CBH40 ; CBI4	4.8	512260	1000		
BT50-LBK4-205L	205		39	RBH40 ; CBH40 ; CBI4	4.9	512262	1100		
BT50-LBK5-105L	1		105	50	RBH52 ; CBH52 ; CBI 5	4.5	512264	800	
BT50-LBK5-180L			180	50	RBH52 ; CBH52 ; CBI 5	5.5	512266	900	
BT50-LBK5-240L		240	50	RBH52 ; CBH52 ; CBI 5	6.2	512268	1000		
BT50-LBK5-300L		300	64/50	RBH68 ; RBH90 ; CBH68 ; CBH100 ; CBH150 ; CBI6	7.6	512270	1300		
BT50-LBK6-095L		2	95	64	RBH68 ; RBH90 ; CBH68 ; CBH100 ; CBH150 ; CBI6	4.5	512272	900	
BT50-LBK6-170L			170	64	RBH68 ; RBH90 ; CBH68 ; CBH100 ; CBH150 ; CBI6	6.3	512274	1100	
BT50-LBK6-230L	230		64	RBH68 ; RBH90 ; CBH68 ; CBH100 ; CBH150 ; CBI6	7.6	512276	1200		
BT50-LBK6-290L	290		64	RBH68 ; RBH90 ; CBH68 ; CBH100 ; CBH150 ; CBI6	9.0	512278	1300		
BT50-LBK6-350L	1	350	90/64	RBH68 ; RBH90 ; CBH68 ; CBH100 ; CBH150 ; CBI6	13.5	512280	1500		
IBT50-LBK6-350L	2	350	64	RBH68 ; RBH90 ; CBH68 ; CBH100 ; CBH150 ; CBI6	11.2	512282	1500		
BT40-BST-070L	3	70	95	RBH120 and above ; CBH200 and above ; large diameter boring heads series	3.2	512284	1250		
BT50-BST-100L		100			5.1	512286	1520		
BT50-BST-150L		150			6.8	512288	2000		
BT50-BST-200L		200			9.6	512290	2400		
BT50-BST-250L		250			11.5	512292	2600		
BT50-BST-300L		300			13.5	512294	2800		
BT50-BST-350L		350			15.5	512296	5000		
BT50-BST-400L		400			17.5	512298	5200		
BT50-FMA47.625-75		75			128	RBH600A , RBH900A , CBH600 , CBH900	7.0	512300	900

Boring Cutter System

BS

BS BORING BAR



BSA = 45°

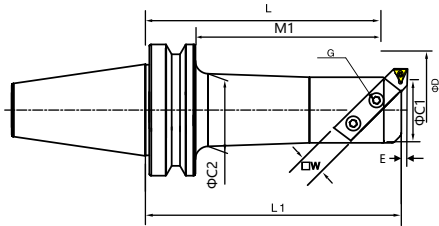

BSB = 90°

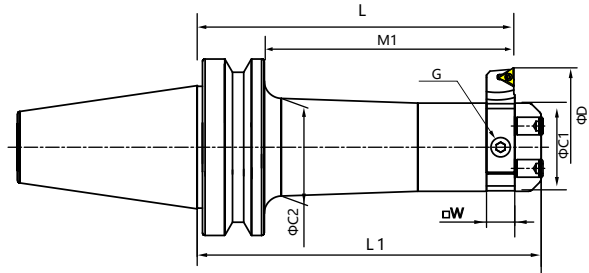

Cat.No	D		L	M1	C1	C2	E	W	Order	Price
	min	max								
BT30-BSA20-105	20	30	105	85	17	19	-	6	512300	
25-120	25	38	120	100	20	24	1	8	512302	
25-160	25	38	160	140	20	24	1	8	512304	
30-150	30	42	150	130	24	28	1.6	8	512306	
30-180	30	42	180	160	24	28	1.6	8	512308	
30-210	30	42	210	190	24	28	1.6	8	512310	
38-165	38	52	165	145	30	36	2.6	10	512312	
50-165	50	65	165	145	40	48	3	13	512314	
50-210	50	65	210	190	40	48	3	13	512316	
BT40-BSA25-135	25	38	135	110	20	24	1	8	512318	
30-150	30	42	150	125	24	28	1.6	8	512320	
38-165	38	52	165	140	30	36	2.6	10	512322	
50-165	50	65	165	140	40	48	3	13	512324	
50-210	50	65	210	185	40	48	3	13	512326	
62-165	62	90	165	140	50	48	2	16	512328	
62-225	62	90	225	200	50	58	2	16	512330	
72-165	72	110	165	140	60	60	2.4	19	512332	
72-225	72	110	225	200	60	60	2.4	19	512334	
90-165	90	125	165	140	75	62	4	19	512336	
90-210	90	125	210	185	75	62	4	19	512338	
BT50-BSA25-135	25	38	135	100	20	24	1	8	512340	
30-165	30	42	165	130	24	28	1.6	8	512342	
38-180	38	52	180	145	30	36	2.6	10	512344	
38-230	38	52	230	195	30	36	2.6	10	512346	
42-210	42	56	210	175	34	38	2	10	512348	
42-240	42	56	240	205	34	38	2	10	512350	
50-180	50	65	180	145	40	48	3	13	512352	
50-240	50	65	240	205	40	48	3	13	512354	
50-270	50	65	270	235	40	48	3	13	512356	
50-300	50	65	300	265	40	48	3	13	512358	
62-195	62	90	195	160	50	58	2	16	512360	
62-240	62	90	240	205	50	58	2	16	512362	
62-270	62	90	270	235	50	58	2	16	512364	
62-300	62	90	300	265	50	58	2	16	512366	
72-195	72	110	195	160	60	68	2.4	19	512368	
72-240	72	110	240	205	60	68	2.4	19	512370	
72-285	72	110	285	250	60	68	2.4	19	512372	
72-320	72	110	320	285	60	68	2.4	19	512374	
90-210	90	125	210	175	75	74	4	19	512376	
90-250	90	125	250	215	75	76	4	19	512378	
90-300	90	125	300	265	75	76	4	19	512380	
105-195	105	160	195	160	90	76	3	25	512382	
105-285	105	160	285	250	90	76	3	25	512384	

Cat.No	D		L	M1	C1	C2	W	Order	Price
	min	max							
BT30-BSB20-105	20	30	105	85	17	19	6	512400	
25-120	25	38	120	100	20	24	8	512402	
25-160	25	38	160	140	20	24	8	512404	
30-150	30	42	150	130	24	28	8	512406	
30-165	30	42	180	160	24	28	8	512408	
30-210	30	42	210	190	24	28	8	512410	
38-165	38	52	165	145	30	36	10	512412	
50-165	50	65	165	145	40	48	13	512414	
50-210	50	65	210	190	40	48	13	512416	
BT40-BSB25-135	25	38	135	110	20	24	8	512418	
38-165	38	52	165	140	30	36	10	512420	
50-165	50	65	165	140	40	48	13	512422	
50-210	50	65	210	185	40	48	13	512424	
62-165	62	90	165	140	50	54	16	512426	
62-225	62	90	225	200	50	56	16	512428	
72-165	72	110	165	140	60	60	19	512430	
72-225	72	110	225	200	60	60	19	512432	
90-165	90	125	165	140	75	75	19	512434	
90-210	90	125	210	185	75	64	19	512436	
BT50-BSB25-135	25	38	135	100	20	24	8	512438	
38-180	38	52	180	145	30	38	10	512440	
38-230	38	52	230	195	30	38	10	512442	
42-210	42	56	210	175	34	38	10	512444	
42-240	42	56	240	205	34	38	10	512446	
50-180	50	65	180	145	40	48	13	512448	
50-240	50	65	240	205	40	48	13	512450	
50-270	50	65	270	235	40	48	13	512452	
50-300	50	65	300	265	40	48	13	512454	
62-195	62	90	195	160	50	58	16	512456	
62-240	62	90	240	205	50	58	16	512458	
62-270	62	90	270	235	50	58	16	512460	
62-300	62	90	300	265	50	58	16	512462	
62-330	72	110	195	160	60	68	19	512464	
72-195	72	110	240	205	60	68	19	512466	
72-240	72	110	285	250	60	68	19	512468	
72-285	72	110	320	285	60	68	19	512470	
90-210	90	125	210	175	75	80	19	512472	
90-250	90	125	250	215	75	80	19	512474	
90-300	90	125	300	265	75	80	19	512476	
105-195	105	160	195	160	90	-	25	512478	
105-285	105	160	285	250	90	94	25	512480	

- Boring Bar rough cutting beart suiting through-hole and blind hole borings .The same location of drive key and cunina edae .
- Please order boring bite separately .
- Dlmsjion of L , L1 , L2 criteria , when D is minimum dimension .

- Bo ring Bar for rough cutting best suiting through-hole boring .
- Also app`cable to counter bore spot facing:

Boring Cutter System

BSA bevel-type sugar head

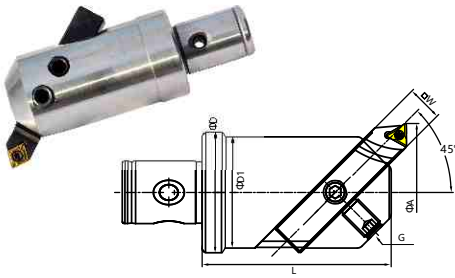

Order Number	Cat. No	Boring Range		Size						Price
		ΦA min	ΦA max	ΦD	ΦD1	L	E	W	G	
513101	BSA30-CK2	Φ30	Φ42	24	24	40	1.6	8	M6x1.00P	
513102	BSA38-CK3	Φ38	Φ52	31	60	60	2.6	10	M8x1.25P	
513103	BSA50-CK4	Φ50	Φ65	42	40	70	3	13	M10x1.50P	
513104	BSA62-CK5	Φ62	Φ90	55	50	85	2	16	M12x1.75P	
513105	BSA72-CK6	Φ72	Φ110	63	60	98	2.4	19	M12x1.75P	

BSB bevel-type sugar head

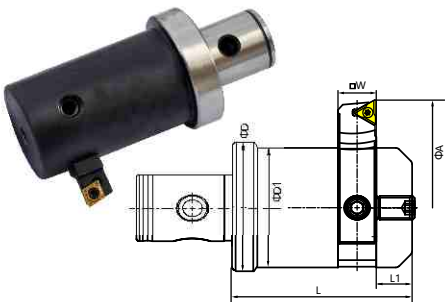

Order Number	Cat. No	Boring Range		Size						Price
		ΦA min	ΦA max	ΦD	ΦD1	L	L1	W	G	
513111	BSB25-CK2	Φ26	Φ52	24	20	45	10	8	M6x1.00P	
513112	BSB38-CK3	Φ38	Φ70	31	30	55	10	10	M8x1.25P	
513113	BSB50-CK4	Φ50	Φ90	42	40	60	10	13	M10x1.50P	
513114	BSB62-CK5	Φ62	Φ115	55	50	70	12	16	M12x1.75P	
513115	BSB72-CK6	Φ72	Φ135	63	60	85	12	19	M12x1.75P	

CK

CK Chamfering cutter

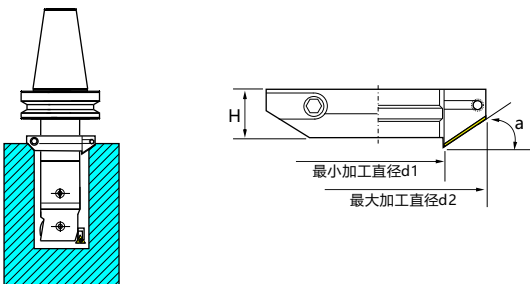

Order Number	Cat. No	Size			Modular holder	Applicable inserts	Price
		d1	d2	D			
513121	ZC1-35	20	35	13	CK1		
513122	ZC2-42	25	42	15	CK2	ZM1-45	
513123	ZC3-49	32	49		CK3	ZM1-30	
513124	ZC4-57	41	57	25	CK4		
513125	ZC5-90	53	90		CK5		
513126	ZC6-104	68	104		CK6	ZM2-45	
513127	ZC7-138	98	138		CK6	ZM2-30	
513128	ZC8-160	120	160		CK6		

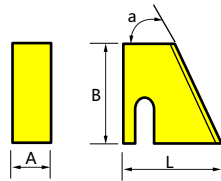

Order Number	Cat. No	Size				Modular holder	Price
		L	A	B	a		
513130	ZM1-45	23.5	4	9	45°	CK1-4	
513131	ZM2-45	43	8	20		CK5-6	
513132	ZM1-30	27.5	4	9	30°	CK1-4	
513133	ZM2-30	52	8	20		CK5-6	

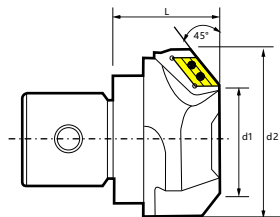

Order Number	Cat. No	Teeth	Size			Modular holder	Applicable inserts	Clamp screw	Price
			d1	d2	D				
513140	CK-B2-C0525	1	5	25	25	CK2	CW1206A	M2	
513141	CK-B4-C1040	2	10	40	35	CK4	CW1909A	M3	
513142	CK-B5-C3060	3	30	60	40	CK5			
513143	CK-B5-C50100	3	50	100	65	CK6	CW3115A	M5	

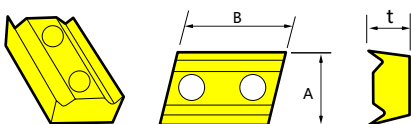

Order Number	Cat. No	Size			Clamp screw	Price
		A	B	t		
513150	CW1206A	6.35	12.7	2.7	M2	
513151	CW1909A	9.525	4.5	4.5	M3	
513152	CW3115A	15.875	7.0	7.0	M5	

BS

BS turner

● For BSA, BSB coarse sugar cutter, suitable for heavy machining

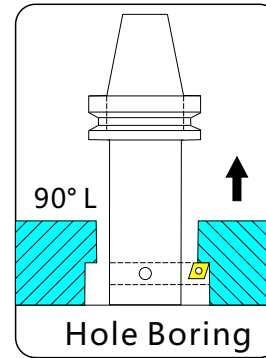
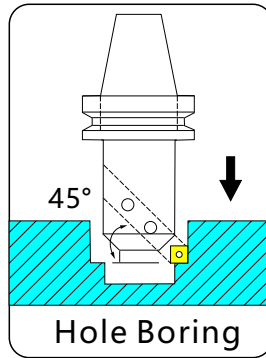





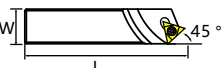
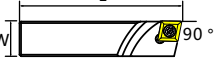





Fig	Shape	Fig-1 Ordering Code	Insert 	Fig-2 Ordering Code	Insert 	Fig-2 Ordering Code	Insert 	Dimensions,mm		
								H	W	L
1		TBS306	CC..0602..	TSBS306	TC..0902..	SBS306	TP..0902..	6	6	55
		TBS308	CC..0602..	TSBS308	TC..0902..	SBS308	TP..0902..	8	8	55
		TBS310	CC..0602..	TSBS310	TC..0902..	SBS310	TP..0902..	10	10	65
		TBS313	CC..09T3..	TSBS313	TC..1102..	SBS313	TP..1103..	13	13	80
		TBS316	CC..09T3..	TSBS316	TC..16T3..	SBS316	TP..1103..	16	16	120
		TBS319	CC..1204..	TSBS319	TC..16T3..	SBS319	TP..1603..	19	19	140
2		TBS325	CC..1204..	TSBS325	TC..16T3..	SBS325	TP..1603..	25	25	150
		TBS406	CC..0602..	TSBS406	TC..0902..	SBS406	TP..0902..	6	6	55
		TBS408	CC..0602..	TSBS408	TC..0902..	SBS408	TP..0902..	8	8	55
		TBS410	CC..0602..	TSBS410	TC..0902..	SBS410	TP..0902..	10	10	65
		TBS413	CC..09T3..	TSBS413	TC..1102..	SBS413	TP..1103..	13	13	80
		TBS416	CC..09T3..	TSBS416	TC..16T3..	SBS416	TP..1103..	16	16	120
1		TBS419	CC..1204..	TSBS419	TC..16T3..	SBS419	TP..1603..	19	19	140
		TBS425	CC..1204..	TSBS425	TC..16T3..	SBS425	TP..1603..	25	25	150
		TBS416B				SBS416B	TP..1103..	16	16	120
		TBS906	CC..0602..	TSBS906	TC..0902..	SBS906	TP..0902..	6	6	55
		TBS908	CC..0602..	TSBS908	TC..0902..	SBS908	TP..0902..	8	8	55
		TBS910	CC..0602..	TSBS910	TC..0902..	SBS910	TP..0902..	10	10	65
2		TBS913	CC..09T3..	TSBS913	TC..1102..	SBS913	TP..1103..	13	13	80
		TBS916	CC..09T3..	TSBS916	TC..16T3..	SBS916	TP..1103..	16	16	120
		TBS919	CC..1204..	TSBS919	TC..16T3..	SBS919	TP..1603..	19	19	140
		TBS925	CC..1204..	TSBS925	TC..16T3..	SBS925	TP..1603..	25	25	150
		TBS916B				SBS916B	TP..1103..	16	16	120
		TBS919L	CC..1204..					19	19	140
1		TBS908L	CC..0602..					8	8	55
		TBS910L	CC..0602..					10	10	65
		TBS913L	CC..09T3..					13	13	80
		TBS916L	CC..09T3..					16	16	120
		TBS919L	CC..1204..					19	19	140
2						BSB916	TP..1103..	16	16	150
						BSB920	TP..1103..	20	20	150

Insert 	Clamp Screw	Wrench	Insert 	Clamp Screw	Wrench	Insert 	Clamp Screw	Wrench
CC..0602..	MS2506A	T9	TC..0902..	MS2206A	T7	TP..0902..	MS2506A	T9
CC..09T3..	MS4011A	T15	TC..1102..	MS2506A	T9	TP..1103..	MS3008A	T9
CC..1204..	MS5011A	T20	TC..16T3..	MS4011A	T15	TP..1603..	MS4011A	T15

-Boring cutter replaceable of insert.The tip is sold separately

Boring Cutter System

Cassette Knife Block

SCFCR

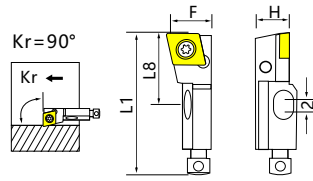

Cat. No	Size						Insert	Order Number	Price
	L1	L8	F	H	Dm	R			
SCFCR-08CA-06	32	15	10	8	25	0.4	CC..0602..	513200	
SCFCR-10CA-09	50	30	14	10	40	0.4	CC..09T3..	513202	

STFPR

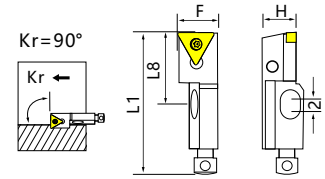

Cat. No	Size						Insert	Order Number	Price
	L1	L8	F	H	Dm	R			
STFPR-08CA-09	32	15	10	8	25	0.4	TP..0902..	513218	
STFPR-10CA-11	50	30	14	10	40	0.4	TP..1102..	513220	
STFPR-12CA-16	55	35	20	12	50	0.8	TP..1603..	513222	

SRSCR

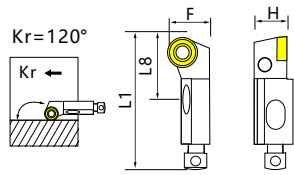

Cat. No	Size						Insert	Order Number	Price
	L1	L8	F	H	Dm	R			
SRSCR/L-10CA-10	50	30	14	10	40		RC..10T3..	513208	

STGCL

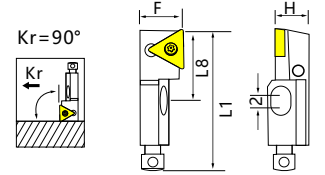

Cat. No	Size						Insert	Order Number	Price
	L1	L8	F	H	Dm	R			
STGCL-12CA-16	32	35	20	12	75	0.8	TC..16T3..	513224	

SSSPR

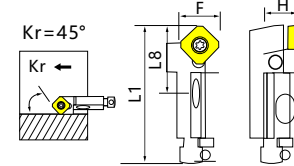

Cat. No	Size						Insert	Order Number	Price
	L1	L8	F	H	Dm	R			
SSSPR-10CA-09	50	30	14	10	40	0.4	SP..0903..	513210	

STSPR

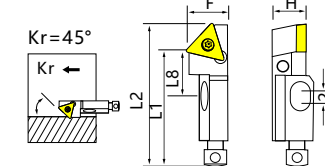

Cat. No	Size						Insert	Order Number	Price
	L1	L2	L8	F	H	Dm			
STSPR-08CA-09	28	34.1	11	10	8	25	0.4	TP..0902..	513230
STSPR-10CA-11	44	51.0	24	14	10	40	0.4	TP..1102..	513232
STSPR-12CA-16	47	57.0	27	20	12	50	0.8	TP..1603..	513234

STFCR

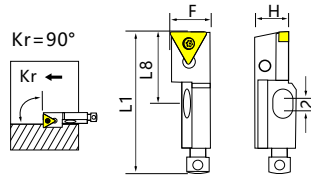

Cat. No	Size						Insert	Order Number	Price
	L1	L8	F	H	Dm	R			
STFCR-08CA-09	32	15	10	8	25	0.4	TC..0902..	513212	
STFCR-10CA-11	50	30	14	10	40	0.4	TC..1102..	513214	
STFCR-12CA-16	55	35	20	12	50	0.8	TC..16T3..	513216	

STSCR

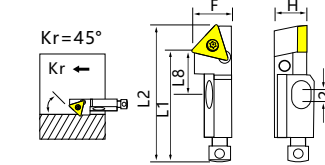

Cat. No	Size						Insert	Order Number	Price
	L1	L2	L8	F	H	Dm			
STSCR-08CA-09	28	34.1	11	10	8	25	0.4	TC..0902..	513236
STSCR-10CA-11	44	51.0	24	14	10	40	0.4	TC..1102..	513238
STSCR-12CA-16	47	57.0	27	20	12	50	0.8	TC..16T3..	513240

Axial mounting

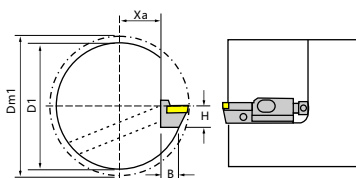

$$Xa = \frac{Dm1 - F}{2} \quad \text{Axial adjust} = \pm 1\text{mm}$$

$$\text{Radial adjust} = \pm 0.5\text{mm}$$

$$D1 = 2\sqrt{HF + (B(\pm)xa)^2}$$

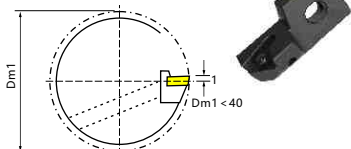

Radial mounting

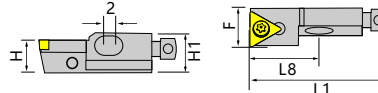

$$Xb = L1 - \frac{Dm2}{2} \quad \text{Axial adjust} = +0.5\text{mm}$$

$$\text{Radial adjust} = \pm 1\text{mm}$$

$$D2 = 2\sqrt{HF + (L3(\pm)xb)^2}$$

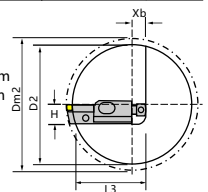

Cartridge size	Ordering code	Screw	Wrench	Screw	Wrench	Screw	Screw	Wrench	Order Number	Price
08CA	SCFCR-08CA-06	HM408	PL20	HTR414	PL25	RTM412	MS2506A	TF9		
	STFCR-08CA-09									
	STFPR-08CA-09									
	STSCR-08CA-09									
	STSPR-08CA-09									
10CA	SCFCR-10CA-09	HM410	PL20	HTR623	PL25	RTM515	MS2506A	TF9		
	SRSCR/L-10CA-10									
	SSSPR-10CA-09									
	STFCR-10CA-11									
	STFPR-10CA-11									
	STSCR-10CA-11									
STSPR-10CA-11										
12CA	SCFCR-08CA-06	HM412	PL20	HTR623	PL25	RTM515	MS4011A	TF15		
	STFCR-08CA-09									
	STFPR-08CA-09									
	STSCR-08CA-09									
	STSPR-08CA-09									

TDL Twin Edge Rough Boring Tool

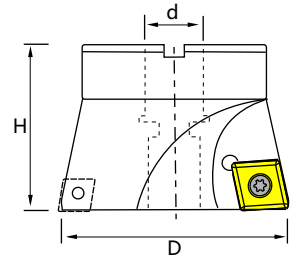
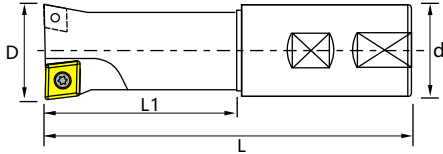

Order Number	Cat. No	No.of flutes	Size				Price
			D	d	L	L1	
513250	TDL-12-120	1	11.7	16	120	30	400
513251	TDL-13-120	1	12.7	16	120	30	400
513252	TDL-14-120	1	13.7	16	120	30	400
513253	TDL-15-120	1	14.7	16	130	30	400
513254	TDL-16-135	2	15.7	16	135	70	400
513255	TDL-17-135	2	16.7	16	135	70	400
513256	TDL-18-135	2	17.7	16	135	70	400
513257	TDL-19-160	2	18.7	16	160	90	400
513258	TDL-20-160	2	19.7	20	160	90	400
513259	TDL-22-160	2	21.7	20	160	90	400
513260	TDL-24-180	2	23.7	20	180	100	400
513261	TDL-25-190	2	24.7	25	190	110	400
513262	TDL-26-200	2	25.7	25	200	120	450
513263	TDL-27-200	2	26.7	25	200	120	450
513264	TDL-28-200	2	27.7	25	200	120	450
513265	TDL-30-210	2	29.7	25	210	130	450
513266	TDL-32-210	2	31.7	25	210	130	450
513267	TDL-35-250	2	34.7	32	250	150	500
513268	TDL-37-250	2	36.7	32	250	150	500
513269	TDL-40-270	2	39.7	32	270	170	550
513270	TDL-42-250	2	41.7	32	250	150	550
513271	TDL-45-310	2	44.7	32	310	210	600
513272	TDL-47-260	2	46.7	32	260	160	600
513273	TDL-50-260	2	49.7	42	260	160	650
513274	TDL-50-310	2	49.7	42	310	210	700
513275	TDL-52-260	2	51.7	42	260	160	700
513276	TDL-55-330	2	54.7	42	330	230	750
513277	TDL-60-260	2	59.7	42	260	160	800
513278	TDL-60-350	2	59.7	42	350	250	900

Mating

Cat. No	Insert	Clamp screw	wrench
TDL-16	CCMT060204	M2.5×6	T8
TDL-30	CCMT09T308	M4×10	T15

Order Number	Cat. No	No.of flutes	Size			Price
			D	d	L1	
513280	TDL-45-22	2	44.7	22	50	
513281	TDL-50-22	2	49.7	22	50	
513282	TDL-55-22	2	54.7	22	50	
513283	TDL-60-22	2	59.7	22	50	
513284	TDL-62-22	2	61.7	22	50	
513285	TDL-62-25.4	2	61.7	25.4	50	
513286	TDL-65-25.4	2	64.7	25.4	50	
513287	TDL-70-25.4	2	69.7	25.4	50	
513288	TDL-72-25.4	2	71.7	25.4	50	
513289	TDL-75-25.4	2	74.7	25.4	50	
513290	TDL-80-25.4	2	79.7	25.4	50	
513291	TDL-85-25.4	2	84.7	25.4	50	
513292	TDL-90-31.75	2	89.7	31.75	50	
513293	TDL-95-31.75	2	94.7	31.75	50	
513294	TDL-100-31.75	2	99.7	31.75	50	

Mating

Cat. No	Insert	Clamp screw	wrench
TDL-62	CCMT09T308	M4×10	T15

Counter-sink hole on sceewof milling cutter

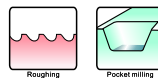

- ★ When bored with the traditional combination of the first processing in one, a process completed in a substantial increase in countersunk head screw hole processing efficiency

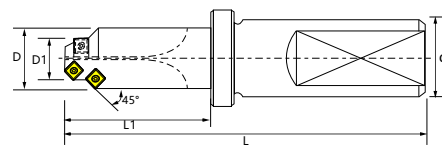

Order Number	Cat. No	Teeth	Size						Insert	Clamp screw	wrench	Price
			D	D1	d	L1	L					
513300	CH-8-14-C25	1	14	2.9	25	21	108					
513302	CH-10-17.5-C25	2	17.5	5.3	25	26	115					
513304	CH-12-20-C25	2	20	7.8	25	30	120	CCMT060204	M2.5x6.5	T8		
513306	CH-14-23-C25	2	23	10.8	25	34.5	126					
513308	CH-16-26-C32	2	26	8.5	32	39	132					
513310	CH-18-29-C32	2	29	11.5	32	43.5	138	CCMT09T308	M4x9	T15		
513312	CH-20-32-C32	2	32	14.5	32	59	144					

Boring Cutter System

Throw-away back counter-sink tool

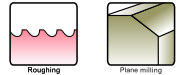

- ★ Reduction of secondary processing, additional fine-tuning sector
- ★ No positive inversion, reducing the probability of damage
- ★ Specially designed rigid body the best

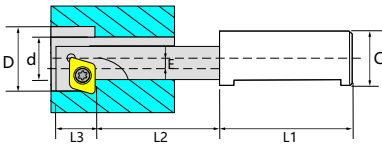

Order Number	Cat. No	Size						Insert	Clamp screw	wrench	Price	
		D	d	C	L1	L2	L3					E
513320	M10-1810	18	10.5	16	48	35	13	4	CCMT060204 CCGT060204	M2.5x6	T8	200
513322	M12-2013	20	13	16	48	40	13	3.85				200
513324	M16-2617	26	17	20	50	50	13	4.85	CCMT09T308 CCGT09T308	M4x9	T15	300
513326	M20-3321	33	21	25	56	70	13	6.4				300
513328	M24-4025	40	25	25	56	80	13	7.9				300

ZCDM

ZCDM screw drill countersunk chamfering cutter

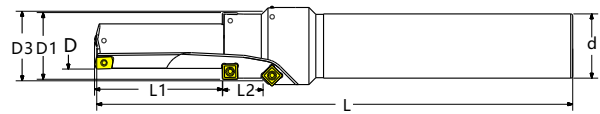

Order Number	Cat. No	Hole diameter	Head diameter	Hole depth	Head deep	The chamfer	Shank diameter	Long	Stem length	Price
513350	ZCDM10-12-30-17.5-11-45DEG	12	17.5	35	11	0.6	25	100	50	
513352	ZCDM12-14-38-20-13-45DEG	14	20	35	13	0.6	25	110	50	
513354	ZCDM14-16-43-23-15-45DEG	16	23	45	15	0.8	25	180	100	
513356	ZCDM16-18-48-26-17-45DEG	18	26	50	17	0.8	25	190	100	

Nonstandard tool for boring

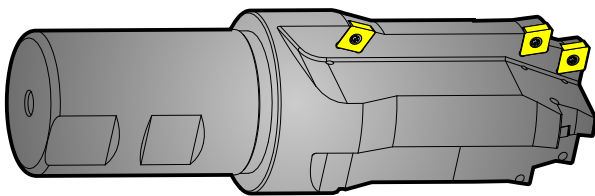

Knife handle leveling compound sugar

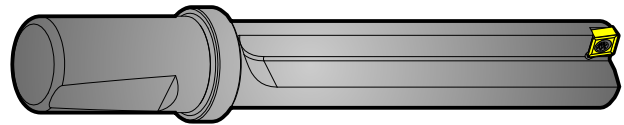

Fixed size reaming drill

- High efficiency: a tool can be completed in a feed multi-process machining.
- High rigidity: Because it is tailor-made, the tool can be processed to design into a rigid structure of the highest.
- Ultra-flexible: whether it is long or large special shaped tools can be customized for you.

✦ Custom non-standard tool of the general steps:

step1: providing workpiece drawings, and detailed processing of specifying a location of the size requirements and the workpiece material, hardness.

step2: Specify the type of tool shank, which can be integral spindle handle BT, etc. may also be a leveling out or raked flat shank straight shank handle, etc. or any other form of interface.

step3: to provide the following information as detailed as possible so that we can provide you customized tool that best meets your needs.

Machine Type _____
 Machine power (KW) _____
 Maximum Speed (RPM) _____
 Maximum Coolant Pressure _____
 Rotary Drill Workpiece rotation Vertical Drilling The level of drilling
 Cooling Cooled External cooling
 Machine rigidity High common low

◊ If you already have designed non-standard drawing tools, then we can only provide tools that you are drawing processing.

◊ Much detail as possible you need to customize the tool to provide relevant information, data more detailed, customized tool will be more shared.

◊ If you have other requirements please communicate directly with our engineers.